

ANIMAL TRAP

ASSEMBLY INSTRUCTIONS

Model 9646



Model 90218



Visit our website at: <http://www.harborfreight.com>



**Read this material before using this product.
Failure to do so can result in serious injury.
SAVE THIS MANUAL.**

Copyright© 2003 by Harbor Freight Tools®. All rights reserved. No portion of this manual or any artwork contained herein may be reproduced in any shape or form without the express written consent of Harbor Freight Tools. Diagrams within this manual may not be drawn proportionally. Due to continuing improvements, actual product may differ slightly from the product described herein. Tools required for assembly and service may not be included.

For technical questions or replacement parts, please call 1-800-444-3353.

Revised Manual 04k, 07i, 09k

SPECIFICATIONS

Overall Dimensions	SKU 09646 - 32" L X 10" W X 15" H SKU 90218 - 37" L X 12" W X 12" H
Materials	Steel Wire Cage with Welded Joints
Finish	Zinc Plated Wire
Doors (2)	Front Door Locking-Trigger Hook Release w/ Weight Sensitive Trigger Pan
Cage Wire Thickness	$\frac{3}{16}$ "

SAVE THIS MANUAL

You will need the manual for the safety warnings and precautions, assembly instructions, operating and maintenance procedures, parts list and diagram. Keep your invoice with this manual. Write the invoice number on the inside of the front cover. Keep the manual and invoice in a safe and dry place for future reference.

SAFETY WARNINGS AND PRECAUTIONS

1. **AVOID SHARP EDGES WHEN ASSEMBLING.**
2. **KEEP PRODUCT USAGE AREA CLEAN.** Animal Trap can be hosed off when cleaning.
3. **ALWAYS CHECK DOOR LOCK AND ASSEMBLY LATCHES.**
4. **CHECK FOR DAMAGED PARTS.** Before using this product, carefully check that it will operate properly and perform its intended function. Check for damaged parts and any other conditions that may affect its operation. Replace or repair damaged or worn parts immediately.
5. **REPLACEMENT PARTS AND ACCESSORIES.** When servicing, use only identical replacement parts.
6. **USE EXTREME CAUTION** when transporting animal in Animal Trap. Be cautious of bites or scratching if you plan on carrying Trap with animal inside. Could cause back injury or injury to animal.
7. **DO NOT ALLOW CHILDREN TO STAND UPON OR CLIMB INTO ANIMAL TRAP.** For small animals only. Do not exceed maximum weight indicated on warning label.
8. **NEVER PUT TRAP ON A WOODEN DECK OR ANY OTHER SURFACE** that you do not want scratched.
9. **PUT BAIT BETWEEN TRIGGER PAN AND BACK DOOR.** Bait should be far enough away from side so the bait cannot be reached from the outside. Do not put bait on Trigger Pan.
10. **AFTER SETTING, CHECK THE TRAP AT LEAST ONCE PER DAY.** Caged animals suffer from stress and should be treated humanely.

OPERATION INSTRUCTIONS

1. The Animal Trap comes collapsed and assembled for transportation and storage. It is a strong, durable steel wire cage. **See Figure 1.**



Figure 1

Figure 3

Figure 4

2. Open collapsed Animal Trap by lifting Trap by handle. The Trap will take on a square shape. Swing down the Cage Support Brace (10) and attach it to the Cage (1) using the clip on each side. Close the Quick Release Rear Door (2) and clamp it in place with the Squeeze Clamp (4). **See Figure 3.**
3. If the ground permits, press the Anchor Stake (3) into the ground once the trap is in position. The Stake will help prevent the trap from rolling and potentially injuring the animal.

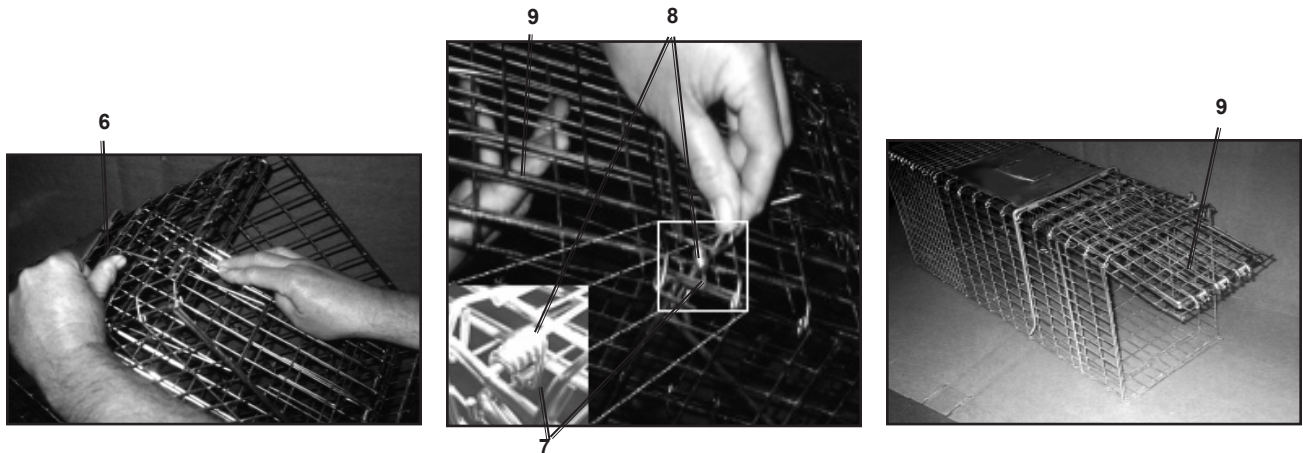

Figure 5

Figure 6

Figure 7

4. Open the Front Spring Powered Trap Door (5) while pressing the Upper Latch (6). **See Figure 4.** Hold the Trap Door (5) open (assistance may be required). Hook the Trigger Hook (7) on the Turning Sleeve (8) on the Front Door (9). **See Figure 5.** The Trigger Hook (7) will keep the door open. **See Figures 6 & 7.**

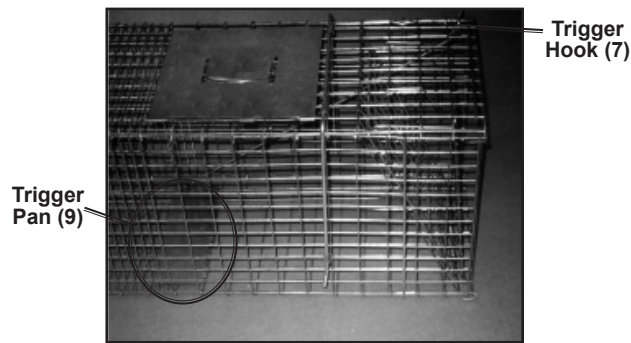

Figure 8

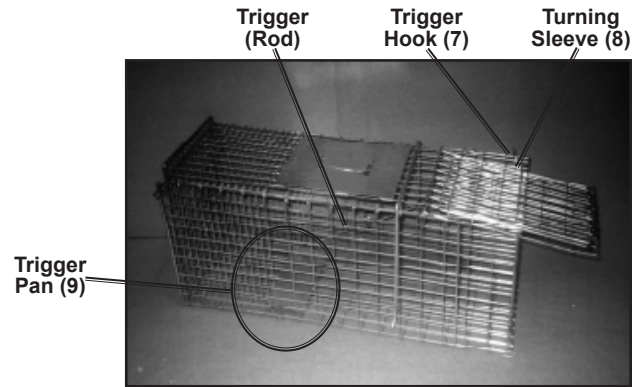

Figure 9

5. Adjust the Trigger's sensitivity by adjusting Trigger Hook (7) all the way as far as it goes under the Turning Sleeve (8) for a "coarse setting". This will need a LOT of weight on the Trigger Pan (9) to pull the Trigger Hook (7) off the Turning Sleeve (8) on the Front Door (5) and releases the Front Door. **See Figure 8 & 9.**
6. For a more sensitive setting, hook the Trigger Hook on the Turning Sleeve (8) only with the **TIP** of the Hook. The weight of a light weight animal will pull the Trigger hook off the Turning Sleeve and release the Front (Trap) Door (5) with that weight on the Trigger Pan (9).
7. A pair of pliers can reshape the Trigger Hook for any fine adjustment you may need. Practicing the settings of the Trigger with a pencil or screwdriver on the Trigger Pan (9) and how much pressure is needed for releasing of the Front Door (5), should give you the desired setting you will need for the animal you plan to catch.

To Collapse Trap

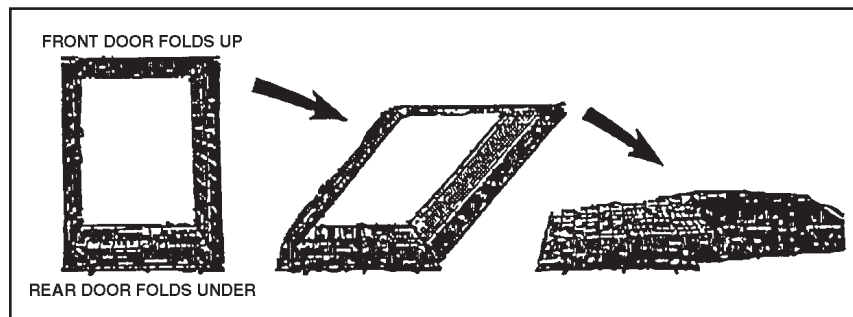

Figure 10

Collapse the Trap by undoing the clips holding the Cage Support Brace (10) and folding it out of the way. Fold Rear Door (2) underneath Trap. Hold Front Door (5) open. Then, fold Trap in direction of arrow. **See Figure 10.**

MAINTENANCE

1. For better and safer performance, keep all parts of this product clean and dry.
2. Periodically check to see that all hardware is in place.

PARTS LIST

Part	Description	Q'ty
1	Cage	1
2	Quick Release Rear Door	1
3	Anchor Stake (not shown)	1
4	Squeeze Clamp	1
5	Front Spring Powered Trap Door	1
6	Upper Latch	1
7	Trigger Hook	1
8	Turning Sleeve	1
9	Trigger Pan	1
10	Cage Support Brace	1

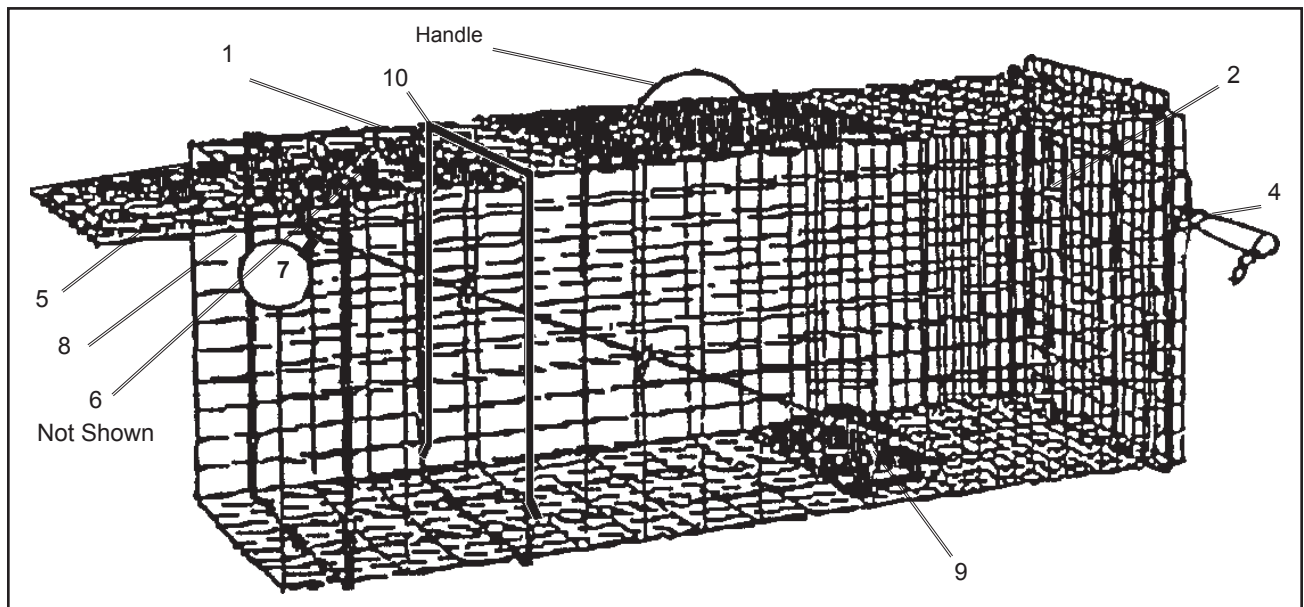

PLEASE READ THE FOLLOWING CAREFULLY

THE MANUFACTURER AND/OR DISTRIBUTOR HAS PROVIDED THE PARTS DIAGRAM IN THIS MANUAL AS A REFERENCE TOOL ONLY. NEITHER THE MANUFACTURER NOR DISTRIBUTOR MAKES ANY REPRESENTATION OR WARRANTY OF ANY KIND TO THE BUYER THAT HE OR SHE IS QUALIFIED TO MAKE ANY REPAIRS TO THE PRODUCT OR THAT HE OR SHE IS QUALIFIED TO REPLACE ANY PARTS OF THE PRODUCT. IN FACT, THE MANUFACTURER AND/OR DISTRIBUTOR EXPRESSLY STATES THAT ALL REPAIRS AND PARTS REPLACEMENTS SHOULD BE UNDERTAKEN BY CERTIFIED AND LICENSED TECHNICIANS AND NOT BY THE BUYER. THE BUYER ASSUMES ALL RISK AND LIABILITY ARISING OUT OF HIS OR HER REPAIRS TO THE ORIGINAL PRODUCT OR REPLACEMENT PARTS THERETO, OR ARISING OUT OF HIS OR HER INSTALLATION OF REPLACEMENT PARTS THERETO.