

Owner's Manual & Safety Instructions

Save This Manual Keep this manual for the safety warnings and precautions, assembly, operating, inspection, maintenance and cleaning procedures. Write the product's serial number in the back of the manual near the assembly diagram (or month and year of purchase if product has no number). Keep this manual and the receipt in a safe and dry place for future reference.

20c

Bauer™

19116C-B

20V

HYPERMAX™ LITHIUM

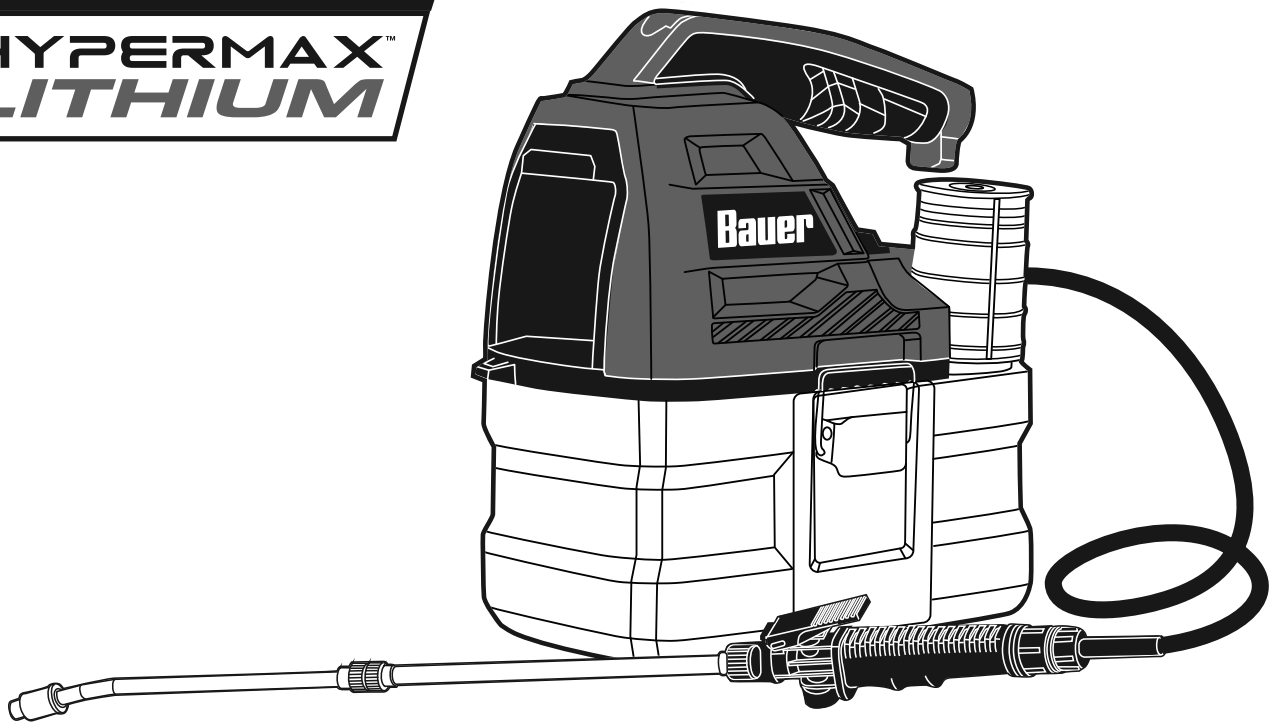

1 GALLON CORDLESS CHEMICAL SPRAYER

Visit our website at: <http://www.harborfreight.com>
Email our technical support at: productsupport@harborfreight.com

57230

When unpacking, make sure that the product is intact and undamaged. If any parts are missing or broken, please call 1-888-866-5797 as soon as possible.

Copyright© 2020 by Harbor Freight Tools®. All rights reserved.

No portion of this manual or any artwork contained herein may be reproduced in any shape or form without the express written consent of Harbor Freight Tools. Diagrams within this manual may not be drawn proportionally. Due to continuing improvements, actual product may differ slightly from the product described herein.

Tools required for assembly and service may not be included.

⚠ WARNING

Read this material before using this product. Failure to do so can result in serious injury.
SAVE THIS MANUAL.

Table of Contents

Safety	2	Maintenance	8
Specifications	5	Parts List and Diagram	10
Setup	5	Warranty	12
Operation.....	7		

SAFETY



SETUP

WARNING SYMBOLS AND DEFINITIONS

	This is the safety alert symbol. It is used to alert you to potential personal injury hazards. Obey all safety messages that follow this symbol to avoid possible injury or death.
	Indicates a hazardous situation which, if not avoided, will result in death or serious injury.
	Indicates a hazardous situation which, if not avoided, could result in death or serious injury.
	Indicates a hazardous situation which, if not avoided, could result in minor or moderate injury.
	Addresses practices not related to personal injury.

OPERATION

IMPORTANT SAFETY INSTRUCTIONS

WARNING

When using electric gardening appliances, basic safety precautions should always be followed to reduce the risk of fire, electric shock, and personal injury, including the following:

READ ALL INSTRUCTIONS

Battery Precautions

1. Do not charge appliance in rain, or in wet locations.
2. Do not use battery-operated appliance in rain.
3. Use only the specified battery pack or an identical replacement.
4. Do not dispose of the battery in a fire. The cell may explode. Check with local codes for possible special disposal instructions.
5. Do not open or mutilate the battery. Released electrolyte is corrosive and may cause damage to the eyes or skin. It may be toxic if swallowed.
6. Exercise care in handling batteries in order not to short the battery with conducting materials such as rings, bracelets, and keys. The battery or conductor may overheat and cause burns.

MAINTENANCE

Lithium Battery Safety Warnings



LITHIUM BATTERIES STORE A LARGE AMOUNT OF ENERGY AND WILL VENT FIRE OR EXPLODE IF MISTREATED:

1. **Keep Battery Pack dry.**

2. **DO NOT DO ANY OF THE FOLLOWING TO THE BATTERY PACK:**
 - a. **Open,**
 - b. **Drop,**
 - c. **Short-circuit,**
 - d. **Puncture,**
 - e. **Incinerate, or**
 - f. **Expose to temperatures greater than 140°F.**
3. Charge Battery Pack only according to its Charger's instructions.
4. Inspect Battery Pack before every use; do not use or charge if damaged.

Personal Safety

1. **Follow all guidelines regarding chemicals sprayed, including MSDS instructions and EPA regulations.**
2. Dress Properly - Do not wear loose clothing or jewelry. They can be caught in moving parts. Use of rubber gloves and substantial footwear is recommended when working outdoors. Wear protective hair covering to contain long hair.
3.  Wear ANSI-approved safety goggles and heavy-duty work gloves. Use face or dust mask if operation is dusty.
4. Avoid Unintentional Starting - Be sure switch is off when installing battery.
5. Do not Overreach - Keep proper footing and balance at all times.
6. Stay Alert - Watch what you are doing. Use common sense. Do not operate appliance when you are tired.

Gardening Appliance Use and Care

1. **Avoid Dangerous Environment - Do not use appliances in damp or wet locations.**
2. **Do not Use In Rain.**
3. **Keep Children Away - All visitors should be kept at a distance from work area.**
4. When servicing use only identical replacement parts.
5. Use Right Appliance - Do not use appliance for any job except that for which it is intended.
6. Do not Force Appliance - It will do the job better and with less likelihood of injury at the rate for which it was designed.
7. Store Idle Appliances Indoors - When not in use, appliances should be stored indoors in dry, and high or locked-up place - out of reach of children.
8. Maintain Appliance With Care. Follow instructions for lubricating and changing accessories. Inspect appliance cord periodically, and if damaged, have it repaired by an authorized service facility. Inspect extension cords periodically and replace if damaged. Keep handles dry, clean, and free from oil and grease.
9. Check Damaged Parts - Before further use of the appliance, a guard or other part that is damaged should be carefully checked to determine that it will operate properly and perform its intended function. Check for alignment of moving parts, binding of moving parts, breakage of parts, mounting, and any other condition that may affect its operation. A guard or other part that is damaged should be properly repaired or replaced by a qualified technician unless indicated elsewhere in this manual.

Vibration Hazard

This appliance vibrates during use. Repeated or long-term exposure to vibration may cause temporary or permanent physical injury, particularly to the hands, arms and shoulders. To reduce the risk of vibration-related injury:

1. Anyone using vibrating appliances regularly or for an extended period should first be examined by a doctor and then have regular medical check-ups to ensure medical problems are not being caused or worsened from use. Pregnant women or people who have impaired blood circulation to the hand, past hand injuries, nervous system disorders, diabetes, or Raynaud's Disease should not use this appliance. If you feel any symptoms related to vibration (such as tingling, numbness, and white or blue fingers), seek medical advice as soon as possible.
2. Do not smoke during use. Nicotine reduces the blood supply to the hands and fingers, increasing the risk of vibration-related injury.
3. Wear suitable gloves to reduce the vibration effects on the user.
4. Use appliances with the lowest vibration when there is a choice between different processes.
5. Include vibration-free periods each day of work.
6. Grip appliance as lightly as possible (while still keeping safe control of it). Let the appliance do the work.
7. To reduce vibration, maintain the appliance as explained in this manual. If any abnormal vibration occurs, stop use immediately.

General Safety

1. **Use only for water or water-based fertilizers, herbicides, pesticides and sealers. Do not use to spray combustible or corrosive chemicals.**
2. **Follow all guidelines regarding chemicals sprayed, including MSDS instructions and EPA regulations.**
3. Do not point the Sprayer at yourself, other people or animals.
4. Industrial applications must follow OSHA requirements.
5. Make sure the liquid used in the Sprayer is not dirty, sandy or viscous.
6. This product is not a toy. Do not allow children to play with or near this item.
7. Inspect before every use; do not use if parts are loose or damaged.
8. Do not use appliance for other than intended use.
9. Maintain labels and nameplates on the appliance. These carry important safety information. If unreadable or missing, contact Harbor Freight Tools for a replacement.
10. The warnings, precautions, and instructions discussed in this instruction manual cannot cover all possible conditions and situations that may occur. It must be understood by the operator that common sense and caution are factors which cannot be built into this product, but must be supplied by the operator.



SAVE THESE INSTRUCTIONS.

Specifications

Charger Type	Bauer 20V Li-ion (sold separately)
Battery Type	Bauer 20V Li-ion (sold separately)
Tank Capacity	1 Gallon
Maximum Output	28 PSI
Hose Length	4'

Set Up Instructions



Read the **ENTIRE IMPORTANT SAFETY INSTRUCTIONS** section at the beginning of this manual including all text under subheadings therein before set up or use of this product.

WARNING

TO PREVENT SERIOUS INJURY FROM ACCIDENTAL OPERATION:

Make sure that the Power Switch/Trigger is in the off-position and remove the Battery Pack before performing any procedure in this section.

Note: For additional information regarding the parts listed in the following pages, refer to the Assembly Diagram near the end of this manual.

Components and Controls

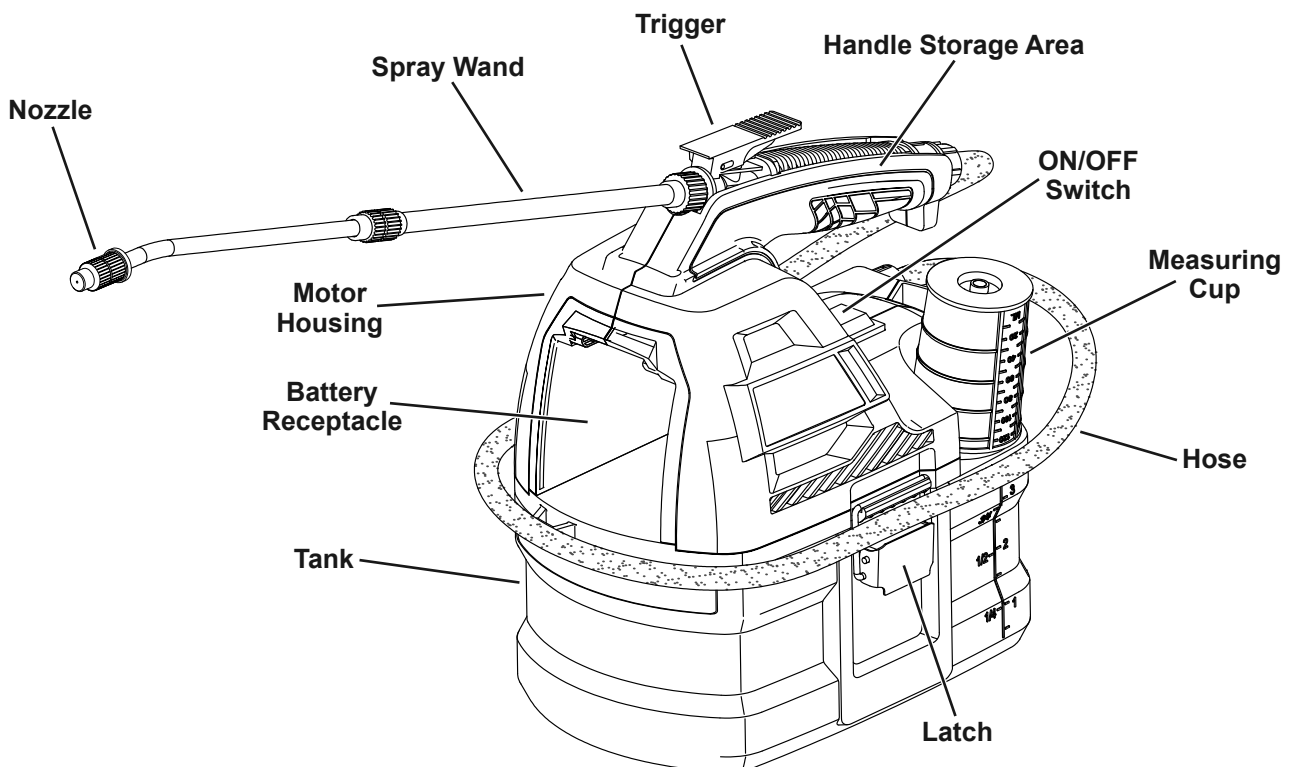

Assembly

SAFETY

Assembling the Spray Wand

1. Make sure the O-Ring is in place, then thread the Spray Wand onto the Handle and tighten securely. Refer to Figure A.
2. Loosen the Nozzle Nut and pull out the Nozzle Extension to the desired length.
3. Align the Nozzle with the Handle so it is pointing down and tighten the Nozzle Nut.
4. Pull on the Spray Wand to be certain it is properly secured.
5. Place the Handle of the assembled Wand into the handle storage area on the Sprayer.

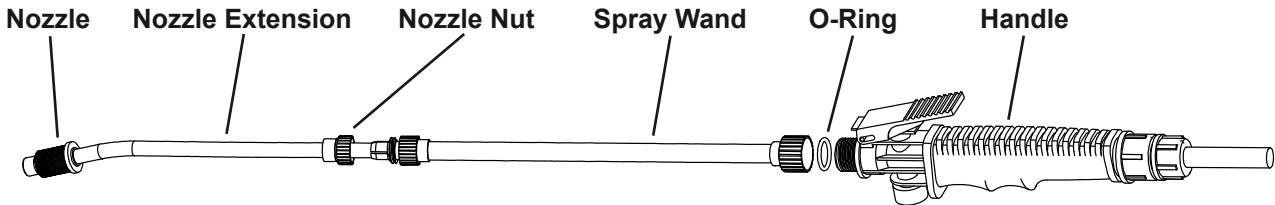

Figure A

SETUP

Attaching the Hose

1. To attach the Hose to the Tank, insert the end of the Hose into the threaded outlet on the Tank. Make sure the Hose is pushed in as far as it will go. Refer to Figure B.
2. Slide the Nut on the Hose over the threaded outlet and Hose end and hand tighten. Make sure the Hose is securely attached but do not overtighten.
3. To attach the Hose to the Handle, thread the Cap onto the Handle and tighten securely.
4. Insert the end of the Hose into the threaded opening on the Cap. Make sure the Hose is pushed in as far as it will go. Refer to Figure C.

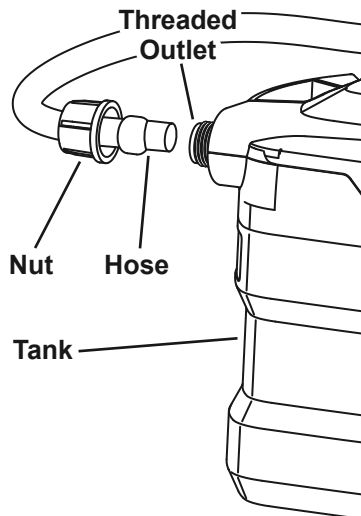

Figure B

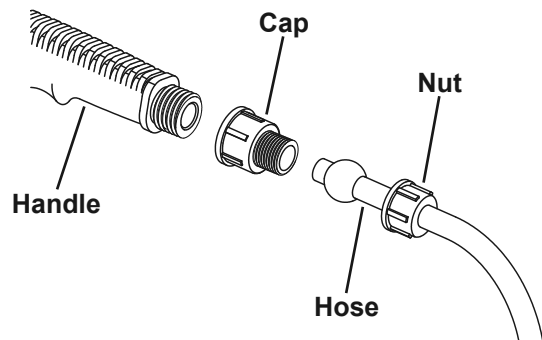

Figure C

5. Slide the Nut over the Hose end and Cap and hand tighten. Make sure the Hose is securely attached but do not overtighten.

OPERATION

MAINTENANCE

Operating Instructions



Read the **ENTIRE IMPORTANT SAFETY INFORMATION** section at the beginning of this manual including all text under subheadings therein before set up or use of this product.

Charging Battery Pack

Charge Battery Pack according to the instructions included with the 20V Bauer Battery Charger. Battery Pack and Charger sold separately.

General Operation

WARNING! TO PREVENT SERIOUS INJURY:
Follow all guidelines regarding chemicals sprayed, including MSDS instructions and EPA regulations.

1. Before operating the gardening appliance, put on ANSI-approved safety goggles and other safety gear. Safety goggles and other safety gear are sold separately.
2. Assemble Sprayer according to Assembly Instructions on page 6.
3. Unscrew and remove Measuring Cup and fill Tank with up to one gallon of premixed spray solution. Replace Cup and tighten securely.
4. Adjust the Nozzle for a fan spray or stream. For a fan spray tighten the Nozzle or loosen it for a steady stream. Refer to Figure D.

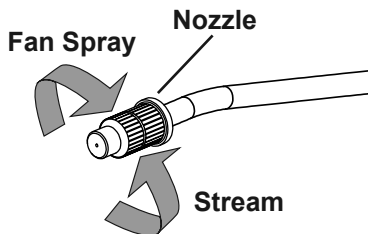
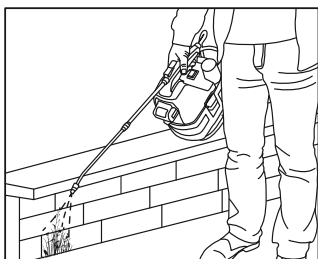
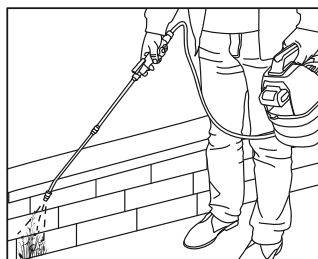

Figure D

5. Make sure the ON/OFF Switch is in the off-position, then slide the Battery Pack into the battery receptacle on the front of the Sprayer until it clicks into place.
6. Press the ON/OFF Switch to start the Sprayer.
7. Operate either with the Spray Wand secured in the handle storage area on the Sprayer or with the Wand held in your hand as shown.



Wand mounted on Sprayer



Wand held in hand

8. Point the Nozzle toward the area to be sprayed, then depress the Trigger to begin spraying.
9. For continuous spray, press the Trigger down and push it forward, then release the Trigger. To stop continuous spray, press the Trigger down and pull it back, then release the Trigger.

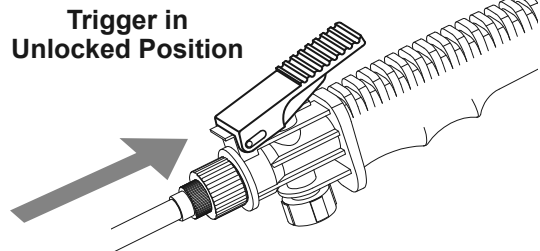
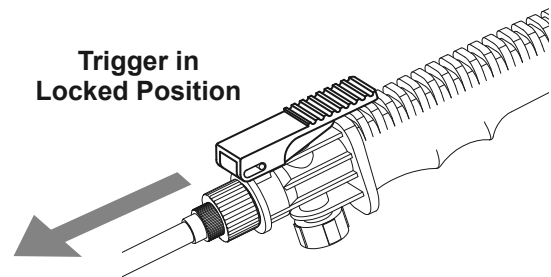

Figure E

10. When finished spraying:
 - a. Turn off Sprayer and remove its Battery Pack.
 - b. Point Wand in safe direction and depressurize the Tank by pressing down on the Trigger.
 - c. Dispose of liquid according to manufacturer guidelines.
 - d. Clean the Sprayer according to Maintenance Instructions.

Maintenance and Servicing



Procedures not specifically explained in this manual must be performed only by a qualified technician.

WARNING

TO PREVENT SERIOUS INJURY FROM ACCIDENTAL OPERATION:
Make sure that the Power Switch/Trigger is in the off-position and remove Battery Pack before performing any procedure in this section.

TO PREVENT SERIOUS INJURY FROM TOOL FAILURE:
Do not use damaged equipment. If abnormal noise or vibration occurs, have the problem corrected before further use.

Cleaning, Maintenance, and Lubrication

- BEFORE EACH USE**, inspect the general condition of the tool. Check for:
 - leaking, swollen, or cracked battery pack
 - loose hardware
 - misalignment or binding of moving parts
 - cracked or broken parts
 - any other condition that may affect its safe operation.
- AFTER EVERY USE**, clean the Sprayer:
 - Drain any remaining solution from the Tank through the fill area and dispose of properly.
 - Fill Tank one-third full with clean water. Install Battery Pack, point Wand in safe direction and run Sprayer until Tank is empty.
 - Repeat previous step as necessary until Sprayer is clean. Disconnect Battery Pack and drain the Tank of residual water.
 - Lift the two Latches and remove the Motor Housing from the Tank. Allow tool to air-dry with the Tank open.
- When dry, store Battery Pack, Charger, and tool in dry, indoor area out of reach of children and away from metal objects (i.e., paperclips, coins) to prevent shorting.
- Li-Ion BATTERY MUST BE RECYCLED OR DISPOSED OF PROPERLY.**
Do not short, incinerate or open battery.

Cleaning the Nozzle

- Remove the Nozzle Cap from the Nozzle Head on the Spray Wand.
- Push a small pin or wire through the exposed holes in the Nozzle Head to remove accumulated dirt and debris, then flush with clean water.
- Wipe the Nozzle Head with a clean, dry cloth and reattach the Nozzle Cap to the Nozzle Head.

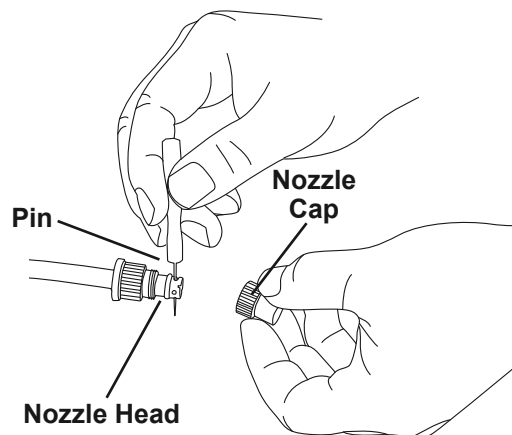

Figure F

Seal Replacement

1. Six replacement seals are included with the Sprayer. It may become necessary to replace the seals in the Spray Wand at some point, as they can become hard and damaged over time, causing leaks to occur.
2. Before replacing seals, thoroughly clean the Sprayer as described on page 8. Refer to Figure G for seal location and placement. Replace seals when needed to correct any leaks that appear.

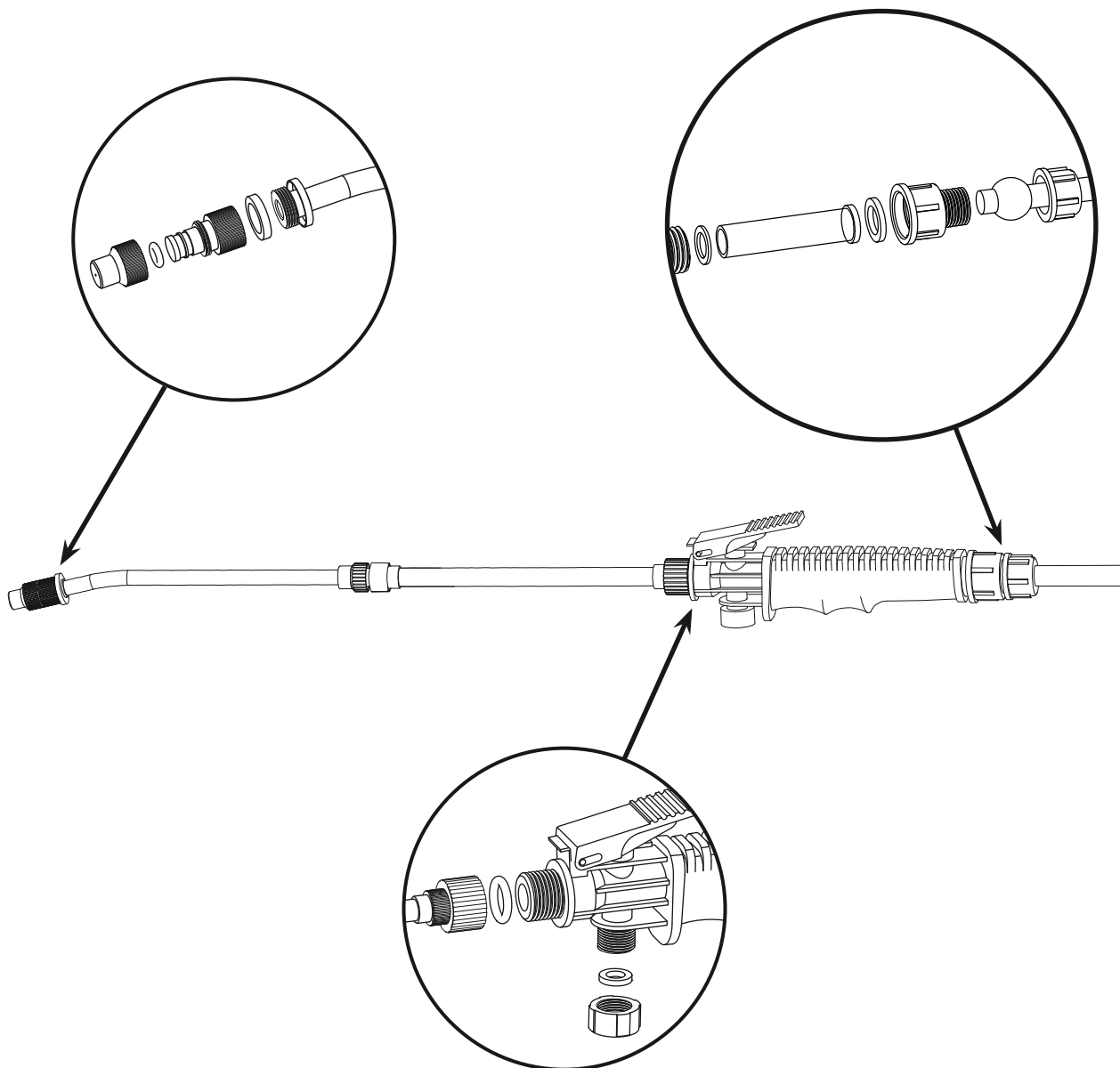

Figure G

SAFETY

SETUP

OPERATION

MAINTENANCE

PLEASE READ THE FOLLOWING CAREFULLY

THE MANUFACTURER AND/OR DISTRIBUTOR HAS PROVIDED THE PARTS LIST AND ASSEMBLY DIAGRAM IN THIS MANUAL AS A REFERENCE TOOL ONLY. NEITHER THE MANUFACTURER OR DISTRIBUTOR MAKES ANY REPRESENTATION OR WARRANTY OF ANY KIND TO THE BUYER THAT HE OR SHE IS QUALIFIED TO MAKE ANY REPAIRS TO THE PRODUCT, OR THAT HE OR SHE IS QUALIFIED TO REPLACE ANY PARTS OF THE PRODUCT. IN FACT, THE MANUFACTURER AND/OR DISTRIBUTOR EXPRESSLY STATES THAT ALL REPAIRS AND PARTS REPLACEMENTS SHOULD BE UNDERTAKEN BY CERTIFIED AND LICENSED TECHNICIANS, AND NOT BY THE BUYER. THE BUYER ASSUMES ALL RISK AND LIABILITY ARISING OUT OF HIS OR HER REPAIRS TO THE ORIGINAL PRODUCT OR REPLACEMENT PARTS THERETO, OR ARISING OUT OF HIS OR HER INSTALLATION OF REPLACEMENT PARTS THERETO.

Parts List

Part	Description	Qty
1	Spray Wand Assembly	1
2	Handle Assembly	1
3	Spray Wand Hose	1
4	Screw	16
5	Screw	2
6	Two-Piece Housing	1
7	Battery Housing	1
8	PCBA	1
9	Seal Strip	1
10	Metal Latch	2
11	Tank	1
12	Bottom Plate	1
13	Pump Assembly	1
14	Hose Clip	2
15	Pump Hose	2
16	Pump Hose Clip	2

Part	Description	Qty
17	Pump Assembly Connector	1
18	ON/OFF Switch	1
19	Internal Wire 1	1
20	Internal Wire 2	1
21	O-Ring	1
22	Pressure Sensor	1
23	Cup Seal Ring	1
24	O-Ring	1
25	Suction Tube	1
26	Filter	1
27	Block	1
28	Check Valve	1
29	Measuring Cup	1
30	Measuring Cup Seal Ring	1
31	Carry Strap	1
32	Replacement Seals (not shown)	6

Record Product's Serial Number Here: _____

Note: If product has no serial number, record month and year of purchase instead.

Note: Some parts are listed and shown for illustration purposes only, and are not available individually as replacement parts.

Assembly Diagram

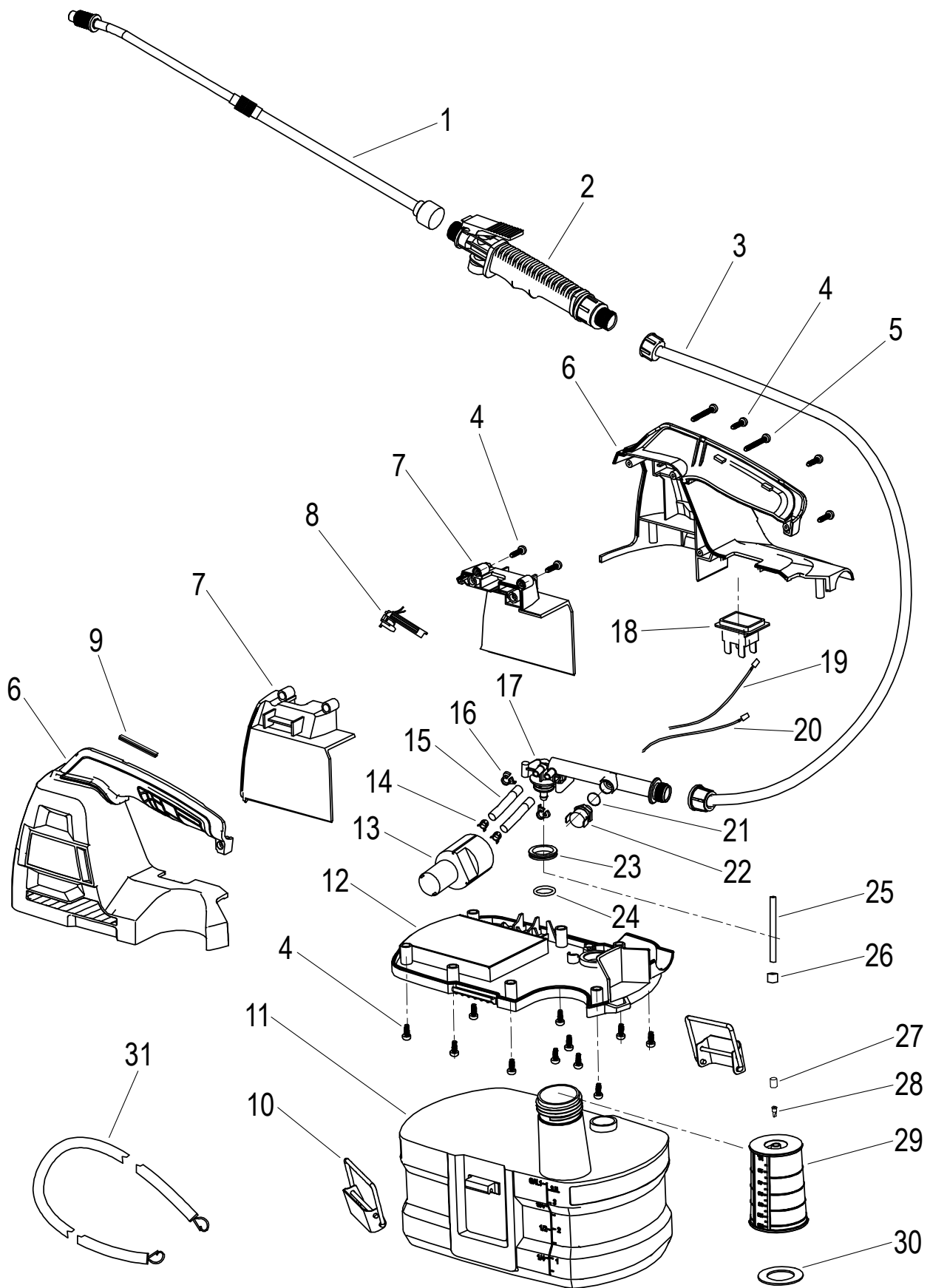

SAFETY

SETUP

OPERATION

MAINTENANCE

Limited 90 Day Warranty

Harbor Freight Tools Co. makes every effort to assure that its products meet high quality and durability standards, and warrants to the original purchaser that this product is free from defects in materials and workmanship for the period of 90 days from the date of purchase. This warranty does not apply to damage due directly or indirectly, to misuse, abuse, negligence or accidents, repairs or alterations outside our facilities, criminal activity, improper installation, normal wear and tear, or to lack of maintenance. We shall in no event be liable for death, injuries to persons or property, or for incidental, contingent, special or consequential damages arising from the use of our product. Some states do not allow the exclusion or limitation of incidental or consequential damages, so the above limitation of exclusion may not apply to you. THIS WARRANTY IS EXPRESSLY IN LIEU OF ALL OTHER WARRANTIES, EXPRESS OR IMPLIED, INCLUDING THE WARRANTIES OF MERCHANTABILITY AND FITNESS.

To take advantage of this warranty, the product or part must be returned to us with transportation charges prepaid. Proof of purchase date and an explanation of the complaint must accompany the merchandise. If our inspection verifies the defect, we will either repair or replace the product at our election or we may elect to refund the purchase price if we cannot readily and quickly provide you with a replacement. We will return repaired products at our expense, but if we determine there is no defect, or that the defect resulted from causes not within the scope of our warranty, then you must bear the cost of returning the product.

This warranty gives you specific legal rights and you may also have other rights which vary from state to state.

Bauer[™]

26541 Agoura Road • Calabasas, CA 91302 • 1-888-866-5797