

Owner's Manual & Safety Instructions

Save This Manual Keep this manual for the safety warnings and precautions, assembly, operating, inspection, maintenance and cleaning procedures. Write the product's serial number in the back of the manual near the assembly diagram (or month and year of purchase if product has no number). Keep this manual and the receipt in a safe and dry place for future reference.

21e



SPOT LIGHT

LOW VOLTAGE



Visit our website at: <http://www.harborfreight.com>
Email our technical support at: productsupport@harborfreight.com

57686

When unpacking, make sure that the product is intact and undamaged. If any parts are missing or broken, please call 1-888-866-5797 as soon as possible.

Copyright© 2020 by Harbor Freight Tools®. All rights reserved.

No portion of this manual or any artwork contained herein may be reproduced in any shape or form without the express written consent of Harbor Freight Tools. Diagrams within this manual may not be drawn proportionally. Due to continuing improvements, actual product may differ slightly from the product described herein. Tools required for assembly and service may not be included.

⚠WARNING

Read this material before using this product. Failure to do so can result in serious injury. **SAVE THIS MANUAL.**

IMPORTANT SAFETY INFORMATION

INSTRUCTIONS PERTAINING TO A RISK OF FIRE OR INJURY TO PERSONS IMPORTANT SAFETY INSTRUCTIONS

SAVE THESE INSTRUCTIONS

Lighted lamp is HOT!

1. **WARNING - To reduce the risk of FIRE OR INJURY TO PERSONS:**
 - a. Turn off/unplug and allow to cool before replacing lamp.
 - b. Lamp gets HOT quickly! Contact only switch/plug when turning on.
 - c. Do not touch hot lens, guard, or enclosure.
 - d. Keep lamp away from materials that may burn.
 - e. Do not touch the lamp at any time. Use a soft cloth. Oil from skin may damage lamp.
 - f. Do not operate the luminaire fitting with a missing or damaged shield.
2. Install all luminaires 10 feet (3.05m) or more from a pool, spa, or fountain.
3. Install in accordance with local codes and ordinances.
4. Do not apply pressure to lens when installing.
5. Install light securely into the ground prior to use.
6. Assemble only according to these instructions. Improper assembly can create hazards.
7. Wear ANSI-approved safety goggles during installation.
8. Keep assembly area clean and well lit.
9. Keep bystanders out of the area during assembly.
10. Do not assemble when tired or when under the influence of drugs or medication.
11. This product is not a toy. Do not allow children to play with or near this item.
12. Use as intended only.
13. Inspect before every use; do not use if parts are loose or damaged, or if sharp edges are exposed. This is fragile and sharp edges may be exposed if weathered or damaged.
14. Maintain product labels and nameplates. These carry important safety information. If unreadable or missing, contact Harbor Freight Tools for a replacement.

Specifications

Electrical Rating	12VAC / 60Hz / 20W
Wire Requirement	12-18AWG 2-Conductor Low Voltage Landscape (sold separately)
Replacement Bulb	Halogen 20W Max

Landscape Cable Selection Guide

This data is provided as a general guideline.

12 VOLT TAP	Cable Length		
	0 - 50 feet	51 - 100 feet	101 - 150 feet
Total Fixture Wattage			
0-60 Watts	18 AWG	16 AWG	14 AWG
61 - 120 Watts	16 AWG	14 AWG	12 AWG
121 - 180 Watts	14 AWG	12 AWG	Not Recommended
181 - 240 Watts	14 AWG	12 AWG	Not Recommended
241 - 300 Watts	12 AWG	Not Recommended	Not Recommended
600W Transformer (2 x 300) Watts	12 AWG	Not Recommended	Not Recommended
900W Transformer (3 X 300) Watts	12 AWG	Not Recommended	Not Recommended

15 VOLT TAP	Cable Length		
	0 - 50 feet	51 - 100 feet	101 - 150 feet
Total Fixture Wattage			
0-60 Watts	16 AWG*	16 AWG	16 AWG
61 - 120 Watts	16 AWG*	16 AWG	12 AWG
121 - 180 Watts	14 AWG*	14 AWG	12 AWG
181 - 240 Watts	14 AWG*	14 AWG	12 AWG
241 - 300 Watts	12 AWG*	12 AWG	Not Recommended
600W Transformer (2 x 300) Watts	12 AWG*	12 AWG	Not Recommended
900W Transformer (3 X 300) Watts	12 AWG*	12 AWG	Not Recommended

Components

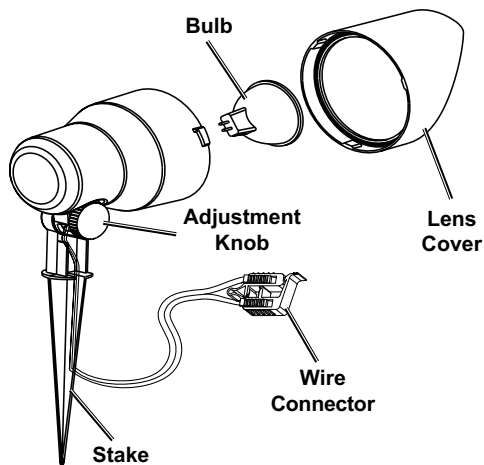

Installation Instructions

WARNING! TO PREVENT SERIOUS INJURY: Verify that installation surface has no hidden utility lines before installing light fixtures.

Main secondary wiring (landscape wire) is intended for shallow burial - less than 6 inches (152mm). Low voltage cable shall:

- a. be protected by routing in close proximity to the luminaire or fitting, or next to a building structure such as a house or deck;
 - b. not be buried except for a maximum 6 inches (15.2 cm) in order to connect to the main low voltage cable; and
 - c. have the length cut off so that it is connected to a connector within 6 inches (15.2 cm) from a building structure, a luminaire, or fitting.
1. Lay out Light Fixtures in desired locations. The first Light Fixture must be installed at least 10 feet from power unit.
 2. Unplug power unit (sold separately) and lay out landscape wire (sold separately) from power unit along path of Light Fixtures.

3. Installing:

WARNING - To reduce the risk of FIRE OR INJURY TO PERSONS: Keep away from combustibles.

- a. Loosen soil as necessary.
- b. Drive stake with rubber mallet.
- c. Remove Adjustment Knob.
- d. Attach Light Fixture.
- e. Replace Adjustment Knob.

4. Wiring:

- a. Open Wire Connector, place landscape wire in Connector's jaw.
- b. Close Wire Connector so that contact pins pierce both wires.

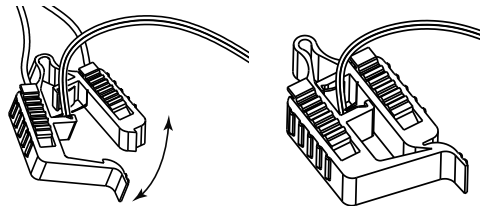

- c. At end of run, cut off excess wire.

5. Adjusting Angle:

- a. Loosen Adjustment Knob.
 - b. Adjust angle.
 - c. Tight Adjustment Knob.
6. Plug in power unit.

Maintenance

Cleaning and Maintenance

1. **CLEAN PERIODICALLY** with a damp towel. Do not clean with chemicals, solvents or harsh abrasives. Do not put too much pressure on the Light Fixture while cleaning.
2. **PERIODICALLY**, inspect the general condition of the Light Fixture. Check for:
 - loose hardware,
 - misalignment or binding of parts,
 - cracked or broken parts, and
 - any other condition that may affect its safe operation.

Bulb Replacement

1. Turn Lens Cover counterclockwise to remove.
2. **Do not hold Bulb with fingers, oil from skin may damage bulb.** Hold bulb with soft cloth and insert into socket.
3. Replace Lens Cover.

Troubleshooting

Problem	Possible Causes	Probable Solutions
Light Fixture will not turn on	<ol style="list-style-type: none">1. No power.2. Bad bulb.3. Disconnection or break in landscape wire.4. Too many Light Fixtures connected to transformer.	<ol style="list-style-type: none">1. Check power is on and power unit is connected to 120VAC GFCI outlet.2. Replace bulb.3. Check for loose connection at power unit's screw terminal.4. Remove some Light Fixtures or replace wire with heavier gauge.
Only some Light Fixtures work	<ol style="list-style-type: none">1. Bad bulb.2. Bad connection at Light Fixture.3. Faulty Light Fixture.	<ol style="list-style-type: none">1. Replace bulb.2. Check that connector pins have pierced both wires.3. Replace Light Fixture.



Follow all safety precautions whenever diagnosing or servicing the tool. Disconnect power supply before service

PLEASE READ THE FOLLOWING CAREFULLY

THE MANUFACTURER AND/OR DISTRIBUTOR HAS PROVIDED THE PARTS LIST AND ASSEMBLY DIAGRAM IN THIS MANUAL AS A REFERENCE TOOL ONLY. NEITHER THE MANUFACTURER OR DISTRIBUTOR MAKES ANY REPRESENTATION OR WARRANTY OF ANY KIND TO THE BUYER THAT HE OR SHE IS QUALIFIED TO MAKE ANY REPAIRS TO THE PRODUCT, OR THAT HE OR SHE IS QUALIFIED TO REPLACE ANY PARTS OF THE PRODUCT. IN FACT, THE MANUFACTURER AND/OR DISTRIBUTOR EXPRESSLY STATES THAT ALL REPAIRS AND PARTS REPLACEMENTS SHOULD BE UNDERTAKEN BY CERTIFIED AND LICENSED TECHNICIANS, AND NOT BY THE BUYER. THE BUYER ASSUMES ALL RISK AND LIABILITY ARISING OUT OF HIS OR HER REPAIRS TO THE ORIGINAL PRODUCT OR REPLACEMENT PARTS THERETO, OR ARISING OUT OF HIS OR HER INSTALLATION OF REPLACEMENT PARTS THERETO.

Parts List and Diagram

Parts List

Part	Description	Qty
1	Lens Cover	1
2	Lens	1
3	Seal	1
4	Light Board	1
5	Screw	4
6	Reflector	1
7	Thumb Screw	1
8	Spike	1
9	Light	1
10	Wire	1
11	Connector (not shown)	1
12	Halogen Bulb, 20W (not shown)	1

Diagram

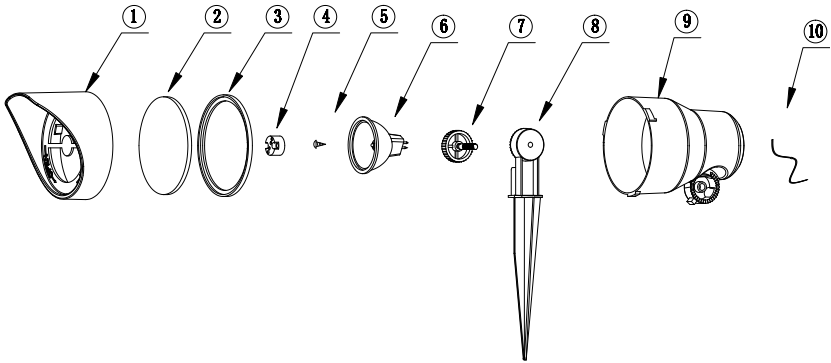

Record Serial Number Here: _____

Note: If product has no serial number, record month and year of purchase instead.

Note: Some parts are listed and shown for illustration purposes only, and are not available individually as replacement parts. Specify UPC 193175421173 when ordering parts.

Limited 90 Day Warranty

Harbor Freight Tools Co. makes every effort to assure that its products meet high quality and durability standards, and warrants to the original purchaser that this product is free from defects in materials and workmanship for the period of 90 days from the date of purchase. This warranty does not apply to damage due directly or indirectly, to misuse, abuse, negligence or accidents, repairs or alterations outside our facilities, criminal activity, improper installation, normal wear and tear, or to lack of maintenance. We shall in no event be liable for death, injuries to persons or property, or for incidental, contingent, special or consequential damages arising from the use of our product. Some states do not allow the exclusion or limitation of incidental or consequential damages, so the above limitation of exclusion may not apply to you. THIS WARRANTY IS EXPRESSLY IN LIEU OF ALL OTHER WARRANTIES, EXPRESS OR IMPLIED, INCLUDING THE WARRANTIES OF MERCHANTABILITY AND FITNESS.

To take advantage of this warranty, the product or part must be returned to us with transportation charges prepaid. Proof of purchase date and an explanation of the complaint must accompany the merchandise. If our inspection verifies the defect, we will either repair or replace the product at our election or we may elect to refund the purchase price if we cannot readily and quickly provide you with a replacement. We will return repaired products at our expense, but if we determine there is no defect, or that the defect resulted from causes not within the scope of our warranty, then you must bear the cost of returning the product.

This warranty gives you specific legal rights and you may also have other rights which vary from state to state.

