

Owner's Manual & Safety Instructions

Save This Manual Keep this manual for the safety warnings and precautions, assembly, operating, inspection, maintenance and cleaning procedures. Write the product's serial number in the back of the manual (or month and year of purchase if product has no number). Keep this manual and the receipt in a safe and dry place for future reference.

22b

HAULMASTER®

STEEL MOTORCYCLE CARRIER



Visit our website at: <http://www.harborfreight.com>
Email our technical support at: productsupport@harborfreight.com

57720

When unpacking, make sure that the product is intact and undamaged. If any parts are missing or broken, please call 1-888-866-5797 as soon as possible.

Copyright© 2015 by Harbor Freight Tools®. All rights reserved.

No portion of this manual or any artwork contained herein may be reproduced in any shape or form without the express written consent of Harbor Freight Tools. Diagrams within this manual may not be drawn proportionally. Due to continuing improvements, actual product may differ slightly from the product described herein. Tools required for assembly and service may not be included.

⚠ WARNING

**Read this material before using this product.
Failure to do so can result in serious injury.
SAVE THIS MANUAL.**

Table of Contents

Safety	2	Maintenance	8
Assembly	4	Parts List and Diagram	10
Operation	6	Warranty	12



WARNING SYMBOLS AND DEFINITIONS

	This is the safety alert symbol. It is used to alert you to potential personal injury hazards. Obey all safety messages that follow this symbol to avoid possible injury or death.
	Indicates a hazardous situation which, if not avoided, will result in death or serious injury.
	Indicates a hazardous situation which, if not avoided, could result in death or serious injury.
	Indicates a hazardous situation which, if not avoided, could result in minor or moderate injury.
	Addresses practices not related to personal injury.

IMPORTANT SAFETY INFORMATION



WARNING Read all safety warnings and instructions. *Failure to follow the warnings and instructions may result in serious injury.*

Save all warnings and instructions for future reference

General Safety Information

- Work area safety**
 - Keep work area clean and well lit.** *Cluttered or dark areas invite accidents.*
 - Keep children and bystanders away during use.** *Distractions can cause you to lose control.*
- Personal safety**
 - Stay alert, watch what you are doing and use common sense during use. Do not use while you are tired or under the influence of drugs, alcohol or medication.** *A moment of inattention during use may result in serious personal injury.*
 - Use personal protective equipment. Always wear eye protection.** *Safety equipment such as dust mask, non-skid safety shoes, or hearing protection used for appropriate conditions will reduce personal injuries.*
- Do not overreach. Keep proper footing and balance at all times.** *This enables better control of the product in unexpected situations.*
- Dress properly. Do not wear loose clothing or jewelry. Keep your hair, clothing and gloves away from moving parts.** *Loose clothes, jewelry or long hair can be caught in moving parts.*
- Only use safety equipment that has been approved by an appropriate standards agency.** *Unapproved safety equipment may not provide adequate protection. Eye protection must be ANSI-approved.*
- Carrier use and care**
 - Store the Carrier out of the reach of children and do not allow persons unfamiliar with the it or these instructions to operate.** *Equipment is dangerous in the hands of untrained users.*

b. **Maintain the Carrier. Check for misalignment or binding parts, breakage of parts and any other condition that may affect operation. If damaged, have the product repaired before use. Many accidents are caused by poorly maintained products.**

4. Use the Carrier in accordance with these instructions, taking into account the working conditions and the work to be performed. Use of this equipment for operations different from those intended could result in a hazardous situation.

Motorcycle Carrier Safety Information

1. Secure motorcycle frame and wheels securely using ratcheting tie downs (not included) and included pins.
2. Push, do not drive, the motorcycle onto the Carrier.
3. Obey all DOT regulations pertaining to mounting the Carrier onto a vehicle.
4. Only use this product with a vehicle that has a 2" square receiver hitch, rated to Class III or Class IV, and can bear the additional weight of both the Carrier and motorcycle.
5. Do not sit on motorcycle while loading, unloading, or while supported on carrier.
6. Do not exceed maximum load for this product (600 lb.). Loading a heavier object on this product can result in dangerous conditions to both the operator and the item loaded.
7. Do not exceed 55 mph while carrier is attached to vehicle.
8. Turn off the vehicle's ignition and set the parking brake before installing, loading, or unloading Carrier.
9. Maintain labels and nameplates on the tool. These carry important safety information. If unreadable or missing, contact Harbor Freight Tools for a replacement.
10. Keep bystanders out of the area during assembly, loading and unloading.
11. The warnings, precautions, and instructions discussed in this instruction manual cannot cover all possible conditions and situations that may occur. It must be understood by the operator that common sense and caution are factors which cannot be built into this product, but must be supplied by the operator.



SAVE THESE INSTRUCTIONS.

Specifications

Weight Capacity	600 lb
Motorcycle Platform Size	78-3/4" X 8"
Receiver Size	2"
Platform Thickness	12 Gauge (0.109")

Assembly Instructions



Read the **ENTIRE IMPORTANT SAFETY INFORMATION** section at the beginning of this manual including all text under subheadings therein before set up or use of this product.

Note: For additional information regarding the parts listed in the following pages, refer to *Parts List and Diagram* on page 10.

Components

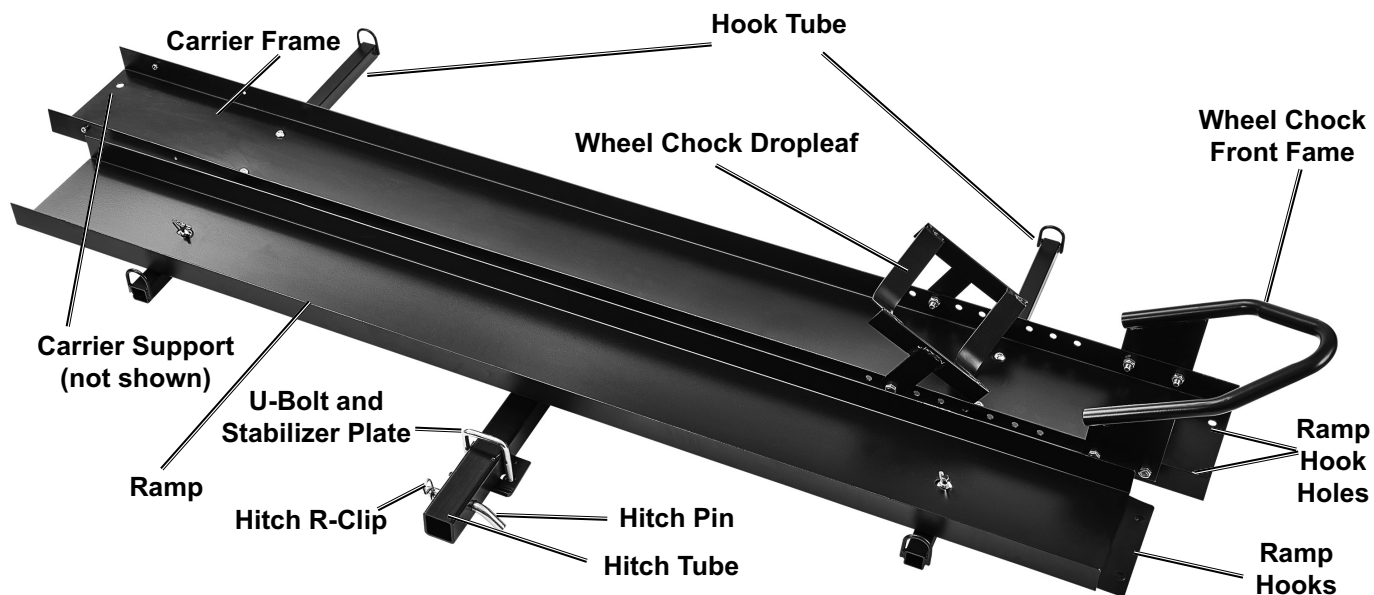

Carrier Assembly

1. Secure the Hitch Tube (12) to Carrier Frame (6) with six Hex Bolts (5) and six Nuts (4). See Figure A.
3. Attach Wheel Chock Dropleaf (2) to Carrier Frame (6) with two Hex Bolts (5) and two Nut (4). Install Dropleaf according to tire size. See Figure C.

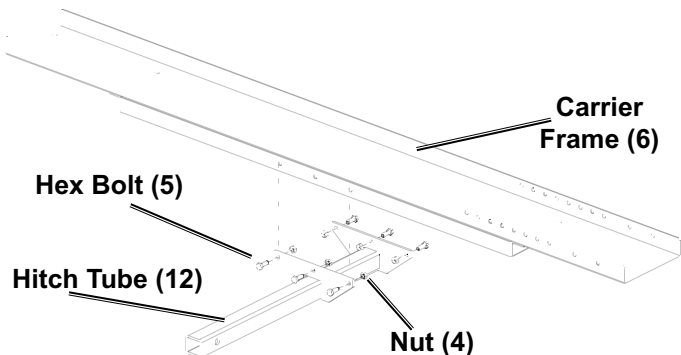

Figure A: Hitch Tube Installation

2. Attach Wheel Chock Front Frame (1) to Carrier Frame (6) with four Hex Bolts (5) and four Nuts (4). See Figure B.

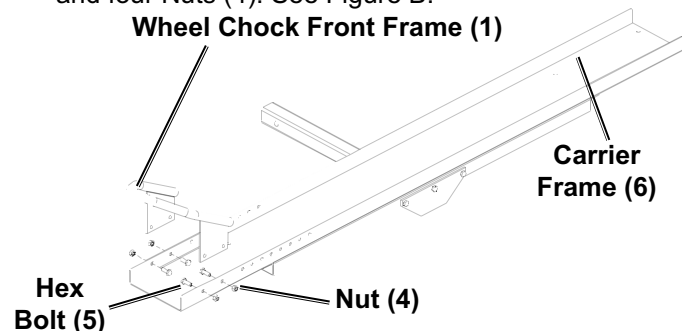

Figure B: Wheel Chock Front Frame Attachment

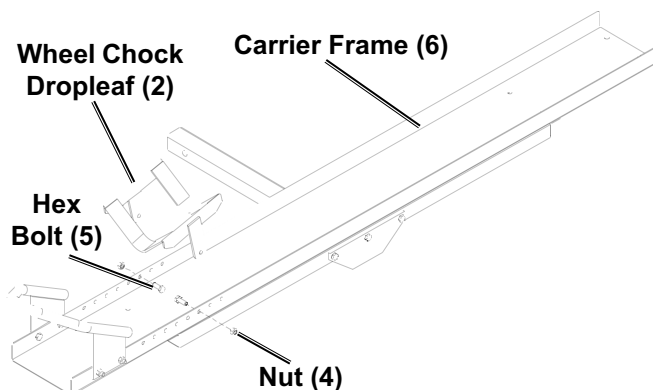

Figure C: Wheel Chock Dropleaf Attachment

- Attach both Hook Tubes (8) to the Carrier Frame (6) using two Round Head Bolts (7) and two Nuts (4) for each Hook Tube (8). See Figure D.

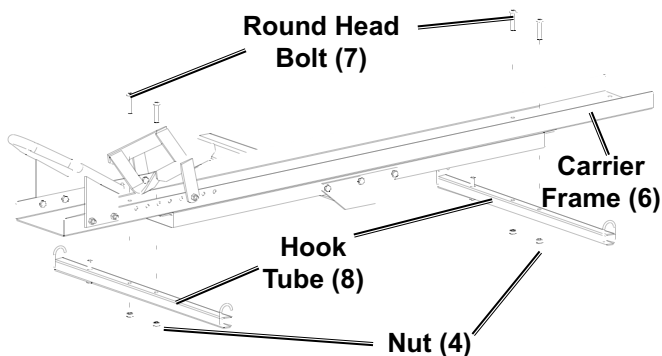

Figure D: Hook Tube Installation

- Attach Ramp (3) to Hook Tubes (8) with Wing Nut (9), Washer (10) and Nylon Washer (11). Secure each side of Ramp (3) with R-Clip (15). See Figure E.

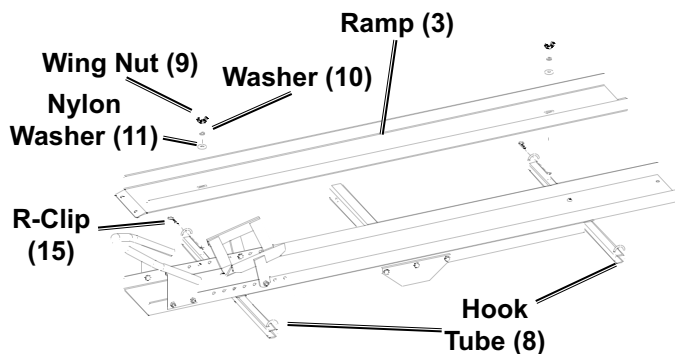

Figure E: Ramp Attachment

Mounting to Hitch Receiver

Warning! TO PREVENT SERIOUS INJURY: Turn off the vehicle's ignition and set the parking brake before installing, loading, or unloading Carrier.

- Secure Stabilizer Plate (17) and U-Bolt (16) around Hitch Tube (12) using two sets of Nuts, Spring Washers, and Flat Washers (18). See Figure F.

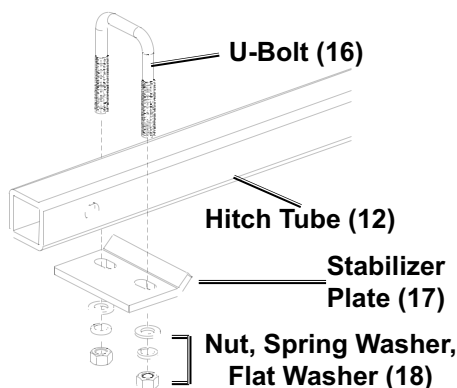

Figure F: Stabilizer Plate Assembly

- Insert Hitch Tube into the hitch receiver (not included) of vehicle.

- Insert Hitch Pin (13) through Hole in Hitch Tube. Secure Hitch Pin with Hitch R-Clip (14). See Figure G.

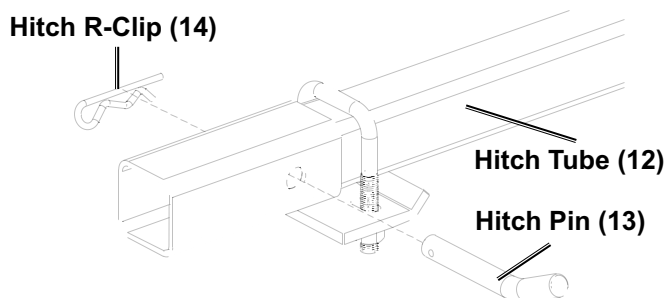

Figure G: Securing Carrier to Hitch Receiver

- Tighten Nuts (18) on U-Bolt (16). DO NOT OVER TIGHTEN. Nuts should not exceed 20 ft. lb. of torque.

Note: The stabilizer plate assembly will take up tolerances in the product, but will NOT prevent all movement.

Note: A light kit (such as Kenway 64275, sold separately) must be installed on this hitch-mounted carrier if your cargo blocks the license plate and/or tail lights on your vehicle. Please review your state or local laws regarding tail lights and license plates for required location and lighting.

Operation Instructions



Read the **ENTIRE IMPORTANT SAFETY INFORMATION** section at the beginning of this manual including all text under subheadings therein before set up or use of this product.

⚠ WARNING

TO PREVENT SERIOUS INJURY:

Turn off vehicle and engage parking break before loading or unloading carrier.

Loading

1. Remove R-Clips (15), Wing Nuts (9), Plate Washers (10) and Nylon Washers (11) from each side of the Ramp (3). See Figure H.

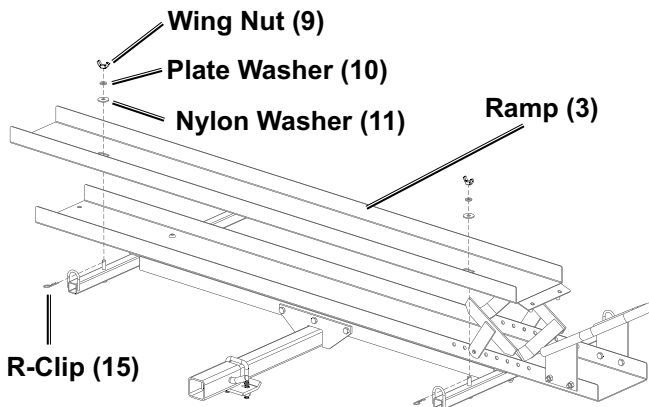

Figure H: Unlocking Ramp

2. Remove Ramp (3) and place end rung onto Carrier Frame (6).
3. Open the Wheel Chock Dropleaf (2). See Figure I.

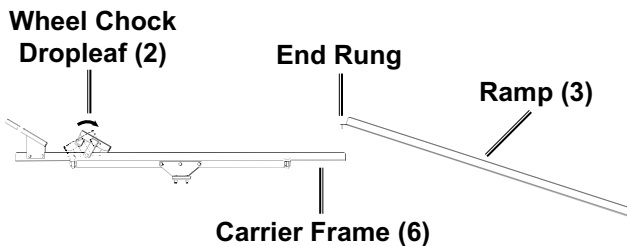

Figure I: Loading Position

Warning! To Prevent Serious Injury: Use two people to push motorcycle onto Carrier Frame. Do not drive motorcycle onto Carrier Frame.

4. Shift motorcycle into neutral and, with another person's assistance, push motorcycle up Ramp (3) and onto Carrier Frame (6). See Figure J.

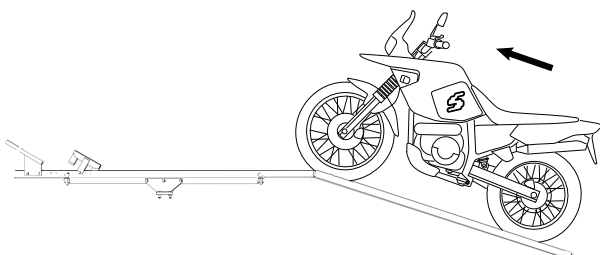

Figure J: Loading Motorcycle

5. Push the motorcycle until the front wheel rests between Wheel Chock Front Frame (1) and Wheel Chock Dropleaf (2). See Figure K.

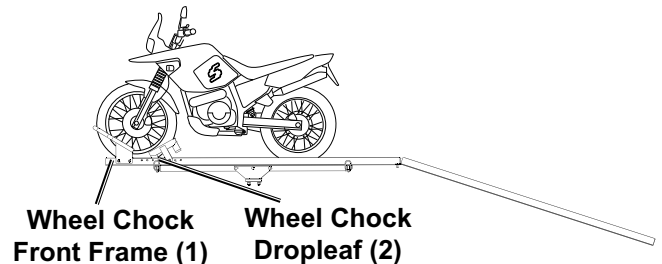

Figure K: Loaded Motorcycle

6. Secure motorcycle with straps to the holes on Hook Tube (8). See Figure L.

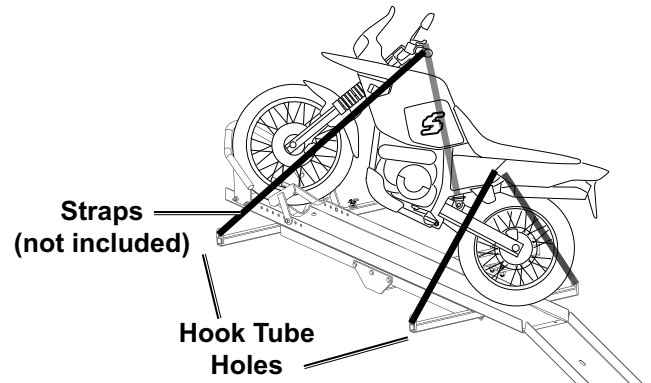

Figure L: Securing Motorcycle

7. Return Ramp (3) to mounted position and secure with R-Clip (15), Wing Nut (9), Plate Washer (10) and Nylon Washer (11) to lock Ramp (3).

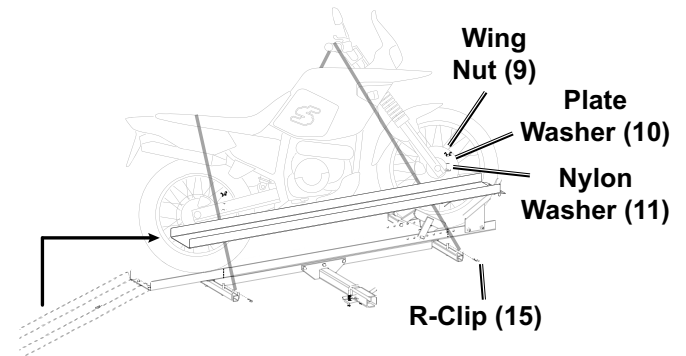

Figure M: Securing Ramp

8. Check that motorcycle and ramp are both secured before transporting.

Unloading

1. Remove R-Clips (15), Wing Nuts (9), Plate Washers (10) and Nylon Washer (11) to remove Ramp (3) from its secured position. See Figure H on page 6.
2. Remove Ramp (3) and insert the Ramp Hooks into the Ramp Hook Holes located at the edge of the Carrier Frame (6). See Figure I on page 6.

Warning! To Prevent Serious Injury: Use two people to unload motorcycle from Carrier Frame. Do not drive motorcycle off of Carrier Frame.

3. Have one person support motorcycle to prevent movement. Have another person release tension on all tie-downs.
4. Open Wheel Chock Dropleaf (2).
5. Set motorcycle into Neutral gear. With assistance, slowly push motorcycle down Ramp (3) and off Carrier Frame (6).
6. Return Ramp to mounted position and secure with R-Clip (15), Wing Nut (9), Plate Washer (10), Nylon Washer (11). See Figure M on page 6.



Maintenance and Servicing



Procedures not specifically explained in this manual must be performed only by a qualified technician.

WARNING

TO PREVENT SERIOUS INJURY FROM PRODUCT FAILURE:
Do not use damaged equipment.

Cleaning, Maintenance, and Lubrication

1. **BEFORE EACH USE**, inspect the general condition of the tool. Check for:
 - loose hardware,
 - misalignment or binding of moving parts,
 - cracked or broken parts, and
 - any other condition that may affect its safe operation.
2. **AFTER USE**, wipe external surfaces of the tool with clean cloth.

PLEASE READ THE FOLLOWING CAREFULLY

THE MANUFACTURER AND/OR DISTRIBUTOR HAS PROVIDED THE PARTS LIST AND ASSEMBLY DIAGRAM IN THIS MANUAL AS A REFERENCE TOOL ONLY. NEITHER THE MANUFACTURER OR DISTRIBUTOR MAKES ANY REPRESENTATION OR WARRANTY OF ANY KIND TO THE BUYER THAT HE OR SHE IS QUALIFIED TO MAKE ANY REPAIRS TO THE PRODUCT, OR THAT HE OR SHE IS QUALIFIED TO REPLACE ANY PARTS OF THE PRODUCT. IN FACT, THE MANUFACTURER AND/OR DISTRIBUTOR EXPRESSLY STATES THAT ALL REPAIRS AND PARTS REPLACEMENTS SHOULD BE UNDERTAKEN BY CERTIFIED AND LICENSED TECHNICIANS, AND NOT BY THE BUYER. THE BUYER ASSUMES ALL RISK AND LIABILITY ARISING OUT OF HIS OR HER REPAIRS TO THE ORIGINAL PRODUCT OR REPLACEMENT PARTS THERETO, OR ARISING OUT OF HIS OR HER INSTALLATION OF REPLACEMENT PARTS THERETO.

SAFETY

ASSEMBLY

OPERATION

MAINTENANCE

Record Product's Serial Number Here: _____

Note: If product has no serial number, record month and year of purchase instead.

Note: Some parts are listed and shown for illustration purposes only, and are not available individually as replacement parts. Specify UPC 193175421548 when ordering parts.

Parts List and Diagram

SAFETY

ASSEMBLY

OPERATION

MAINTENANCE

Part	Description	Qty
1	Wheel Chock Front Frame	1
2	Wheel Chock Dropleaf	1
3	Ramp	1
4	Nylon Nut, M10	16
5	Hex Bolt, M10X25	12
6	Carrier Frame	1
7	Round Head Bolt, M10X50	4
8	Hook Tube	2
9	Wing Nut	2
10	Plate Washer	2

Part	Description	Qty
11	Nylon Washer	2
12	Hitch Tube	1
13	Hitch Pin	1
14	Hitch R-Clip	1
15	R-Clip	2
16	U-bolt	1
17	Stabilizer Plate	1
18	Nut M12, Spring Washer, Flat Washer Set	2

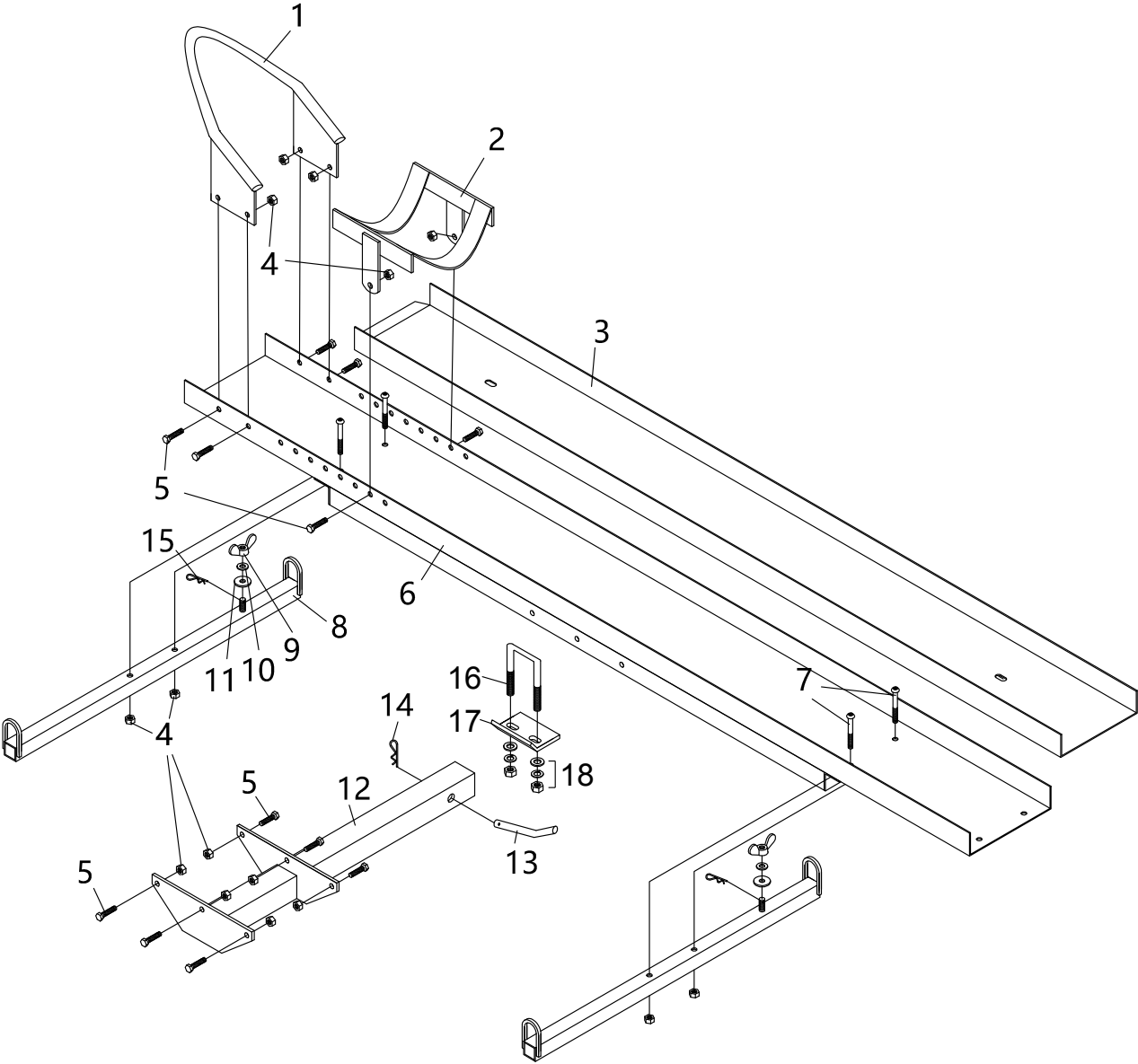

Limited 90 Day Warranty

Harbor Freight Tools Co. makes every effort to assure that its products meet high quality and durability standards, and warrants to the original purchaser that this product is free from defects in materials and workmanship for the period of 90 days from the date of purchase. This warranty does not apply to damage due directly or indirectly, to misuse, abuse, negligence or accidents, repairs or alterations outside our facilities, criminal activity, improper installation, normal wear and tear, or to lack of maintenance. We shall in no event be liable for death, injuries to persons or property, or for incidental, contingent, special or consequential damages arising from the use of our product. Some states do not allow the exclusion or limitation of incidental or consequential damages, so the above limitation of exclusion may not apply to you. THIS WARRANTY IS EXPRESSLY IN LIEU OF ALL OTHER WARRANTIES, EXPRESS OR IMPLIED, INCLUDING THE WARRANTIES OF MERCHANTABILITY AND FITNESS.

To take advantage of this warranty, the product or part must be returned to us with transportation charges prepaid. Proof of purchase date and an explanation of the complaint must accompany the merchandise. If our inspection verifies the defect, we will either repair or replace the product at our election or we may elect to refund the purchase price if we cannot readily and quickly provide you with a replacement. We will return repaired products at our expense, but if we determine there is no defect, or that the defect resulted from causes not within the scope of our warranty, then you must bear the cost of returning the product.

This warranty gives you specific legal rights and you may also have other rights which vary from state to state.



26677 Agoura Road • Calabasas, CA 91302 • 1-888-866-5797