

Owner's Manual & Safety Instructions

Save This Manual Keep this manual for the safety warnings and precautions, assembly, operating, inspection, maintenance and cleaning procedures. Write the product's serial number in the back of the manual near the assembly diagram (or month and year of purchase if product has no number). Keep this manual and the receipt in a safe and dry place for future reference.

23a

BauerTM

2021MH-B

1,300 LB CAPACITY STEEL SAWHORSE



Visit our website at: <http://www.harborfreight.com>
Email our technical support at: productsupport@harborfreight.com

57807

When unpacking, make sure that the product is intact and undamaged. If any parts are missing or broken, please call 1-888-866-5797 as soon as possible.

Copyright© 2022 by Harbor Freight Tools®. All rights reserved.
No portion of this manual or any artwork contained herein may be reproduced in any shape or form without the express written consent of Harbor Freight Tools. Diagrams within this manual may not be drawn proportionally. Due to continuing improvements, actual product may differ slightly from the product described herein. Tools required for assembly and service may not be included.

⚠ WARNING

Read this material before using this product.
Failure to do so can result in serious injury.
SAVE THIS MANUAL.

Specifications (per Sawhorse)

Height	24-1/4" - 32-1/8"
Width	42-3/4"
Maximum Weight Capacity	1,300 lb for each Sawhorse (must be used in pairs)

IMPORTANT SAFETY INFORMATION

1. This product is not a toy. Do not allow children to play with or near this item.
2. Use on flat, level, hard surface able to support load.
3. Wear ANSI-approved safety goggles during assembly and use.
4. Use as intended only. Use at least two sawhorses to support load.
5. Inspect before every use; do not use if parts loose or damaged.
6. Secure the workpiece to the sawhorses, if possible.
7. Do not exceed 1,300 lb weight capacity per Sawhorse. **Be aware of dynamic loading!** Sudden load movement may briefly create excess load causing product failure.
8. Use only on hard, level surfaces. Make sure legs are all properly extended and feet are securely placed on the floor.
9. Assemble only according to these instructions. Improper assembly can create hazards.
10. Wear ANSI-approved safety goggles and heavy-duty work gloves during assembly.
11. Keep assembly area clean and well lit.
12. Keep bystanders out of the area during assembly.
13. Do not assemble when tired or when under the influence of alcohol, drugs or medication.
14. Weight capacity and other product capabilities apply to properly and completely assembled product only.
15. Maintain product labels and nameplates. These carry important safety information. If unreadable or missing, contact Harbor Freight Tools for a replacement.
16. The warnings, cautions, and instructions discussed in this instruction manual cannot cover all possible conditions and situations that may occur. It must be understood by the operator that common sense and caution are factors which cannot be built into this product, but must be supplied by the operator.



SAVE THESE INSTRUCTIONS.

BauerTM

Operation



Read the **ENTIRE IMPORTANT SAFETY INFORMATION** section at the beginning of this manual including all text under subheadings therein before set up or use of this product.

⚠ WARNING

Inspect tool before use, looking for damaged, loose, and missing parts. If any problems are found, do not use tool until repaired.

Set Up

1. Lay the Sawhorse on the ground.

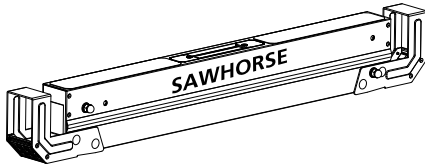

2. Above the location labeled "Open 1st" press the release button and pull Legs all the way down.

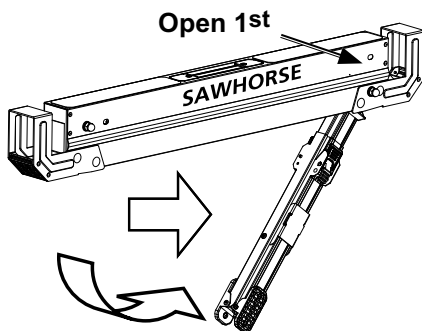

3. Separate Legs and push the Leg Locking Brace down flat.

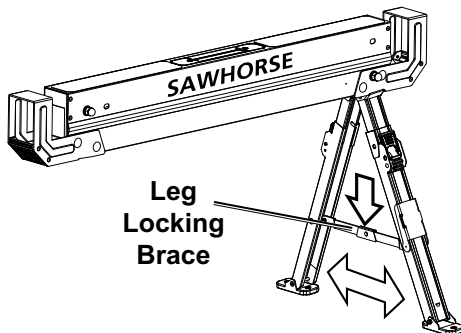

4. Above the location labeled "Close 1st" press the release button and pull Legs all the way down.

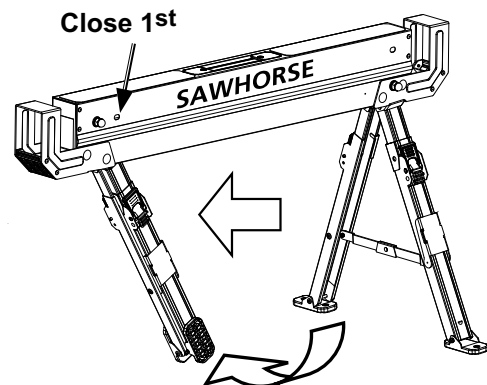

5. Separate Legs and push the Leg Locking Brace down flat, as done in Step 3.
6. Extend Legs as needed by pulling them down until the Latch is locked at the desired position. To retract legs, press the Latch button and pull Legs down slightly then push them up.

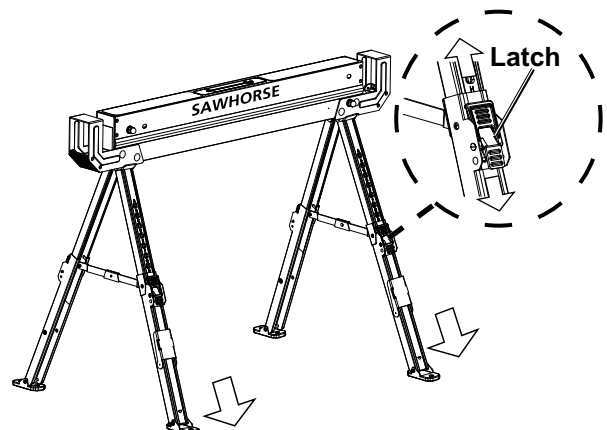

CAUTION! Be sure all lock pins and Latches are secure.

7. Carefully position the Sawhorse and place as needed.

8. When using two Sawhorses for a work table, use a 2 x 4 in the support arms to pair the two Sawhorses together. Fit each 2 x 4 end into the support arm openings at the end of the.

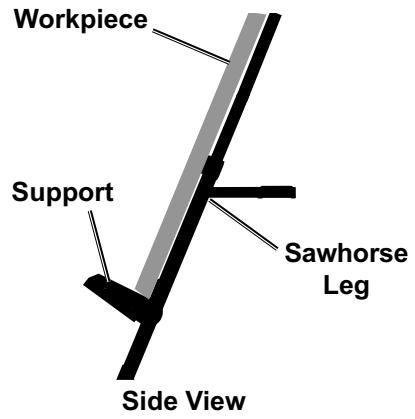
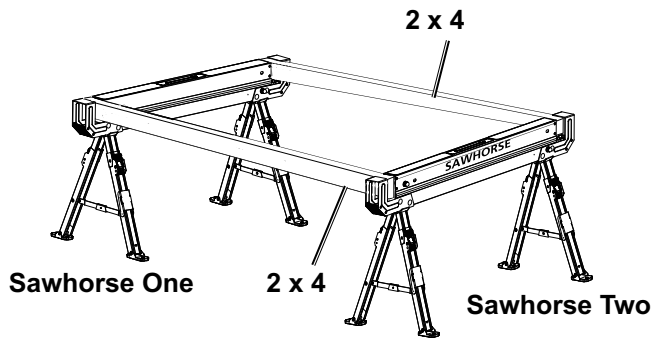

- b. Place Workpiece on Supports.

WARNING! TO AVOID SERIOUS INJURY: Check that each Sawhorse is positioned level and straight, and all legs have solid contact with the floor.

9. The side Supports may be pulled down and used to hold a Workpiece in place.

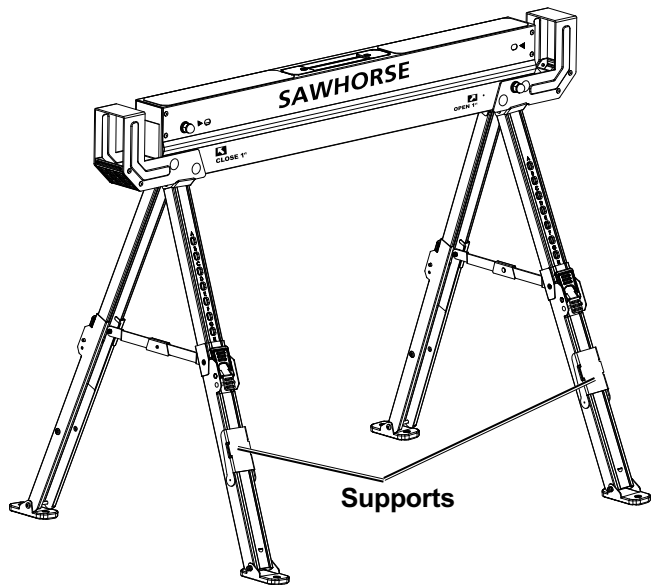

- a. Pull down Support on each Leg.

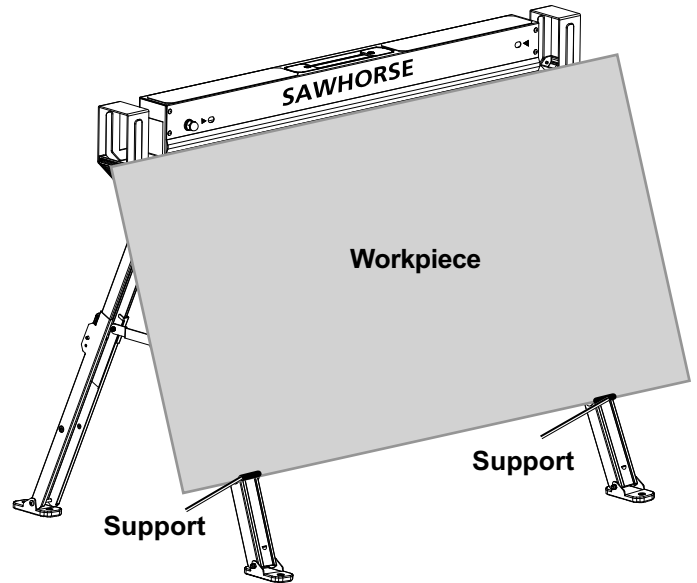

10. Before each use, confirm that:

- all Latches and lock pins are secure
- all Leg Locking Braces are secure
- all hardware is tight
- all legs have solid contact with the floor
- the Sawhorse is positioned level and straight.

Take Down

WARNING! TO PREVENT SERIOUS INJURY: Remove load before removing 2 x 4s or taking the Sawhorse down.

1. Reverse setup steps starting with the "Close 1st" Leg.

2. When fully collapsed, be sure all locking pins fully engage to secure the Sawhorse for transport.
3. Store Sawhorse in a clean, dry, safe location out of the reach of children.

Maintenance



Procedures not specifically explained in this manual must be performed only by a qualified technician.

⚠ WARNING

TO PREVENT SERIOUS INJURY FROM TOOL FAILURE:

Do not use damaged equipment. If damage is found, have the problem corrected before further use.

Cleaning, Maintenance, and Lubrication

1. **BEFORE EACH USE**, inspect the general condition of the tool. Check for:
 - loose hardware,
 - misalignment or binding of moving parts,
 - cracked or broken parts, and
 - any other condition that may affect its safe operation.
2. **AFTER USE**, wipe external surfaces of the tool with clean cloth.

PLEASE READ THE FOLLOWING CAREFULLY

THE MANUFACTURER AND/OR DISTRIBUTOR HAS PROVIDED THE PARTS LIST AND ASSEMBLY DIAGRAM IN THIS DOCUMENT AS A REFERENCE TOOL ONLY. NEITHER THE MANUFACTURER OR DISTRIBUTOR MAKES ANY REPRESENTATION OR WARRANTY OF ANY KIND TO THE BUYER THAT HE OR SHE IS QUALIFIED TO MAKE ANY REPAIRS TO THE PRODUCT, OR THAT HE OR SHE IS QUALIFIED TO REPLACE ANY PARTS OF THE PRODUCT. IN FACT, THE MANUFACTURER AND/OR DISTRIBUTOR EXPRESSLY STATES THAT ALL REPAIRS AND PARTS REPLACEMENTS SHOULD BE UNDERTAKEN BY CERTIFIED AND LICENSED TECHNICIANS, AND NOT BY THE BUYER. THE BUYER ASSUMES ALL RISK AND LIABILITY ARISING OUT OF HIS OR HER REPAIRS TO THE ORIGINAL PRODUCT OR REPLACEMENT PARTS THERETO, OR ARISING OUT OF HIS OR HER INSTALLATION OF REPLACEMENT PARTS THERETO.

Parts List and Diagram

Parts List

Part	Description	Qty
1	Socket Head Screw	1
2	Steel Side Cover	2
3	Worktop Laminate	2
4	Socket Head Screw	1
5	Worktop	1
6	2 x 4 Bracket	1
7	Washer	2
8	Spring Washer	2
9	Cap Nut	2
10	Spacer Long	4
11	Leg Link Block 1	1
12	Carriage Bolt	8
13	Leg Link Block 2	1
14	Spring	2
15	Alignment Pin	2
16	Locknut	2

Part	Description	Qty
17	Inside Leg Set	4
18	Locking Handle	4
19	Outside Leg Set	4
20	Support	2
21	Bolt	4
22	Foot	4
23	Locknut	4
24	Leg Locking Brace	2
25	Spacer Short	4
26	Hex Socket Screw	2
27	Clip	2
28	Side Cover	2
29	2 x 4 Bracket 2	1
30	Handle Cover	2
31	Handle	1

Assembly Diagram

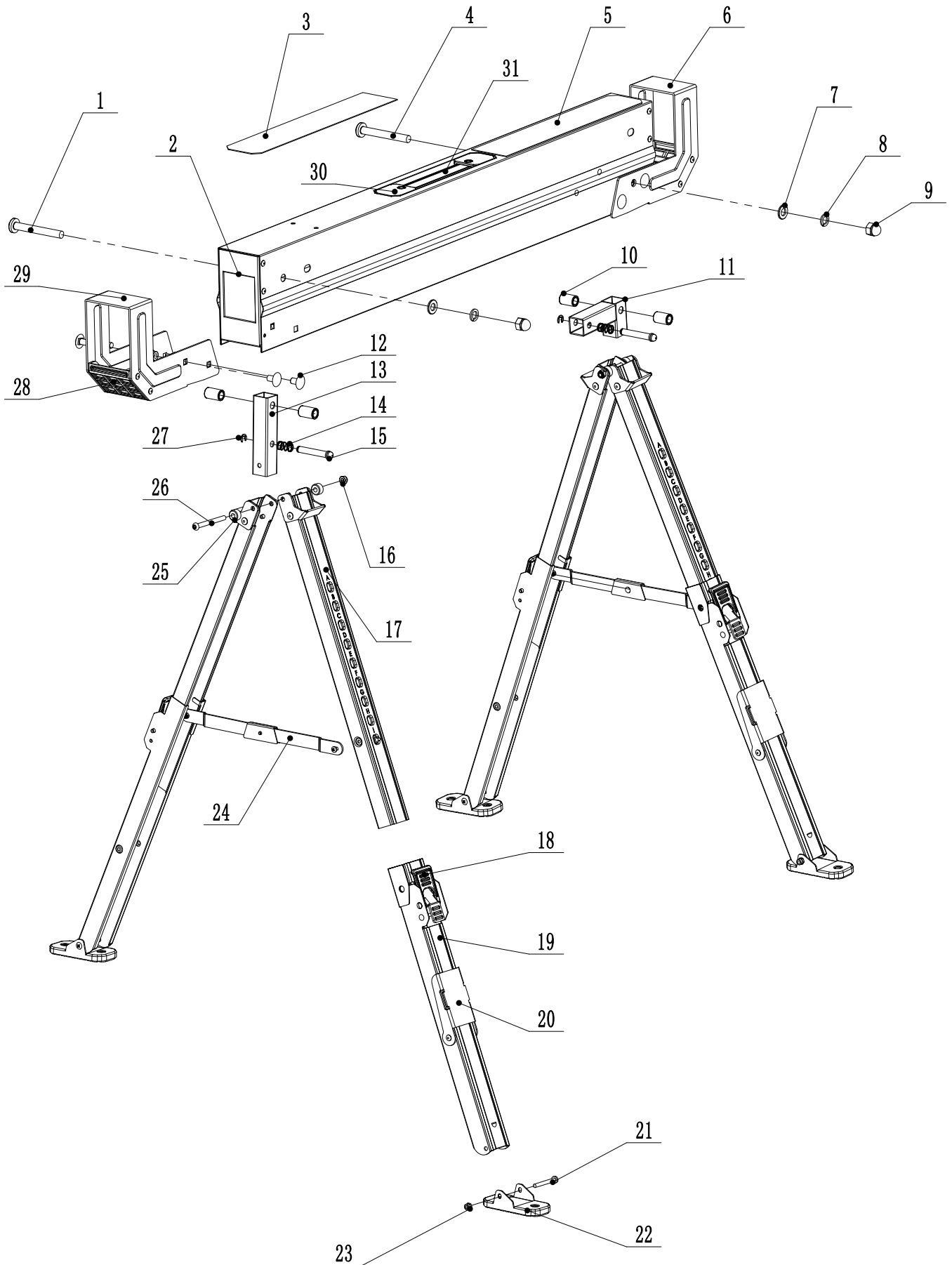

Limited 90 Day Warranty

Harbor Freight Tools Co. makes every effort to assure that its products meet high quality and durability standards, and warrants to the original purchaser that this product is free from defects in materials and workmanship for the period of 90 days from the date of purchase. This warranty does not apply to damage due directly or indirectly, to misuse, abuse, negligence or accidents, repairs or alterations outside our facilities, criminal activity, improper installation, normal wear and tear, or to lack of maintenance. We shall in no event be liable for death, injuries to persons or property, or for incidental, contingent, special or consequential damages arising from the use of our product. Some states do not allow the exclusion or limitation of incidental or consequential damages, so the above limitation of exclusion may not apply to you. THIS WARRANTY IS EXPRESSLY IN LIEU OF ALL OTHER WARRANTIES, EXPRESS OR IMPLIED, INCLUDING THE WARRANTIES OF MERCHANTABILITY AND FITNESS.

To take advantage of this warranty, the product or part must be returned to us with transportation charges prepaid. Proof of purchase date and an explanation of the complaint must accompany the merchandise. If our inspection verifies the defect, we will either repair or replace the product at our election or we may elect to refund the purchase price if we cannot readily and quickly provide you with a replacement. We will return repaired products at our expense, but if we determine there is no defect, or that the defect resulted from causes not within the scope of our warranty, then you must bear the cost of returning the product.

This warranty gives you specific legal rights and you may also have other rights which vary from state to state.

Record Serial Number Here:

Note: If product has no serial number, record month and year of purchase instead.

Note: Some parts are listed and shown for illustration purposes only, and are not available individually as replacement parts. Specify UPC 193175507402 when ordering parts.

BauerTM

26677 Agoura Road • Calabasas, CA 91302 • 1-888-866-5797