

Owner's Manual & Safety Instructions

Save This Manual Keep this manual for the safety warnings and precautions, assembly, operating, inspection, maintenance and cleaning procedures. Write the product's serial number in the back of the manual near the assembly diagram (or month and year of purchase if product has no number). Keep this manual and the receipt in a safe and dry place for future reference.

23g



2 JAW MASTER INTERCHANGEABLE PULLER SET



58118

Visit our website at: <http://www.harborfreight.com>
Email our technical support at: productsupport@harborfreight.com

When unpacking, make sure that the product is intact and undamaged. If any parts are missing or broken, please call 1-888-866-5797 as soon as possible.

Copyright© 2021 by Harbor Freight Tools®. All rights reserved.
No portion of this manual or any artwork contained herein may be reproduced in any shape or form without the express written consent of Harbor Freight Tools. Diagrams within this manual may not be drawn proportionally. Due to continuing improvements, actual product may differ slightly from the product described herein. Tools required for assembly and service may not be included.

⚠ WARNING

Read this material before using this product.
Failure to do so can result in serious injury.
SAVE THIS MANUAL.

Specifications

Capacity	6-10 Tons depending on yoke or Jaws used
Jaw Puller Range	3" - 6"

IMPORTANT SAFETY INFORMATION

1. Assemble and use only according to these instructions. Improper assembly and usage can create hazards.
2. Wear ANSI-approved safety goggles and heavy-duty work gloves during assembly and use.
3. Keep area clean and well lit.
4. Use only according to vehicle service instructions.
5. Inspect before every use; do not use if parts are loose or damaged.
6. Keep children and other bystanders out of the area.
7. Do not use when tired or when under the influence of drugs or medication.
8. Use as intended only.
9. Maintain product labels and nameplates. These carry important safety information. If unreadable or missing, contact Harbor Freight Tools for a replacement.



Assembly Instructions



Read the **ENTIRE IMPORTANT SAFETY INFORMATION** section at the beginning of this document including all text under subheadings therein before set up or use of this product.

Note: The Bearing Separator comes fully assembled.

Jaw Puller

1. Choose appropriate size Yoke and Jaws for object being removed:
 - Use same size Clamp Bolt and Yoke.
 - Use the same size Jaws on each side.
 - Jaws should be just long enough to fit around object being pulled.

Note: Connect Jaws to same holes that best fit the size of the object being pulled.

2. Attach one Jaw to Yoke using a Jaw Pin. Attach Jaw pointing in for external pulling or pointing out for internal pulling.

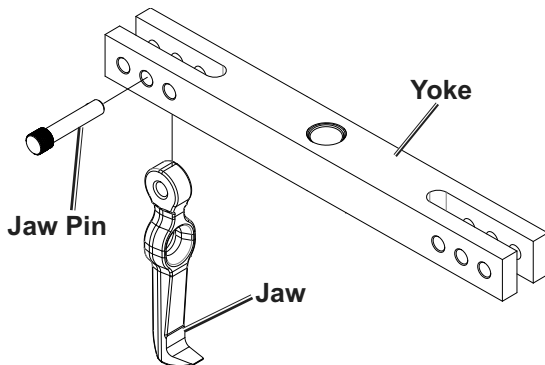

3. Insert the Clamp Bolt through the Jaw opening and hand tighten Washer and Nut.
4. Attach the other Jaw, Washer and Nut.

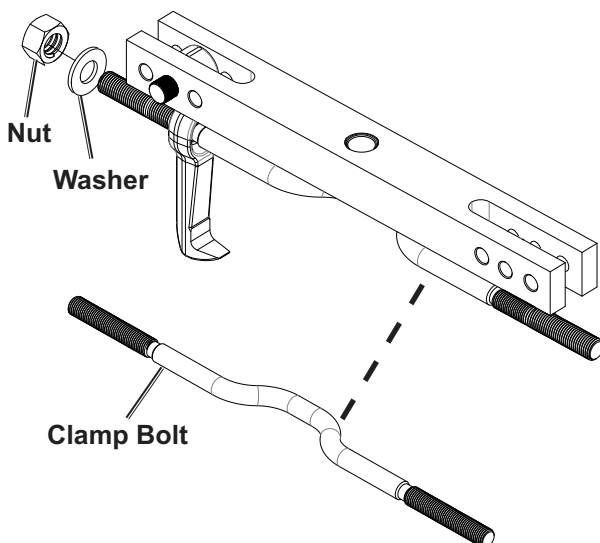

5. Thread the Pressure Screw through the Yolk and through the groove in the Clamp Bolt.

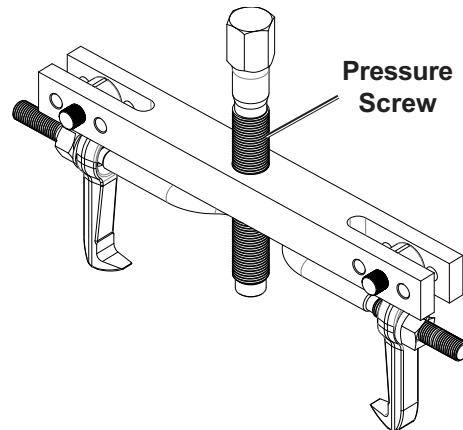

6. Thread appropriate Pressure Tip into the end of the Pressure Screw.

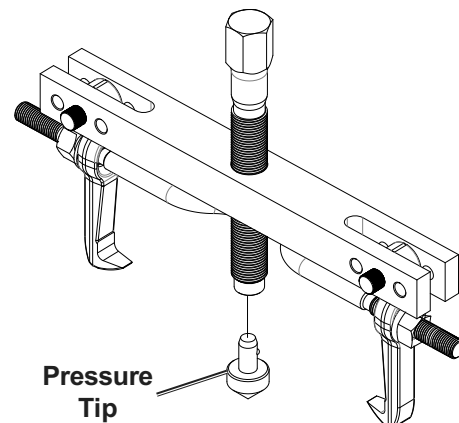

Operation



Read the **ENTIRE IMPORTANT SAFETY INFORMATION** section at the beginning of this document including all text under subheadings therein before set up or use of this product.

!WARNING



TO PREVENT SERIOUS INJURY FROM EXPLOSION:
Carefully follow service instructions to disable airbag before working near steering wheel or steering column.

Jaw Puller

1. Position Jaws to object and grip by loosening or tightening Nuts.
2. Using a wrench, rotate Pressure Screw so that the Pressure Tip makes contact with the center of the object being removed.
3. Check alignment of Puller and object being removed.:
 - Puller should be level, pulling equally on both sides.
 - Jaws should be gripping the object on both sides.
4. Continue to rotate the Pressure Screw until the object is pulled out.
5. If more leverage is needed, place Centering Disc onto center of object and center the Pressure Tip against it.

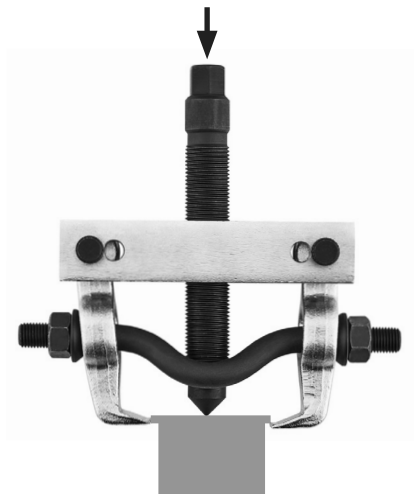

Jaws Pointing In

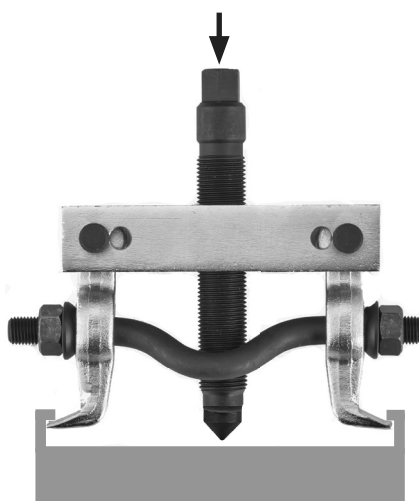

Jaws Pointing Out

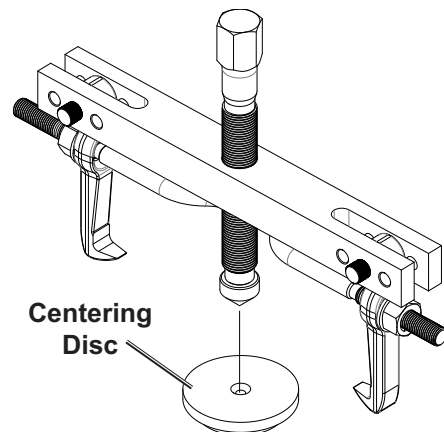

Bearing Separator

1. Loosen the Nuts and center the Bearing Separator around the bearing.
2. Grip bearing by tightening both Nuts with wrench (sold separately).

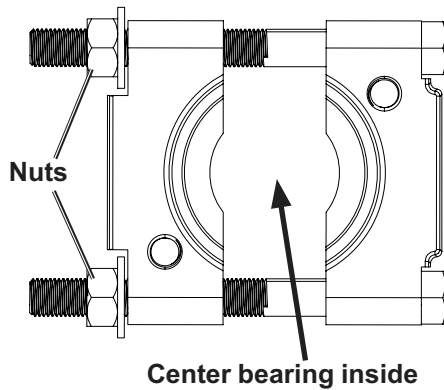

3. Thread puller legs (sold separately) into Separator's holes. Both legs should be the same length.
4. Connect yolk (sold separately) to the legs.
5. Thread pressure screw (sold separately) into yolk until the tip makes contact with the center of the bearing.
6. Using a wrench, continue to tighten the pressure screw until the bearing has been pulled out.

Maintenance

⚠WARNING

TO PREVENT SERIOUS INJURY FROM TOOL FAILURE:
Do not use damaged equipment. If abnormal noise or vibration occurs, have the problem corrected before further use.

Cleaning, Maintenance, and Lubrication

1. **BEFORE EACH USE**, inspect the general condition of the tool. Check for:
 - loose hardware
 - misalignment or binding of moving parts
 - cracked or broken parts
 - any other condition that may affect its safe operation.
2. When storing, coat all parts with a light oil to prevent rust, then store them in the Carry Case.

PLEASE READ THE FOLLOWING CAREFULLY

THE MANUFACTURER AND/OR DISTRIBUTOR HAS PROVIDED THE PARTS LIST AND ASSEMBLY DIAGRAM IN THIS DOCUMENT AS A REFERENCE TOOL ONLY. NEITHER THE MANUFACTURER OR DISTRIBUTOR MAKES ANY REPRESENTATION OR WARRANTY OF ANY KIND TO THE BUYER THAT HE OR SHE IS QUALIFIED TO MAKE ANY REPAIRS TO THE PRODUCT, OR THAT HE OR SHE IS QUALIFIED TO REPLACE ANY PARTS OF THE PRODUCT. IN FACT, THE MANUFACTURER AND/OR DISTRIBUTOR EXPRESSLY STATES THAT ALL REPAIRS AND PARTS REPLACEMENTS SHOULD BE UNDERTAKEN BY CERTIFIED AND LICENSED TECHNICIANS, AND NOT BY THE BUYER. THE BUYER ASSUMES ALL RISK AND LIABILITY ARISING OUT OF HIS OR HER REPAIRS TO THE ORIGINAL PRODUCT OR REPLACEMENT PARTS THERETO, OR ARISING OUT OF HIS OR HER INSTALLATION OF REPLACEMENT PARTS THERETO.

Parts List and Diagram

Parts List

Part	Description	Qty
1	Jaw, 6"	2
2	Jaw, 5"	2
3	Jaw, 4"	2
4	Jaw, 3"	2
5	Clamp Bolt Nut, 6" - 20UNF	4
6	Jaw Pin, 46mm	4
7	Clamp Bolt Washer, 11.4mm	4
8	Centering Disc, 75.5mm	1
9	Centering Disc, 63mm	1
10	Centering Disc, 53.77mm	1
11	Centering Disc, 37.9mm	1
12	Centering Disc, 44.1mm	1
13	Centering Disc, 41.3mm	1
14	Centering Disc, 38mm	1
15	Centering Disc, 34mm	1
16	Clamp Bolt, 7/16" - 20UNF - 154.6mm	1

Part	Description	Qty
17	Clamp Bolt, 7/16" - 20UNF - 209.5mm	1
18	Clamp Bolt, 7/16" - 20UNF - 325mm	1
19	Yoke, 5"	1
20	Yoke, 8"	1
21	Yoke, 11"	1
22	Nut, 7/16" - 20UNF - 17mm	2
23	Bolt, 7/16" - 20UNF - 122mm	2
24	Bearing Separator	1
25	Washer, 3/8" - 16UNF - 90mm	2
26	Pressure Screw, 3/4" - 16UNF - 5-1/8" L	1
27	Pressure Screw, 3/4" - 16UNF - 6-11/16" L	1
28	Pressure Tip, 22.2mm x 7/8" L	1
29	Pressure Tip, 16mm x 5/8" L	1
30	Carry Case (not shown)	1

Parts Diagram

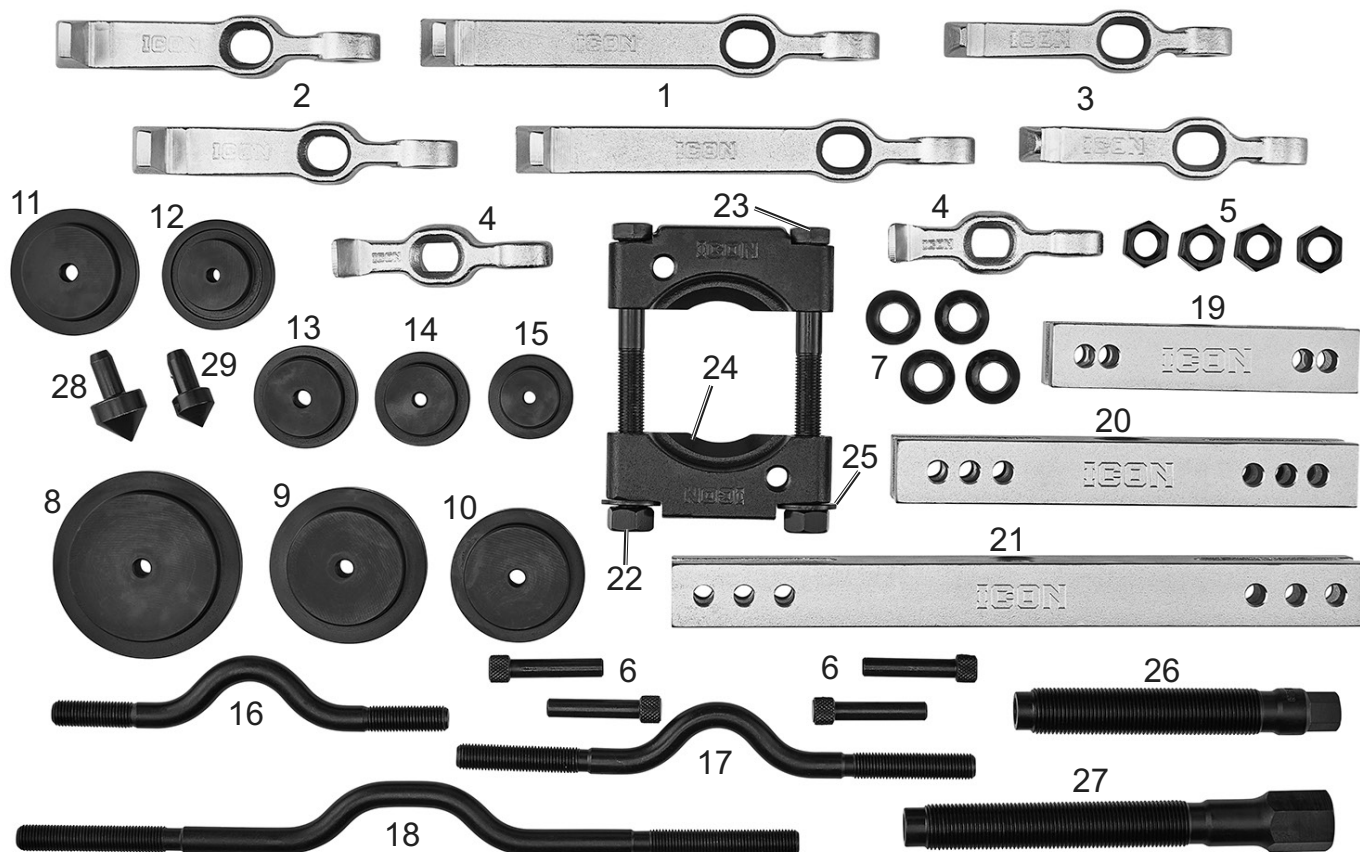

Record Serial Number Here: _____

Note: If product has no serial number, record month and year of purchase instead.

Note: Some parts are listed and shown for illustration purposes only, and are not available individually as replacement parts. Specify UPC 193175432568 when ordering parts.

Limited Lifetime Warranty

Harbor Freight Tools warrants to the original purchaser that this ICON™ product shall be free from defects in materials and workmanship for its useful life.

If your ICON™ product does not perform in accordance with this warranty, Harbor Freight Tools will, at its option and expense, repair or replace (or elect to refund the purchase price if we cannot repair or replace), your ICON™ product, which shall be your sole and exclusive remedy. To obtain warranty service, ICON™ products must be returned with proof of purchase to a Harbor Freight Tools retail store or returned by mail after contacting Harbor Freight Tools Product Support at 1-888-866-5797 and receiving a return authorization.

This warranty excludes normal wear and tear and does not apply to damage due directly or indirectly to misuse, use or operation other than for the intended purpose or not in accordance with the product manual, abuse, accident, modification or alteration, unauthorized repair, improper storage, neglect, or lack of maintenance. This warranty is in lieu of all other warranties. Harbor Freight Tools is not liable for incidental, indirect, special, consequential, or punitive damages or costs arising from the use of this product. Some states do not allow the exclusion or limitation of incidental or consequential damages, so the above limitation may not apply to you. This warranty gives you specific legal rights, and you may also have other rights which vary from state to state.

ICON is a trademark of Harbor Freight Tools. All other brands and trade names are the property of their respective owners.



26677 Agoura Road • Calabasas, CA 91302 • 1-888-866-5797