

Owner's Manual & Safety Instructions

Save This Manual Keep this manual for the safety warnings and precautions, assembly, operating, inspection, maintenance and cleaning procedures. Write the product's serial number in the back of the manual near the assembly diagram (or month and year of purchase if product has no number). Keep this manual and the receipt in a safe and dry place for future reference.

21h

Bauer™ **21505C-B**

20v
HYPERMAX™
LITHIUM-ION

**For Best Results,
Use 3.0 Amp Hour Battery
(Sold Separately)**

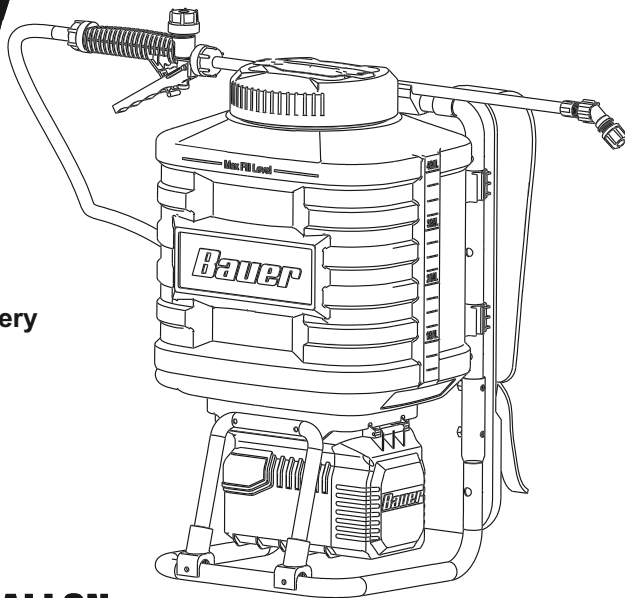

20V CORDLESS 4 GALLON BACKPACK CHEMICAL SPRAYER

Visit our website at: <http://www.harborfreight.com>
Email our technical support at: productsupport@harborfreight.com

58671

When unpacking, make sure that the product is intact and undamaged. If any parts are missing or broken, please call 1-888-866-5797 as soon as possible.

Copyright© 2021 by Harbor Freight Tools®. All rights reserved.
No portion of this manual or any artwork contained herein may be reproduced in any shape or form without the express written consent of Harbor Freight Tools. Diagrams within this manual may not be drawn proportionally. Due to continuing improvements, actual product may differ slightly from the product described herein. Tools required for assembly and service may not be included.

⚠WARNING

Read this material before using this product.
Failure to do so can result in serious injury.
SAVE THIS MANUAL.

Table of Contents

Safety	2	Maintenance	8
Specifications	5	Parts List and Diagram	10
Setup	5	Warranty	12
Operation	7		



SAFETY

SETUP

OPERATION

MAINTENANCE

WARNING SYMBOLS AND DEFINITIONS

	This is the safety alert symbol. It is used to alert you to potential personal injury hazards. Obey all safety messages that follow this symbol to avoid possible injury or death.
	Indicates a hazardous situation which, if not avoided, will result in death or serious injury.
	Indicates a hazardous situation which, if not avoided, could result in death or serious injury.
	Indicates a hazardous situation which, if not avoided, could result in minor or moderate injury.
	Addresses practices not related to personal injury.

IMPORTANT SAFETY INSTRUCTIONS

WARNING

When using electric gardening appliances, basic safety precautions should always be followed to reduce the risk of fire, electric shock, and personal injury, including the following:

READ ALL INSTRUCTIONS

Battery Precautions

1. Do not charge appliance in rain, or in wet locations.
2. Do not use battery-operated appliance in rain.
3. Remove or disconnect battery before servicing, cleaning, or removing material from the gardening appliance.
4. Do not dispose of the battery in a fire. The cell may explode. Check with local codes for possible special disposal instructions.
5. Do not open or mutilate the battery. Released electrolyte is corrosive and may cause damage to the eyes or skin. It may be toxic if swallowed.
6. Exercise care in handling batteries in order not to short the battery with conducting materials such as rings, bracelets, and keys. The battery or conductor may overheat and cause burns.

Lithium Battery Safety Warnings



LITHIUM BATTERIES STORE A LARGE AMOUNT OF ENERGY AND WILL VENT FIRE OR EXPLODE IF MISTREATED:

1. **Keep Battery Pack dry.**

Personal Safety

1. **Follow all guidelines regarding chemicals sprayed, including MSDS instructions and EPA regulations.**
2. **Dress Properly** - Do not wear loose clothing or jewelry. They can be caught in moving parts. Use of rubber gloves and substantial footwear is recommended when working outdoors. Wear protective hair covering to contain long hair.
3.  **Wear ANSI-approved safety goggles and heavy-duty work gloves. Use face or dust mask if operation is dusty.**

2. **DO NOT DO ANY OF THE FOLLOWING TO THE BATTERY PACK:**
 - a. **Open,**
 - b. **Drop,**
 - c. **Short-circuit,**
 - d. **Puncture,**
 - e. **Incinerate, or**
 - f. **Expose to temperatures greater than 265°F.**
3. Charge Battery Pack only according to its Charger's instructions.
4. Inspect Battery Pack before every use; do not use or charge if damaged.

Gardening Appliance Use and Care

1. **Avoid Dangerous Environment** - Do not use appliances in damp or wet locations.
2. **Do not Use In Rain.**
3. **Keep Children Away - All visitors should be kept at a distance from work area.**
4. When servicing use only identical replacement parts.
5. Use Right Appliance - Do not use appliance for any job except that for which it is intended.
6. Do not Force Appliance - It will do the job better and with less likelihood of injury at the rate for which it was designed.
7. Store Idle Appliances Indoors - When not in use, appliances should be stored indoors in dry, and high or locked-up place - out of reach of children.
8. Check Damaged Parts - Before further use of the appliance, a guard or other part that is damaged should be carefully checked to determine that it will operate properly and perform its intended function. Check for alignment of moving parts, binding of moving parts, breakage of parts, mounting, and any other condition that may affect its operation. A guard or other part that is damaged should be properly repaired or replaced by a qualified technician unless indicated elsewhere in this manual.

Vibration Hazard

This appliance vibrates during use. Repeated or long-term exposure to vibration may cause temporary or permanent physical injury, particularly to the hands, arms and shoulders. To reduce the risk of vibration-related injury:

1. Anyone using vibrating appliances regularly or for an extended period should first be examined by a doctor and then have regular medical check-ups to ensure medical problems are not being caused or worsened from use. Pregnant women or people who have impaired blood circulation to the hand, past hand injuries, nervous system disorders, diabetes, or Raynaud's Disease should not use this appliance. If you feel any symptoms related to vibration (such as tingling, numbness, and white or blue fingers), seek medical advice as soon as possible.
2. Do not smoke during use. Nicotine reduces the blood supply to the hands and fingers, increasing the risk of vibration-related injury.
3. Wear suitable gloves to reduce the vibration effects on the user.
4. Use appliances with the lowest vibration when there is a choice between different processes.
5. Include vibration-free periods each day of work.
6. Grip appliance as lightly as possible (while still keeping safe control of it). Let the appliance do the work.
7. To reduce vibration, maintain the appliance as explained in this manual. If any abnormal vibration occurs, stop use immediately.

General Safety

1. **Use only for water or water-based fertilizers, herbicides, pesticides, and sealers. Do not use to spray combustible or corrosive chemicals.**
2. **Follow all guidelines regarding chemicals sprayed, including MSDS instructions and EPA regulations.**
3. Do not point Sprayer at yourself, other people, or animals.
4. Industrial applications must follow OSHA requirements.
5. Make sure liquid used in Sprayer is not dirty, sandy, or viscous.
6. This product is not a toy. Do not allow children to play with or near this item.
7. Inspect before every use; do not use if parts are loose or damaged.
8. Do not use appliance for other than intended use.
9. Maintain labels and nameplates on the appliance. These carry important safety information. If unreadable or missing, contact Harbor Freight Tools for a replacement.
10. The warnings, precautions, and instructions discussed in this instruction manual cannot cover all possible conditions and situations that may occur. It must be understood by the operator that common sense and caution are factors which cannot be built into this product, but must be supplied by the operator.



SAVE THESE INSTRUCTIONS.

Specifications

Battery Type	Bauer 20V 3.0Ah Li-Ion Battery Pack (64816, sold separately)
Charger Type	Bauer 20V 3.0A Li-Ion Charger (57006, sold separately)
Tank Capacity	4 Gallon
Working Pressure	Up to 90 PSI
Hose Length	53"

Set Up Instructions



Read the **ENTIRE IMPORTANT SAFETY INSTRUCTIONS** section at the beginning of this manual including all text under subheadings therein before set up or use of this product.

⚠ WARNING

TO PREVENT SERIOUS INJURY FROM ACCIDENTAL OPERATION:
Make sure that the Power Switch/Trigger is in the off-position and unplug the tool from its electrical outlet before performing any procedure in this section.

Note: For additional information regarding the parts listed in the following pages, refer to the Assembly Diagram on Page 10.

Components

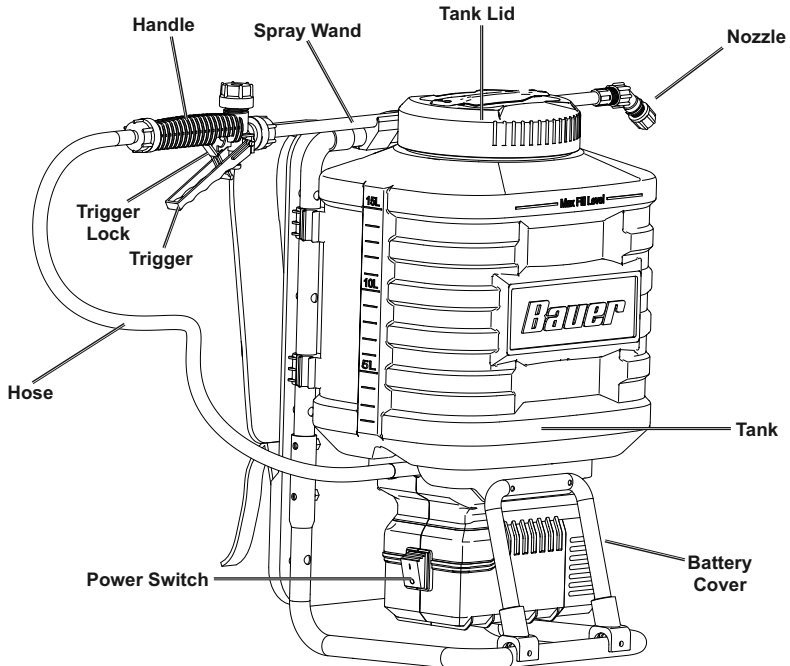

Assembly

SAFETY

1. Insert Handle into Spray Wand.
2. Slide Nut onto threaded coupling and hand tighten securely. Make sure Spray Wand and Handle are securely connected. See Figure A.

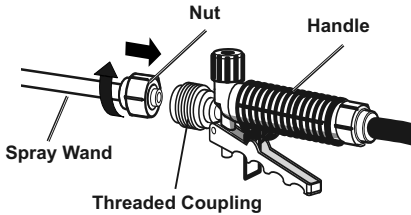

Figure A: Spray Wand and Handle Attachment

- Note:** If necessary, loosen Nut holding the Spray Wand and Handle. Rotate the Wand until it is aligned with the nozzle pointing downward. Retighten the Nut by hand.
4. The Hose comes pre-assembled to the Handle. If Hose comes loose, slide Nut on hose away from Hose end. Insert Hose end into Hose Connector. Slide Nut over the opening and Hose End. Hand tighten and make sure all connections are secure. See Figure C.

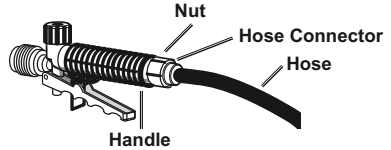

Figure C: Hose Connection

SETUP

3. Attach Nozzle by threading it onto the Elbow. Make sure connection is secure. Do not overtighten. See Figure B.

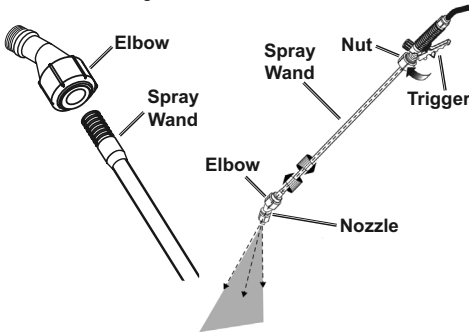

Figure B: Elbow Attachment

OPERATION

Tool Set Up

Filling the Tank

1. Unscrew and remove Tank Lid.
2. Fill Tank with the desired amount of liquid to no higher than top of fill line.
3. Replace Lid on Tank. Make sure Lid is tightened securely before use.

Adjusting the Spray Nozzle

1. Loosen the Nozzle for a stream spray.
2. Tighten the Nozzle for a fan spray.

MAINTENANCE

Operating Instructions



Read the **ENTIRE IMPORTANT SAFETY INFORMATION** section at the beginning of this manual including all text under subheadings therein before set up or use of this product.

Battery Charging

Charge Battery after unpacking and before using this tool. Follow instructions included with battery charger (sold separately).

General Operation

1. Before operating the gardening appliance, put on ANSI-approved safety goggles and other safety gear (sold separately).
2. To attach Battery Pack, raise the Battery Cover on the side of the Backpack. See Figure D.

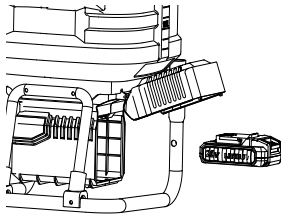

Figure D: Battery Pack Attachment

3. Align the raised rib on the Battery Pack with the groove in the Battery Port and place the Battery Pack in the tool.
4. Make sure the latches on the Battery Pack snap in place. Make sure the Battery Pack is secured in the tool before beginning operation.
5. Lower the battery cover.

Trigger Lock

1. The lock-on feature is convenient when spraying for an extended period of time or when covering a large area.
2. To engage the Trigger Lock, depress the Trigger and slide Trigger Lock forward.

6. To remove Battery Pack, press button on front of the Battery Pack to release the Battery and remove it from the tool.
7. To turn the Sprayer on, turn Power Switch to the On Position.
8. To start the spray of liquid, squeeze the Trigger. Release the Trigger to stop the flow of liquid.
9. To turn the Sprayer off, turn Power Switch to the Off Position.
10. When finished spraying:
 - a. Point Wand in safe direction and depressurize the Tank by pressing down on the Trigger.
 - b. Dispose of liquid according to manufacturer guidelines.
 - c. Clean the Sprayer according to Maintenance Instructions.
 - d. Store Sprayer in a safe, dry, clean location out of reach of children and out of sunlight.
11. To prevent accidents, turn off the appliance and remove its Battery Pack after use.

3. To release the Trigger Lock, depress the Trigger and slide Trigger Lock backward.

Note: Make sure the trigger lock is not engaged before inserting the battery pack into the sprayer.

Maintenance and Servicing



Procedures not specifically explained in this manual must be performed only by a qualified technician.

!WARNING

TO PREVENT SERIOUS INJURY FROM ACCIDENTAL OPERATION:

Make sure that the Power Switch/Trigger is in the off-position and unplug the tool from its electrical outlet before performing any procedure in this section.

TO PREVENT SERIOUS INJURY FROM TOOL FAILURE:

Do not use damaged equipment. If abnormal noise or vibration occurs, have the problem corrected before further use.

Cleaning, Maintenance, and Lubrication

- BEFORE EACH USE**, inspect the general condition of the tool. Check for:
 - leaking, swollen, or cracked battery pack,
 - loose hardware,
 - misalignment or binding of moving parts,
 - cracked or broken parts, and
 - any other condition that may affect its safe operation.
- AFTER USE**, clean external surfaces of the appliance with clean, moist cloth.
- AFTER EVERY USE**, clean the Sprayer:
 - Reinstall Battery Pack and Flush with water until Tank is empty.
 - Clean Nozzle and Tank Strainer.
 - Allow to air-dry with the Tank open.
 - After dry, replace Strainer and Tank Lid.

Note: Do not use flammable cleaners or abrasive cleaners when cleaning tool.
- Disconnect battery pack and store battery pack, charger, and tool in dry, indoor area out of reach of children and away from metal objects (i.e., paperclips, coins) to prevent shorting.
- "Li-Ion battery must be recycled or disposed of properly.

Cleaning Nozzle

- If Nozzle becomes plugged, remove Battery Pack and make sure tool is in Off Position.
- Unscrew and remove Nozzle from Spray Wand. Push a small wire through the cross holes to clear any debris. If necessary, rinse the cross holes and Nozzle with clean water.
- Wipe Nozzle and cross holes with a clean dry cloth and reinstall Nozzle.

PLEASE READ THE FOLLOWING CAREFULLY

THE MANUFACTURER AND/OR DISTRIBUTOR HAS PROVIDED THE PARTS LIST AND ASSEMBLY DIAGRAM IN THIS MANUAL AS A REFERENCE TOOL ONLY. NEITHER THE MANUFACTURER OR DISTRIBUTOR MAKES ANY REPRESENTATION OR WARRANTY OF ANY KIND TO THE BUYER THAT HE OR SHE IS QUALIFIED TO MAKE ANY REPAIRS TO THE PRODUCT, OR THAT HE OR SHE IS QUALIFIED TO REPLACE ANY PARTS OF THE PRODUCT. IN FACT, THE MANUFACTURER AND/OR DISTRIBUTOR EXPRESSLY STATES THAT ALL REPAIRS AND PARTS REPLACEMENTS SHOULD BE UNDERTAKEN BY CERTIFIED AND LICENSED TECHNICIANS, AND NOT BY THE BUYER. THE BUYER ASSUMES ALL RISK AND LIABILITY ARISING OUT OF HIS OR HER REPAIRS TO THE ORIGINAL PRODUCT OR REPLACEMENT PARTS THERETO, OR ARISING OUT OF HIS OR HER INSTALLATION OF REPLACEMENT PARTS THERETO.

SAFETY

SETUP

OPERATION

MAINTENANCE

Record Product's Serial Number Here: _____

Note: If product has no serial number, record month and year of purchase instead.

Note: Some parts are listed and shown for illustration purposes only, and are not available individually as replacement parts. Specify UPC 193175443663 when ordering parts.

Parts List

Part	Description	Qty
1	Lid Assembly	1
1.1	Screw	4
1.2	Lid Handle	1
1.3	Lid	1
1.4	Check Valve	1
2	Filter Assembly	1
2.1	Seal Ring	1
2.2	Filter Cartridge	1
3	Suction Tube Assembly	1
3.1	Suction Tube	1
3.2	Strainer Base	1
3.3	Strainer	1
3.4	O-Ring	1
3.5	Locking Nut	1
3.6	O-Ring	1
3.7	Bead	1
4	Backstrap Assembly	1
4.1	Screw	9
4.2	Gasket	9
4.3	Strap Assembly	1
5	Holder Assembly	1
5.1	Screw	6
5.2	Upper Bracket	1
5.3	Holder Stationary Cover	6
5.4	Spray Wand Holder	2
5.5	Screw	4
5.6	Lower Bracket	1
6	Water Pump Assembly	1
6.1	Water Pump	1
6.2	Hose Clamp	1

Part	Description	Qty
6.3	Motor Press Plate	2
6.4	Screw	4
6.5	Hose Clamp 2	2
6.6	Duct, 110 mm	1
6.7	Spring	1
6.8	Pressure Cap	2
7	Battery Enclosure Assembly	1
7.1	Shaft	1
7.2	Battery Cover	1
7.3	Screw	2
7.4	Flag-shaped Spring	2
7.5	Flag-shaped Spring Sheath	1
7.6	Wire, 170 mm	1
7.7	Battery Enclosure	1
7.8	PCB	1
7.9	Power Switch	1
7.10	Screw	5
8	Support Frame Assembly	1
8.1	Screw	2
8.2	Support Frame	1
8.3	Support Frame Stationary Base	2
8.4	Nut	2
8.5	Screw	2
9	Tank	1
10	Hose Assembly	2
11	Nut	1
12	Threaded Coupling	1
13	Sealing Gasket	1
14	Trigger Handle	1
15	Spray Wand	1

Assembly Diagram

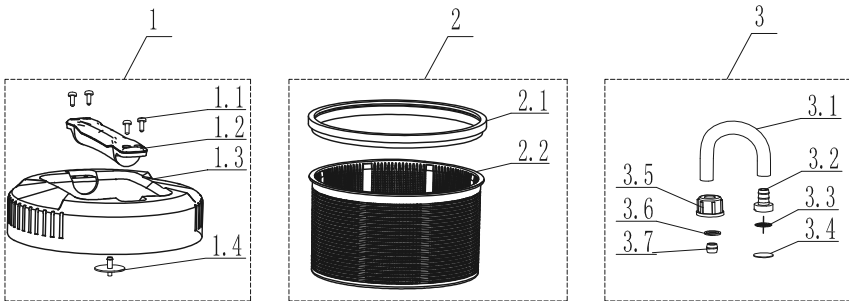

SAFETY

SETUP

OPERATION

MAINTENANCE

Assembly Diagram Continued

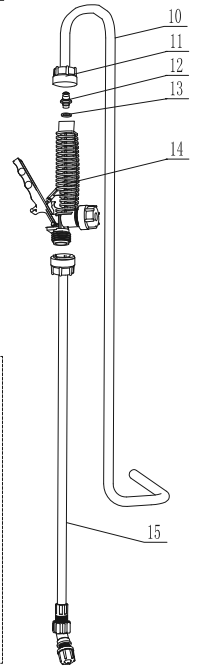
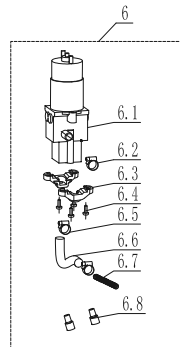
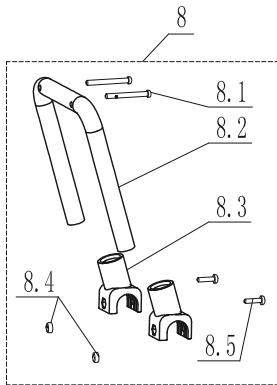
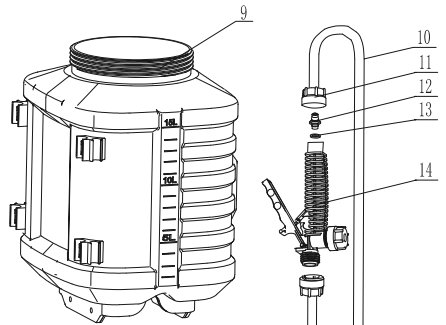
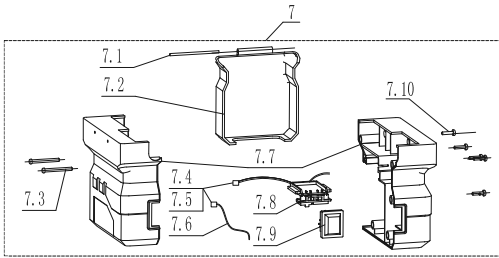
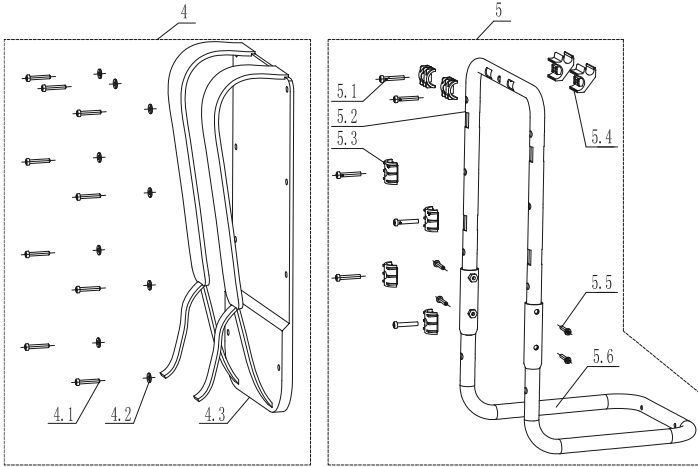

SAFETY

SETUP

OPERATION

MAINTENANCE

Limited 90 Day Warranty

Harbor Freight Tools Co. makes every effort to assure that its products meet high quality and durability standards, and warrants to the original purchaser that this product is free from defects in materials and workmanship for the period of 90 days from the date of purchase. This warranty does not apply to damage due directly or indirectly, to misuse, abuse, negligence or accidents, repairs or alterations outside our facilities, criminal activity, improper installation, normal wear and tear, or to lack of maintenance. We shall in no event be liable for death, injuries to persons or property, or for incidental, contingent, special or consequential damages arising from the use of our product. Some states do not allow the exclusion or limitation of incidental or consequential damages, so the above limitation of exclusion may not apply to you. THIS WARRANTY IS EXPRESSLY IN LIEU OF ALL OTHER WARRANTIES, EXPRESS OR IMPLIED, INCLUDING THE WARRANTIES OF MERCHANTABILITY AND FITNESS.

To take advantage of this warranty, the product or part must be returned to us with transportation charges prepaid. Proof of purchase date and an explanation of the complaint must accompany the merchandise. If our inspection verifies the defect, we will either repair or replace the product at our election or we may elect to refund the purchase price if we cannot readily and quickly provide you with a replacement. We will return repaired products at our expense, but if we determine there is no defect, or that the defect resulted from causes not within the scope of our warranty, then you must bear the cost of returning the product.

This warranty gives you specific legal rights and you may also have other rights which vary from state to state.

Bauer[™]

26541 Agoura Road • Calabasas, CA 91302 • 1-888-866-5797