

# Owner's Manual & Safety Instructions

Save This Manual Keep this manual for the safety warnings and precautions, assembly, operating, inspection, maintenance and cleaning procedures. Write the product's serial number in the back of the manual near the assembly diagram (or month and year of purchase if product has no number). Keep this manual and the receipt in a safe and dry place for future reference.

22f

**MADDOX™**  
SUPERIOR AUTOMOTIVE TOOLS

MA11-1

## 1 1PC Ball Joint Service Add-On Kit



Visit our website at: <http://www.harborfreight.com>  
Email our technical support at: [productsupport@harborfreight.com](mailto:productsupport@harborfreight.com)

58785





When unpacking, make sure that the product is intact and undamaged. If any parts are missing or broken, please call 1-888-866-5797 as soon as possible.

### **⚠ WARNING**

Read this material before using this product.  
Failure to do so can result in serious injury.  
**SAVE THIS MANUAL.**

Copyright© 2021 by Harbor Freight Tools®. All rights reserved.  
No portion of this manual or any artwork contained herein may be reproduced in any shape or form without the express written consent of Harbor Freight Tools. Diagrams within this manual may not be drawn proportionally. Due to continuing improvements, actual product may differ slightly from the product described herein. Tools required for assembly and service may not be included.

## WARNING SYMBOLS AND DEFINITIONS

	This is the safety alert symbol. It is used to alert you to potential personal injury hazards. Obey all safety messages that follow this symbol to avoid possible injury or death.
 <b>DANGER</b>	Indicates a hazardous situation which, if not avoided, will result in death or serious injury.
 <b>WARNING</b>	Indicates a hazardous situation which, if not avoided, could result in death or serious injury.
 <b>CAUTION</b>	Indicates a hazardous situation which, if not avoided, could result in minor or moderate injury.
<b>NOTICE</b> <b>CAUTION</b>	Addresses practices not related to personal injury.

# MADDOX™

## SUPERIOR AUTOMOTIVE TOOLS

## IMPORTANT SAFETY INFORMATION

1. Keep work area clean and well lit. Cluttered or dark areas invite accidents.
2. Keep children and bystanders away while using this product. Distractions can cause you to lose control.
3. Stay alert, watch what you are doing and use common sense when using this product. Do not use this product while you are tired or under the influence of drugs, alcohol or medication. A moment of inattention while using this product may result in serious personal injury.
4. Use safety equipment. Always wear eye protection. Safety equipment such as non-skid safety shoes, hard hat, or heavy duty work gloves used for appropriate conditions will reduce personal injuries.
5. Do not overreach. Keep proper footing and balance at all times. This enables better control of this product in unexpected situations.
6. Dress properly. Do not wear loose clothing or jewelry. Keep your hair, clothing and gloves away from moving parts. Loose clothes, jewelry or long hair can be caught in moving parts.
7. Do not force this product. Use the correct product for your application. The correct product will do the job better and safer at the rate for which it was designed.
8. Store this product out of the reach of children and do not allow people unfamiliar with the product or these instructions to operate the product. This product could be dangerous in the hands of untrained users.
9. Maintain this product. Check for misalignment or binding of parts, breakage of parts and any other condition that may affect the product's operation. If damaged, have this product repaired before use. Many accidents are caused by poorly maintained equipment.
10. Use this product in accordance with these instructions and in the manner intended for this particular type of product, taking into account the working conditions and the work to be performed. Use of this product for operations different from those intended could result in a hazardous situation.
11. Maintain labels and nameplates on the Adapter Set. These carry important safety information. If unreadable or missing, contact Harbor Freight Tools for a replacement.
12. Wear ANSI-approved safety goggles and heavy duty work gloves when using this product.
13. Prior to servicing a vehicle, **turn off the vehicle's engine** and refer to the vehicle manufacturer's service and repair manual for instructions on how to safely secure the vehicle in place with jacks, stands, etc.
14. The warnings, precautions, and instructions discussed in this instruction manual cannot cover all possible conditions and situations that may occur. It must be understood by the operator that common sense and caution are factors which cannot be built into this product, but must be supplied by the operator.



**SAVE THESE INSTRUCTIONS.**

## Operating Instructions



Read the **ENTIRE IMPORTANT SAFETY INFORMATION** section at the beginning of this document including all text under subheadings therein before set up or use of this product.

**Note:** This add-on kit is used with MA10-1 Ball Joint Service Kit (63610 sold separately).

**Note:** Refer to *Application Chart* on page 5 for selection of proper Adapter when removing/installing Ball Joint, Brake Anchor Pins, or U-Joint.

**Note:** Read vehicle service manual to determine how to prepare the Ball Joint for removal from a specific vehicle make/model. The generic instructions that follow may, or may not apply to your vehicle.

### Attaching Plug Bolt to Ball Joint Press Frame

**Note:** The illustration depicts a disassembled Ball Joint Press that is part of MA10-1 Ball Joint Service Kit 63610.

1. Attach the Plug Bolt (11) to the Ball Joint Press by removing the Jackscrew, Steel Ball, and O-Ring from the Frame.
2. Make sure Steel Ball and O-Ring remain inside the Jack Screw. Then insert Plug Bolt into Jackscrew.
3. Screw threaded end of Jackscrew (with its Steel Ball, O-Ring, and attached Plug Bolt) back into threaded end of the Frame.

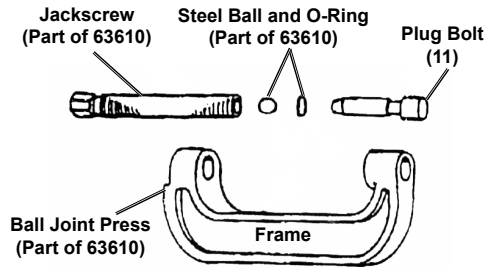

**MADDOX™**  
SUPERIOR AUTOMOTIVE TOOLS

## Removing/Installing Ball Joint

Note: The following instructions are intended to illustrate the process in general terms, and NOT to be specific to any one make/model vehicle. A combination of Receiving Tubes (parts 1-6, 8), Receiving Cup (9), and Installers (7, 10) will be necessary for different vehicles.

1. Remove all attaching hardware from ball joint.
2. Mount Remover/Installer (10) on the Jackscrew so that larger diameter portion of the Remover/Installer faces the threaded hole of the Ball Joint Press Assembly, and the smaller diameter portion faces the ball joint.
3. Removing a Ball Joint:
  - a. Mount proper size Receiving Tube (1-6, 8-9) under the ball joint.
  - b. Align mounted Remover/Installer (10), ball joint, and Receiver Tube to allow removal of ball joint.
  - c. Using a wrench, turn Jackscrew clockwise to remove ball joint.
4. Installing a Ball Joint:
  - a. Place proper size Receiving/Installing Tube (1-8) over the ball joint.
  - b. Align mounted Remover/Installer (10), ball joint, and Receiving/Installing Tube to allow installation of ball joint.
  - c. Using a wrench, turn Jackscrew clockwise to install the ball joint.

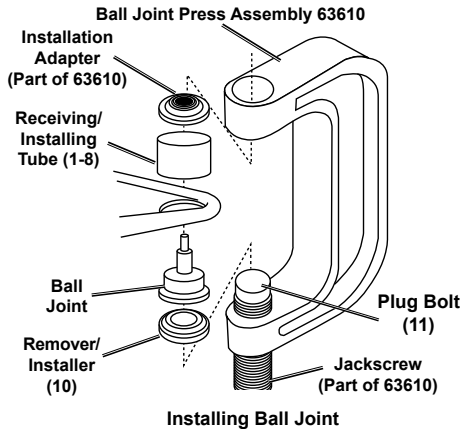
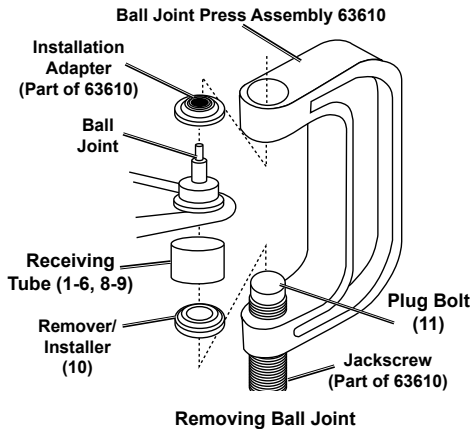

**MADDOX™**  
SUPERIOR AUTOMOTIVE TOOLS

## Application Chart

Adapter Application Chart		
Description	Image	Dimensions
GM Receiving Tube 1 (1)		2-3/4" x 3" x 2-1/4"
GM Receiving Tube 2 (2)		2-7/16" x 2-3/4" x 2-1/4"
Ford Receiving Tube 1 (3)		2-1/4" x 2-1/2" x 2-3/4"
Ford Receiving Tube 2 (4)		2-5/8" x 2-7/8" x 2-7/8"
Dodge/Chrysler/Jeep Receiving Tube 1 (5)		2-3/16" x 2-7/16" x 3-3/16"
Dodge/Chrysler/Ford Receiving Tube (6)		2-1/4" x 2-1/2" x 3/4"
Dodge/Chrysler/Jeep Installing Tube (7)		1-3/4" x 2" x 2-3/8"
Ford Receiving Tube (8)		2-1/4" x 2-1/2" x 1-1/2"
Dodge/Chrysler/Jeep Receiving Cup (9)		1-3/4" x 2-1/8" x 1/2"
Dodge/Chrysler/Jeep Remover/Installer (10)		3/4" x 1-7/16" x 1.00"
Dodge/Chrysler/Jeep/Ford Plug Bolt (11)		7/8" OD x 3" L

## Cleaning, Maintenance, and Lubrication

Do not perform any inspection, maintenance or cleaning procedures when the Ball Joint Kit is under a load.

1. **BEFORE EACH USE**, inspect the general condition of the Ball Joint Kit. Check for misalignment or binding of moving parts, cracked or broken parts, and any other condition that may affect its safe operation. If abnormal noise or vibration occurs, have the problem corrected before further use. **Do not use damaged equipment.**
2. **PERIODICALLY**, use a premium quality and light weight machine oil to lubricate the threads of the Jackscrew.
3. **AFTER USE**, wipe clean with a damp cloth, using a mild detergent or mild solvent.
4. When storing, keep kit parts in their Carry Case.

## PLEASE READ THE FOLLOWING CAREFULLY

---

THE MANUFACTURER AND/OR DISTRIBUTOR HAS PROVIDED THE PARTS LIST AND ASSEMBLY DIAGRAM IN THIS DOCUMENT AS A REFERENCE TOOL ONLY. NEITHER THE MANUFACTURER OR DISTRIBUTOR MAKES ANY REPRESENTATION OR WARRANTY OF ANY KIND TO THE BUYER THAT HE OR SHE IS QUALIFIED TO MAKE ANY REPAIRS TO THE PRODUCT, OR THAT HE OR SHE IS QUALIFIED TO REPLACE ANY PARTS OF THE PRODUCT. IN FACT, THE MANUFACTURER AND/OR DISTRIBUTOR EXPRESSLY STATES THAT ALL REPAIRS AND PARTS REPLACEMENTS SHOULD BE UNDERTAKEN BY CERTIFIED AND LICENSED TECHNICIANS, AND NOT BY THE BUYER. THE BUYER ASSUMES ALL RISK AND LIABILITY ARISING OUT OF HIS OR HER REPAIRS TO THE ORIGINAL PRODUCT OR REPLACEMENT PARTS THERETO, OR ARISING OUT OF HIS OR HER INSTALLATION OF REPLACEMENT PARTS THERETO.

**Record Product's Serial Number Here:** \_\_\_\_\_

**Note:** If product has no serial number, record month and year of purchase instead.

**Note:** Some parts are listed and shown for illustration purposes only, and are not available individually as replacement parts. Specify UPC 193175446589 when ordering parts.

## Parts List & Diagram

Part	Description	Qty
1	GM Receiving Tube 1	1
2	GM Receiving Tube 2	1
3	Ford Receiving Tube 1	1
4	Ford Receiving Tube 2	1
5	Dodge/Chrysler/Jeep Receiving Tube	1
6	Dodge/Chrysler/Ford Receiving Tube	1

Part	Description	Qty
7	Dodge/Chrysler/Jeep Installing Tube	1
8	Ford Receiving Tube	1
9	Dodge/Chrysler/Jeep Receiving Cup	1
10	Dodge/Chrysler/Jeep Remover/Installer	1
11	Dodge/Chrysler/Jeep/Ford Plug Bolt	1
12	Carry Case	1



## Limited 90 Day Warranty

Harbor Freight Tools Co. makes every effort to assure that its products meet high quality and durability standards, and warrants to the original purchaser that this product is free from defects in materials and workmanship for the period of 90 days from the date of purchase. This warranty does not apply to damage due directly or indirectly, to misuse, abuse, negligence or accidents, repairs or alterations outside our facilities, criminal activity, improper installation, normal wear and tear, or to lack of maintenance. We shall in no event be liable for death, injuries to persons or property, or for incidental, contingent, special or consequential damages arising from the use of our product. Some states do not allow the exclusion or limitation of incidental or consequential damages, so the above limitation of exclusion may not apply to you. THIS WARRANTY IS EXPRESSLY IN LIEU OF ALL OTHER WARRANTIES, EXPRESS OR IMPLIED, INCLUDING THE WARRANTIES OF MERCHANTABILITY AND FITNESS.

To take advantage of this warranty, the product or part must be returned to us with transportation charges prepaid. Proof of purchase date and an explanation of the complaint must accompany the merchandise. If our inspection verifies the defect, we will either repair or replace the product at our election or we may elect to refund the purchase price if we cannot readily and quickly provide you with a replacement. We will return repaired products at our expense, but if we determine there is no defect, or that the defect resulted from causes not within the scope of our warranty, then you must bear the cost of returning the product.

This warranty gives you specific legal rights and you may also have other rights which vary from state to state.

**MADDOX™**  
SUPERIOR AUTOMOTIVE TOOLS

26677 Agoura Road • Calabasas, CA 91302 • 1-888-866-5797