

Owner's Manual & Safety Instructions

Save This Manual Keep this manual for the safety warnings and precautions, assembly, operating, inspection, maintenance and cleaning procedures. Write the product's serial number in the back of the manual near the assembly diagram (or month and year of purchase if product has no number). Keep this manual and the receipt in a safe and dry place for future reference.

23d

HAULMASTER

TRIPLE-BALL ADJUSTABLE 6" DROP/ 4" RISE HITCH

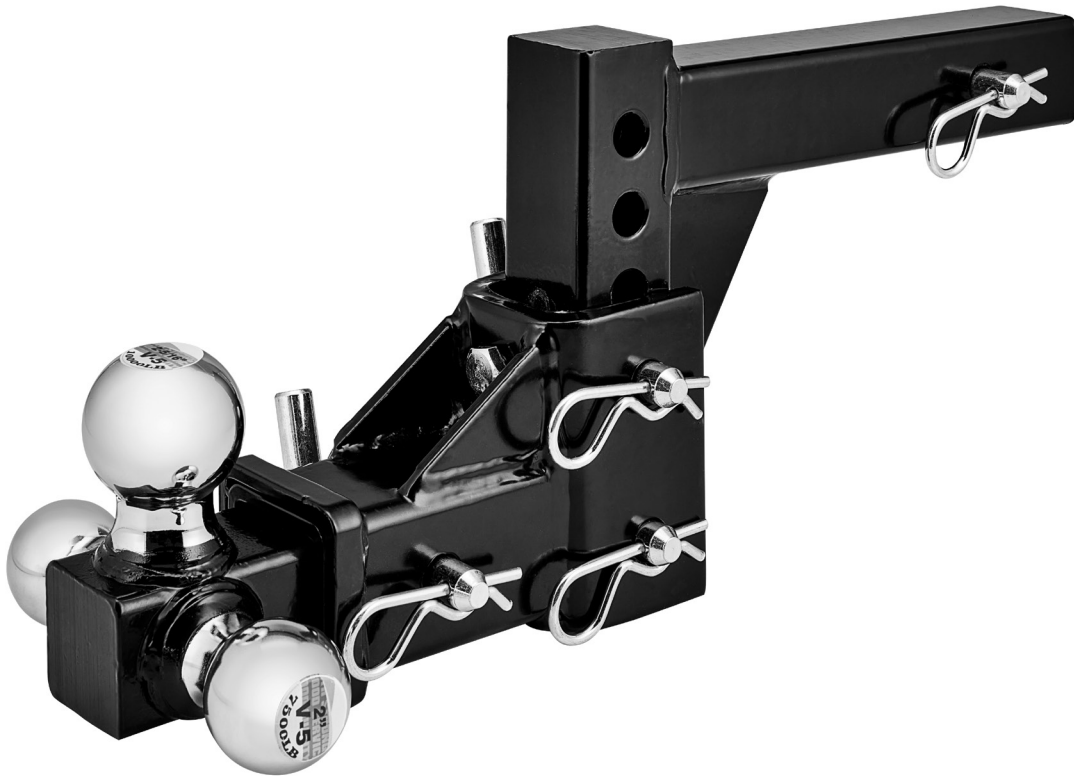

Visit our website at: <http://www.harborfreight.com>
Email our technical support at: productsupport@harborfreight.com

58790

When unpacking, make sure that the product is intact and undamaged. If any parts are missing or broken, please call 1-888-866-5797 as soon as possible.

Copyright© 2023 by Harbor Freight Tools®. All rights reserved.
No portion of this manual or any artwork contained herein may be reproduced in any shape or form without the express written consent of Harbor Freight Tools. Diagrams within this manual may not be drawn proportionally. Due to continuing improvements, actual product may differ slightly from the product described herein.
Tools required for assembly and service may not be included.

⚠WARNING

Read this material before using this product.
Failure to do so can result in serious injury.
SAVE THIS MANUAL.

Specifications

Ball Size	Gross Trailer Weight Capacity	Tongue Weight Capacity	Class
1-7/8"	5,000lb	500lb	III
2"	7,500lb	750lb	IV
2-5/16"	10,000lb	1,000lb	IV

IMPORTANT SAFETY INFORMATION

1. Do not exceed individual ball towing capacities, as shown in table above.
Be aware of dynamic loading!
Sudden starting or jerking against load may briefly create excess load causing product failure.
2. Wear ANSI-approved safety goggles and heavy-duty work gloves during set up.
3. Read trailer hitch and towing vehicle manuals before installation and use.
4. Use safety chain when pulling trailer.
5. All hitch pins and clips must be installed before use.
6. Frequently check hitch/coupler connection and condition of parts before and during use. Do not use if parts loose or damaged. Do not use if hitch ball does not properly fit trailer coupler.
7. Assemble only according to these instructions. Improper assembly can create hazards.
8. Keep assembly area clean and well lit.
9. Keep bystanders out of the area during assembly.
10. Do not assemble when tired or when under the influence of alcohol, drugs or medication.
11. Weight capacity and other product capabilities apply to properly and completely assembled product only.
12. This product is not a toy. Do not allow children to play with or near this item.
13. Use as intended only.
14. Inspect before every use; do not use if parts are loose or damaged.
15. Maintain product labels and nameplates. These carry important safety information. If unreadable or missing, contact Harbor Freight Tools for a replacement.

Installation Instructions



Read the **ENTIRE IMPORTANT SAFETY INFORMATION** section at the beginning of this document including all text under subheadings therein before set up or use of this product.

Note: Trailer must be level when hitched to tow vehicle. Use rise position or drop position to achieve the desired height.

1. Insert Shank Assembly (3) into the receiver hitch. Install Hitch Pin (1) and Clip (2).

Note: Flip Shank Assembly over for rise position.

2. Loosen Anti-Rattle Bolt (5).
3. Secure Receiver Tube Assembly (6) to Shank Assembly (3) using two Hitch Pins (1) and two Clips (2).

Note: Both Pins must be engaged in two holes of the Shank Assembly.

4. Tighten Anti-Rattle Bolt (5) to eliminate movement between the Shank Assembly and Receiver Tube Assembly.

Note: Coupler must match ball size exactly.

5. Insert Ball Mount Assembly (4) with required ball size pointing upward, into Receiver Tube Assembly (6). Secure with Hitch Pin (1) and Clip (2).

Note: All pins must be installed before use.

Note: Attach safety chains when pulling trailer.

Parts List and Diagram

Part	Description	Qty
1	Hitch Pin	4
2	Clip	4
3	Shank Assembly	1
4	Ball Mount Assembly	1
5	Anti-Rattle Bolt	1
6	Receiver Tube Assembly	1

Record Serial Number Here:

Note: If product has no serial number, record month and year of purchase instead.

Note: Some parts are listed and shown for illustration purposes only, and are not available individually as replacement parts. Specify UPC 193175446640 when ordering parts.

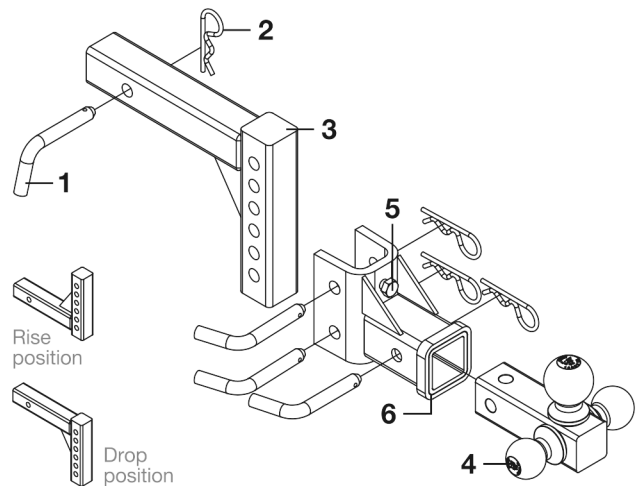

PLEASE READ THE FOLLOWING CAREFULLY

THE MANUFACTURER AND/OR DISTRIBUTOR HAS PROVIDED THE PARTS LIST AND ASSEMBLY DIAGRAM IN THIS DOCUMENT AS A REFERENCE TOOL ONLY. NEITHER THE MANUFACTURER OR DISTRIBUTOR MAKES ANY REPRESENTATION OR WARRANTY OF ANY KIND TO THE BUYER THAT HE OR SHE IS QUALIFIED TO MAKE ANY REPAIRS TO THE PRODUCT, OR THAT HE OR SHE IS QUALIFIED TO REPLACE ANY PARTS OF THE PRODUCT. IN FACT, THE MANUFACTURER AND/OR DISTRIBUTOR EXPRESSLY STATES THAT ALL REPAIRS AND PARTS REPLACEMENTS SHOULD BE UNDERTAKEN BY CERTIFIED AND LICENSED TECHNICIANS, AND NOT BY THE BUYER. THE BUYER ASSUMES ALL RISK AND LIABILITY ARISING OUT OF HIS OR HER REPAIRS TO THE ORIGINAL PRODUCT OR REPLACEMENT PARTS THERETO, OR ARISING OUT OF HIS OR HER INSTALLATION OF REPLACEMENT PARTS THERETO.

Limited 90 Day Warranty

Harbor Freight Tools Co. makes every effort to assure that its products meet high quality and durability standards, and warrants to the original purchaser that this product is free from defects in materials and workmanship for the period of 90 days from the date of purchase. This warranty does not apply to damage due directly or indirectly, to misuse, abuse, negligence or accidents, repairs or alterations outside our facilities, criminal activity, improper installation, normal wear and tear, or to lack of maintenance. We shall in no event be liable for death, injuries to persons or property, or for incidental, contingent, special or consequential damages arising from the use of our product. Some states do not allow the exclusion or limitation of incidental or consequential damages, so the above limitation of exclusion may not apply to you. THIS WARRANTY IS EXPRESSLY IN LIEU OF ALL OTHER WARRANTIES, EXPRESS OR IMPLIED, INCLUDING THE WARRANTIES OF MERCHANTABILITY AND FITNESS.

To take advantage of this warranty, the product or part must be returned to us with transportation charges prepaid. Proof of purchase date and an explanation of the complaint must accompany the merchandise. If our inspection verifies the defect, we will either repair or replace the product at our election or we may elect to refund the purchase price if we cannot readily and quickly provide you with a replacement. We will return repaired products at our expense, but if we determine there is no defect, or that the defect resulted from causes not within the scope of our warranty, then you must bear the cost of returning the product.

This warranty gives you specific legal rights and you may also have other rights which vary from state to state.

The logo for Haulmaster, featuring the word "HAULMASTER" in a bold, italicized, sans-serif font. The letters are white with a thick black outline, and the entire word is set against a dark, horizontal rectangular background.

26677 Agoura Road • Calabasas, CA 91302 • 1-888-866-5797