

# Owner's Manual & Safety Instructions

Save This Manual Keep this manual for the safety warnings and precautions, assembly, operating, inspection, maintenance and cleaning procedures. Write the product's serial number in the back of the manual near the assembly diagram (or month and year of purchase if product has no number). Keep this manual and the receipt in a safe and dry place for future reference.

21g

# **Bauer**<sup>TM</sup> **2021MH-B**

## **ADJUSTABLE ROLLER STAND WITH EDGE GUARD**



Visit our website at: <http://www.harborfreight.com>  
Email our technical support at: [productsupport@harborfreight.com](mailto:productsupport@harborfreight.com)

**58810**

When unpacking, make sure that the product is intact and undamaged. If any parts are missing or broken, please call 1-888-866-5797 as soon as possible.

### **⚠ WARNING**

Read this material before using this product. Failure to do so can result in serious injury. **SAVE THIS MANUAL.**

Copyright© 2021 by Harbor Freight Tools®. All rights reserved.  
No portion of this manual or any artwork contained herein may be reproduced in any shape or form without the express written consent of Harbor Freight Tools. Diagrams within this manual may not be drawn proportionally. Due to continuing improvements, actual product may differ slightly from the product described herein. Tools required for assembly and service may not be included.

## Specifications

Adjustable Height	27-3/4" – 43-1/2"
Ball Bearing Roller	11-1/2" L
Weight Capacity	250 lb

## Important Safety Information

### Assembly Precautions

---

1. Assemble only according to these instructions. Improper assembly can create hazards.
2. Wear ANSI-approved safety goggles and heavy-duty work gloves during assembly.
3. Keep assembly area clean and well lit.
4. Keep bystanders out of the area during assembly.
5. Do not assemble when tired or when under the influence of drugs or medication.
6. Weight capacity and other product capabilities apply to properly and completely assembled product only.

***Bauer***<sup>™</sup>

## Use Precautions

---

1. Wear ANSI-approved safety goggles and heavy-duty work gloves during use.
2. Do not exceed the Roller Stand's maximum weight capacity of 250 lb.  
**Be aware of dynamic loading!**  
Sudden load movement may briefly create excess load causing product failure.
3. Use the Roller Stand on a flat, level surface capable of supporting the weight of the Stand and the weight of the workpiece.
4. Do not wear loose clothing or jewelry as they can be caught in moving parts. Protective, electrically non-conductive clothes and non-skid footwear are recommended when working. Wear restrictive hair covering to contain long hair.
5. This product is not a toy. Do not allow children to play with or near this item.
6. Use as intended only. Do not use the Roller Stand to support people or animals.
7. Inspect before every use; do not use if parts are loose or damaged.
8. Maintain product labels and nameplates. These carry important safety information. If unreadable or missing, contact Harbor Freight Tools for a replacement.
9. The warnings, cautions, and instructions discussed in this instruction manual cannot cover all possible conditions and situations that may occur. It must be understood by the operator that common sense and caution are factors which cannot be built into this product, but must be supplied by the operator.

The logo for Bauer, featuring the word "Bauer" in a bold, italicized, sans-serif font. A small trademark symbol (TM) is located at the bottom right of the letter "r".

# Assembly Instructions

1. Remove the Outer Barrel Nut (9) making sure the Screw (2) remains screwed into the Inner Barrel Nut (10) inside the Base Bar (11).

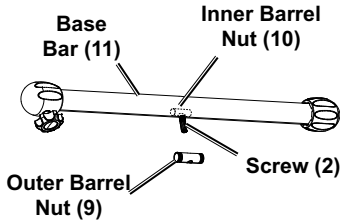

2. Insert the Outer Barrel Nut through the holes in the Leg (8).
3. Place the Base Bar onto the Leg. Attach Base Bar to Leg by threading Screw through Outer Barrel Nut, tighten securely.
4. Repeat on other leg.

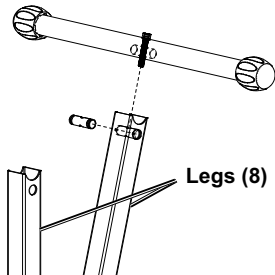

5. Turn stand right side up and fully open legs.

6. Slide the Extendable Arm (5) into the top opening of the Leg with its holes at the top and facing the front and back of the stand.

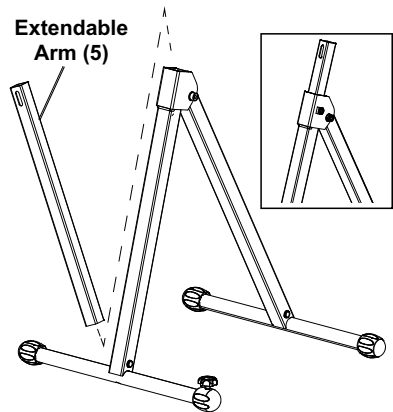

7. Insert the Lock Handle (7) through the Ring (6) and screw into the nut on the frame.

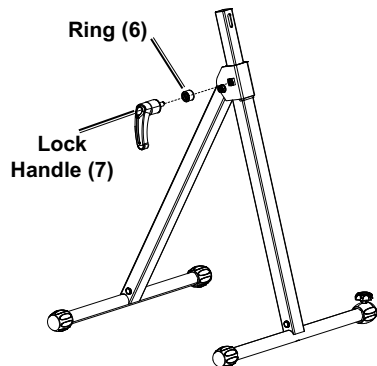

8. Attach the Roller Head (1) using two Screws (2) Flat Washers (3) and Locknuts (4). Tighten Securely.

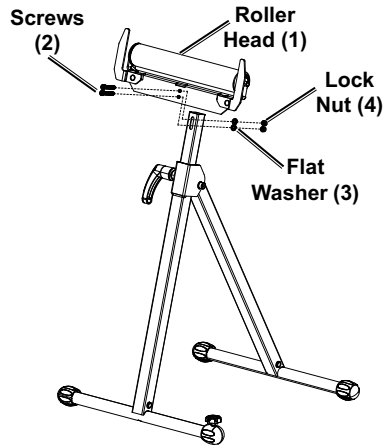

## Operation

1. Place the Roller Stand on a flat, level surface, capable of supporting the weight of the Stand and workpiece.
2. Level the Stand: if necessary, turn Adjustable Knob.
3. Adjust the height by loosening the Lock Handle. Raise or lower the Extension Arm to the desired height. Tighten Lock Handle securely.
4. After use lower Roller Head, fold Work Stand and store in dry location indoors out of childrens reach.

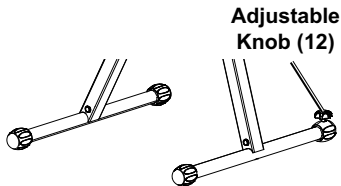

## Maintenance

1. Periodically check Roller Head and all hardware for tightness.
2. Periodically clean the Roller Stand with warm water and a soft cloth.

# Parts List

Part	Description	Qty
1	Roller Head	1
2	Screw	2
3	Flat Washer	2
4	Locknut	2
5	Extendable Arm	1
6	Ring	1
7	Lock Handle	2
8	Leg Base	2
9	Outer Barrel Nut	2
10	Inner Barrel Nut	2
11	Base Bar with Adjustable Knob	1
12	Adjustable Knob	1
13	Base Bar	1

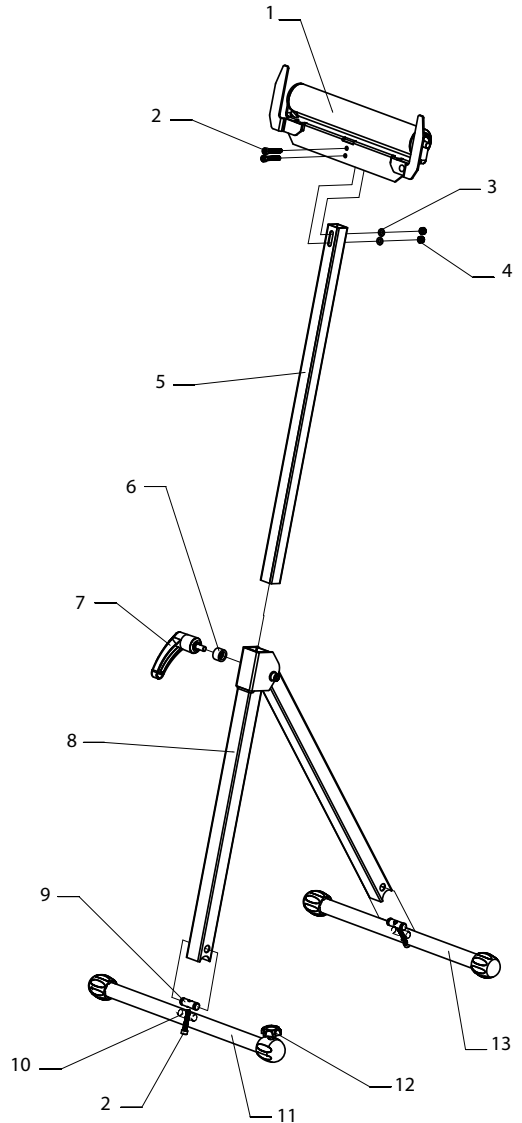

## PLEASE READ THE FOLLOWING CAREFULLY

---

THE MANUFACTURER AND/OR DISTRIBUTOR HAS PROVIDED THE PARTS LIST AND ASSEMBLY DIAGRAM IN THIS DOCUMENT AS A REFERENCE TOOL ONLY. NEITHER THE MANUFACTURER OR DISTRIBUTOR MAKES ANY REPRESENTATION OR WARRANTY OF ANY KIND TO THE BUYER THAT HE OR SHE IS QUALIFIED TO MAKE ANY REPAIRS TO THE PRODUCT, OR THAT HE OR SHE IS QUALIFIED TO REPLACE ANY PARTS OF THE PRODUCT. IN FACT, THE MANUFACTURER AND/OR DISTRIBUTOR EXPRESSLY STATES THAT ALL REPAIRS AND PARTS REPLACEMENTS SHOULD BE UNDERTAKEN BY CERTIFIED AND LICENSED TECHNICIANS, AND NOT BY THE BUYER. THE BUYER ASSUMES ALL RISK AND LIABILITY ARISING OUT OF HIS OR HER REPAIRS TO THE ORIGINAL PRODUCT OR REPLACEMENT PARTS THERETO, OR ARISING OUT OF HIS OR HER INSTALLATION OF REPLACEMENT PARTS THERETO.

### Record Serial Number Here:

---

**Note:** If product has no serial number, record month and year of purchase instead.

**Note:** Some parts are listed and shown for illustration purposes only, and are not available individually as replacement parts. Specify UPC 193175446916 when ordering parts.

The logo for Bauer, featuring the word "Bauer" in a bold, italicized, sans-serif font. The letters are black with a white outline, and a small trademark symbol (TM) is located at the bottom right of the letter 'r'.

## Limited 90 Day Warranty

Harbor Freight Tools Co. makes every effort to assure that its products meet high quality and durability standards, and warrants to the original purchaser that this product is free from defects in materials and workmanship for the period of 90 days from the date of purchase. This warranty does not apply to damage due directly or indirectly, to misuse, abuse, negligence or accidents, repairs or alterations outside our facilities, criminal activity, improper installation, normal wear and tear, or to lack of maintenance. We shall in no event be liable for death, injuries to persons or property, or for incidental, contingent, special or consequential damages arising from the use of our product. Some states do not allow the exclusion or limitation of incidental or consequential damages, so the above limitation of exclusion may not apply to you. THIS WARRANTY IS EXPRESSLY IN LIEU OF ALL OTHER WARRANTIES, EXPRESS OR IMPLIED, INCLUDING THE WARRANTIES OF MERCHANTABILITY AND FITNESS.

To take advantage of this warranty, the product or part must be returned to us with transportation charges prepaid. Proof of purchase date and an explanation of the complaint must accompany the merchandise. If our inspection verifies the defect, we will either repair or replace the product at our election or we may elect to refund the purchase price if we cannot readily and quickly provide you with a replacement. We will return repaired products at our expense, but if we determine there is no defect, or that the defect resulted from causes not within the scope of our warranty, then you must bear the cost of returning the product.

This warranty gives you specific legal rights and you may also have other rights which vary from state to state.

The logo for Bauer, featuring the word "Bauer" in a bold, italicized, sans-serif font. The letters are black with a white outline, and a small trademark symbol (TM) is located at the bottom right of the letter 'r'.