

Owner's Manual & Safety Instructions

Save This Manual Keep this manual for the safety warnings and precautions, assembly, operating, inspection, maintenance and cleaning procedures. Write the product's serial number in the back of the manual near the assembly diagram (or month and year of purchase if product has no number). Keep this manual and the receipt in a safe and dry place for future reference.

21j

ZURICH™

OBD2 WIRELESS DONGLE



Visit our website at: <http://www.harborfreight.com>
Email our technical support at: productsupport@harborfreight.com

59091

When unpacking, make sure that the product is intact and undamaged. If any parts are missing or broken, please call 1-888-866-5797 as soon as possible.

Copyright© 2021 by Harbor Freight Tools®. All rights reserved.





No portion of this manual or any artwork contained herein may be reproduced in any shape or form without the express written consent of Harbor Freight Tools. Diagrams within this manual may not be drawn proportionally. Due to continuing improvements, actual product may differ slightly from the product described herein. Tools required for assembly and service may not be included.

⚠WARNING

Read this material before using this product. Failure to do so can result in serious injury. **SAVE THIS MANUAL.**

Table of Contents

Safety	3	Operating Instructions.....	6
Specifications	5	Warranty	8
Overview.....	5		

WARNING SYMBOLS AND DEFINITIONS	
	<p>This is the safety alert symbol. It is used to alert you to potential personal injury hazards. Obey all safety messages that follow this symbol to avoid possible injury or death.</p>
 DANGER	<p>Indicates a hazardous situation which, if not avoided, will result in death or serious injury.</p>
 WARNING	<p>Indicates a hazardous situation which, if not avoided, could result in death or serious injury.</p>
 CAUTION	<p>Indicates a hazardous situation which, if not avoided, could result in minor or moderate injury.</p>
NOTICE CAUTION	<p>Addresses practices not related to personal injury.</p>



Important Safety Information

Work Area Safety

1. Keep your work area clean and well lit. Cluttered benches and dark areas may cause accidents.
2. Do not connect or disconnect the Code Reader while the ignition is on or the engine is running.
3. **DO NOT attempt to operate the Code Reader while driving the vehicle. Have a passenger operate the Code Reader.**
4. Before testing a vehicle, engage the parking brake and chock the tires.
5. NEVER smoke or allow a spark or flame in vicinity of battery or engine.
6. **Carbon Monoxide is produced while the vehicle's engine is operating and is deadly in a closed environment.** Early signs of carbon monoxide poisoning resemble the flu, with headaches, dizziness, or nausea. If you have these signs, the work area may not be vented properly. Get fresh air immediately. Operate the vehicle in a well-ventilated work area.
7. Do not operate the Code Reader in explosive atmospheres, such as in the presence of flammable liquids, gases, or heavy dust.
8. Keep a fire extinguisher suitable for gasoline/chemical/electrical fires nearby.
9. Use extreme caution when working around the ignition coil, distributor cap, ignition wires and spark plugs. These components create hazardous voltages when the engine is running.
10. Keep bystanders, children and visitors away while operating the Code Reader.
11. This product is not a toy. Do not allow children to play with or near this item.
12. Use as intended only.
13. Inspect before every use; do not use if parts are loose or damaged.
14. Do not place the Code Reader on any unstable surface.
15. Handle the Code Reader with care. If the Code Reader is dropped, check for breakage and any other conditions that may affect its operation.
16. Keep the Code Reader dry, clean, free from oil, water or grease. Use a mild detergent on a clean cloth to clean the outside of the Scan Tool, when necessary.
17. Store the Code Reader in a locked area out of the reach of children.
18. Maintain product labels and nameplates. These carry important safety information. If unreadable or missing, contact Harbor Freight Tools for a replacement.

Electrical Safety

1. Do not use the Code Reader while standing in water.
2. Avoid body contact with grounded surfaces such as pipes, radiators, ranges and refrigerators.
3. Do not expose the Code Reader to rain or wet conditions.
Water entering the Code Reader increases the risk of electric shock.
4. Make sure your hands are dry before operating the Code Reader.

Personal Safety

1. Wear ANSI-approved safety goggles during use.
2. Do not wear loose clothing or jewelry. Keep your hair, clothing, and gloves away from moving parts. Loose clothes, jewelry, or long hair can be caught in moving parts.
3. Do not use the Code Reader while tired or under the influence of drugs, alcohol, or medications. A moment of interruption can result in serious personal injury.
4. People with pacemakers should consult their physician(s) before use. Electromagnetic fields in close proximity to heart pacemaker could cause pacemaker interference or pacemaker failure.
5. The warnings, precautions, and instructions discussed in this instruction manual cannot cover all possible conditions and situations that may occur. It must be understood by the operator that common sense and caution are factors which cannot be built into this product, but must be supplied by the operator.

Service

There are no user serviceable parts. Code Reader service must be performed only by qualified repair personnel.

ZURICH[™]

Specifications

Working Voltage	12 V DC provided by vehicle battery
-----------------	-------------------------------------

Overview

OBD II On-Board Diagnostics

It is required by the EPA that all 1996 and newer vehicles sold in the United States be equipped with an OBD II computer system.

OBD II is an early warning system designed to monitor engine, transmission, and emissions control components by performing specific diagnostic tests.

When a fault condition is detected, the system captures important data and activates the "Check Engine" light.

If the light comes on, the vehicle might have a condition that wastes fuel, shortens engine life, or causes excessive air pollution. If the problem that caused the light to come on is addressed, for instance a loose gas cap is tightened, the light will go out.

If the light comes on and stays on, a minor engine fault condition is occurring and should be addressed as soon as possible.

If the light is blinking, a severe engine fault condition is occurring and should be addressed immediately.

The Code Reader connects to the vehicle's computer system and captures information that can help identify the fault condition.

Operation

1. Scan QR code for iOS,
Repair Solutions 2 App.

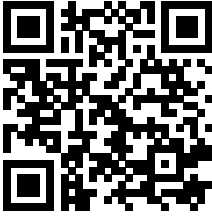

2. Scan QR code for Android,
Repair Solutions 2 App.

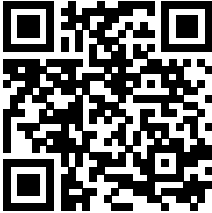

3. Download and open
Repair Solutions 2 App.

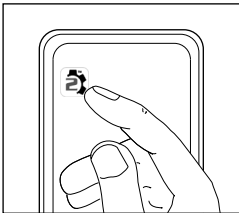

4. Type in Email Address, create
and confirm Password.

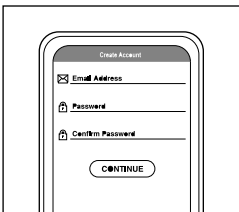

5. 16-pin DLC is usually located under
dashboard, within 12 inches of
center of panel, on driver's side
of most vehicles. Check vehicle's
service manual for exact location.

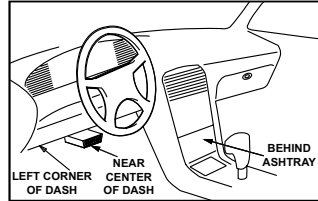

6. Connect Bluetooth Code Reader to
vehicle's Data Link Connector (DLC).

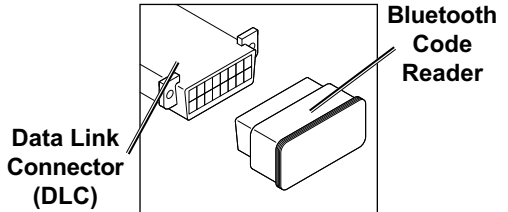

7. Turn ignition key to "Acc."
DO NOT start engine.

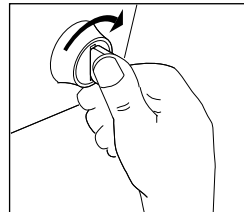

8. Press here and follow prompts.

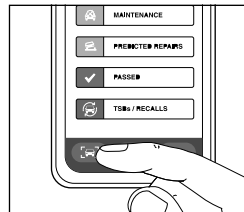

FCC ID - 2AMWOFC-BT825

This device complies with part 15 of the FCC Rules. Operation is subject to the following two conditions: (1) This device may not cause harmful interference and (2) this device must accept any interference received, including interference that may cause undesired operation.

Record Serial Number Here: _____

Note: If product has no serial number, record month and year of purchase instead.

Note: Some parts are listed and shown for illustration purposes only, and are not available individually as replacement parts. Specify UPC 193175454454 when ordering parts.

Limited 90 Day Warranty

Harbor Freight Tools Co. makes every effort to assure that its products meet high quality and durability standards, and warrants to the original purchaser that this product is free from defects in materials and workmanship for the period of 90 days from the date of purchase. This warranty does not apply to damage due directly or indirectly, to misuse, abuse, negligence or accidents, repairs or alterations outside our facilities, criminal activity, improper installation, normal wear and tear, or to lack of maintenance. We shall in no event be liable for death, injuries to persons or property, or for incidental, contingent, special or consequential damages arising from the use of our product. Some states do not allow the exclusion or limitation of incidental or consequential damages, so the above limitation of exclusion may not apply to you. THIS WARRANTY IS EXPRESSLY IN LIEU OF ALL OTHER WARRANTIES, EXPRESS OR IMPLIED, INCLUDING THE WARRANTIES OF MERCHANTABILITY AND FITNESS.

To take advantage of this warranty, the product or part must be returned to us with transportation charges prepaid. Proof of purchase date and an explanation of the complaint must accompany the merchandise. If our inspection verifies the defect, we will either repair or replace the product at our election or we may elect to refund the purchase price if we cannot readily and quickly provide you with a replacement. We will return repaired products at our expense, but if we determine there is no defect, or that the defect resulted from causes not within the scope of our warranty, then you must bear the cost of returning the product.

This warranty gives you specific legal rights and you may also have other rights which vary from state to state.

ZURICH™

26677 Agoura Road • Calabasas, CA 91302 • 1-888-866-5797