

Owner's Manual & Safety Instructions

Save This Manual Keep this manual for the safety warnings and precautions, assembly, operating, inspection, maintenance and cleaning procedures. Write the product's serial number in the back of the manual near the assembly diagram (or month and year of purchase if product has no number). Keep this manual and the receipt in a safe and dry place for future reference.

21j

CENTRAL[®] MACHINERY

DUST RECLAIMER KIT



For use with 60738 Industrial Blast Cabinet
Visit our website at: <http://www.harborfreight.com>
Email our technical support at: productsupport@harborfreight.com

59342

When unpacking, make sure that the product is intact and undamaged. If any parts are missing or broken, please call 1-888-866-5797 as soon as possible.

Copyright© 2021 by Harbor Freight Tools®. All rights reserved.
No portion of this manual or any artwork contained herein may be reproduced in any shape or form without the express written consent of Harbor Freight Tools. Diagrams within this manual may not be drawn proportionally. Due to continuing improvements, actual product may differ slightly from the product described herein.
Tools required for assembly and service may not be included.





⚠ WARNING

**Read this material before using this product.
Failure to do so can result in serious injury.
SAVE THIS MANUAL.**

Table of Contents

Safety	3	Maintenance	13
Specifications	6	Parts List and Diagram	14
Setup	7	Warranty	16
Operation.....	12		

CENTRAL[®] MACHINERY

WARNING SYMBOLS AND DEFINITIONS	
	This is the safety alert symbol. It is used to alert you to potential personal injury hazards. Obey all safety messages that follow this symbol to avoid possible injury or death.
	Indicates a hazardous situation which, if not avoided, will result in death or serious injury.
	Indicates a hazardous situation which, if not avoided, could result in death or serious injury.
	Indicates a hazardous situation which, if not avoided, could result in minor or moderate injury.
	Addresses practices not related to personal injury.

IMPORTANT SAFETY INFORMATION

General Tool Safety Warnings

⚠️WARNING

Read all safety warnings and instructions.

Failure to follow the warnings and instructions may result in electric shock, fire and/or serious injury.

Save all warnings and instructions for future reference.

1. KEEP GUARDS IN PLACE and in working order.
2. REMOVE ADJUSTING KEYS AND WRENCHES. Form habit of checking to see that keys and adjusting wrenches are removed from tool before turning it on.
3. KEEP WORK AREA CLEAN. Cluttered areas and benches invite accidents.
4. DON'T USE IN DANGEROUS ENVIRONMENT. Don't use power tools in damp or wet locations, or expose them to rain. Keep work area well lit.
5. KEEP CHILDREN AWAY. All visitors should be kept safe distance from work area.
6. MAKE WORKSHOP KID PROOF with padlocks, master switches, or by removing starter keys.
7. USE RIGHT TOOL. Don't force tool or attachment to do a job for which it was not designed.
8. USE PROPER EXTENSION CORD. Make sure your extension cord is in good condition. When using an extension cord, be sure to use one heavy enough to carry the current your product will draw. An undersized cord will cause a drop in line voltage resulting in loss of power and overheating. Table A shows the correct size to use depending on cord length and nameplate ampere rating. If in doubt, use the next heavier gauge. The smaller the gauge number, the heavier the cord.
9. WEAR PROPER APPAREL. Do not wear loose clothing, neckties, rings, bracelets, or other jewelry which may get caught in moving parts. Nonslip footwear is recommended. Wear protective hair covering to contain long hair.
10. ALWAYS USE SAFETY GLASSES. Also use face or dust mask if cutting operation is dusty. Everyday eyeglasses only have impact resistant lenses, they are NOT safety glasses.
11. MAINTAIN TOOLS WITH CARE. Keep tools clean for best and safest performance. Follow instructions for lubricating and changing accessories.
12. DISCONNECT TOOLS before servicing.
13. REDUCE THE RISK OF UNINTENTIONAL STARTING. Make sure switch is in off position before plugging in.
14. USE RECOMMENDED ACCESSORIES. Consult the owner's manual for recommended accessories. The use of improper accessories may cause risk of injury to persons.
15. CHECK DAMAGED PARTS. Before further use of the tool, a guard or other part that is damaged should be carefully checked to determine that it will operate properly and perform its intended function – check for alignment of moving parts, binding of moving parts, breakage of parts, mounting, and any other conditions that may affect its operation. A guard or other part that is damaged should be properly repaired or replaced.
16. NEVER LEAVE TOOL RUNNING UNATTENDED. TURN POWER OFF. Don't leave tool until it comes to a complete stop.

Table A: RECOMMENDED MINIMUM WIRE GAUGE FOR EXTENSION CORDS (120 VOLT)

NAMEPLATE AMPERES (at full load)	EXTENSION CORD LENGTH			
	25'	50'	100'	150'
0 – 6	18	16	16	14
6.1 – 10	18	16	14	12
10.1 – 12	16	16	14	12
12.1 – 16	14	12	Do not use.	

Grounding Instructions



⚠️ WARNING

TO PREVENT ELECTRIC SHOCK AND DEATH FROM INCORRECT GROUNDING WIRE CONNECTION READ AND FOLLOW THESE INSTRUCTIONS:

110-120 VAC Grounded Tools: Tools with Three Prong Plugs

1. In the event of a malfunction or breakdown, grounding provides a path of least resistance for electric current to reduce the risk of electric shock. This tool is equipped with an electric cord having an equipment-grounding conductor and a grounding plug. The plug must be plugged into a matching outlet that is properly installed and grounded in accordance with all local codes and ordinances.
2. Do not modify the plug provided – if it will not fit the outlet, have the proper outlet installed by a qualified electrician.
3. Improper connection of the equipment-grounding conductor can result in a risk of electric shock. The conductor with insulation having an outer surface that is green with or without yellow stripes is the equipment-grounding conductor. If repair or replacement of the electric cord or plug is necessary, do not connect the equipment-grounding conductor to a live terminal.
4. Check with a qualified electrician or service personnel if the grounding instructions are not completely understood, or if in doubt as to whether the tool is properly grounded.
5. Use only 3-wire extension cords that have 3-prong grounding plugs and 3-pole receptacles that accept the tool's plug.
6. Repair or replace damaged or worn cord immediately.
7. This tool is intended for use on a circuit that has an outlet that looks like the one illustrated above in **125 VAC 3-Prong Plug and Outlet**. The tool has a grounding plug that looks like the plug illustrated above in **125 VAC 3-Prong Plug and Outlet**.
8. The outlet must be properly installed and grounded in accordance with all codes and ordinances.
9. Do not use an adapter to connect this tool to a different outlet.

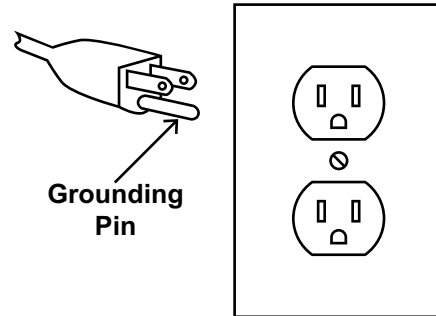

**125 VAC 3-Prong Plug and Outlet
(for up to 125 VAC and up to 15 A)**

Dust Reclaimer Safety Warnings

For Your Own Safety Read Instruction Manual Before Operating

1. Wear eye protection.
2. Do not use with any openings blocked. Keep openings clear of anything that may limit air flow or hinder motor operation.
3. Do not use the Reclaimer without its Filter (18) in place. Before each use, make sure the Filter is not clogged.
4. This product is designed only to pick up dry debris. Do not use the Dust Reclaimer to pick up water (or any other liquid) from the floor or containers such as sinks, tubs, barrels, etc.
5. When mounting the Dust Reclaimer to a wall surface, make sure the wall and the mounting hardware used (not included) are capable of supporting the weight of the Dust Reclaimer and its contents.
6. Prior to drilling mounting holes in a wall surface, check to make sure there are no hidden electrical cables, gas or plumbing pipes in the drilling path.
7. Do not use for abrasives containing crystalline silica. Silica containing abrasives have been linked to severe respiratory disease such as silicosis. Use proper abrasives such as aluminum oxide, glass bead, or walnut shell.
8. **DO NOT OPERATE WITH ANY GUARD DISABLED, DAMAGED, OR REMOVED.**
9. The use of accessories or attachments not recommended by the manufacturer may result in a risk of injury to persons.
10. When servicing use only identical replacement parts.
11. Only use safety equipment that has been approved by an appropriate standards agency. Unapproved safety equipment may not provide adequate protection. Eye protection must be ANSI-approved and breathing protection must be NIOSH-approved for the specific hazards in the work area.
12. Stay alert, watch what you are doing and use common sense when operating a power tool. Do not use a power tool while you are tired or under the influence of drugs, alcohol or medication. A moment of inattention while operating power tools may result in serious personal injury.
13. Industrial applications must follow OSHA guidelines.
14. Maintain labels and nameplates on the tool. These carry important safety information. If unreadable or missing, contact Harbor Freight Tools for a replacement.
15. Avoid unintentional starting. Prepare to begin work before turning on the tool.
16. People with pacemakers should consult their physician(s) before use. Electromagnetic fields in close proximity to heart pacemaker could cause pacemaker interference or pacemaker failure.
17. The warnings, precautions, and instructions discussed in this instruction manual cannot cover all possible conditions and situations that may occur. It must be understood by the operator that common sense and caution are factors which cannot be built into this product, but must be supplied by the operator.



SAVE THESE INSTRUCTIONS.

Specifications

Electrical Rating	120VAC / 60Hz / 12A
Motor No Load Speed	18,900 RPM
Product Compatibility	For use with 60738 Industrial Blast Cabinet
Capacity	Approximately 1-3/4 Gallons
Hose Size	2" Diameter x 3 Ft. Long

CENTRAL[®]
MACHINERY

Assembly



Read the **ENTIRE IMPORTANT SAFETY INFORMATION** section at the beginning of this manual including all text under subheadings therein before set up or use of this product.

WARNING

TO PREVENT SERIOUS INJURY FROM ACCIDENTAL OPERATION:
Turn the Power Switch of the tool off and unplug the tool from its electrical outlet before performing any procedure in this section.

Note: For additional information regarding the parts listed in the following pages, refer to the Assembly Diagram near the end of this manual.

The Dust Reclaimer Kit can be attached to a wall surface (see instructions below), or it can be mounted to the back of 60738 Industrial Blast Cabinet (see page 10).

How To Install The Dust Reclaimer To A Wall

IMPORTANT: The Wire Mesh Reinforced Hose (16B) supplied with the Dust Reclaimer is **3 feet long**. When determining a permanent location for the 60738 Blast Cabinet, make sure the Blast Cabinet is **within 3 feet** of the wall surface on which the Dust Reclaimer will be mounted. (See Figure F on page 9).

NOTE: You may wish to connect a *longer* Wire Mesh Reinforced Hose (not included) between the Blast Cabinet and Dust Reclaimer. If so, make sure the longer Hose has a **2" diameter**, and use a proper extension cord to connect the Power Cord Plug (12) of the Dust Reclaimer to the Lamp Housing on the Blast Cabinet.

1. Open the right side door of the blast cabinet. Remove the four screws on the exhaust board. Take out the exhaust board (see Figure A).
2. Install the Hose Connector (48) using four M5x12 bolts (47) as shown in Figure B below.

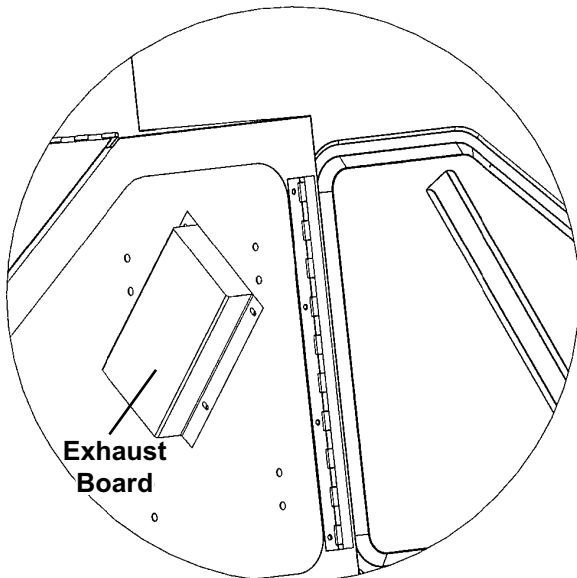

Figure A

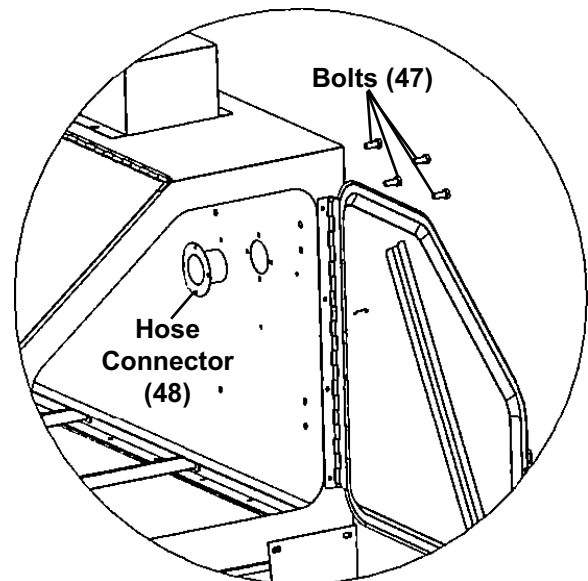

Figure B

3. Re-install the Exhaust Board over the Hose Connector (48) (see Figure A).

- Use the pattern in Figure C as a reference, or hold the assembled Dust Reclaimer against the wall where you intend to mount it, and mark the drill hole positions through the mounting holes.
- Drill holes in the wall to accept the Wall Anchors (33). Use a concrete drill bit that is 5/16" diameter.

NOTE: The Wall Anchors (33) are intended for concrete walls. If you are attaching the Dust Reclaimer Kit to drywall or wood you will need different fasteners (not included).

CAUTION! When mounting the Dust Reclaimer to a wall surface, make sure that the wall and the mounting hardware used are capable of supporting the weight of the Dust Reclaimer and its contents. Prior to drilling mounting holes in a wall surface, check to make sure there are no hidden electrical cables, gas or plumbing pipes in the drilling path.

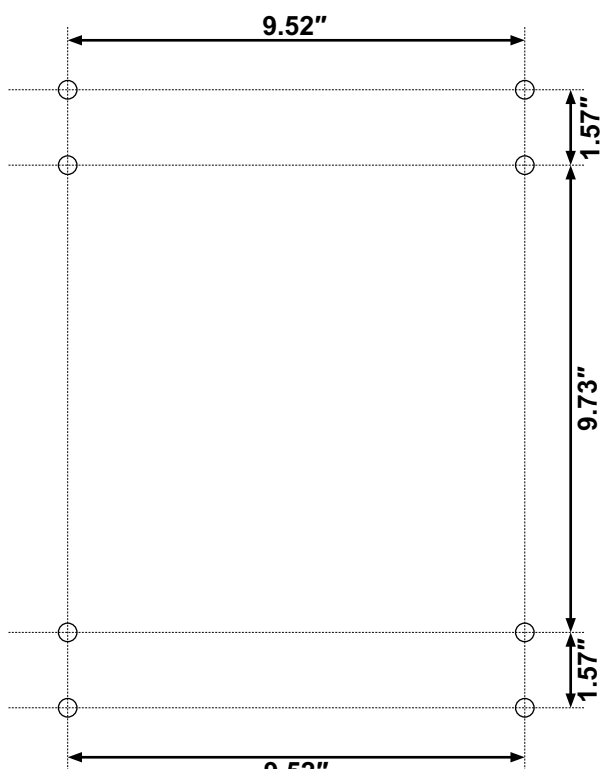

Figure C*
*Not to scale

- Tap the Wall Anchors (33) into the wall using a hammer. They will expand inside the wall when you thread a nut onto them. See Figure D below.

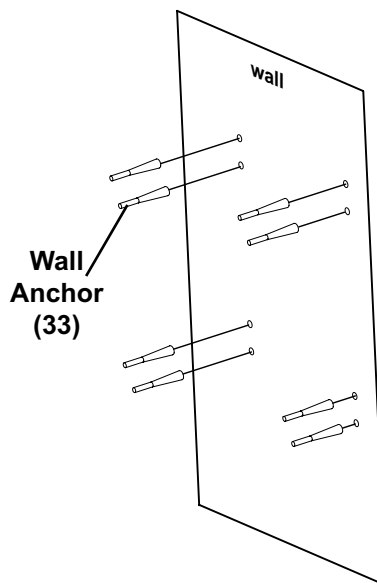

Figure D

- Attach the dust reclaimer to the wall using Washers (35), Spring Washers (36) and Nuts (46). See Figure E below.

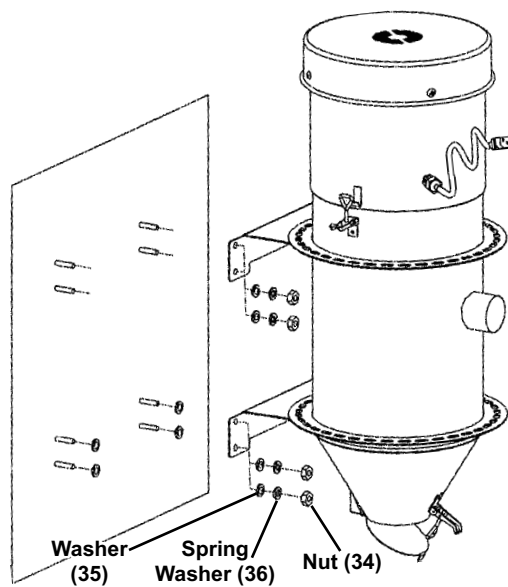

Figure E

8. Attach the blast cabinet to the Dust Reclaimer as shown in Figure F, then firmly tighten up the Hose Clamps (15).

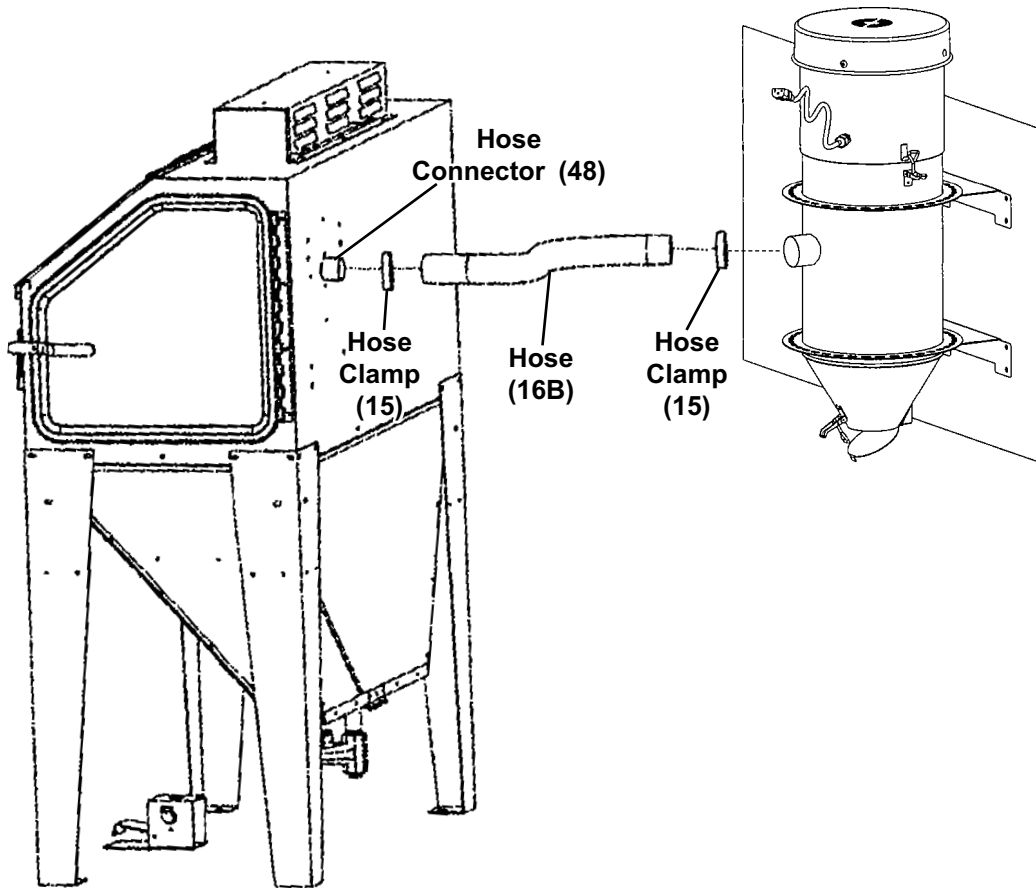

Figure F

CENTRAL[®]
MACHINERY

How To Install The Dust Reclaimer To A Blast Cabinet (60738)

1. Open the right side door of the blast cabinet. Remove the four screws on the exhaust board. Take out the Exhaust Board (see Figure G).

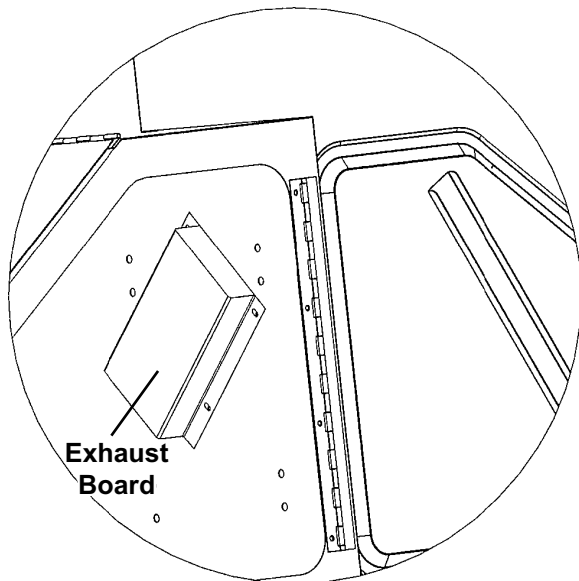

Figure G

2. Install the Hose Connector (48) using four Bolts (47) as shown in Figure H.

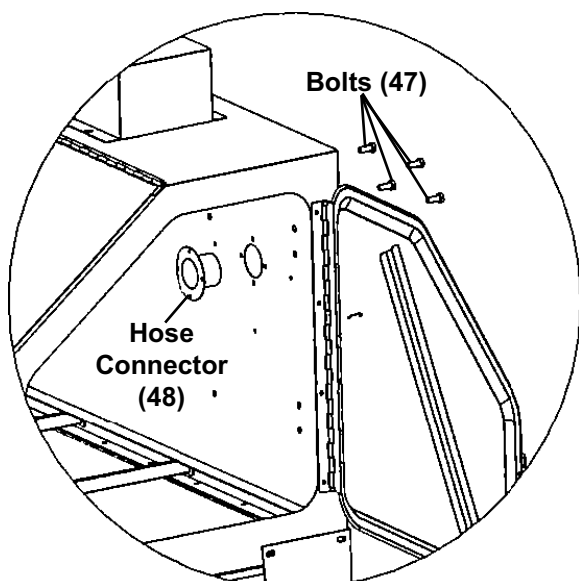

Figure H

3. Re-install the Exhaust Board as shown in Figure G.

4. Assemble the two Support Brackets (32) to the Housing (22A) using Bolts (28), Spring Washers (29), Washers (30), and Nuts (31). **Do not tighten the Nuts (31) completely at this point.** See Figure I.
5. Place the Support Brackets (32) on a flat surface. Adjust the position of the support brackets and the Dust Reclaimer hose nozzle until it looks like it does in Figure I.
6. Make sure the Support Brackets are parallel with the dust collector hose nozzle. After ensuring the support brackets center line is in line with that of the dust collector hose, firmly tighten the Nuts (31). See Figure I.

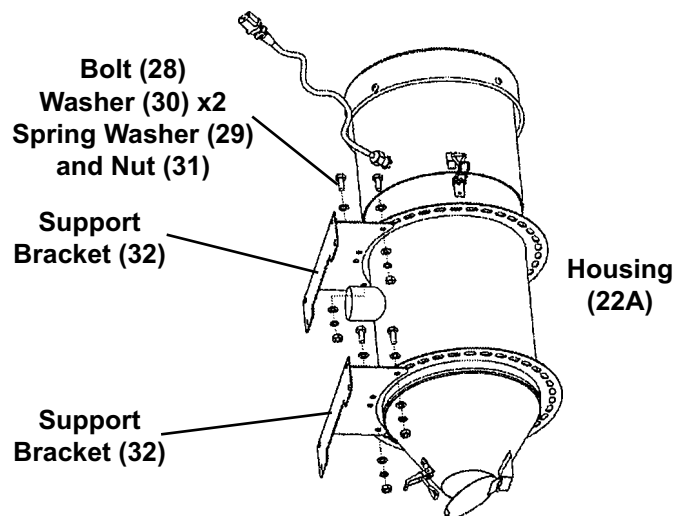

Figure I

7. There will be bolts and nuts already in the holes where the Dust Reclaimer will be attached to the Blast Cabinet. Remove the bolts and nuts. See Figure J.

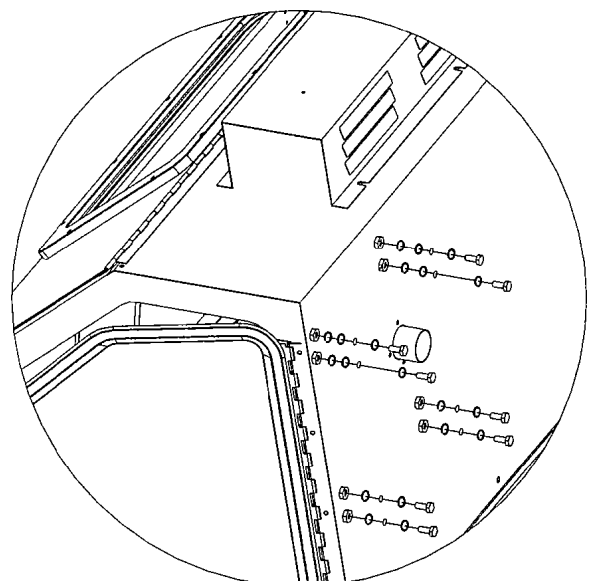

Figure J

8. Attach the Dust Reclaimer to Blast Cabinet using the Bolts (51), Flat Washers (44), Spring Washers (45) and Nuts (46). Parts 45 and 48 attach to the bolts from inside the cabinet. See Figure K.

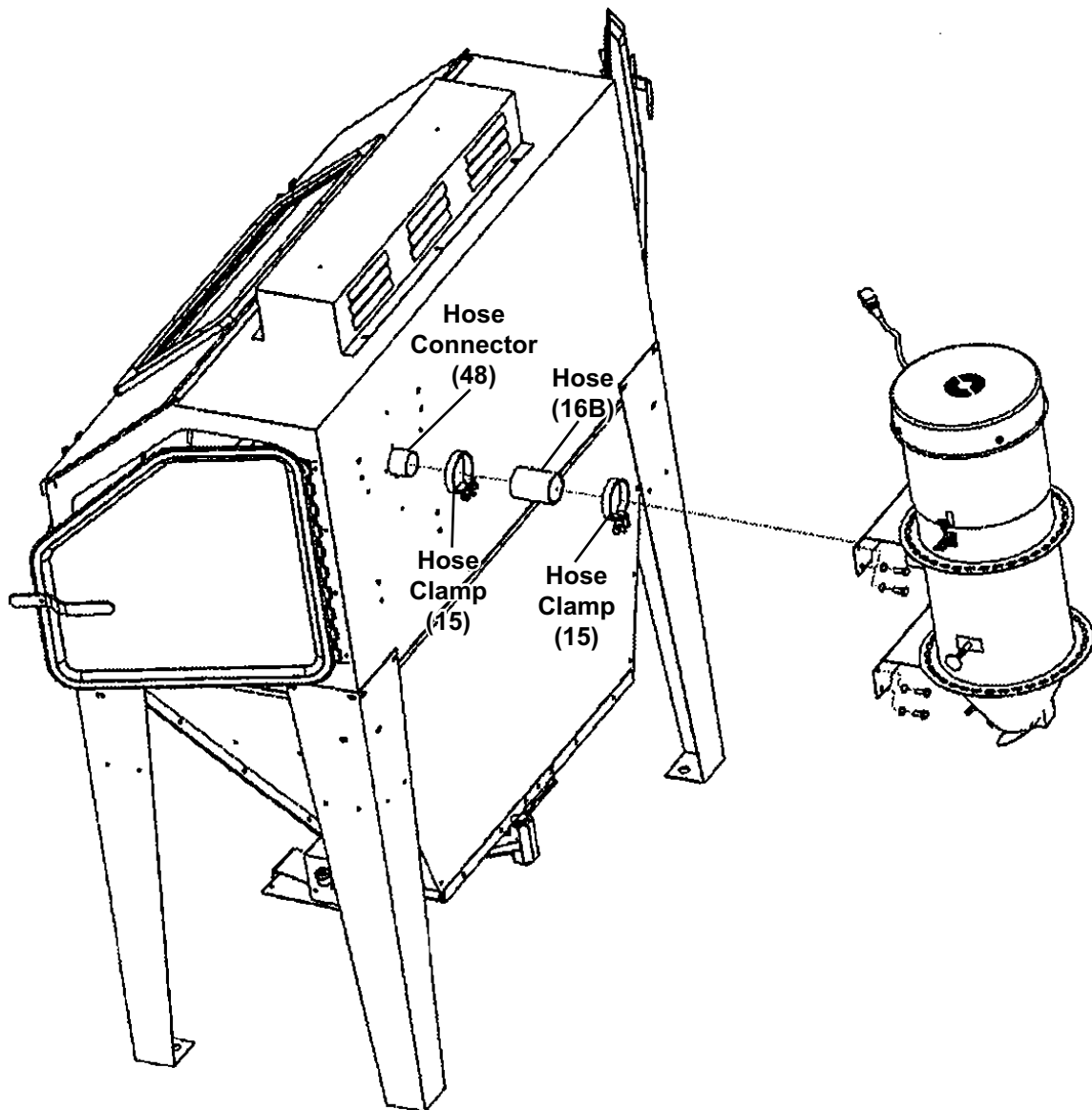

Figure K

Operating Instructions



Read the **ENTIRE IMPORTANT SAFETY INFORMATION** section at the beginning of this manual including all text under subheadings therein before set up or use of this product.

!WARNING

TO PREVENT SERIOUS INJURY FROM ACCIDENTAL OPERATION:

Turn the Power Switch of the tool off and unplug the tool from its electrical outlet before performing any procedure in this section.

PREVENT SERIOUS INJURY:

DO NOT OPERATE WITH ANY GUARD DISABLED, DAMAGED, OR REMOVED.

1. Make sure the Dust Collector Cap is closed and latched. Then, turn on the Dust Reclaimer using the Power Switch.
2. The Dust Reclaimer will immediately activate, drawing airborne particles out of the Blast Cabinet and into the Filter and Dust Housing of the Dust Reclaimer.
3. To prevent accidents, turn off the tool and disconnect its power supply after use.

Maintenance and Servicing



Procedures not specifically explained in this manual must be performed only by a qualified technician.

WARNING

TO PREVENT SERIOUS INJURY FROM ACCIDENTAL OPERATION:

Turn the Power Switch of the tool off and unplug the tool from its electrical outlet before performing any procedure in this section.

TO PREVENT SERIOUS INJURY FROM TOOL FAILURE:

Do not use damaged equipment. If abnormal noise or vibration occurs, have the problem corrected before further use.

1. **BEFORE EACH USE**, inspect the general condition of the tool. Check for:
 - loose hardware,
 - misalignment or binding of moving parts,
 - cracked or broken parts,
 - damaged electrical wiring,
 - plugged hose or suction port, and
 - any other condition that may affect its safe operation.
2. **AFTER USE**, wipe external surfaces of the tool with clean cloth.
3. Inadequate Blast Cabinet ventilation will result in reduced cleaning power as well as diminished view of the work in progress. Empty the Dust Reclaimer after every 20 to 30 minutes of Blast Cabinet use (more often in more dusty conditions):
 - a. Unplug the Power Cord from its electrical outlet.
 - b. Release the Latch (27), and open the Dust Collector Cap (26) at the bottom of the Dust Reclaimer. Then, allow the dust and debris to pour out into a proper waste container.
 - c. Push in and out on the Pull Rod (24) several times to help shake out any remaining dust and debris from the Dust Reclaimer.
 - d. Close the Dust Collector Cap (26), and refasten the Latch (27).
4. Periodically, remove the Filter (18) and use compressed air to blow out the dust and debris from the Filter to keep the Dust Reclaimer working efficiently. Replace the Filter as needed:
 - a. Unplug the Power Cord from its electrical outlet.
 - b. Remove the Radiating Guard (1) from the top of the Dust Reclaimer.
 - c. Remove the Filter (18), and clean with compressed air.
 - d. Replace the Filter (18) and Radiating Guard (1).
5. **WARNING!** If the supply cord of this power tool is damaged, it must be replaced only by a qualified service technician.

Troubleshooting

Problem	Possible Solutions
Dust Reclaimer does not turn on.	<ol style="list-style-type: none">1. Make sure the Power Switch (25) on is in its "ON" position.2. Make sure the Power Cord Plug of the Dust Reclaimer is properly connected to a working, 120 volt, grounded, electrical outlet.3. Have a qualified service technician check out the Dust Reclaimer and Blast Cabinet.
Poor visibility within the Blast Cabinet.	<ol style="list-style-type: none">1. Check to make sure Dust Reclaimer is on.2. Dust Reclaimer is filled. Empty and clean out Dust Reclaimer.3. Filter in Dust Reclaimer needs to be cleaned or replaced.4. Check to make sure there is no clogging in the Wire Mesh Reinforced Hose.5. Have a qualified service technician check out the Dust Reclaimer and Blast Cabinet.



Follow all safety precautions whenever diagnosing or servicing the tool. Disconnect power supply before service.

Parts List and Diagram

PLEASE READ THE FOLLOWING CAREFULLY

THE MANUFACTURER AND/OR DISTRIBUTOR HAS PROVIDED THE PARTS LIST AND ASSEMBLY DIAGRAM IN THIS MANUAL AS A REFERENCE TOOL ONLY. NEITHER THE MANUFACTURER OR DISTRIBUTOR MAKES ANY REPRESENTATION OR WARRANTY OF ANY KIND TO THE BUYER THAT HE OR SHE IS QUALIFIED TO MAKE ANY REPAIRS TO THE PRODUCT, OR THAT HE OR SHE IS QUALIFIED TO REPLACE ANY PARTS OF THE PRODUCT. IN FACT, THE MANUFACTURER AND/OR DISTRIBUTOR EXPRESSLY STATES THAT ALL REPAIRS AND PARTS REPLACEMENTS SHOULD BE UNDERTAKEN BY CERTIFIED AND LICENSED TECHNICIANS, AND NOT BY THE BUYER. THE BUYER ASSUMES ALL RISK AND LIABILITY ARISING OUT OF HIS OR HER REPAIRS TO THE ORIGINAL PRODUCT OR REPLACEMENT PARTS THERETO, OR ARISING OUT OF HIS OR HER INSTALLATION OF REPLACEMENT PARTS THERETO.

Parts List

Part	Description	Qty
1	Radiating Guard	1
2	Screw (M6x12)	4
3	Motor	1
4	Screw (M5x15)	4
5	Nut (M5)	4
6	Spring Washer	4
7	Motor Fixed Plate	4
8	nut (M6)	3
9	nut	1
10	Double Head Retaining Bolt	1
11	Retaining Nut	1
12	Power Cord	1
13	Protective Guard	1
14	Bolt (M5x20)	4
15	2" Hose Clamp	2
16A	Wire Mesh Reinforced Hose	1
16B	Wire Mesh Reinforced Hose	1
17	Mounting Base	1
18	Filter	1
19	Double Head Screw Rod	1
20	Flat Washer	1
21	Wing Nut (M6)	1

Part	Description	Qty
22A	Housing	1
23	Spring	1
24	Pull Rod	1
25	Power Switch	1
26	Dust Collector Cap	1
27	Latch	3
28	Bolt (M8x20)	6
29	Spring Washer	6
30	Flat Washer	12
31	Nut (M8)	6
32	Support Brackets	2
33	Wall Anchor	8
34	Nut	8
35	Flat Washer	8
36	Spring Washer	8
44	Flat Washer	8
45	Spring Washer	8
46	Nut M8	8
47	M5 x12 Bolt	4
48	Hose Connector	1
51	M8 x20 Bolt	8

Record Product's Serial Number Here: _____

Note: If product has no serial number, record month and year of purchase instead.

Note: Some parts are listed and shown for illustration purposes only, and are not available individually as replacement parts. Specify UPC 193175466174 when ordering parts.

Assembly Diagram

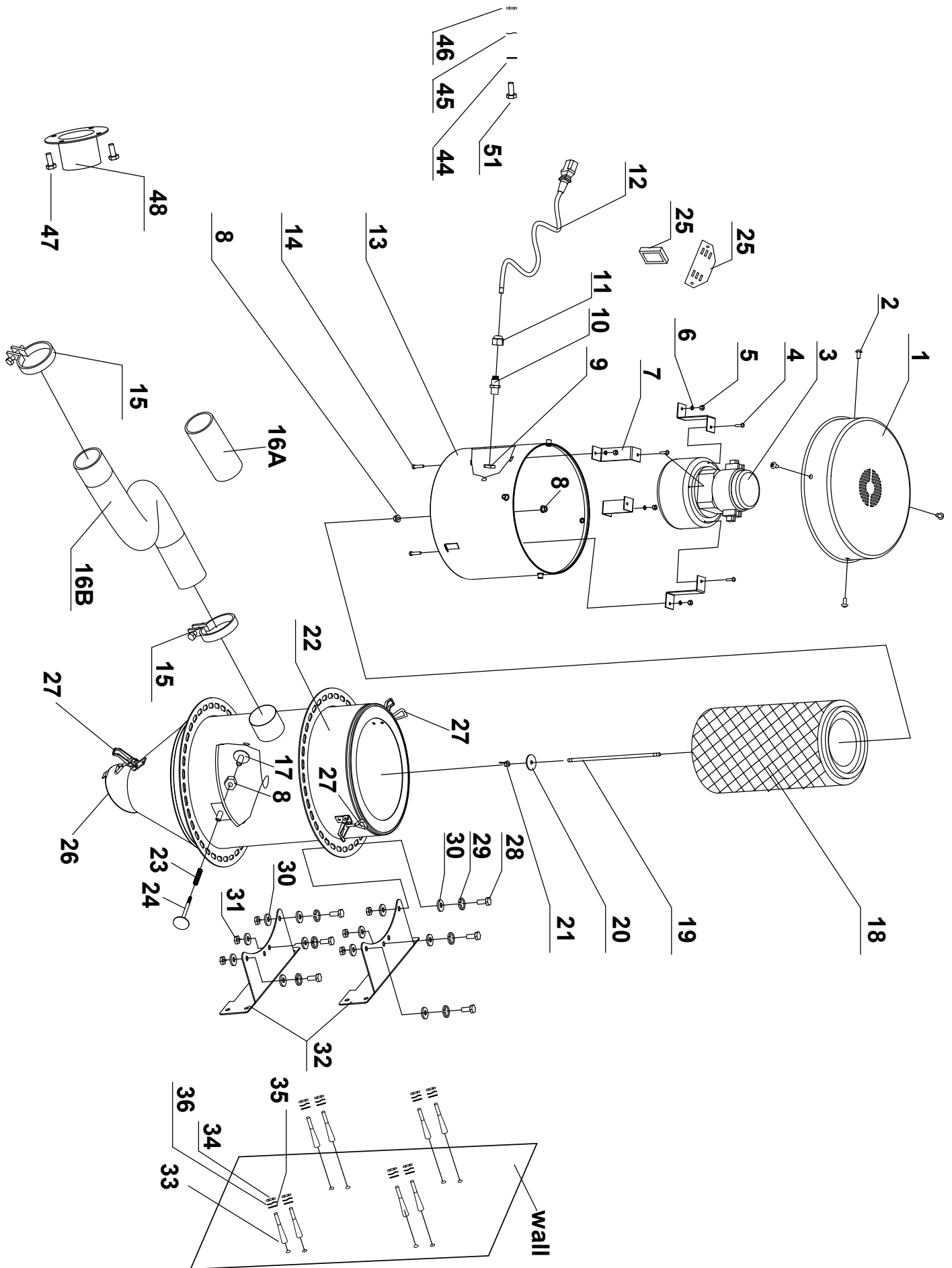

Limited 90 Day Warranty

Harbor Freight Tools Co. makes every effort to assure that its products meet high quality and durability standards, and warrants to the original purchaser that this product is free from defects in materials and workmanship for the period of 90 days from the date of purchase. This warranty does not apply to damage due directly or indirectly, to misuse, abuse, negligence or accidents, repairs or alterations outside our facilities, criminal activity, improper installation, normal wear and tear, or to lack of maintenance. We shall in no event be liable for death, injuries to persons or property, or for incidental, contingent, special or consequential damages arising from the use of our product. Some states do not allow the exclusion or limitation of incidental or consequential damages, so the above limitation of exclusion may not apply to you. THIS WARRANTY IS EXPRESSLY IN LIEU OF ALL OTHER WARRANTIES, EXPRESS OR IMPLIED, INCLUDING THE WARRANTIES OF MERCHANTABILITY AND FITNESS.

To take advantage of this warranty, the product or part must be returned to us with transportation charges prepaid. Proof of purchase date and an explanation of the complaint must accompany the merchandise. If our inspection verifies the defect, we will either repair or replace the product at our election or we may elect to refund the purchase price if we cannot readily and quickly provide you with a replacement. We will return repaired products at our expense, but if we determine there is no defect, or that the defect resulted from causes not within the scope of our warranty, then you must bear the cost of returning the product.

This warranty gives you specific legal rights and you may also have other rights which vary from state to state.

CENTRAL[®]
MACHINERY

26677 Agoura Road • Calabasas, CA 91302 • 1-888-866-5797