

Owner's Manual & Safety Instructions

Save This Manual Keep this manual for the safety warnings and precautions, assembly, operating, inspection, maintenance and cleaning procedures. Write the product's serial number in the back of the manual near the assembly diagram (or month and year of purchase if product has no number). Keep this manual and the receipt in a safe and dry place for future reference.

23f

TITANIUM™

WELDING TABLE

59403



Visit our website at: <http://www.harborfreight.com>
Email our technical support at: productsupport@harborfreight.com

When unpacking, make sure that the product is intact and undamaged. If any parts are missing or broken, please call 1-888-866-5797 as soon as possible.

Copyright© 2021 by Harbor Freight Tools®. All rights reserved.
No portion of this manual or any artwork contained herein may be reproduced in any shape or form without the express written consent of Harbor Freight Tools. Diagrams within this manual may not be drawn proportionally. Due to continuing improvements, actual product may differ slightly from the product described herein.
Tools required for assembly and service may not be included.

⚠ WARNING

Read this material before using this product.
Failure to do so can result in serious injury.
SAVE THIS MANUAL.

Specifications

Table Surface	36" x 24"
Table Height	33-1/4"
Maximum Weight Capacity	600 lb
Hole Diameter	5/8"
Hole Spacing	2"

IMPORTANT SAFETY INFORMATION

Assembly Precautions

1. Assemble only according to these instructions. Improper assembly can create hazards.
2. Wear ANSI-approved safety goggles and heavy-duty work gloves during assembly.
3. Keep assembly area clean and well lit.
4. Keep bystanders out of the area during assembly.
5. Do not assemble when tired or when under the influence of alcohol, drugs or medication.
6. Weight capacity and other product capabilities apply to properly and completely assembled product only.

Use Precautions

1. This product is not a toy. Do not allow children to play with or near this item.
2. Use as intended only. Do not sit or stand on Table.
3. Inspect before every use; do not use if parts are loose or damaged.
4. Use only on flat, level, hard surface.
5. Do not exceed listed weight capacity. Tighten all knobs securely before applying load.
Be aware of dynamic loading!
Sudden load movement may briefly create excess load causing product failure.
6. Maintain product labels and nameplates. These carry important safety information. If unreadable or missing, contact Harbor Freight Tools for a replacement.

TITANIUM™

Assembly Instructions



Read the **ENTIRE IMPORTANT SAFETY INFORMATION** section at the beginning of this document including all text under subheadings therein before set up or use of this product.

Note: For additional information regarding the parts listed in the following pages, refer to the Assembly Diagram near the end of this manual.

Unwrap and separate all parts on a clear work area.

Tabletop Only Configuration

1. Attach the four Short Legs (2) to the Tabletop (1). Screw two Bolts (6) into the outermost holes on each Short Leg. Secure with Nuts (7). See Figure A.
2. Screw the four Leveling Feet (5) into the bottom hole on each Short Leg. Leave Nuts (8) loose for now. Place the Tabletop Assembly in the upright position, and adjust the Leveling Feet as needed to level the Tabletop.
3. When the Tabletop (1) is level, turn it upside down again, and tighten all four Nuts (8) to lock the Leveling Feet (5) into position.

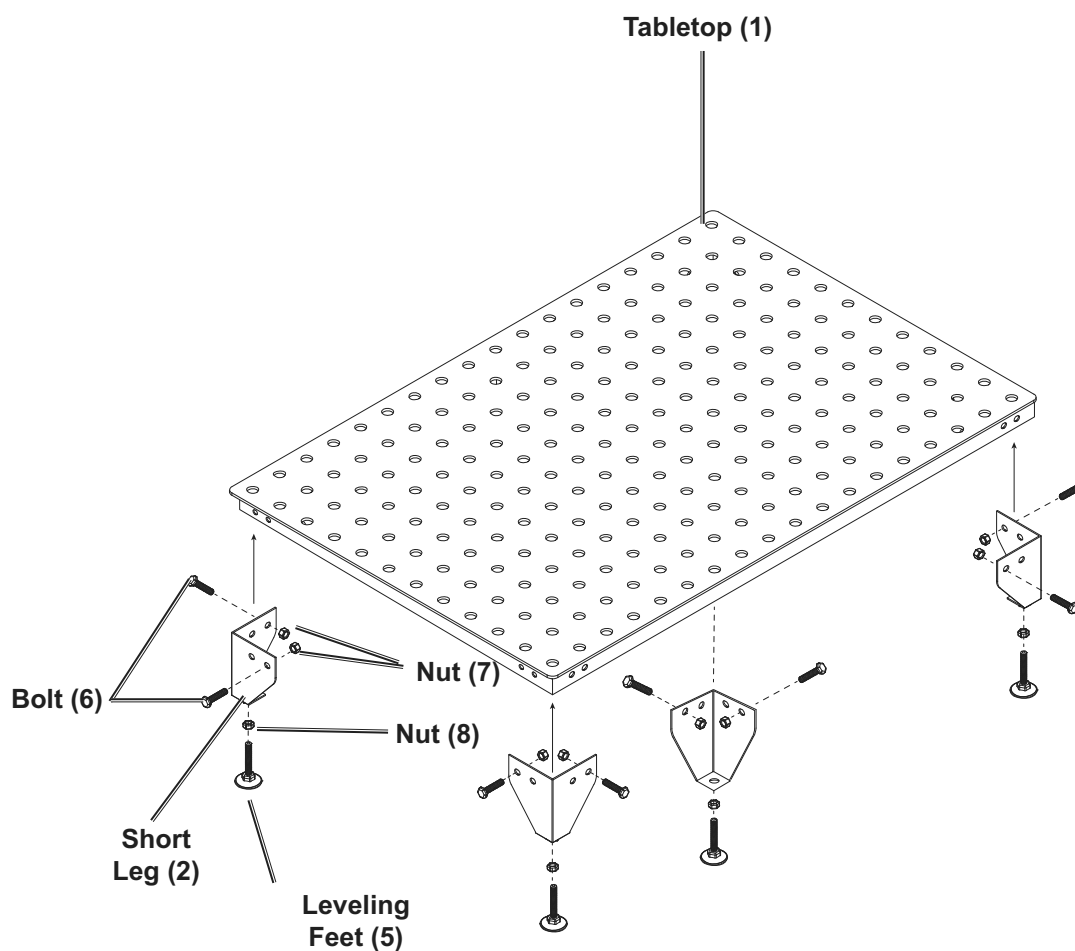

Figure A: Tabletop Configuration

Full Assembly Configuration

1. Attach the four Short Legs (2) to the Tabletop (1). Screw two Bolts (6) into the outermost holes on each Short Leg. Secure with Nuts (7). See Figure A on page 3.
2. Connect Leg Brace (4) to the Long Legs (3) using the holes in the middle of the Long Legs (3). See Figure B.

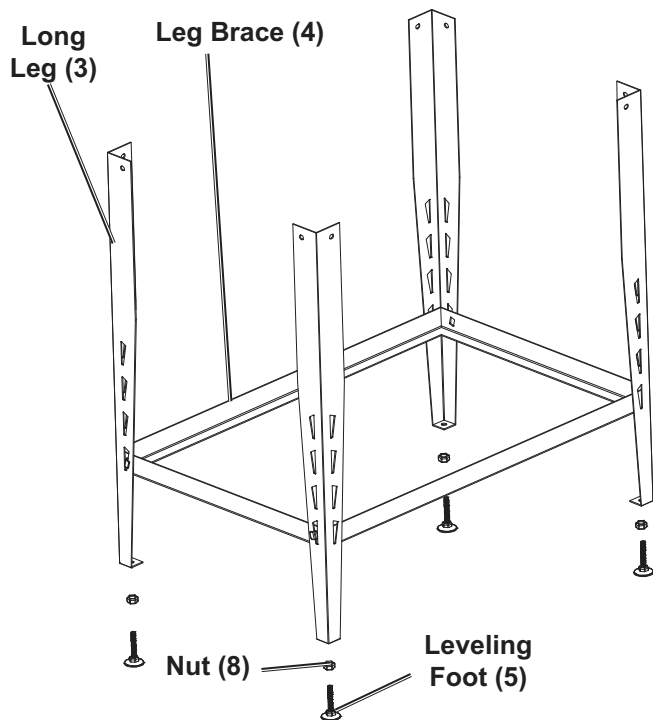

Figure B: Leg Brace (4) Attachment

Note: Use the same height holes on each Long Leg (3) to make sure the Leg Brace (4) will be level.

3. Place the Tabletop (1) upside down on a sturdy surface. Set the Leg Assembly over the Tabletop (1) and align the mounting holes on the Long Legs (3) with the mounting holes on the Short Legs (2). Use two Bolts (6) and Nuts (7) to secure each Long Leg (3) to the Table Top assembly. Tighten the Bolts (6) and Nuts (7). See Figure C.

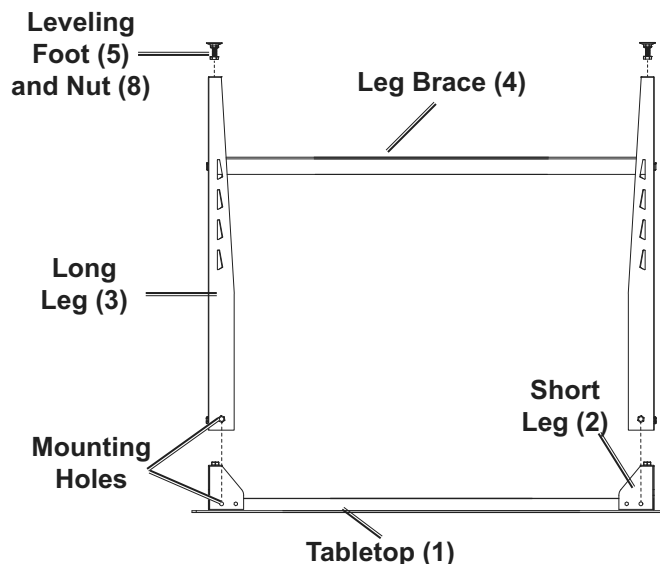

Figure C: Securing Leg Assembly to Tabletop (1)

4. Screw the four Leveling Feet (5) into the bottom hole on Long Leg (3). Leave Nuts (8) loose for now. Place the Tabletop Assembly in the upright position, and adjust the Leveling Feet as needed to level the Tabletop.
5. Place the assembled table in the upright position. Adjust the Leveling Feet as needed to level the table. When the Table Top is level, turn it upside down again, and tighten the Nuts (8) to lock the Leveling Feet into position.
6. When the Tabletop (1) is level, turn it upside down again, and tighten all four Nuts (8) to lock the Leveling Feet (5) into position.

Tools and Tool Mounting

1. Tools can be mounted to Tabletop (1) in any configuration. Make sure all tools are properly attached and secured before beginning work.
2. **Clamp:** Insert Clamp (14, 11) into any hole on Tabletop (1). Clamp may be used to secure workpiece.
3. **Stop Bar:** Mount Stop Bar (9, 11, 15) into any hole on Tabletop (1). Use Stop Bar to guide or stop workpiece. Use in conjunction with Threaded Adaptors (12).
4. **Threaded Adaptors:** Mount Threaded Adaptors (12) underneath Tabletop (1). Use to convert any Tabletop hole into an M10 threaded hole.
5. **V-Blocks and V-Spacers:** Place V-Spacer (13) into any hole on Tabletop (1), then place V-Block (10) on top of V-Spacer(13). Use to support rounded workpieces or parts.

Inspection, Maintenance, and Cleaning

1. **BEFORE EACH USE**, inspect the general condition of the Welding Table. Check for:
 - loose hardware
 - misalignment or binding of parts
 - cracked or broken parts
 - any other condition that may affect its safe operation.
2. **AFTER USE**, wipe external surfaces of the Table with clean cloth.

PLEASE READ THE FOLLOWING CAREFULLY

THE MANUFACTURER AND/OR DISTRIBUTOR HAS PROVIDED THE PARTS LIST AND ASSEMBLY DIAGRAM IN THIS DOCUMENT AS A REFERENCE TOOL ONLY. NEITHER THE MANUFACTURER OR DISTRIBUTOR MAKES ANY REPRESENTATION OR WARRANTY OF ANY KIND TO THE BUYER THAT HE OR SHE IS QUALIFIED TO MAKE ANY REPAIRS TO THE PRODUCT, OR THAT HE OR SHE IS QUALIFIED TO REPLACE ANY PARTS OF THE PRODUCT. IN FACT, THE MANUFACTURER AND/OR DISTRIBUTOR EXPRESSLY STATES THAT ALL REPAIRS AND PARTS REPLACEMENTS SHOULD BE UNDERTAKEN BY CERTIFIED AND LICENSED TECHNICIANS, AND NOT BY THE BUYER. THE BUYER ASSUMES ALL RISK AND LIABILITY ARISING OUT OF HIS OR HER REPAIRS TO THE ORIGINAL PRODUCT OR REPLACEMENT PARTS THERETO, OR ARISING OUT OF HIS OR HER INSTALLATION OF REPLACEMENT PARTS THERETO.

Parts List

Part	Description	Qty
1	Tabletop (with Bottom Frame)	1
2	Short Leg	4
3	Long Leg	4
4	Leg Brace	1
5	Leveling Foot	4
6	Bolt	16
7	Nut M8	16
8	Leveling Foot Nut M10	4

Part	Description	Qty
9	Stop Bars	4
10	V-Blocks	8
11	Stop Bars Cover Plate	4
12	Threaded Adaptors	4
13	V-Blocks-Spacers	4
14	Clamp	4
15	Bolt M10	8
16	Clamp Nut M12	4

Record Serial Number Here: _____

Note: If product has no serial number, record month and year of purchase instead.

Note: Some parts are listed and shown for illustration purposes only, and are not available individually as replacement parts. Specify UPC 193175469311 when ordering parts.

Assembly Diagram

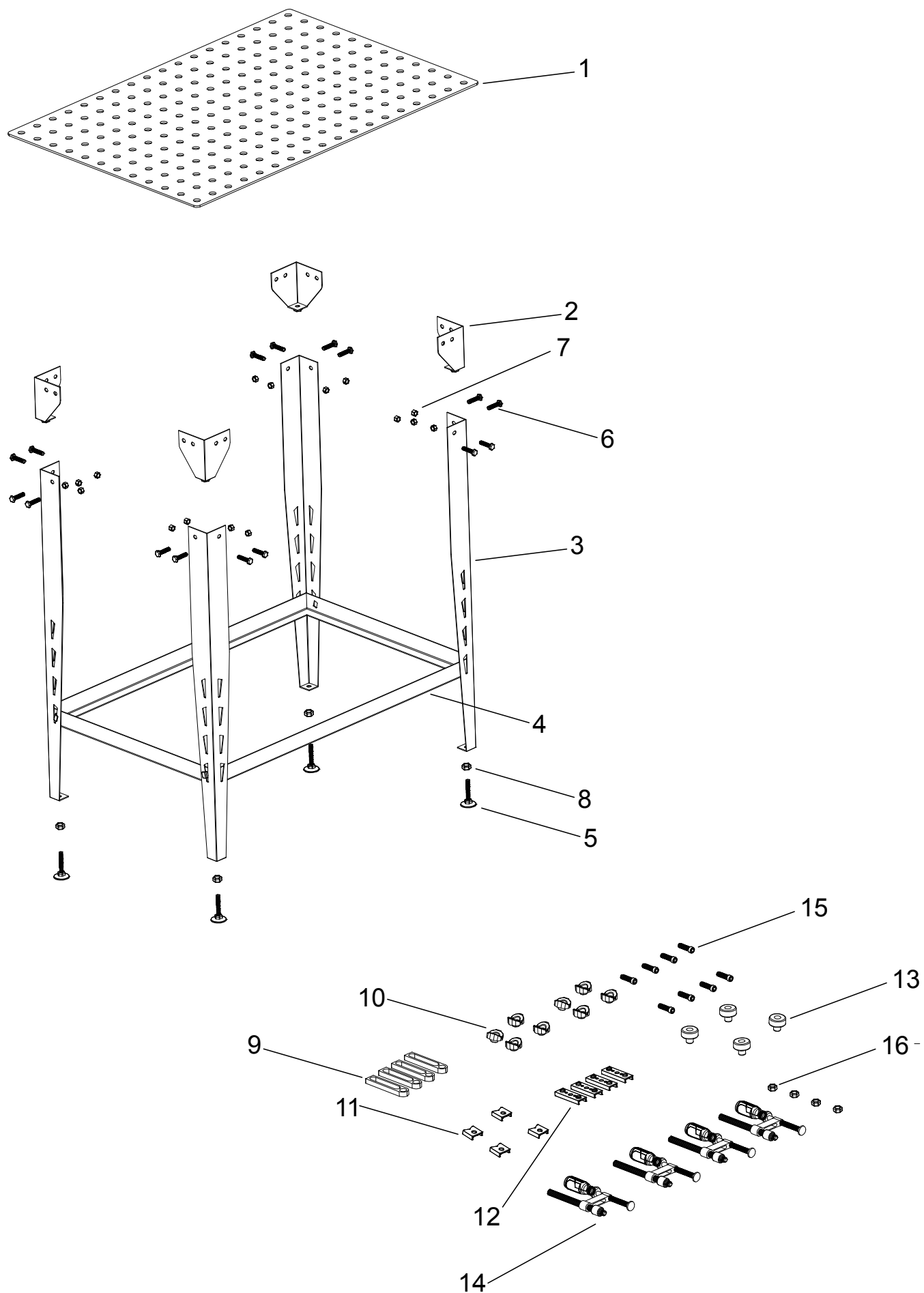

Limited 90 Day Warranty

Harbor Freight Tools Co. makes every effort to assure that its products meet high quality and durability standards, and warrants to the original purchaser that this product is free from defects in materials and workmanship for the period of 90 days from the date of purchase. This warranty does not apply to damage due directly or indirectly, to misuse, abuse, negligence or accidents, repairs or alterations outside our facilities, criminal activity, improper installation, normal wear and tear, or to lack of maintenance. We shall in no event be liable for death, injuries to persons or property, or for incidental, contingent, special or consequential damages arising from the use of our product. Some states do not allow the exclusion or limitation of incidental or consequential damages, so the above limitation of exclusion may not apply to you. THIS WARRANTY IS EXPRESSLY IN LIEU OF ALL OTHER WARRANTIES, EXPRESS OR IMPLIED, INCLUDING THE WARRANTIES OF MERCHANTABILITY AND FITNESS.

To take advantage of this warranty, the product or part must be returned to us with transportation charges prepaid. Proof of purchase date and an explanation of the complaint must accompany the merchandise. If our inspection verifies the defect, we will either repair or replace the product at our election or we may elect to refund the purchase price if we cannot readily and quickly provide you with a replacement. We will return repaired products at our expense, but if we determine there is no defect, or that the defect resulted from causes not within the scope of our warranty, then you must bear the cost of returning the product.

This warranty gives you specific legal rights and you may also have other rights which vary from state to state.

TITANIUMTM

26677 Agoura Road • Calabasas, CA 91302 • 1-888-866-5797