

# Owner's Manual & Safety Instructions

**Save This Manual** Keep this manual for the safety warnings and precautions, assembly, operating, inspection, maintenance and cleaning procedures. Write the product's serial number in the back of the manual (or month and year of purchase if product has no number). Keep this manual and the receipt in a safe and dry place for future reference.

24d

# CENTRAL<sup>™</sup> MACHINERY

## 2HP DUST COLLECTOR



Visit our website at: <http://www.harborfreight.com>  
Email our technical support at: [productsupport@harborfreight.com](mailto:productsupport@harborfreight.com)

59726

When unpacking, make sure that the product is intact and undamaged. If any parts are missing or broken, please call 1-888-866-5797 as soon as possible.

Copyright© 2024 by Harbor Freight Tools®. All rights reserved.  
No portion of this manual or any artwork contained herein may be reproduced in any shape or form without the express written consent of Harbor Freight Tools. Diagrams within this manual may not be drawn proportionally. Due to continuing improvements, actual product may differ slightly from the product described herein.  
Tools required for assembly and service may not be included.

### **⚠WARNING**

Read this material before using this product. Failure to do so can result in serious injury.  
**SAVE THIS MANUAL.**

# Table of Contents





|                      |   |                              |    |
|----------------------|---|------------------------------|----|
| Safety .....         | 2 | Maintenance .....            | 8  |
| Specifications ..... | 4 | Parts List and Diagram ..... | 10 |
| Setup .....          | 5 | Warranty .....               | 12 |
| Operation.....       | 7 |                              |    |

SAFETY

SETUP

OPERATION

MAINTENANCE

| WARNING SYMBOLS AND DEFINITIONS   |  |
|---|--|
|  | This is the safety alert symbol. It is used to alert you to potential personal injury hazards. Obey all safety messages that follow this symbol to avoid possible injury or death. |
|  | Indicates a hazardous situation which, if not avoided, will result in death or serious injury.   |
|  | Indicates a hazardous situation which, if not avoided, could result in death or serious injury.  |
|  | Indicates a hazardous situation which, if not avoided, could result in minor or moderate injury.   |
|  | Addresses practices not related to personal injury.  |

## Instructions Pertaining to a Risk of Fire, Electric Shock, or Injury to Persons

### IMPORTANT SAFETY INSTRUCTIONS

When using an electrical appliance, basic precautions should always be followed, including the following:

**READ ALL INSTRUCTIONS BEFORE USING THIS APPLIANCE.**

#### **WARNING**

To reduce the risk of fire, electric shock, or injury:

1. Do not leave appliance when plugged in. Unplug from outlet when not in use and before servicing.
2. Do not use outdoors or on wet surfaces.
3. Do not allow to be used as a toy. Close attention is necessary when used by or near children.
4. Use only as described in this manual. Use only manufacturer's recommended attachments.
5. Do not use with damaged cord or plug. If appliance is not working as it should, has been dropped, damaged, left outdoors, or dropped into water, return it to a service center.
6. Do not pull or carry by cord, use cord as a handle, close a door on cord, or pull cord around sharp edges or corners. Do not run appliance over cord. Keep cord away from heated surfaces.
7. Do not unplug by pulling on cord. To unplug, grasp the plug, not the cord.
8. Do not handle plug or appliance with wet hands.
9. Do not put any object into openings. Do not use with any opening blocked; keep free of dust, lint, hair, and anything that may reduce air flow.
10. Keep hair, loose clothing, fingers, and all parts of body away from openings and moving parts.
11. Turn off all controls before unplugging.
12. Use extra care when cleaning on stairs.
13. Do not use to pick up flammable or combustible liquids, such as gasoline, or use in areas where they may be present.
14. Connect to a properly grounded outlet only. See Grounding Instructions.
15. **Do not pick up anything that is burning or smoking, such as cigarettes, matches, or hot ashes.**

16. **Do not use without dust bag and/or filters in place.**
17. FOR HOUSEHOLD USE ONLY.
18. Stay alert, watch what you are doing and use common sense when operating an appliance. Do not use an appliance while you are tired or under the influence of drugs, alcohol or medication. A moment of inattention while operating appliances may result in serious personal injury.
19. Maintain labels and nameplates on the appliance. These carry important safety information. If unreadable or missing, contact Harbor Freight Tools for a replacement.
20. People with pacemakers should consult their physician(s) before use. Electromagnetic fields in close proximity to heart pacemaker could cause pacemaker interference or pacemaker failure.
21. The warnings, precautions, and instructions discussed in this instruction manual cannot cover all possible conditions and situations that may occur. It must be understood by the operator that common sense and caution are factors which cannot be built into this product, but must be supplied by the operator.



## SAVE THESE INSTRUCTIONS

### Grounding Instructions

This appliance must be grounded. If it should malfunction or breakdown, grounding provides a path of least resistance for electric current to reduce the risk of electric shock. This appliance is equipped with a cord having an equipment-grounding conductor and grounding plug. The plug must be inserted into an appropriate outlet that is properly installed and grounded in accordance with all local codes and ordinances.

### **!WARNING**

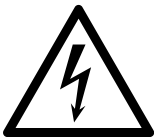

Improper connection of the equipment-grounding conductor can result in a risk of electric shock. Check with a qualified electrician or service person if you are in doubt as to whether the outlet is properly grounded. Do not modify the plug provided with the appliance – if it will not fit the outlet, have a proper outlet installed by a qualified electrician.

This appliance is for use on a nominal 120-V circuit and has a grounding attachment plug that looks like the plug illustrated in **125 VAC 3-Prong Plug and Outlet**. Make sure that the appliance is connected to an outlet having the same configuration as the plug. No adaptor should be used with this appliance.

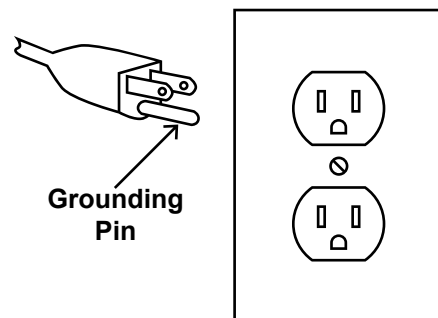

**125 VAC 3-Prong Plug and Outlet**  
(for up to 125 VAC and up to 15 A)

# Extension Cords

SAFETY

1. **Grounded** tools require a three wire extension cord. **Double Insulated** tools can use either a two or three wire extension cord.
2. As the distance from the supply outlet increases, you must use a heavier gauge extension cord. Using extension cords with inadequately sized wire causes a serious drop in voltage, resulting in loss of power and possible tool damage. (See Table A.) The smaller the gauge number of the wire, the greater the capacity of the cord. For example, a 14 gauge cord can carry a higher current than a 16 gauge cord. (See Table A.)
3. When using more than one extension cord to make up the total length, make sure each cord contains at least the minimum wire size required. (See Table A.)
4. If you are using one extension cord for more than one tool, add the nameplate amperes and use the sum to determine the required minimum cord size. (See Table A.)
5. If you are using an extension cord outdoors, make sure it is marked with the suffix "W-A" ("W" in Canada) to indicate it is acceptable for outdoor use.

6. Make sure the extension cord is properly wired and in good electrical condition. Always replace a damaged extension cord or have it repaired by a qualified electrician before using it.
7. Protect the extension cords from sharp objects, excessive heat, and damp or wet areas.

| RECOMMENDED MINIMUM WIRE GAUGE FOR EXTENSION CORDS* (120/240 VOLT) |                       |     |     |      |      |
|--|-----------------------|-----|-----|------|------|
| NAMEPLATE AMPERES (at full load)                                   | EXTENSION CORD LENGTH |     |     |      |      |
|  | 25'                   | 50' | 75' | 100' | 150' |
| 0 – 2.0  | 18                    | 18  | 18  | 18   | 16   |
| 2.1 – 3.4  | 18                    | 18  | 18  | 16   | 14   |
| 3.5 – 5.0  | 18                    | 18  | 16  | 14   | 12   |
| 5.1 – 7.0  | 18                    | 16  | 14  | 12   | 12   |
| 7.1 – 12.0   | 18                    | 14  | 12  | 10   | -    |
| 12.1 – 16.0  | 14                    | 12  | 10  | -    | -    |
| 16.1 – 20.0  | 12                    | 10  | -   | -    | -    |

**TABLE A** \* Based on limiting the line voltage drop to five volts at 150% of the rated amperes.

SETUP

## Symbology

|                          |                                      |
|--------------------------|--------------------------------------|
| <b>VAC</b>               | Volts Alternating Current            |
| <b>A</b>                 | Amperes                              |
| n <sub>0</sub> xxxx/min. | No Load Revolutions per Minute (RPM) |
| <b>CFM</b>               | Cubic Feet Per Minute                |

OPERATION

## Specifications

|                      |  |
|----------------------|--|
| Electrical Rating    | 120VAC / 60Hz / 14A<br>2HP, Single Phase |
| Speed                | 3450 RPM                                 |
| Bag Capacity         | 35 Gallon                                |
| Bag Filtration Ratio | 5 Microns                                |
| Inlet                | 4"                                       |
| Air Flow             | 1550 CFM                                 |

MAINTENANCE

## Setup - Before Use:



Read the **ENTIRE IMPORTANT SAFETY INFORMATION** section at the beginning of this manual including all text under subheadings therein before set up or use of this product.

## WARNING

### TO PREVENT SERIOUS INJURY FROM ACCIDENTAL OPERATION:

Turn the Power Switch of the appliance off and unplug the appliance from its electrical outlet before performing any procedure in this section.

**Note:** For additional information regarding the parts listed in the following pages, refer to the Assembly Diagram near the end of this manual.

## Assembly

**Note:** Your Dust Collector will require complete assembly prior to use. It is important that you read the entire manual to become familiar with the product BEFORE you use the Dust Collector. Before assembling the Dust Collector be sure that you have all parts described in the Parts List and Assembly Diagram.

1. Place Caster (1) in place on the underside corner of the Base Plate (3). Connect Caster (1) to Base Plate (3) using 4 Hex Screws (23), Washers (16) and Nuts (19). Repeat for the remaining three Casters (1).
2. Attach the first Collector Support (14) to the Base Plate (3). Line up the Collector Support (14) with holes on edge of the Base Plate (3). Secure with two sets of Hex Screws (6), and Washers (4).

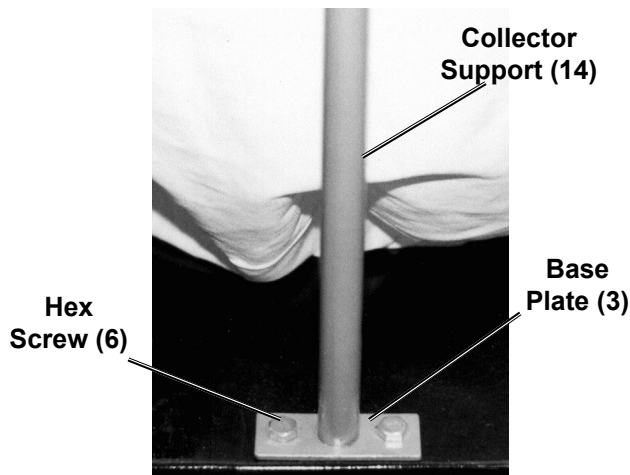

3. Repeat for the second Collector Support (14) on the opposite edge of the Base Plate (3).

4. Attach the third Collector Support (14) through the inside holes near where the Motor Base (5) will be mounted. Secure with two sets of Hex Screws (6), and Washers (4).

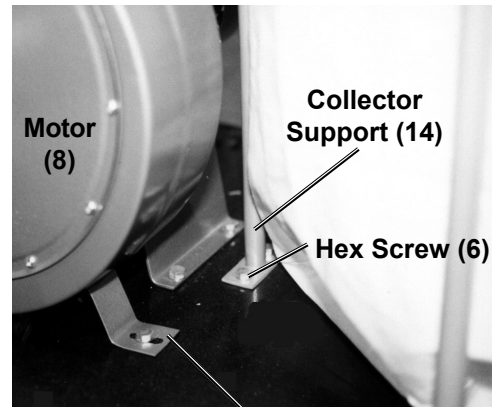

5. Attach the Motor Base to the Base Plate using four M8 Washers (4), and four Hex Bolts (6).
6. Attach the Motor (8) to the Motor Plate using two sets of four M8 Washers (4), four Hex Bolts (41), and four M8 Nuts (2).

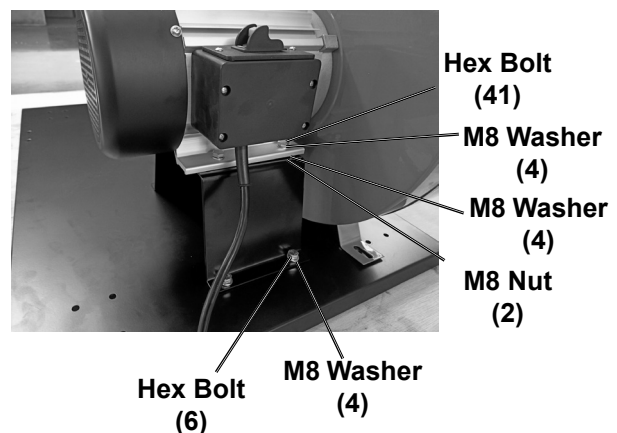

7. The Fan Housing (38) is attached to the Motor (8) and Motor Base (5) as a single unit. Secure the Motor Base (5) to the Base Plate (3) using six Hex Screws (6).

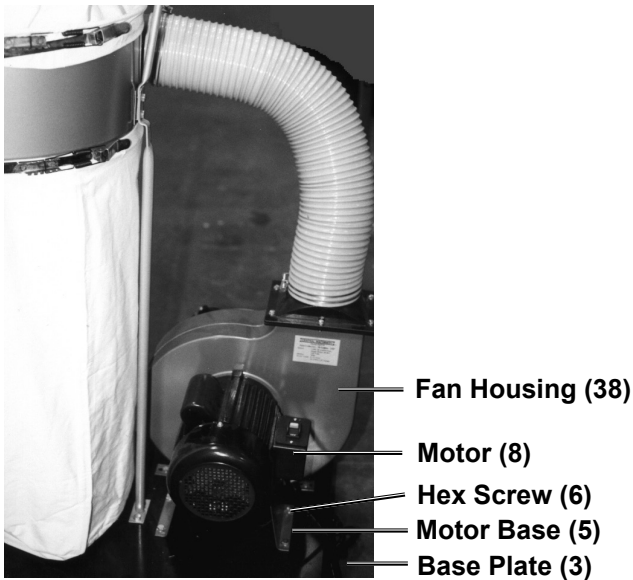

8. Set the Packing (29) on top of the rectangular opening on the Fan Housing (38). Set the Outlet (30) on top of the Packing (29). Secure the Outlet and the Packing to the Fan Housing (38) by using six sets of Hex Screws (15), Washers (16) and Nuts (19).

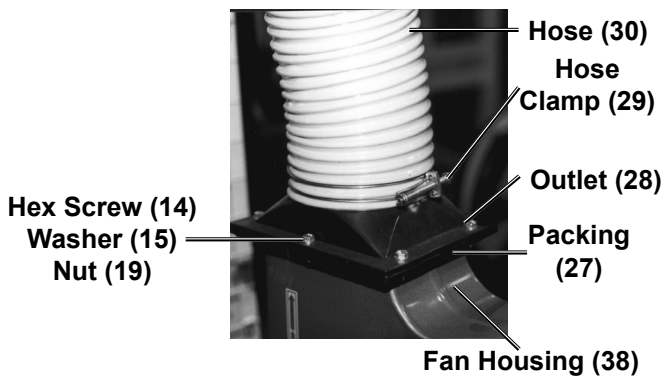

9. Connect the Upper Bag Support (13) to the Collector Support (14) and Collector (33) using Washers (4) and Hex Screws (6).

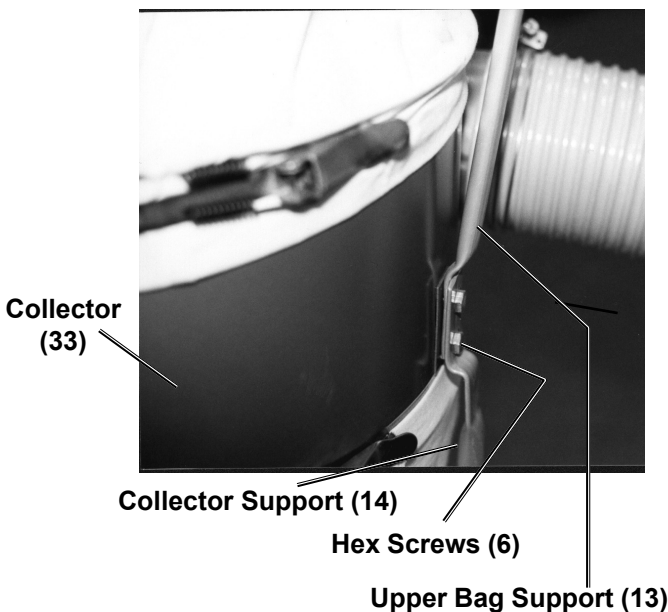

10. Attach the other two Collector Supports (13) to the Collector (31) using Hex Screws (6).
11. Slide a Hose Clamp (29) onto the Hose (30). Slide Hose (30) onto the Outlet (28). Once the Hose (30) is in place, tighten the screw on the Hose Clamp (29) until the Hose (30) is securely fastened to the Outlet (28).
12. Slide the remaining Hose Clamp (29) onto the other end of the Hose (30). Slide the opening of the Hose (30) over the duct in the Collector (31). Tighten the Hose Clamp (29) until the Hose (30) is securely fastened.
13. Attach Handle (35) to Collector (31) using Washers (4) and Nut and Bolt set (37).

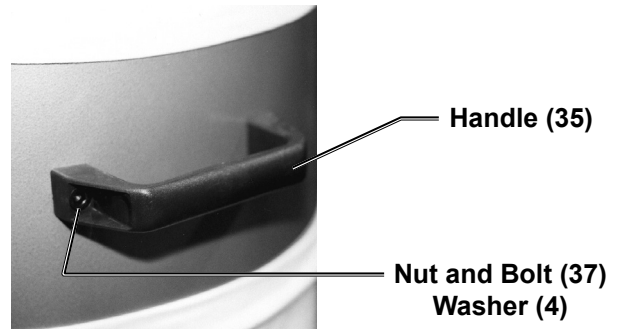

14. Place the Filter Bag (33) on top of the Collector (31). Place Clamp (32) so that the clip rests between the teeth. Press the Clamp (32) down to lock in place. Extend the bag so that the loop on the top hangs on the Upper Bag Support (12).
15. Place the Collection Bag (34) on the bottom of the Collector (31) and secure it with a Clamp (32) as in step 9.
16. Install the Inlet (24) onto the Inlet Cover (25) and secure using Cap Screw (44).

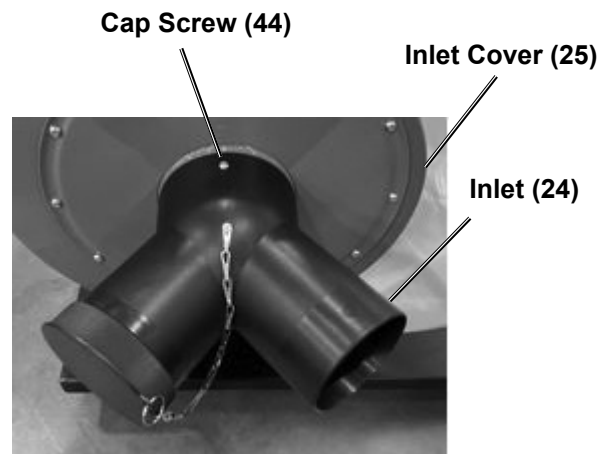

## Operating Instructions



Read the **ENTIRE IMPORTANT SAFETY INFORMATION** section at the beginning of this manual including all text under subheadings therein before set up or use of this product.

## Workpiece and Work Area Setup

### **⚠️ WARNING**

**TO PREVENT SERIOUS INJURY FROM ACCIDENTAL OPERATION:**

**Turn the Power Switch of the appliance off and unplug the appliance from its electrical outlet before performing any procedure in this section.**

1. Designate a work area that is clean and well lit. The work area must not allow access by children or pets to prevent injury and distraction.
2. Route the power cord along a safe route to reach the work area without creating a tripping hazard or exposing the power cord to possible damage. The power cord must reach the work area with enough extra length to allow free movement while working.
3. Secure loose workpieces using a vise or clamps (not included) to prevent movement while working.
4. There must not be hazardous objects such as utility lines or foreign objects, nearby that will present a hazard while working.

## General Operating Instructions

1. If constructing a new system, connect 4" vent pipe (not included) to the 4" Inlet (23) side of the Collector (31).
2. Determine the size of the dust ports on your tools and run vacuum hoses (not included) from each tool to an appropriate sized adapter (not included), and into the 4" vent pipe (not included).
3. Tighten Bag Clamp (32) on Collection Bag (34) so that there are no leaks.
4. Switch on the unit using the toggle Switch (9).
5. During operation, periodically check how full the Collection Bag (34) is. Do not let it fill more than 3/4 full.
6. When removing Collection Bag (34), wear ANSI-approved safety goggles, and a dust mask. Remove the Bag Clamp (32) and empty the bag. Reinstall the Bag (34) and Bag Clamp (32).
7. To prevent accidents, turn off the tool, remove Switch Key, and disconnect its power supply after use. Clean, then store the tool indoors out of children's reach.

**WARNING!** TO PREVENT SERIOUS INJURY:

Do not tamper with or remove the grounding pole on the plug. You must use this unit with a 3 pole receptacle. If you use an extension cord, it must meet amperage specified (see Table A on page 4), and the cord must be 3-pronged.

**CENTRAL<sup>TM</sup>**  
**MACHINERY**

## User-maintenance and Storage



Procedures not specifically explained in this manual must be performed only by a qualified technician.

### **⚠️ WARNING**

**TO PREVENT SERIOUS INJURY FROM ACCIDENTAL OPERATION:**

Turn the Power Switch of the appliance off and unplug the appliance from its electrical outlet before performing any procedure in this section.

**TO PREVENT SERIOUS INJURY FROM APPLIANCE FAILURE:**

Do not use damaged equipment. If abnormal noise or vibration occurs, have the problem corrected before further use.

## Cleaning, Maintenance, and Lubrication

1. **BEFORE EACH USE**, inspect the general condition of the appliance. Check for:
  - loose hardware,
  - misalignment or binding of moving parts,
  - cracked or broken parts,
  - damaged electrical wiring, and
  - any other condition that may affect its safe operation.
2. **AFTER USE**, wipe external surfaces of the appliance with clean cloth. Store in an indoor dry area out of reach of children.
3. Check Collection Bags (34) prior to each use for tears or fraying. Replace if necessary.
4. Periodically tighten the Belts (32) and Hose Clamps (29).
5. Keep the Motor (8) clean of dirt and debris.
6. **⚠️ WARNING! If the supply cord of this appliance is damaged, it must be replaced only by a qualified service technician.**



## PLEASE READ THE FOLLOWING CAREFULLY

---

THE MANUFACTURER AND/OR DISTRIBUTOR HAS PROVIDED THE PARTS LIST AND ASSEMBLY DIAGRAM IN THIS MANUAL AS A REFERENCE TOOL ONLY. NEITHER THE MANUFACTURER OR DISTRIBUTOR MAKES ANY REPRESENTATION OR WARRANTY OF ANY KIND TO THE BUYER THAT HE OR SHE IS QUALIFIED TO MAKE ANY REPAIRS TO THE PRODUCT, OR THAT HE OR SHE IS QUALIFIED TO REPLACE ANY PARTS OF THE PRODUCT. IN FACT, THE MANUFACTURER AND/OR DISTRIBUTOR EXPRESSLY STATES THAT ALL REPAIRS AND PARTS REPLACEMENTS SHOULD BE UNDERTAKEN BY CERTIFIED AND LICENSED TECHNICIANS, AND NOT BY THE BUYER. THE BUYER ASSUMES ALL RISK AND LIABILITY ARISING OUT OF HIS OR HER REPAIRS TO THE ORIGINAL PRODUCT OR REPLACEMENT PARTS THERETO, OR ARISING OUT OF HIS OR HER INSTALLATION OF REPLACEMENT PARTS THERETO.

SAFETY

SETUP

OPERATION

MAINTENANCE

**Record Product's Serial Number Here:** \_\_\_\_\_

**Note:** If product has no serial number, record month and year of purchase instead.

**Note:** Some parts are listed and shown for illustration purposes only, and are not available individually as replacement parts. Specify UPC 193175553706 when ordering parts.

**Parts List**

SAFETY

SETUP

OPERATION

MAINTENANCE

| Part | Description          | Qty |
|------|----------------------|-----|
| 1    | Caster, 3" Lockable  | 4   |
| 2    | Nut M8               | 6   |
| 3    | Base Plate           | 1   |
| 4    | Washer 8             | 28  |
| 5    | Motor Base           | 1   |
| 6    | Hex Bolt M8x16       | 18  |
| 7    | Power Cord           | 1   |
| 8    | Motor 120v,60Hz, 2hp | 1   |
| 9    | Switch               | 1   |
| 10   | Self-Set Screw 4x12  | 2   |
| 12   | Hex Wrench 5mm       | 1   |
| 13   | Upper Bag Support    | 1   |
| 14   | Collector Support    | 3   |
| 15   | Hex Screw M6x20      | 6   |
| 16   | Washer 6             | 28  |
| 17   | Key                  | 1   |
| 18   | Packing              | 1   |
| 19   | Nut M6               | 22  |
| 20   | Washer M10           | 4   |
| 21   | Hex Screw M10x16     | 4   |
| 22   | Turbo Fan            | 1   |
| 23   | Hex Screw M6x10      | 28  |
| 24   | Inlet 1x5" - 2x4"    | 1   |
| 25   | Inlet Cover          | 1   |
| 26   | Hex Screw M6x20      | 1   |
| 27   | Washer               | 1   |

| Part | Description           | Qty |
|------|-----------------------|-----|
| 29   | Packing               | 1   |
| 30   | Outlet                | 1   |
| 31   | Hose Clamp            | 2   |
| 32   | Hose                  | 1   |
| 33   | Collector             | 1   |
| 34   | Bag Clamp             | 2   |
| 35   | Filter Bag            | 1   |
| 36   | Collector Bag         | 1   |
| 37   | Handle                | 1   |
| 38   | Fan Housing           | 1   |
| 39   | Bolts&Nuts For Handle | 2   |
| 40   | Hex Wrench 6mm        | 1   |
| 41   | Hex Screw M8x25       | 4   |
| 42   | Belt                  | 1   |
| 43   | Packing               | 1   |
| 44   | Cap Screw             | 1   |
| 45   | Cover                 | 1   |
| 46   | Switch Box            | 1   |
| 47   | Switch Box Cover      | 1   |
| 48   | Screw ST4x60          | 4   |
| 49   | Screw                 | 1   |
| 50   | Washer                | 1   |
| 51   | Screw                 | 1   |
| 52   | Chain                 | 1   |
| 53   | Ring                  | 1   |

# Assembly Diagram

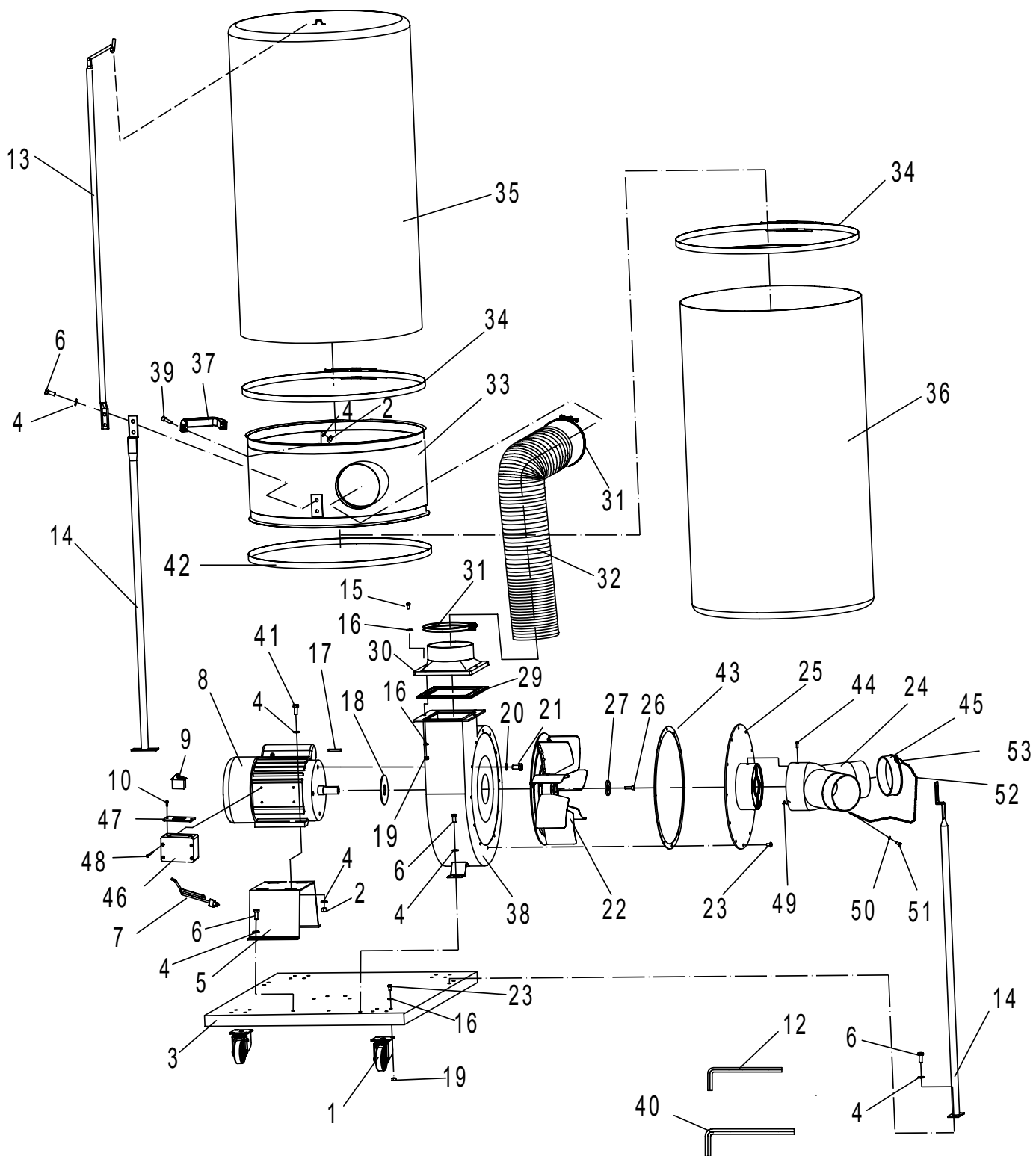

SAFETY

SETUP

OPERATION

MAINTENANCE

## Limited 90 Day Warranty

Harbor Freight Tools Co. makes every effort to assure that its products meet high quality and durability standards, and warrants to the original purchaser that this product is free from defects in materials and workmanship for the period of 90 days from the date of purchase. This warranty does not apply to damage due directly or indirectly, to misuse, abuse, negligence or accidents, repairs or alterations outside our facilities, criminal activity, improper installation, normal wear and tear, or to lack of maintenance. We shall in no event be liable for death, injuries to persons or property, or for incidental, contingent, special or consequential damages arising from the use of our product. Some states do not allow the exclusion or limitation of incidental or consequential damages, so the above limitation of exclusion may not apply to you. THIS WARRANTY IS EXPRESSLY IN LIEU OF ALL OTHER WARRANTIES, EXPRESS OR IMPLIED, INCLUDING THE WARRANTIES OF MERCHANTABILITY AND FITNESS.

To take advantage of this warranty, the product or part must be returned to us with transportation charges prepaid. Proof of purchase date and an explanation of the complaint must accompany the merchandise. If our inspection verifies the defect, we will either repair or replace the product at our election or we may elect to refund the purchase price if we cannot readily and quickly provide you with a replacement. We will return repaired products at our expense, but if we determine there is no defect, or that the defect resulted from causes not within the scope of our warranty, then you must bear the cost of returning the product.

This warranty gives you specific legal rights and you may also have other rights which vary from state to state.

**CENTRAL**<sup>™</sup>  
**MACHINERY**

26677 Agoura Road • Calabasas, CA 91302 • 1-888-866-5797