

# Owner's Manual & Safety Instructions

Save This Manual Keep this manual for the safety warnings and precautions, assembly, operating, inspection, maintenance and cleaning procedures. Write the product's serial number in the back of the manual near the assembly diagram (or month and year of purchase if product has no number). Keep this manual and the receipt in a safe and dry place for future reference.

231

# CENTRAL<sup>®</sup> MACHINERY 1 TON ARBOR PRESS



59766

Visit our website at: <http://www.harborfreight.com>  
Email our technical support at: [productsupport@harborfreight.com](mailto:productsupport@harborfreight.com)

When unpacking, make sure that the product is intact and undamaged. If any parts are missing or broken, please call 1-888-866-5797 as soon as possible.

Copyright© 2022 by Harbor Freight Tools®. All rights reserved.

No portion of this manual or any artwork contained herein may be reproduced in any shape or form without the express written consent of Harbor Freight Tools. Diagrams within this manual may not be drawn proportionally. Due to continuing improvements, actual product may differ slightly from the product described herein. Tools required for assembly and service may not be included.






## **⚠WARNING**

Read this material before using this product. Failure to do so can result in serious injury. SAVE THIS MANUAL.

# Table of Contents

Important Safety Information .....	2	Maintenance .....	9
Specifications .....	4	Parts List and Diagram .....	10
Assembly .....	5	Warranty .....	12
Operation .....	7		

## WARNING SYMBOLS AND DEFINITIONS

	This is the safety alert symbol. It is used to alert you to potential personal injury hazards. Obey all safety messages that follow this symbol to avoid possible injury or death.
	Indicates a hazardous situation which, if not avoided, will result in death or serious injury.
	Indicates a hazardous situation which, if not avoided, could result in death or serious injury.
	Indicates a hazardous situation which, if not avoided, could result in minor or moderate injury.
	Addresses practices not related to personal injury.

## IMPORTANT SAFETY INFORMATION

**WARNING** Read all safety warnings and instructions.

*Failure to heed these markings may result in personal injury and/or property damage. Save all warnings and instructions for future reference.*

The warnings, precautions, and instructions discussed in this manual cannot cover all possible conditions and situations that may occur. The operator must understand that common sense and caution are factors, which cannot be built into this product, but must be supplied by the operator.

### Work area

Keep the work area clean and well lit. Cluttered benches and dark areas increase the risks of electric shock, fire, and injury to persons.

### Personal safety

- Stay alert. Watch what you are doing and use common sense when operating the tool. Do not use the tool while tired or under the influence of drugs, alcohol, or medication.**  
A moment of inattention while operating the tool increases the risk of injury to persons.
- Dress properly. Do not wear loose clothing or jewelry. Contain long hair. Keep hair, clothing, and gloves away from moving parts.** Loose clothes, jewelry, or long hair increases the risk of injury to persons as a result of being caught in moving parts.
- Do not overreach. Keep proper footing and balance at all times.** Proper footing and balance enables better control of the tool in unexpected situations.
- Use safety equipment.** Wear heavy-duty work gloves during use. Non-skid safety shoes and a hard hat must be used for the applicable conditions.
- Always wear eye protection.** Wear ANSI-approved safety goggles, heavy-duty work gloves, and steel-toe work boots during set up and/or use.

### Tool use and care

- Do not force the tool.** Use the correct tool for the application. The correct tool will do the job better and safer at the rate for which the tool is designed.
- Store the tool when it is idle out of reach of children and other untrained persons.** A tool is dangerous in the hands of untrained users.

3. **Check for misalignment or binding of moving parts, breakage of parts, and any other condition that affects the tool's operation.** If damaged, have the tool serviced before using. Many accidents are caused by poorly maintained tools. There is a risk of bursting if the tool is damaged.
4. **Use only accessories that are identified by the manufacturer for the specific tool model.** Use of an accessory not intended for use with the specific tool model, increases the risk of injury to persons.

## Service

---

1. **Tool service must be performed only by qualified repair personnel.**
2. **When servicing a tool, use only identical replacement parts. Use only authorized parts.**
3. **Use only the lubricants supplied with the tool or specified by the manufacturer.**

## Specific Safety Rules

---

1. Keep hands away from Plate and Rack Press during use.
2. Do not move workpiece while compressed.
3. Bolt to workbench before use.
4. Keep area under arbor plates clear. If arbor plates rest on obstruction (i.e. bolt, debris, etc.), it creates an uneven press, causing excess stress and possible breakage.
5. Avoid off-center loads. Do not operate if workpiece tilts or binds during compression.
6. STOP and release compression if you suspect imminent structural failure. If safe, inspect thoroughly and reposition before proceeding.
7. Do not compress springs or other elastic objects. They could disengage hazardously.
8. Wear ANSI-approved safety goggles, heavy-duty work gloves, and steel-toe work boots during set up and/or use.
9. Keep bystanders out of work area.
10. 1 Ton Limit. Do not operate the Arbor Press beyond rated capacity.
11. Inspect before every use; do not use if parts are loose or damaged.
12. Press service must be performed only by qualified repair personnel. Service or maintenance performed by unqualified personnel could result in a risk of injury.
13. When servicing Press use only identical replacement parts—refer to attached, product-specific parts list and diagram. Follow instructions in the “User - Maintenance Instructions” section of this manual. Use of unauthorized parts or failure to follow maintenance instructions may create a risk of injury.
14. Only use with accessories rated to handle the forces exerted by this tool during operation. Other accessories not designed for the forces generated may break and forcefully launch pieces.
15. Industrial applications must follow OSHA requirements.
16. This product is not a toy. Keep it out of reach of children.
17. Maintain labels and nameplates on the Arbor Press. These carry important safety information. If unreadable or missing, contact Harbor Freight Tools for a replacement.
18. The warnings, precautions, and instructions discussed in this instruction manual cannot cover all possible conditions and situations that may occur. It must be understood by the operator that common sense and caution are factors which cannot be built into this product, but must be supplied by the operator.



**SAVE THESE INSTRUCTIONS.**

## Specifications

Capacity	1 Ton
Maximum Height	5-1/2"
Maximum Diameter	8"
Largest Arbor	1-1/8"
Ram Square	1"
Height of Press	13"
Base Dimensions	5" x 11"
Leverage Ratio	20: 1

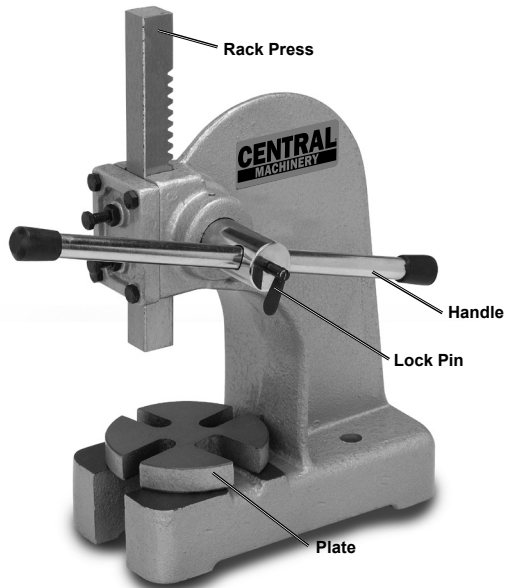
## Setup - Before Use:



Read the **ENTIRE** IMPORTANT SAFETY INFORMATION section at the beginning of this manual including all text under subheadings therein before set up or use of this product.

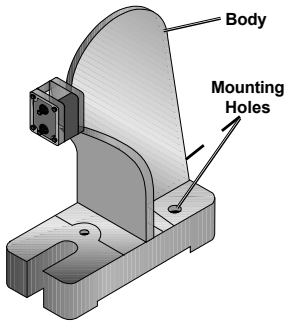
## Functions

---



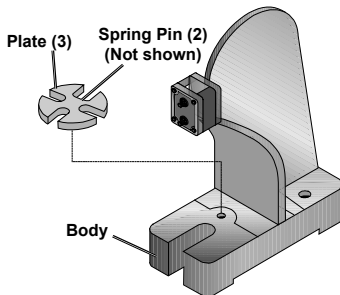
## Assembly

1. Select a place on workbench to mount the Arbor Press.
2. Purchase hardware to mount Arbor Press to workbench. Bolt length will be the thickness of your workbench plus 2-1/2" of length for the Body.



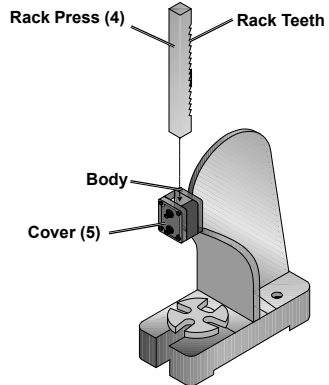
**Figure A: Mounting Holes**

3. Use the two mounting holes in Body as a template as shown in Figure A. Mark and Drill holes in workbench.
4. Place Body over the holes on workbench and insert the Bolts through the holes. Thread on the Nuts and tighten.



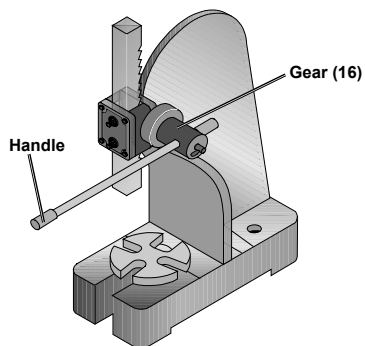
**Figure B: Installing Plate**

5. Place Plate (3) on base of Body as shown in Figure B. Insert Spring Pin (2) into hole of base.

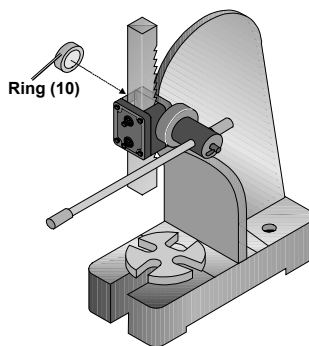


**Figure C: Installing Rack Press**

6. Insert Rack Press (4) down through top of Body as shown in Figure C. Make sure teeth of Rack Press are towards rear of Body as shown in Figure C.



**Figure D: Installing Handle**

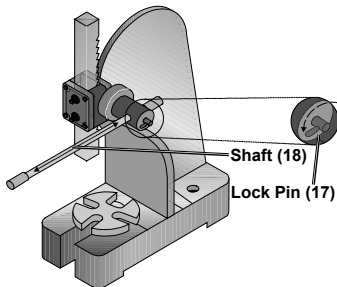


**Figure E: Attaching Ring**

7. Insert Gear (16) section of Handle into side of Arbor Press as shown in Figure D. The Gear will only fit into the side as shown in Figure D.
8. You may have to rotate the Handle slightly to get the teeth of the Gear to mesh with the teeth of the Rack Press.
9. Slide the Ring (10) onto the protruding end of the Gear as shown in Figure E. Tighten the Screw on Ring to secure Gear and Handle.
10. Arbor Press is now ready for use.

### Adjusting Tool

1. Determine if a moderate or large amount of leverage for the job is needed.

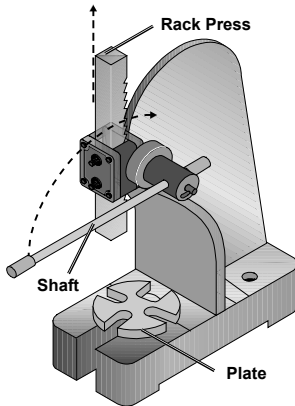


**Figure F: Adjusting Shaft**

2. Loosen Lock Pin (17) by turning it as shown in Figure F. This allows adjustment to length of the Shaft (18)
3. Adjust length of the Shaft to suit needs. If a large amount of leverage is needed for your press job, lock the Shaft in the extended position. If a moderate amount of leverage is needed, position the Shaft in the middle of the Gear.
4. Tighten the Lock Pin to secure Handle. The following steps show Shaft in extended position.

# Using Arbor Press

---



**Figure G: Raising Rack Press**

1. Raise Rack Press up by turning Handle clockwise as shown in Figure G.
2. Turn the Plate until the appropriate width opening is centered under Rack Press. The appropriate width depends upon what you are using the press for. To cover opening beneath the Rack Press, rotate the Plate until one of the four solid parts of Plate is underneath the Rack Press.
3. Place the part to press onto the Plate.
4. Turn Handle counter clockwise to lower Rack Press until bottom of Rack Press contacts the part.
5. Place downward pressure on Handle to press the part as needed.
6. Release pressure on Handle and raise the Rack Press to remove the part.





Procedures not specifically explained in this manual must be performed only by a qualified technician.

### **⚠️ WARNING**

**TO PREVENT SERIOUS INJURY FROM TOOL FAILURE:**

**Do not use damaged equipment. If abnormal noise or vibration occurs, have the problem corrected before further use.**

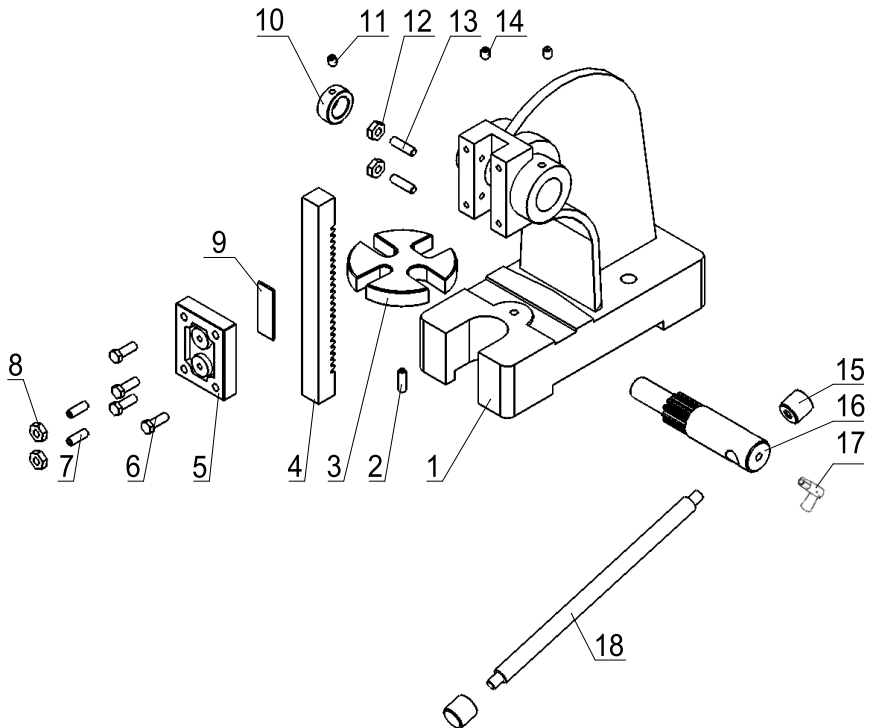
**Before each use**, inspect the general condition of the Arbor Press. Check for broken, cracked, or bent parts, loose or missing parts, and any condition that may affect the proper operation of the product. If a problem occurs, have the problem corrected before further use.

**Do not use damaged equipment.**

## Parts List and Diagram

Part	Description	Qty
1	Body	1
2	Spring Pin	1
3	Plate	1
4	Rack Press	1
5	Cover	1
6	Bolt	4
7	Bolt	2
8	Nut	2
9	Washer	1

Part	Description	Qty
10	Ring	1
11	Screw	1
12	Nut	2
13	Bolt	2
14	Screw	2
15	Handle	2
16	Gear	1
17	Lock Pin	1
18	Shaft	1



**Record Serial Number Here:** \_\_\_\_\_

**Note:** If product has no serial number, record month and year of purchase instead.

**Note:** Some parts are listed and shown for illustration purposes only, and are not available individually as replacement parts. Reference UPC 193175483591.

## **PLEASE READ THE FOLLOWING CAREFULLY**

---

THE MANUFACTURER AND/OR DISTRIBUTOR HAS PROVIDED THE PARTS LIST AND ASSEMBLY DIAGRAM IN THIS DOCUMENT AS A REFERENCE TOOL ONLY. NEITHER THE MANUFACTURER OR DISTRIBUTOR MAKES ANY REPRESENTATION OR WARRANTY OF ANY KIND TO THE BUYER THAT HE OR SHE IS QUALIFIED TO MAKE ANY REPAIRS TO THE PRODUCT, OR THAT HE OR SHE IS QUALIFIED TO REPLACE ANY PARTS OF THE PRODUCT. IN FACT, THE MANUFACTURER AND/OR DISTRIBUTOR EXPRESSLY STATES THAT ALL REPAIRS AND PARTS REPLACEMENTS SHOULD BE UNDERTAKEN BY CERTIFIED AND LICENSED TECHNICIANS, AND NOT BY THE BUYER. THE BUYER ASSUMES ALL RISK AND LIABILITY ARISING OUT OF HIS OR HER REPAIRS TO THE ORIGINAL PRODUCT OR REPLACEMENT PARTS THERETO, OR ARISING OUT OF HIS OR HER INSTALLATION OF REPLACEMENT PARTS THERETO.



## Limited 90 Day Warranty

Harbor Freight Tools Co. makes every effort to assure that its products meet high quality and durability standards, and warrants to the original purchaser that this product is free from defects in materials and workmanship for the period of 90 days from the date of purchase. This warranty does not apply to damage due directly or indirectly, to misuse, abuse, negligence or accidents, repairs or alterations outside our facilities, criminal activity, improper installation, normal wear and tear, or to lack of maintenance. We shall in no event be liable for death, injuries to persons or property, or for incidental, contingent, special or consequential damages arising from the use of our product. Some states do not allow the exclusion or limitation of incidental or consequential damages, so the above limitation of exclusion may not apply to you. THIS WARRANTY IS EXPRESSLY IN LIEU OF ALL OTHER WARRANTIES, EXPRESS OR IMPLIED, INCLUDING THE WARRANTIES OF MERCHANTABILITY AND FITNESS.

To take advantage of this warranty, the product or part must be returned to us with transportation charges prepaid. Proof of purchase date and an explanation of the complaint must accompany the merchandise. If our inspection verifies the defect, we will either repair or replace the product at our election or we may elect to refund the purchase price if we cannot readily and quickly provide you with a replacement. We will return repaired products at our expense, but if we determine there is no defect, or that the defect resulted from causes not within the scope of our warranty, then you must bear the cost of returning the product.

This warranty gives you specific legal rights and you may also have other rights which vary from state to state.

**CENTRAL<sup>®</sup>**  
**MACHINERY**