

PREDATOR®

QUICK START GUIDE

3500 / 4375

RUNNING WATTS

MAX STARTING WATTS

59132 59207

Generator Components

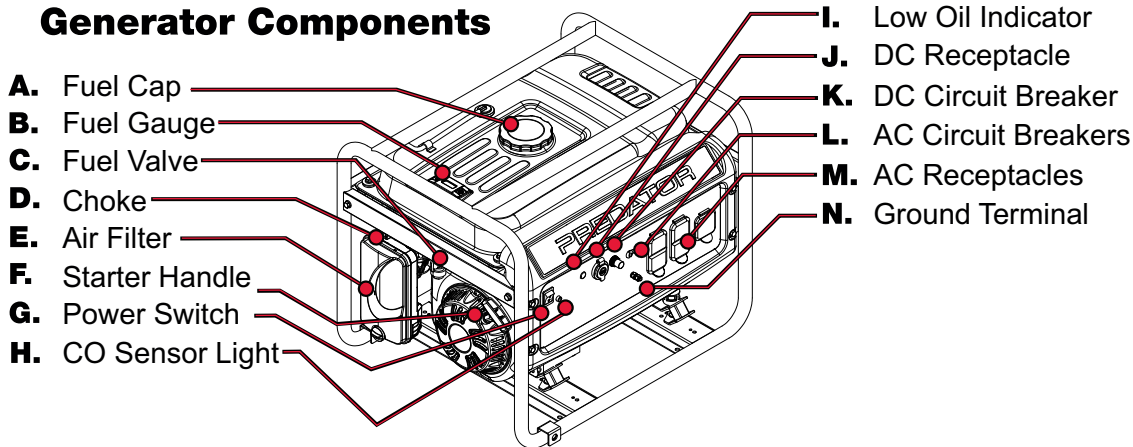

⚠ WARNING

To prevent serious injury:
READ MANUAL BEFORE USE.



BEFORE USING:

Position generator outside and unplug all electrical loads

⚠ DANGER

Using a generator indoors **CAN KILL YOU IN MINUTES.**

Generator exhaust contains carbon monoxide. This is a poison you cannot see or smell.



NEVER use inside a home or garage, **EVEN IF** doors and windows are open.



Only use **OUTSIDE** and far away from windows, doors, and vents.

⚠ DANGER

Do not use in trailers, truck beds, or tents.



Use at least 20 feet away from people, animals, and structures with exhaust pointed away.

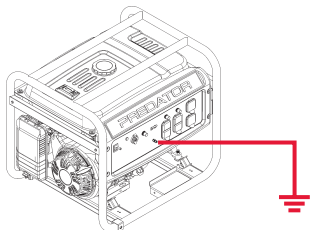
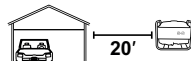
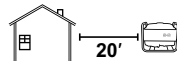
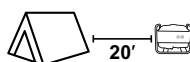
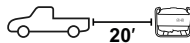
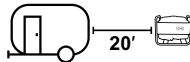

**GROUND GENERATOR
TO PREVENT
ELECTRIC SHOCK**

ADD FLUIDS

Check oil and fuel levels
If needed, fill as shown below

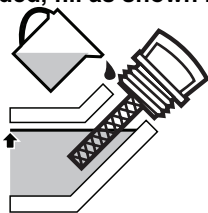

Add oil to engine crankcase
**WITHOUT OIL GENERATOR
WILL NOT START**

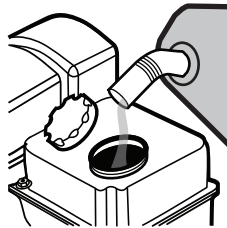

Add fuel to within
1" of the rim of the tank

Note: Use regular Unleaded
87 Octane gasoline. **E85 Ethanol**
blend will damage engine.

Starting Procedure

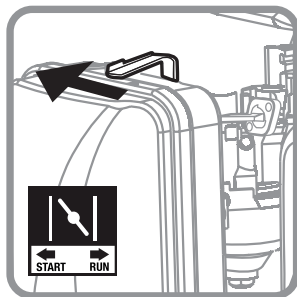

1. CHOKE TO START

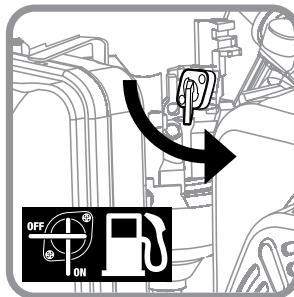

2. OPEN FUEL VALVE

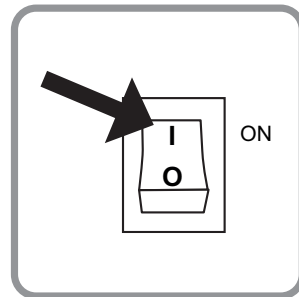

3. SWITCH ON

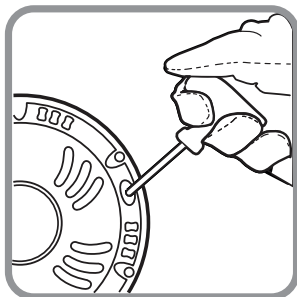

4. PULL STARTER HANDLE

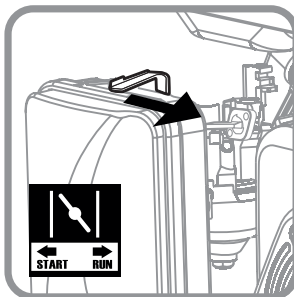

5. CHOKE SLOWLY TO RUN

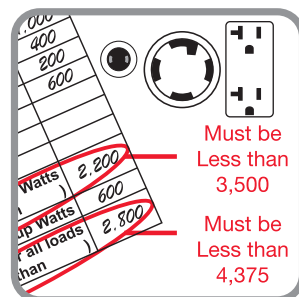

**6. CHECK TOTAL WATTS
THEN PLUG IN PRODUCTS**

Check total Start-up watts amount before plugging in any equipment.

To check the wattage amount:

1. Add up the Running Watts for all items you would like to use at any given time.
2. Make sure that this total is under the 3,500 rated wattage of the generator.
3. Find the single highest starting watts for the selected items and add to the total.
4. Make sure that this total is under the 4,375 maximum rated wattage of the generator.
5. Plug in and turn on products from largest wattage to smallest.

Typical Product Watts

Check your appliance for actual ratings.

WATTAGE ESTIMATE CHART

EMERGENCY

DEVICE	RUNNING WATTS	ADDITIONAL STARTUP WATTS
Refrigerator/Freezer	700	1500
Radio	100	0

HOUSEHOLD

DEVICE	RUNNING WATTS	ADDITIONAL STARTUP WATTS
Computer w/ Monitor	800	0
Electric Clothes Dryer	5500	500
Electric Range	2100	0
Electric Water Heater	2000	0
Light Bulb - 100 Watts	100	0
Microwave - 1000 Watts	1000	200
Sump Pump - 1/2 HP	1000	1100
Television - 27"	400	0
Washing Machine	1100	1100
Well Pump - 1/2 HP	1000	1000

JOB SITE

DEVICE	RUNNING WATTS	ADDITIONAL STARTUP WATTS
Air Compressor - 1/2 HP	1000	1000
Table Saw - 10"	1700	1300
Belt Sander - 3"	1200	1200
Hand Drill - 1/2"	600	600
Halogen Work Light	1000	0
Reciprocating Saw	900	900

LAWN & GARDEN

DEVICE	RUNNING WATTS	ADDITIONAL STARTUP WATTS
Hedge Trimmer	400	400
Pressure Washer	1200	1200
Lawn Mower	1200	1200
Edger	1000	1000

RECREATION

DEVICE	RUNNING WATTS	ADDITIONAL STARTUP WATTS
AM/FM Radio	100	0
Electric Grill	1700	0
Inflator Pump	50	100
CD/DVD Player	100	0
Box Fan - 20"	200	200
Coffee Maker	600	0

HEATING & COOLING

DEVICE	RUNNING WATTS	ADDITIONAL STARTUP WATTS
Central AC - 10,000 BTU	1500	3000
Furnace Fan - 1/2 HP	900	1400
Space Heater	1800	0
Window AC - 10,000 BTU	1200	600

Note: Wattage listed are estimates for that type of equipment only.

Check nameplate wattages on all loads before connecting to generator.

IF ANY CIRCUIT BREAKERS TRIP:

1. Make sure that ALL circuit breakers are reset before starting the generator again.
2. Adjust the plugs so the loads are shared across outlet circuits.



Evenly distributed
over outlets.

