

Bauer™

22201E-B

QUICK START GUIDE

50ft DRAIN CLEANER WITH POWER-FEED

59533

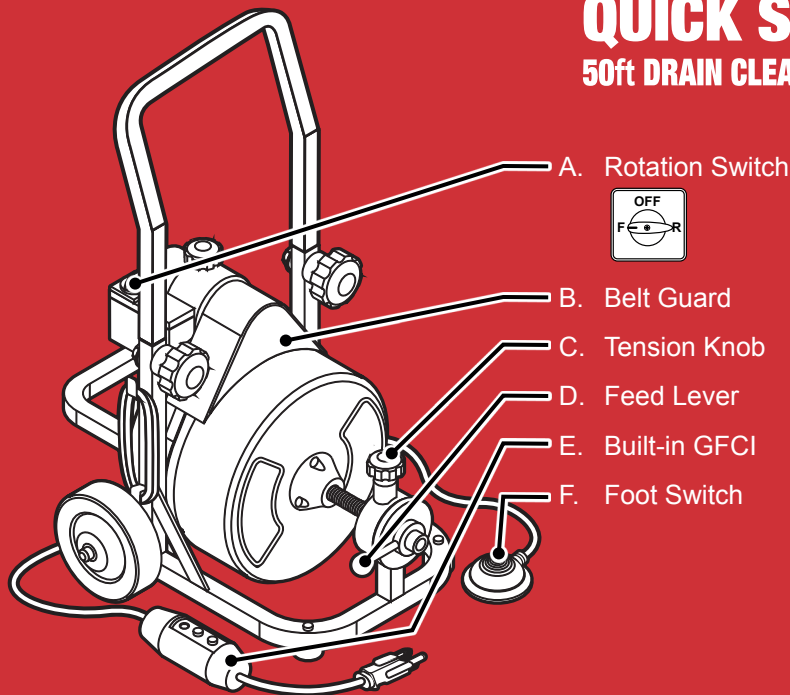

NOTICE

20%
Restocking
Fee
on all drain cleaner
returns

⚠ WARNING

To prevent serious injury:
Read and understand user manual
before set up and/or use.

OPERATION



1. Wear water- and chemical-resistant gloves inside heavy-duty work gloves

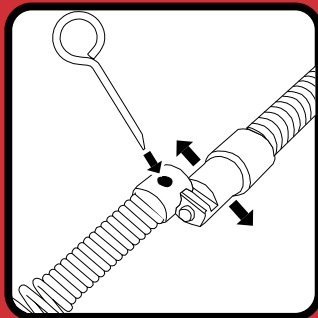

2. Install cutting head; use tool to remove

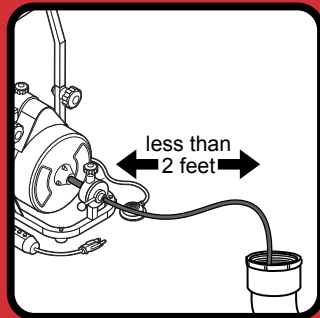

3. Position within 2 feet of drain opening

CAUTION DO NOT PUT ROTATION SWITCH INTO REVERSE FOR MORE THAN A FEW SECONDS AT A TIME
Reverse position is only to momentarily change direction to free jammed cable



Bauer™

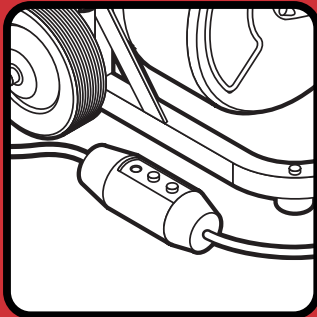

4. Plug in and press reset button on GFCI

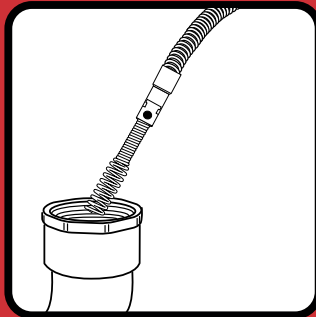

5. Insert into drain as far as possible

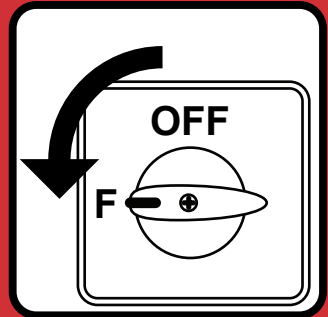

6. Set to forward



7. Hold cable

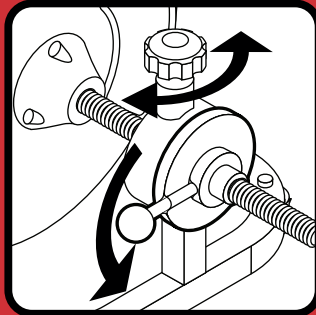

8. Set power feed to forward



9. Press foot switch

IMPORTANT – SEE TIPS ON BACK

TIPS

When the cable hits a blockage, retract the cable back and forth to clear the blockage.

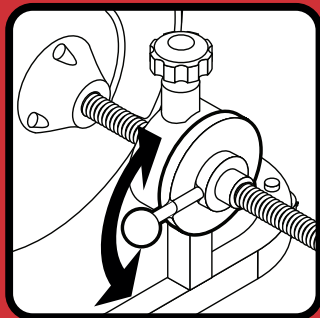

If the cable stops and tension builds, release foot switch, wait for tension to release, then pull cable back manually before proceeding.

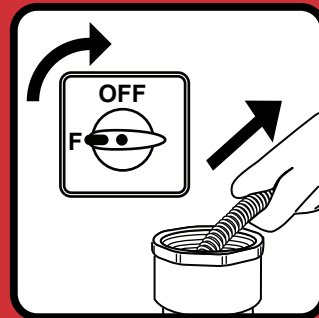

ACCESSORIES



Arrowhead

Starting tool for piercing stoppage and allowing water to drain

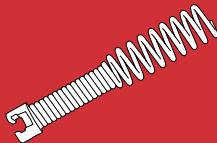

Boring Bulb Cutter

Tool for removing loose objects

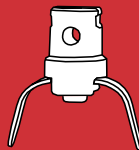

C-Cutter

Tool for grease stoppages



Side Cutter

Finishing tool for cleaning off pipe walls

For technical questions, please call 1-888-866-5797.

26677 Agoura Road | Calabasas, CA 91302

<http://www.harborfreight.com>