

# Bauer™

22202E-B

## QUICK START GUIDE

50ft COMPACT DRAIN CLEANER

59534

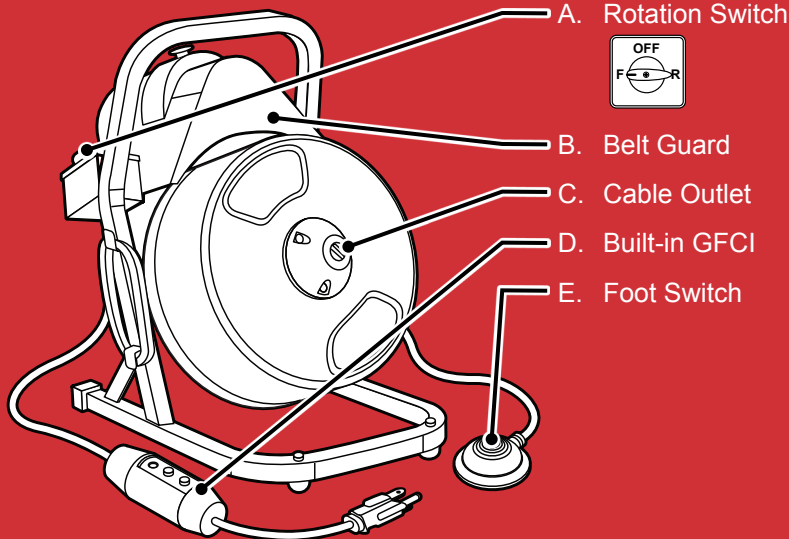

**NOTICE**  
**20%**  
**Restocking**  
**Fee**  
on all drain cleaner  
returns

### **⚠ WARNING**

To prevent serious injury:  
Read and understand user manual  
before set up and/or use.

# OPERATION



1. Wear water- and chemical-resistant gloves inside heavy-duty work gloves

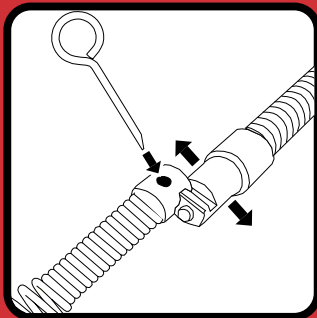

2. Install cutting head; use tool to remove

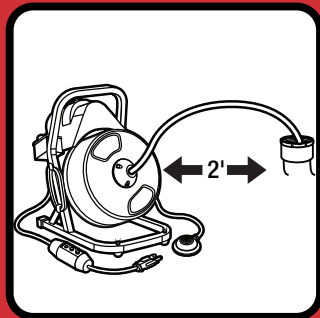

3. Position within 2 feet of drain opening

**CAUTION** DO NOT PUT ROTATION SWITCH INTO REVERSE FOR MORE THAN A FEW SECONDS AT A TIME  
Reverse position is only to momentarily change direction to free jammed cable



# Bauer™

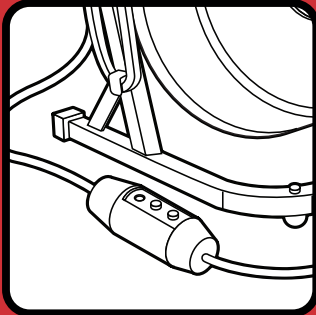

4. Plug in and press reset button on GFCI

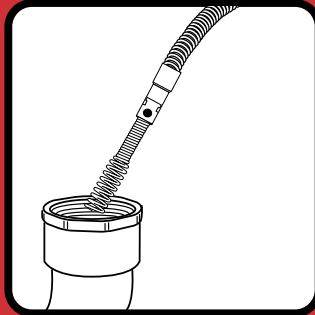

5. Insert into drain as far as possible

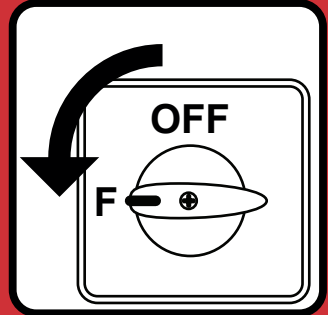

6. Set to forward



7. Hold cable



8. Press foot switch



9. Feed cable

**IMPORTANT – SEE TIPS ON BACK**

# TIPS

When the cable hits a blockage, retract the cable back and forth to clear the blockage.



If the cable stops and tension builds, release foot switch, wait for tension to release, then pull cable back manually before proceeding.

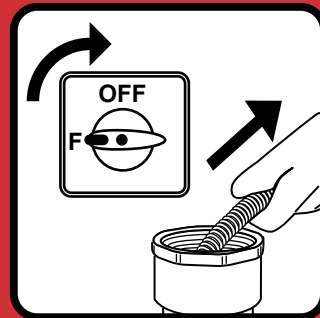

# ACCESSORIES



## Arrowhead

Starting tool for piercing stoppage and allowing water to drain

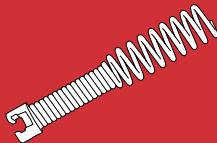

## Boring Bulb Cutter

Tool for removing loose objects

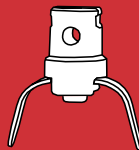

## C-Cutter

Tool for grease stoppages

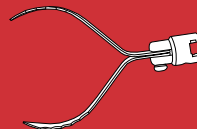

## Side Cutter

Finishing tool for cleaning off pipe walls

For technical questions, please call 1-888-866-5797.

26677 Agoura Road | Calabasas, CA 91302

<http://www.harborfreight.com>