

# Owner's Manual & Safety Instructions

**Save This Manual** Keep this manual for the safety warnings and precautions, assembly, operating, inspection, maintenance and cleaning procedures. Write the product's serial number in the back of the manual near the assembly diagram (or month and year of purchase if product has no number). Keep this manual and the receipt in a safe and dry place for future reference.

24e

# **HAULMASTER™**

## **STEEL TRAILER TONGUE BOX**



Visit our website at: <http://www.harborfreight.com>  
Email our technical support at: [productsupport@harborfreight.com](mailto:productsupport@harborfreight.com)

62253

When unpacking, make sure that the product is intact and undamaged. If any parts are missing or broken, please call 1-888-866-5797 as soon as possible.

### **⚠ WARNING**

Read this material before using this product. Failure to do so can result in serious injury. **SAVE THIS MANUAL.**

Copyright© 2020 by Harbor Freight Tools®. All rights reserved.  
No portion of this manual or any artwork contained herein may be reproduced in any shape or form without the express written consent of Harbor Freight Tools. Diagrams within this manual may not be drawn proportionally. Due to continuing improvements, actual product may differ slightly from the product described herein. Tools required for assembly and service may not be included.

## Specifications

Construction	Formed Sheet Steel
Box Thickness	.079"

***HAULMASTER***<sup>™</sup>

# Important Safety Information

## Installation Precautions

---

1. Wear ANSI-approved safety goggles and heavy-duty work gloves during installation.
2. Verify that installation surface has no hidden brake lines or wires before drilling.
3. Install according to manual instructions only. Attach trailer box securely before moving trailer.
4. Keep installation area clean and well lit.
5. Keep bystanders out of the area during installation.
6. Do not install when tired or when under the influence of alcohol, drugs or medication.
7. Product capabilities apply to properly and completely installed product only.
8. While mounting, apply protective paint/coating to any bare surface metal areas to inhibit trailer tongue corrosion.
9. Install as far rearward on the tongue as possible to ensure proper trailer maneuverability, and to prevent damage from obstructed turning.

## Use Precautions

---

1. Inspect before every use; do not use if parts are loose or damaged.
2. Lock trailer box before transporting.
3. Use as intended only.
4. Not for commercial use; do not exceed trailer weight capacity or towing vehicle tongue weight capacity.
5. This product is not a toy. Do not allow children to play with or near this item.
6. Do not exceed trailer weight capacity or towing vehicle weight capacity. **Be aware of dynamic loading!** Sudden load movement may briefly create excess load causing product failure.
7. Comply with all local, state, and federal regulations regarding installation and use.
8. Maintain product labels and nameplates. These carry important safety information. If unreadable or missing, contact Harbor Freight Tools for a replacement.

**HAULMASTER™**

# Installation Instructions



Read the **ENTIRE IMPORTANT SAFETY INFORMATION** section at the beginning of this document including all text under subheadings therein before set up or use of this product.

## **⚠️WARNING**

### **TO PREVENT SERIOUS INJURY AND PROPERTY DAMAGE:**

Do not attempt to install this product if you are not comfortable and skilled at doing this type of work. This is a custom installed product that requires precise measurements and drilling that is unique to each trailer's design and size. Use an experienced qualified professional installer to install and inspect the fabrication and final installation.

## **“A” Frame Tongue Installation Instructions**

---

**NOTE:** Fasteners sold separately.

1. Measure the width of the trailer tongue on which the Steel Box is to be mounted. Mark the inside of the box at 1-1/2" to 2" from front and back of the box inner side and about 2/3rd of the Tongue width from the sides of the box. Punch drill locator guides with a center punch.
2. Drill a 1/8" guide hole at one location. Position the Steel Box on the Tongue and mark the chassis through the drilled hole. Remove the box and make sure that the marked position on the chassis is in an appropriate location, keeping in mind that you would be drilling 1/4" hole in that position.
3. Repeating the above mentioned steps, mark the remaining three spots and verify their proper location on the chassis.
4. In the bottom of the Steel Box drill four 17/64" holes and remove metal shavings. Attach a 1/4" rubber grommet (not supplied), to each hole.
5. Make sure that there are no hidden electrical wires of conduits below the marked spots and drill a 1/4" hole at each location on the chassis. Clean all metal shavings.
6. Reposition the Box over the tongue aligning the drilled holes.

# **HAULMASTER™**

7. Insert a 1/4" carriage bolt through a 1/4" flat washer and pass it through the grommet and into the drilled hole in the trailer tongue. Attach a flat washer and attach a 1/4" locking nut (do not tighten at this time). Continue with the other three locations. Secure all four nuts tightly. See illustration below.
8. Make sure that there are no hidden electrical wires or conduits below the marked spots and drill a 1/4" hole at each location on the chassis. Clean all metal shavings.
9. Reposition the Box over the tongue aligning the drilled holes.
10. Insert a 1/4" carriage bolt through a 1/4" flat washer and pass it through the grommet and into the drilled hole in the trailer tongue. Attach a flat washer and attach a 1/4" locking nut (do not tighten at this time). Continue with the other three locations. Secure all four nuts tightly.

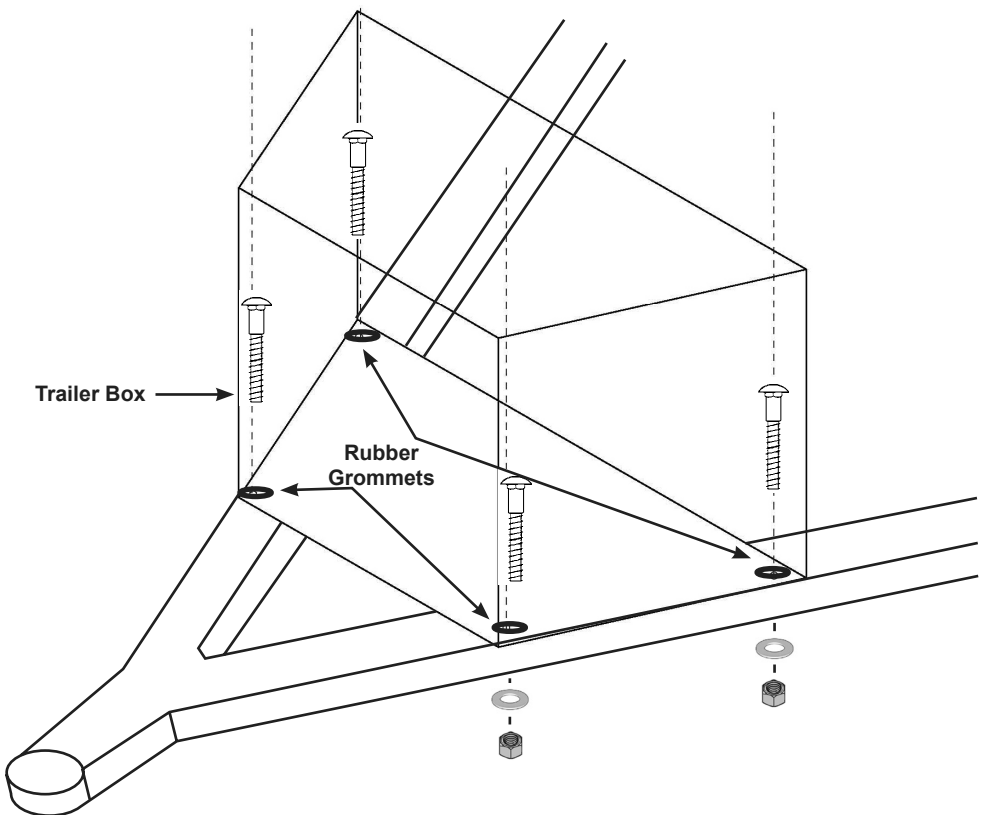

## PLEASE READ THE FOLLOWING CAREFULLY

---

THE MANUFACTURER AND/OR DISTRIBUTOR HAS PROVIDED THE PARTS LIST AND INSTALLATION DIAGRAM IN THIS DOCUMENT AS A REFERENCE TOOL ONLY. NEITHER THE MANUFACTURER OR DISTRIBUTOR MAKES ANY REPRESENTATION OR WARRANTY OF ANY KIND TO THE BUYER THAT HE OR SHE IS QUALIFIED TO MAKE ANY REPAIRS TO THE PRODUCT, OR THAT HE OR SHE IS QUALIFIED TO REPLACE ANY PARTS OF THE PRODUCT. IN FACT, THE MANUFACTURER AND/OR DISTRIBUTOR EXPRESSLY STATES THAT ALL REPAIRS AND PARTS REPLACEMENTS SHOULD BE UNDERTAKEN BY CERTIFIED AND LICENSED TECHNICIANS, AND NOT BY THE BUYER. THE BUYER ASSUMES ALL RISK AND LIABILITY ARISING OUT OF HIS OR HER REPAIRS TO THE ORIGINAL PRODUCT OR REPLACEMENT PARTS THERETO, OR ARISING OUT OF HIS OR HER INSTALLATION OF REPLACEMENT PARTS THERETO.

### Parts List and Diagram

#### Parts List

---

Part	Description	Qty.
1	Tongue Box Body	1
2	Lid	1
3	Gas Shock	1
4	Piano Hinge	1
5	Latch With Lock	1
6	Keys (not shown)*	2

**\*Record Your Lock and Key Number Here:** \_\_\_\_\_

**Be advised that additional keys are not available.**

**Record Serial Number Here:** \_\_\_\_\_

**Note:** If product has no serial number, record month and year of purchase instead.

**Note:** Some parts are listed and shown for illustration purposes only, and are not available individually as replacement parts. Specify UPC 792363622530 when ordering parts.

# Assembly Diagram

---

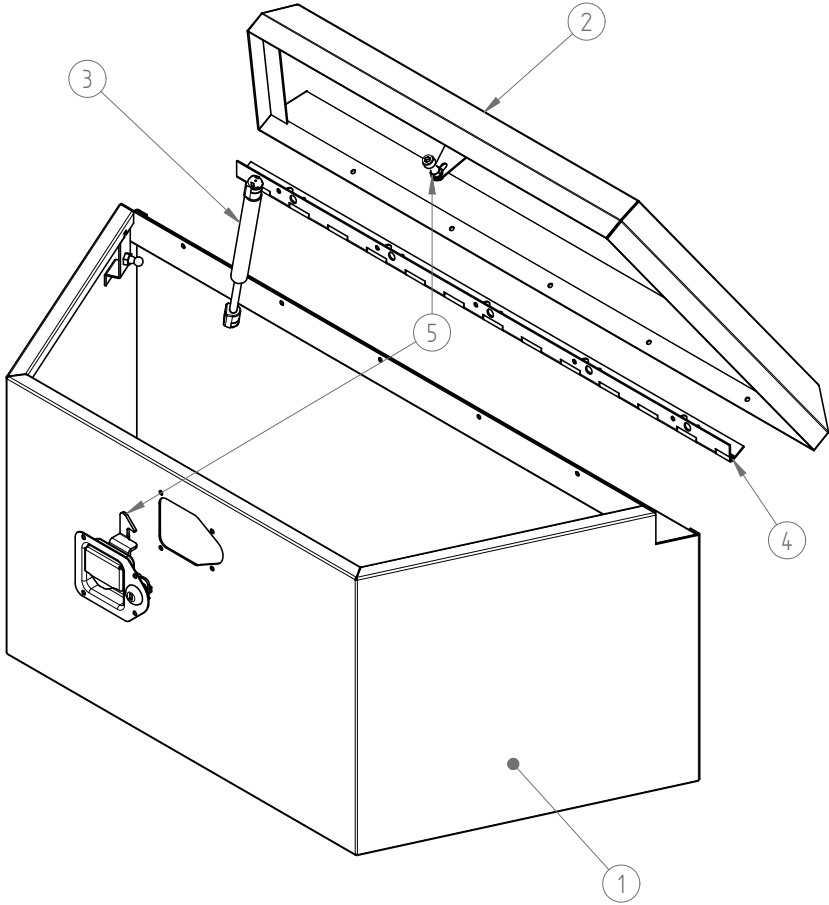

## Limited 90 Day Warranty

Harbor Freight Tools Co. makes every effort to assure that its products meet high quality and durability standards, and warrants to the original purchaser that this product is free from defects in materials and workmanship for the period of 90 days from the date of purchase. This warranty does not apply to damage due directly or indirectly, to misuse, abuse, negligence or accidents, repairs or alterations outside our facilities, criminal activity, improper installation, normal wear and tear, or to lack of maintenance. We shall in no event be liable for death, injuries to persons or property, or for incidental, contingent, special or consequential damages arising from the use of our product. Some states do not allow the exclusion or limitation of incidental or consequential damages, so the above limitation of exclusion may not apply to you. THIS WARRANTY IS EXPRESSLY IN LIEU OF ALL OTHER WARRANTIES, EXPRESS OR IMPLIED, INCLUDING THE WARRANTIES OF MERCHANTABILITY AND FITNESS.

To take advantage of this warranty, the product or part must be returned to us with transportation charges prepaid. Proof of purchase date and an explanation of the complaint must accompany the merchandise. If our inspection verifies the defect, we will either repair or replace the product at our election or we may elect to refund the purchase price if we cannot readily and quickly provide you with a replacement. We will return repaired products at our expense, but if we determine there is no defect, or that the defect resulted from causes not within the scope of our warranty, then you must bear the cost of returning the product.

This warranty gives you specific legal rights and you may also have other rights which vary from state to state.

The logo for Haulmaster, featuring the word "HAULMASTER" in a bold, italicized, sans-serif font. The letters are white with a thick black outline, and the entire word is set against a black background. A small trademark symbol (TM) is located at the bottom right of the word.