

# Owner's Manual & Safety Instructions

**Save This Manual** Keep this manual for the safety warnings and precautions, assembly, operating, inspection, maintenance and cleaning procedures. Write the product's serial number in the back of the manual near the assembly diagram (or month and year of purchase if product has no number). Keep this manual and the receipt in a safe and dry place for future reference.

23h

## **PITTSBURGH™**

### **4 PC. 3 JAW PULLER SET**



**63760**

Visit our website at: <http://www.harborfreight.com>  
Email our technical support at: [productsupport@harborfreight.com](mailto:productsupport@harborfreight.com)

When unpacking, make sure that the product is intact and undamaged. If any parts are missing or broken, please call 1-888-866-5797 as soon as possible.

Copyright© 2023 by Harbor Freight Tools®. All rights reserved.  
No portion of this manual or any artwork contained herein may be reproduced in any shape or form without the express written consent of Harbor Freight Tools. Diagrams within this manual may not be drawn proportionally. Due to continuing improvements, actual product may differ slightly from the product described herein. Tools required for assembly and service may not be included.





#### **⚠ WARNING**

Read this material before using this product.  
Failure to do so can result in serious injury.  
**SAVE THIS MANUAL.**

## Specifications

Size (Inches)	Jaw Size Range (Inches)
3	2-4.5
4	3-6.25
6	5-8.75
8	7-10.75

### WARNING SYMBOLS AND DEFINITIONS

	This is the safety alert symbol. It is used to alert you to potential personal injury hazards. Obey all safety messages that follow this symbol to avoid possible injury or death.
 <b>DANGER</b>	Indicates a hazardous situation which, if not avoided, will result in death or serious injury.
 <b>WARNING</b>	Indicates a hazardous situation which, if not avoided, could result in death or serious injury.
 <b>CAUTION</b>	Indicates a hazardous situation which, if not avoided, could result in minor or moderate injury.
<b>NOTICE</b> <b>CAUTION</b>	Addresses practices not related to personal injury.

## Important Safety Information



**WARNING** Read all safety warnings and instructions.

*Failure to follow the warnings and instructions may result in serious injury.*

**Save all warnings and instructions for future reference.**

1. Wear ANSI-approved safety goggles during use.
2. Use as intended only.
3. Inspect before use; do not use if parts loose or damaged.
4. The warnings, precautions, and instructions discussed in this instruction manual cannot cover all possible conditions and situations that may occur. It must be understood by the operator that common sense and caution are factors which cannot be built into this product, but must be supplied by the operator.



**SAVE THESE INSTRUCTIONS.**

## Setup - Before Use:



Read the **ENTIRE IMPORTANT SAFETY INFORMATION** section at the beginning of this manual before set up or use of this product.

**Note:** For additional information regarding the parts listed in the following pages, refer to the Assembly Diagram near the end of this manual.

## Assembly

1. Install the Yoke Arms (7) on the Yoke (2) and hand tighten using the Bolts (5) and Nuts (6).
2. Install Jaws (1) on the end of the Yoke Arms and hand tighten using the Bolts and Nuts.

**Note:** Jaws have two holes for installation based on the reach required in your application and can be installed with the tips facing outward so they can be used as an internal puller.

3. If using the Live Center Tip (3), thread completely until the Live Center Tip spins freely and moves from side to side.
4. Apply a liberal amount of anti-seize to the Lead Screw (4) threads. This will prolong the life of your Puller and make turning the Lead Screw easier.

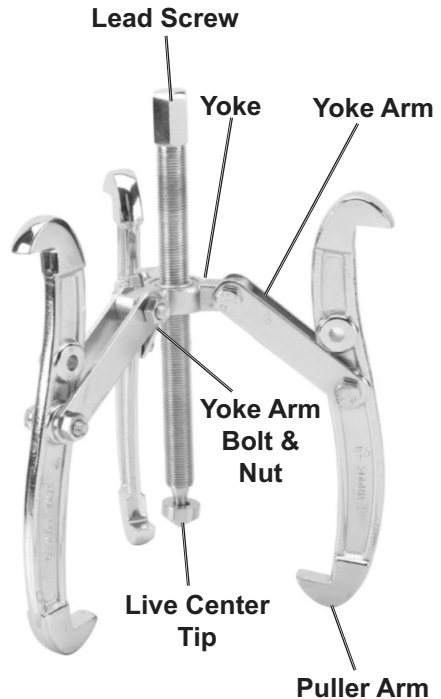

## Functions

The tool is designed to pull items such as bearings, pulleys, and chucks from shafts. The Jaws can grip the object from the inside or outside, whichever offers a better grip. The Lead Screw will push on the center shaft while the jaws pull away. This will remove the item from the shaft by pulling it straight out evenly, without hammering or binding from pulling at an angle.

**Note:** It is not recommended using these types of pullers on engine harmonic balancers. The rubber used in the harmonic balancer can be damaged.

## Operating Instructions



Read the **ENTIRE IMPORTANT SAFETY INFORMATION** section at the beginning of this manual before set up or use of this product.

1. Test fit the appropriate size Jaw making sure the Lead Screw (4) is adjusted to clear the shaft being pulled from.

**Note:** Make sure Jaws (1) are not open too far. This can cause the Jaws to slip loose from the gear or pulley.

**Note:** The Live Center Tip (3) can make the Lead Screw (4) turn more easily and eliminate damage to the end of the shaft being pulled from.

2. Hold the Jaws so they remain hooked on the gear or pulley and turn the Lead Screw by hand until it is snug against the shaft you are pulling from.
3. Using a wrench, turn the Lead Screw (4) until the gear or pulley is free from its shaft.

**Note:** Do not use an impact gun to turn Lead Screw.

## Maintenance and Servicing



Procedures not specifically explained in this manual must be performed only by a qualified technician.

### CAUTION

**TO PREVENT INJURY FROM TOOL FAILURE:** Do not use damaged equipment. If abnormal noise or vibration occurs, have the problem corrected before further use.

## Cleaning, Maintenance, and Lubrication

---

1. **BEFORE EACH USE**, inspect the general condition of the Gear Puller. Check for loose screws, misalignment or binding of moving parts, cracked or broken parts, and any other condition which may affect its safe operation.
2. **AFTER USE**, clean external surfaces with clean cloth.
3. Lightly oil the pivoting joints periodically to keep them operating smoothly.
4. Before each use, lubricate the Lead Screw threads with anti-seize.
5. If rust appears on any part of the tool, remove it with a penetrating oil.

PLEASE READ THE FOLLOWING CAREFULLY

THE MANUFACTURER AND/OR DISTRIBUTOR HAS PROVIDED THE PARTS LIST AND ASSEMBLY DIAGRAM IN THIS MANUAL AS A REFERENCE TOOL ONLY. NEITHER THE MANUFACTURER OR DISTRIBUTOR MAKES ANY REPRESENTATION OR WARRANTY OF ANY KIND TO THE BUYER THAT HE OR SHE IS QUALIFIED TO MAKE ANY REPAIRS TO THE PRODUCT, OR THAT HE OR SHE IS QUALIFIED TO REPLACE ANY PARTS OF THE PRODUCT. IN FACT, THE MANUFACTURER AND/OR DISTRIBUTOR EXPRESSLY STATES THAT ALL REPAIRS AND PARTS REPLACEMENTS SHOULD BE UNDERTAKEN BY CERTIFIED AND LICENSED TECHNICIANS, AND NOT BY THE BUYER. THE BUYER ASSUMES ALL RISK AND LIABILITY ARISING OUT OF HIS OR HER REPAIRS TO THE ORIGINAL PRODUCT OR REPLACEMENT PARTS THERETO, OR ARISING OUT OF HIS OR HER INSTALLATION OF REPLACEMENT PARTS THERETO.

Parts List and Diagram

Parts List

Part	Description	Qty.
1	Jaw	3
2	Yoke	1
3	Live Center Tip	1
4	Lead Screw	1

Part	Description	Qty.
5	Bolt	6
6	Nut	6
7	Yoke Arm	6

Record Product’s Serial Number Here: \_\_\_\_\_

**Note:** If product has no serial number, record month and year of purchase instead.

**Note:** Some parts are listed and shown for illustration purposes only, and are not available individually as replacement parts. Parts may not be interchangeable. Specify UPC 193175501226 when ordering.

# Assembly Diagram

---

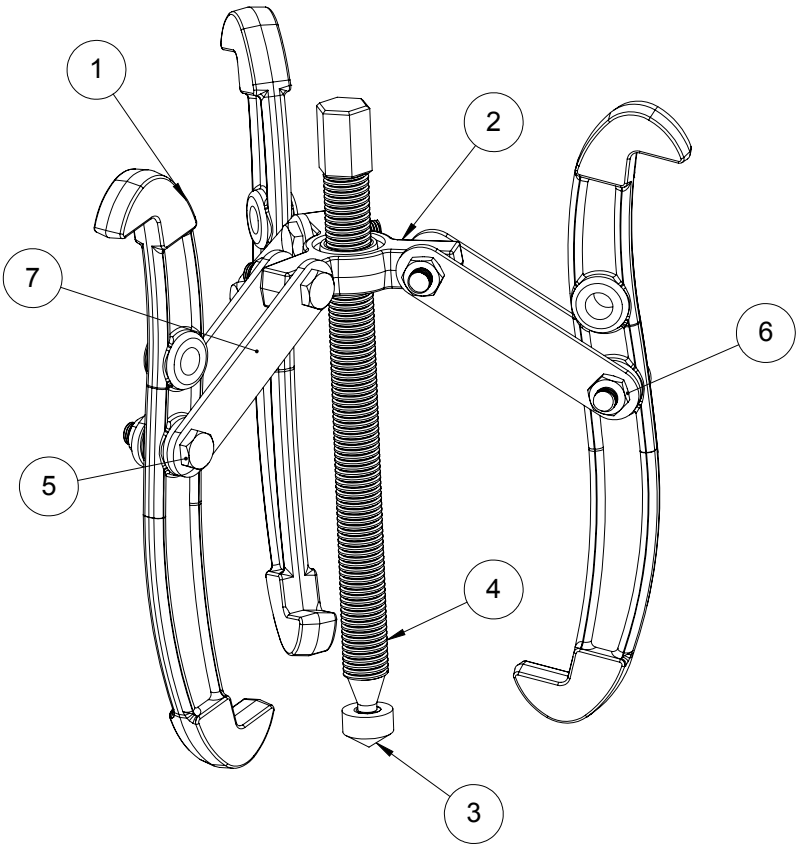

## Limited 90 Day Warranty

Harbor Freight Tools Co. makes every effort to assure that its products meet high quality and durability standards, and warrants to the original purchaser that this product is free from defects in materials and workmanship for the period of 90 days from the date of purchase. This warranty does not apply to damage due directly or indirectly, to misuse, abuse, negligence or accidents, repairs or alterations outside our facilities, criminal activity, improper installation, normal wear and tear, or to lack of maintenance. We shall in no event be liable for death, injuries to persons or property, or for incidental, contingent, special or consequential damages arising from the use of our product. Some states do not allow the exclusion or limitation of incidental or consequential damages, so the above limitation of exclusion may not apply to you. THIS WARRANTY IS EXPRESSLY IN LIEU OF ALL OTHER WARRANTIES, EXPRESS OR IMPLIED, INCLUDING THE WARRANTIES OF MERCHANTABILITY AND FITNESS.

To take advantage of this warranty, the product or part must be returned to us with transportation charges prepaid. Proof of purchase date and an explanation of the complaint must accompany the merchandise. If our inspection verifies the defect, we will either repair or replace the product at our election or we may elect to refund the purchase price if we cannot readily and quickly provide you with a replacement. We will return repaired products at our expense, but if we determine there is no defect, or that the defect resulted from causes not within the scope of our warranty, then you must bear the cost of returning the product.

This warranty gives you specific legal rights and you may also have other rights which vary from state to state.

# ***PITTSBURGH***<sup>™</sup>

26677 Agoura Road • Calabasas, CA 91302 • 1-888-866-5797