

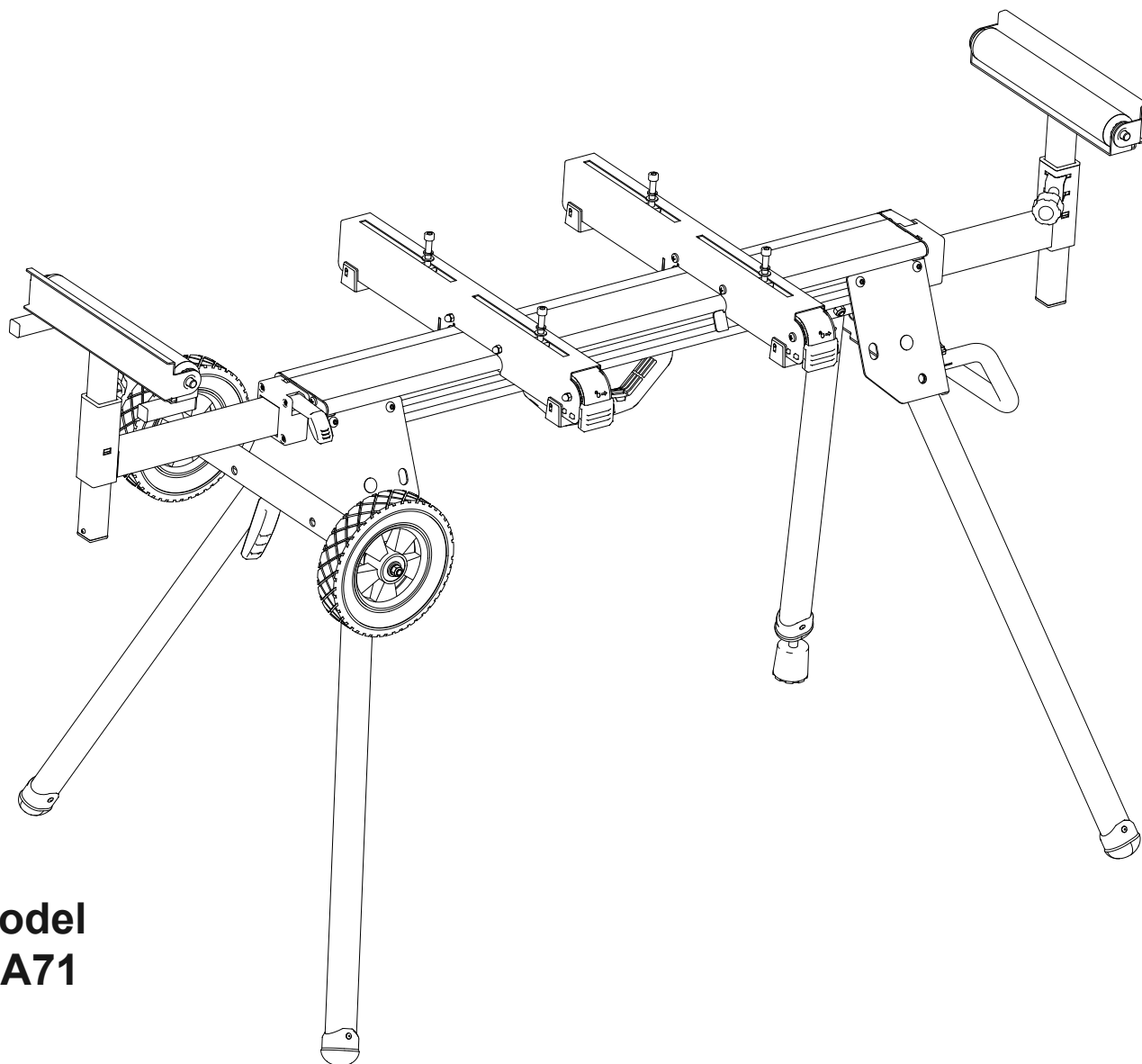

# Owner's Manual & Safety Instructions

20k



**Model  
HA71**

## PROFESSIONAL ROLLING MITER SAW STAND

**⚠WARNING:** To prevent serious injury, User must read and understand Owner's Manual. **SAVE THIS MANUAL.**

When unpacking, make sure that the product is intact and undamaged. If any parts are missing or broken, please call 1-888-866-5797 as soon as possible. Reference 64751

# IMPORTANT SAFETY INFORMATION

## **⚠ WARNING**

**Read all safety warnings and all instructions.**  
*Failure to follow the warnings and instructions may result in electric shock, fire and/or serious injury. Save all warnings and instructions for future reference.*

- 1. PRIOR TO USING THIS PRODUCT, READ AND UNDERSTAND ALL INSTRUCTIONS AND SAFETY PRECAUTIONS AS OUTLINED IN THE MANUFACTURER'S MANUAL OF THE MITER SAW THAT IS TO BE USED.**
- 2. MAKE SURE THE MITER SAW STAND IS PLACED ON A FLAT, LEVEL, HARD SURFACE CAPABLE OF SUPPORTING THE WEIGHT OF THE MITER SAW STAND, MITER SAW BEING USED, AND WORKPIECE.**
- 3. BOLT THE MITER SAW SECURELY TO THE MOUNTING BRACKETS ON THE MITER SAW STAND AND TEST WORK SET-UP FOR STABILITY BEFORE USE.**
- 4. KEEP ALL GUARDS IN PLACE AND IN WORKING ORDER.**
- 5. MAKE SURE THE WORKPIECE IS SUPPORTED AT ALL TIMES DURING OPERATION.**  
Use the two Extension Arms with longer wood stock if necessary.
- 6. UNPLUG THE MITER SAW FROM ITS ELECTRICAL SUPPLY SOURCE BEFORE PERFORMING ANY SERVICE OR MAINTENANCE ON THE MITER SAW STAND.** Make sure to unplug the Miter Saw before leaving the work area, moving the Miter Saw Stand from one location to another, cleaning sawdust from the unit, etc.
- 7. Wear ANSI-approved safety goggles during assembly and use.**
- 8. Do not exceed listed weight capacity. Be aware of dynamic loading!** Sudden load movement may briefly create excess load causing product failure.
9. Weight capacity and other product capabilities apply to properly and completely assembled product only.
10. When folding or unfolding the Miter Saw Stand, be careful not to pinch fingers.
11. This product is not a toy.  
Do not allow children to play with or near this item.
12. Use as intended only.
13. Keep hands clear of moving parts.
14. Maintain labels and nameplates on the tool. These carry important safety information. If unreadable or missing, contact Harbor Freight Tools for a replacement.
15. Stay alert, watch what you are doing and use common sense when operating a power tool. Do not use a power tool while you are tired or under the influence of drugs, alcohol or medication. A moment of inattention while operating power tools may result in serious personal injury.
16. The warnings, precautions, and instructions discussed in this instruction manual cannot cover all possible conditions and situations that may occur. It must be understood by the operator that common sense and caution are factors which cannot be built into this product, but must be supplied by the operator.

## ***Vibration Safety***

This tool vibrates during use. Repeated or long-term exposure to vibration may cause temporary or permanent physical injury, particularly to the hands, arms and shoulders. To reduce the risk of vibration-related injury:

1. Anyone using vibrating tools regularly or for an extended period should first be examined by a doctor and then have regular medical check-ups to ensure medical problems are not being caused or worsened from use. Pregnant women or people who have impaired blood circulation to the hand, past hand injuries, nervous system disorders, diabetes, or Raynaud's Disease should not use this tool. If you feel any medical or physical symptoms related to vibration (such as tingling, numbness, and white or blue fingers), seek medical advice as soon as possible.
2. Do not smoke during use. Nicotine reduces the blood supply to the hands and fingers, increasing the risk of vibration-related injury.
3. Use tools with the lowest vibration when there is a choice between different processes.
4. Include vibration-free periods each day of work.
5. Grip workpiece as lightly as possible (while still keeping safe control of it). Let the tool do the work.
6. To reduce vibration, maintain the tool as explained in this manual. If any abnormal vibration occurs, stop use immediately.



**SAVE THESE INSTRUCTIONS.**

## ***Specifications***

Maximum Load	550 lb
Maximum Extension	98-1/2"
Wheel Diameter	8"

## SETUP - BEFORE USE



Read the **ENTIRE IMPORTANT SAFETY INFORMATION** section at the beginning of this manual including all text under subheadings therein before set up or use of this product.

**Note:** For additional information regarding the parts listed in the following pages, refer to *Parts List and Diagram* on page 10.

## Set Up

1. Lay the Stand upside down on the floor.
2. Press the Lock Pin Handle on one leg and lift the leg up until Lock Pin engages.
3. Repeat with other legs.

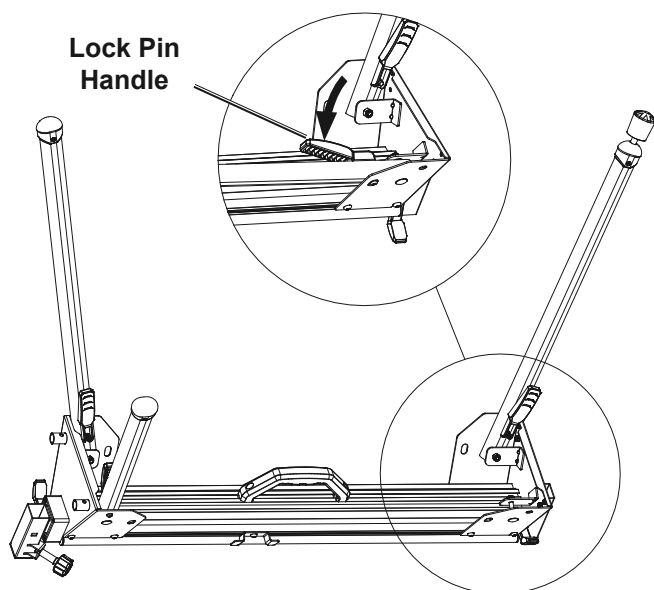

4. Turn Stand to upright working position and make sure all Lock Pins are engaged and legs are stable.
5. **Level Stand:** If necessary, turn Adjustable Foot to level Stand.

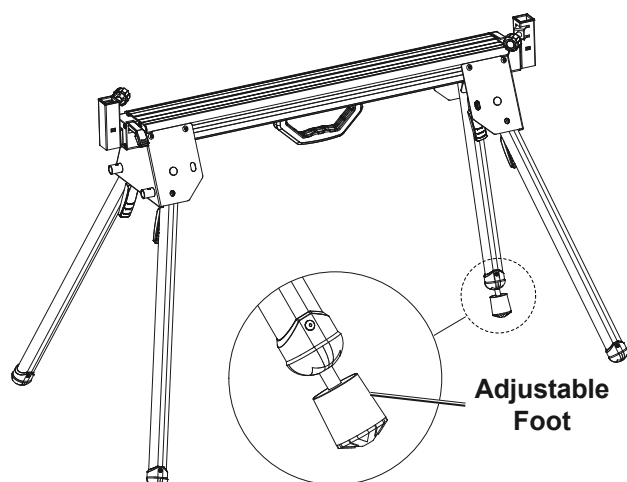

## Assembly

1. Attach Wheel Base using four Bolts (56), Washers (57) and Nuts (38).

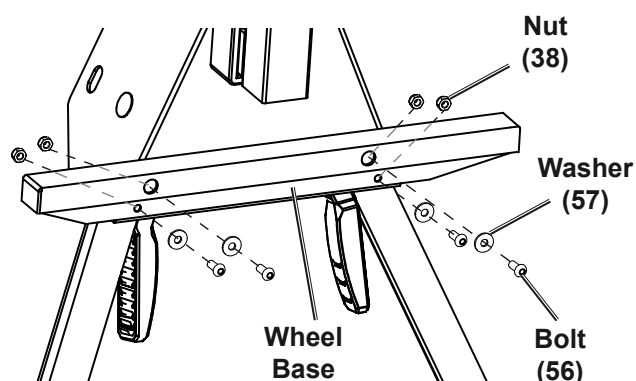

2. Insert Axle into Wheel Base.
3. Secure Wheel to Axle using one Washer (54), Washer (81) and Lock Nut (48).
4. Repeat on other side.

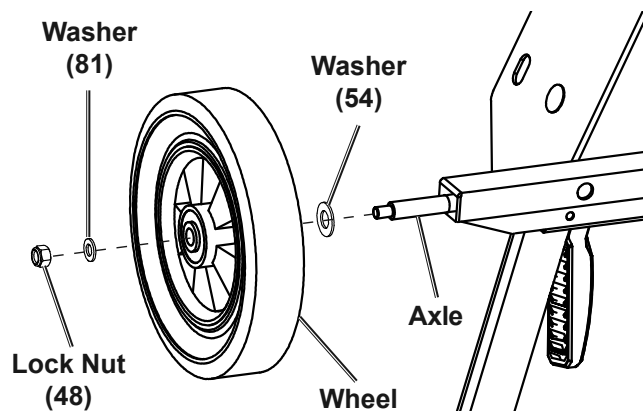

5. Slide Handle over tubes and secure with two Bolts (37) and Nuts (38).
6. Slide Workpiece Support into end of Extension Arm.
7. Thread Set Screw (28) into bottom of Workpiece Support.
8. Repeat on other side.

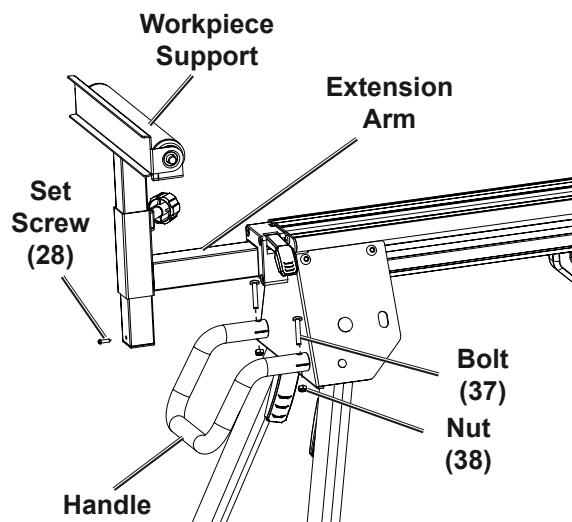

## 9. Attaching Mounting Brackets:

- Push in Lock Button.
- Lift Lock Handle.

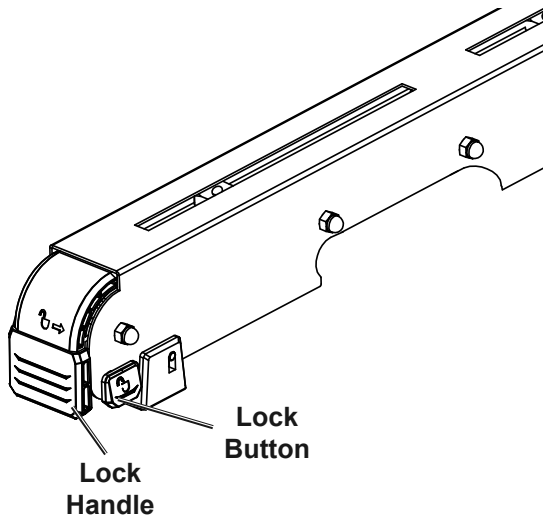

- Measure distance between mounting holes on saw (sold separately).
- Place Right Mounting Bracket in Guide Bracket.
- Push Lock Handle down until Lock Button clicks in place.
- Place Left Mounting Bracket so that it lines up with distance between mounting holes on saw.
- Push Lock Handle down until Lock Button clicks in place.
- Move Mounting Nuts as necessary to fit the mounting holes on saw.

**Note:** Move Guide Bracket as necessary to fit the saw.

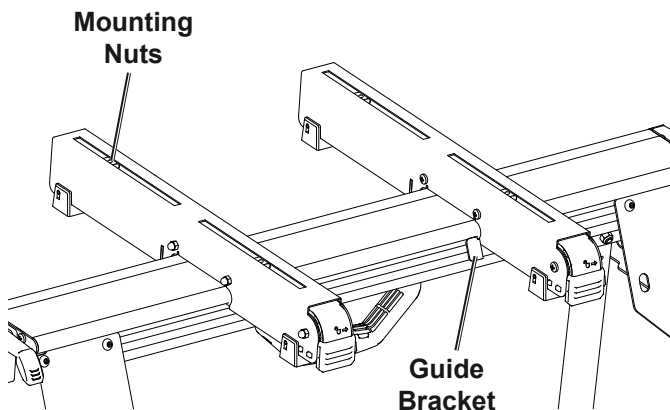

## 10. Mounting saw:

**CAUTION!** Unplug saw before mounting it.

- Place saw on Mounting Brackets.
- Secure saw with four Bolts (27), Spring Washers (26) and Washers (25).

**WARNING!** Included Bolts may be too long or short for your miter saw. They must properly secure the miter saw to the brackets, thread all the way through the washers and nut, and not interfere with the safe operation of the saw in any way.

Replacement bolts can be used instead, but they must be grade 5, have the same head type and size as the included Bolts, and have a 1.25mm thread pitch and M8 thread diameter.

They also must properly secure the miter saw to the brackets, thread all the way through the washers and nut, and not interfere with the safe operation of the saw in any way.

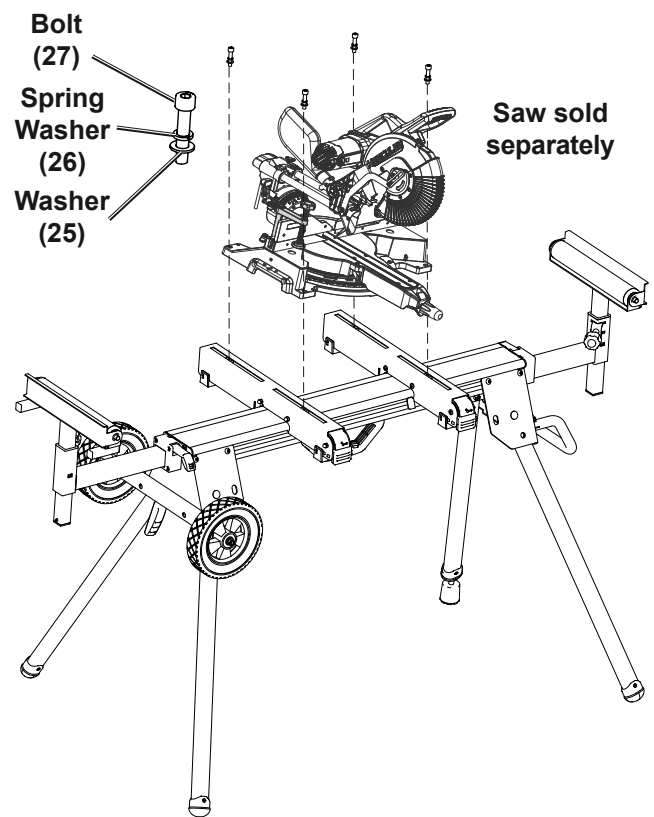

**11. Removing saw:** The saw may be removed while attached to Mounting Brackets.

- Push in Lock Buttons and lift Lock Handles.
- Lift the saw off of the Stand.

**12. Replacing saw while attached to Mounting Brackets:**

- Push in Lock Buttons and lift Lock Handles.
- Place Right Mounting Bracket in Guide Bracket.
- Push Lock Handles down until Lock Buttons click in place.

## OPERATION



Read the **ENTIRE IMPORTANT SAFETY INFORMATION** section at the beginning of this manual including all text under subheadings therein before set up or use of this product.

## WARNING

**TO PREVENT SERIOUS INJURY:** Read the

miter saw manufacturer's instruction manual before use. Ensure that the miter saw is firmly secured to the stand. Use as a miter saw stand only – do not use with any other type of power tool. Do not exceed listed weight capacity. Do not use on uneven or slippery surfaces.

## Adjusting Extension Arms

1. Raise Locking Handle, then pull out or push in Extension Arm to desired length.
2. Lower Locking Handle.

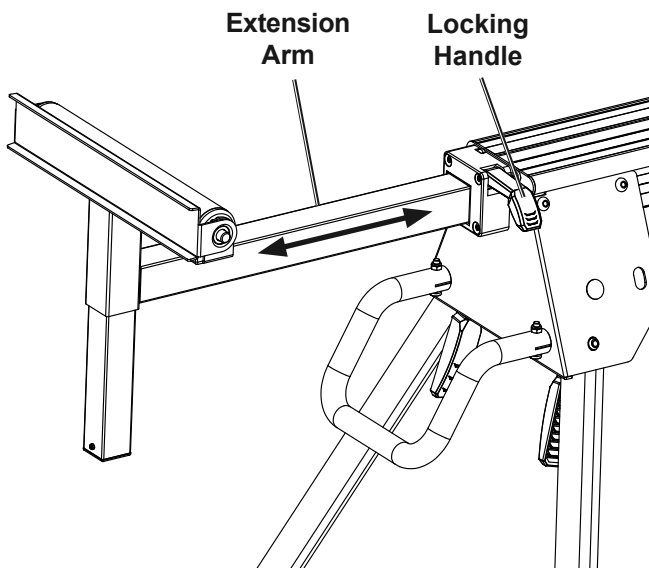

## Adjusting Workpiece Supports

1. **Workpiece Height:**
  - a. Loosen Lock Knob.
  - b. Raise or Lower Workpiece Support.
  - c. Tighten Lock Knob
2. **Workpiece Stop:** Use when cutting multiple workpieces the same length.

**CAUTION!** Do not use both Workpiece Stops at the same time or saw blade may bind in the workpiece when cutting.

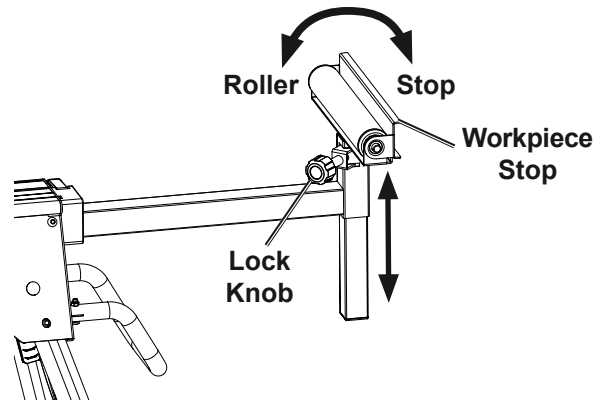

## Storage

1. Loosen Lock Knob and raise Workpiece Support all the way.
2. Tighten Lock Knob.

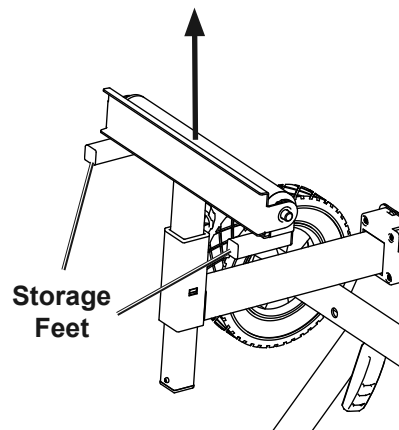

3. Tip Stand so that it is resting on Storage Feet.
4. Press the Lock Pin Handles on each Leg and fold them in.
5. Roll Stand to storage area.

## MAINTENANCE



Procedures not specifically explained in this manual must be performed only by a qualified technician.

### **!WARNING**

#### **TO PREVENT SERIOUS INJURY FROM ACCIDENTAL OPERATION:**

Turn the power switch of the miter saw mounted on the Miter Saw Stand off, and unplug the tool from its electrical outlet before performing any procedure in this section.

#### **TO PREVENT SERIOUS INJURY FROM TOOL FAILURE:**

Do not use damaged equipment.

If abnormal noise or vibration occurs, have the problem corrected before further use.

1. **BEFORE EACH USE**, inspect the general condition of the Stand. Check for:
  - loose hardware
  - misalignment or binding of parts
  - cracked or broken parts
  - loose or improper mounting of the miter saw
  - any other condition that may affect its safe operation.
2. **AFTER USE**, wipe external surfaces of the Stand with clean cloth.
3. Periodically, lightly lubricate all moving parts of the Stand.

**Record Product's Serial Number Here:** \_\_\_\_\_

**Note:** If product has no serial number, record month and year of purchase instead.

**Note:** Some parts are listed and shown for illustration purposes only, and are not available individually as replacement parts. Specify UPC 193175310385 when ordering parts.

***HERCULES***<sup>®</sup>



***PLEASE READ THE FOLLOWING CAREFULLY***

THE MANUFACTURER AND/OR DISTRIBUTOR HAS PROVIDED THE PARTS LIST AND ASSEMBLY DIAGRAM IN THIS MANUAL AS A REFERENCE TOOL ONLY. NEITHER THE MANUFACTURER OR DISTRIBUTOR MAKES ANY REPRESENTATION OR WARRANTY OF ANY KIND TO THE BUYER THAT HE OR SHE IS QUALIFIED TO MAKE ANY REPAIRS TO THE PRODUCT, OR THAT HE OR SHE IS QUALIFIED TO REPLACE ANY PARTS OF THE PRODUCT. IN FACT, THE MANUFACTURER AND/OR DISTRIBUTOR EXPRESSLY STATES THAT ALL REPAIRS AND PARTS REPLACEMENTS SHOULD BE UNDERTAKEN BY CERTIFIED AND LICENSED TECHNICIANS, AND NOT BY THE BUYER. THE BUYER ASSUMES ALL RISK AND LIABILITY ARISING OUT OF HIS OR HER REPAIRS TO THE ORIGINAL PRODUCT OR REPLACEMENT PARTS THERETO, OR ARISING OUT OF HIS OR HER INSTALLATION OF REPLACEMENT PARTS THERETO.

***HERCULES***<sup>®</sup>

## PARTS LIST AND DIAGRAM

### Parts List

Part	Description	Qty
1	Extension Arm	2
2	Spring	2
3	Steel Lock	2
4	Steel Sleeve	2
5	Lock Knob	2
6	Φ4 Spring	2
7	Φ4*8 Rivet	6
8	Cap	8
9	Mounting Bracket	2
10	Square Nut M8	4
11	M6*55 Bolt	6
12	Lock Handle	2
13	Spring	2
14	Mounting Bracket Base	4
15	Lock Mechanism	2
16	Φ5*60 Spring Pin	4
17	Lock Button	2
18	M6 Cover Nut	6
19	Cam	4
20	Clamp	2
21	Adjustable Clamp	2
22	Washer	2
23	Nut M6	2
24	Bolt M6*30	2
25	Φ8 Washer	4
26	Φ8 Spring Washer	4
27	Bolt M8*50	4
28	Set Screw M5*10	2
29	Bolt M6*45	6
30	Φ6 Spring Washer	4
31	Φ6 Washer	4
32	Extension Arm Base	2
33	Extension Arm Lock	2
34	Locking Handle	2
35	Bolt M6*12	4
36	Handle	1
37	Bolt M6*35	2
38	Nylon Nut M6	6
39	Worktop Support (Handle side)	1
40	Fixed Plate for the Worktop Support	4
41	Bolt M8*10	9

Part	Description	Qty
42	Square Nut M6	2
43	Handle	1
44	Bolt M6*20	2
45	Carriage Bolt M8*50	4
46	Round Washer	8
47	Washer	4
48	Lock Nut M8	6
49	Limited Block Base	1
50	Guide Bracket	1
51	Worktop Support (Wheel side)	1
52	Wheel	2
53	Wheel Axle	1
54	Φ12 Washer	8
55	Wheel Base	1
56	Bolt M6*15	4
57	Φ6 Washer	4
58	Leg Cover	3
59	Φ4*10 Rivet	8
60	Leg	3
61	Lock Pin Handle	4
62	Φ6 Ring	4
63	Spring	4
64	Lock Pin	4
65	Extension Tube Lock Spring	2
66	Adjustable Foot	1
67	Adjustable Leg Sleeve	1
68	Adjustable Leg	1
69	Roller Cap	4
70	Roller Spring	2
71	Roller Axle	2
72	Roller	2
73	End Cap 20*20	4
74	Workpiece Stop	2
75	Frame End Cap 35*35	2
76	Workpiece Support (Wheel side)	1
77	Workpiece Support (Handle side)	1
78	Beam	1
79	Insert	2
80	Extension Lock Collar	2
81	Φ8 Washer	2

# Assembly Diagram

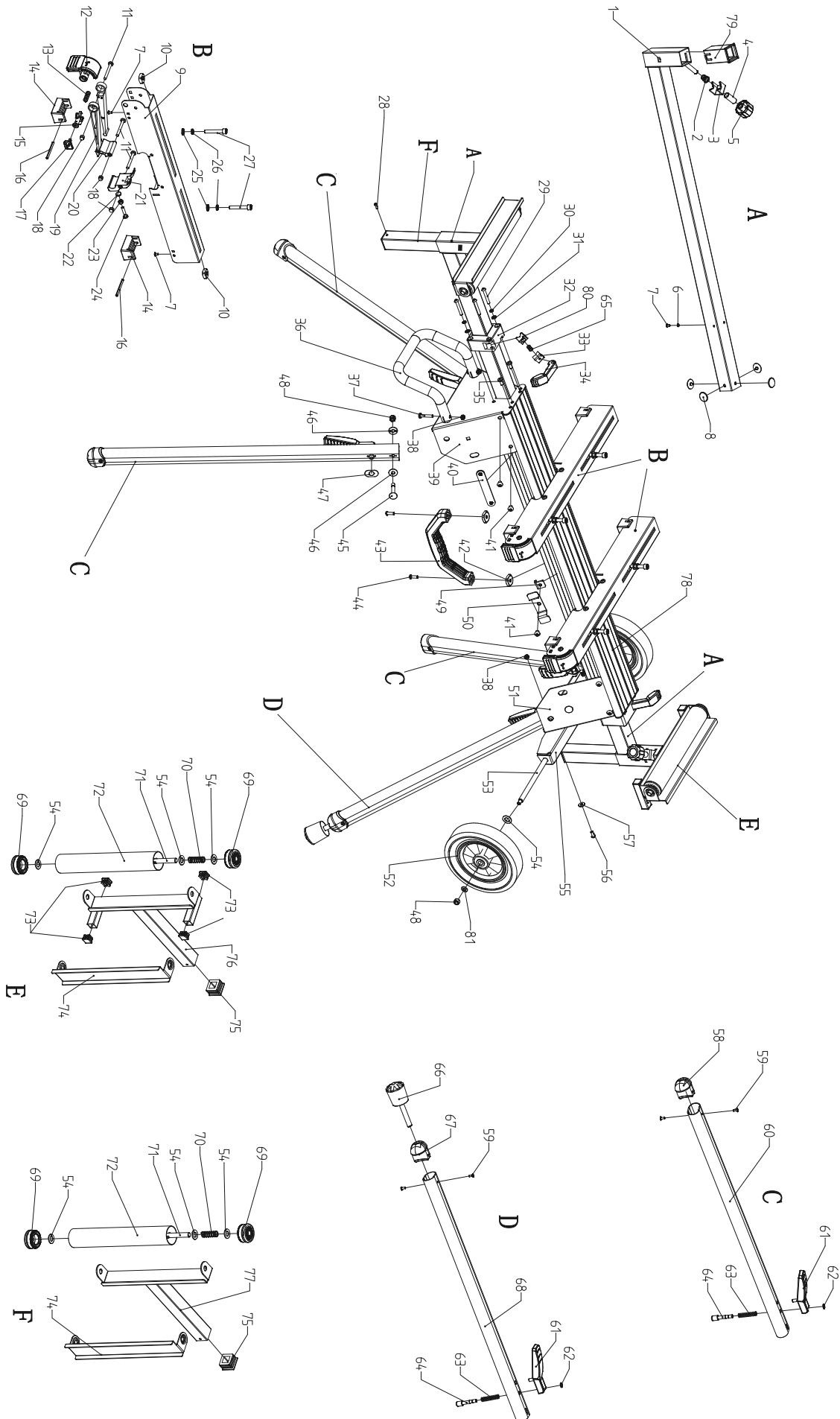

## **LIMITED 90 DAY WARRANTY**

Harbor Freight Tools Co. makes every effort to assure that its products meet high quality and durability standards, and warrants to the original purchaser that this product is free from defects in materials and workmanship for the period of 90 days from the date of purchase. This warranty does not apply to damage due directly or indirectly, to misuse, abuse, negligence or accidents, repairs or alterations outside our facilities, criminal activity, improper installation, normal wear and tear, or to lack of maintenance. We shall in no event be liable for death, injuries to persons or property, or for incidental, contingent, special or consequential damages arising from the use of our product. Some states do not allow the exclusion or limitation of incidental or consequential damages, so the above limitation of exclusion may not apply to you. THIS WARRANTY IS EXPRESSLY IN LIEU OF ALL OTHER WARRANTIES, EXPRESS OR IMPLIED, INCLUDING THE WARRANTIES OF MERCHANTABILITY AND FITNESS.

To take advantage of this warranty, the product or part must be returned to us with transportation charges prepaid. Proof of purchase date and an explanation of the complaint must accompany the merchandise. If our inspection verifies the defect, we will either repair or replace the product at our election or we may elect to refund the purchase price if we cannot readily and quickly provide you with a replacement. We will return repaired products at our expense, but if we determine there is no defect, or that the defect resulted from causes not within the scope of our warranty, then you must bear the cost of returning the product.

This warranty gives you specific legal rights and you may also have other rights which vary from state to state.

**Visit our website at: <http://www.harborfreight.com>  
Email our technical support at: [productsupport@harborfreight.com](mailto:productsupport@harborfreight.com)  
For technical questions, please call 1-888-866-5797**

---

Copyright© 2020 by Harbor Freight Tools®. All rights reserved. No portion of this manual or any artwork contained herein may be reproduced in any shape or form without the express written consent of Harbor Freight Tools. Diagrams within this manual may not be drawn proportionally. Due to continuing improvements, actual product may differ slightly from the product described herein. Tools required for assembly and service may not be included.

# ***HERCULES***

**26541 Agoura Road • Calabasas, CA 91302 • 1-888-866-5797**