

Owner's Manual & Safety Instructions

Save This Manual Keep this manual for the safety warnings and precautions, assembly, operating, inspection, maintenance and cleaning procedures. Write the product's serial number in the back of the manual near the assembly diagram (or month and year of purchase if product has no number). Keep this manual and the receipt in a safe and dry place for future reference.

21h

800 LB. CAPACITY

HaulMaster®

FULL SIZE TRUCK RACK



Visit our website at: <http://www.harborfreight.com>
Email our technical support at: productsupport@harborfreight.com

64793

When unpacking, make sure that the product is intact and undamaged. If any parts are missing or broken, please call 1-888-866-5797 as soon as possible.

Copyright© 2021 by Harbor Freight Tools®. All rights reserved.

No portion of this manual or any artwork contained herein may be reproduced in any shape or form without the express written consent of Harbor Freight Tools. Diagrams within this manual may not be drawn proportionally. Due to continuing improvements, actual product may differ slightly from the product described herein. Tools required for assembly and service may not be included.

⚠ WARNING

Read this material before using this product. Failure to do so can result in serious injury. **SAVE THIS MANUAL.**

IMPORTANT SAFETY INFORMATION

⚠️ WARNING

Read all safety warnings and instructions.

Failure to follow the warnings and instructions may result in serious injury.

Save all warnings and instructions for future reference.

Installation Precautions

1. Follow DOT regulations regarding installation and use.
2. Park truck on a flat, level, hard surface well away from traffic. Place transmission in park/neutral and set parking brake.
3. Verify that installation surface has no hidden wires before drilling or driving screws.
4. Install only according to these instructions. Improper installation can create hazards.
5. Wear ANSI-approved safety goggles and heavy-duty work gloves during assembly and installation.
6. Mount Truck Rack securely to vehicle.
7. Keep installation area clean and well lit.
8. Keep bystanders out of the area during installation.
9. Do not install when tired or when under the influence of drugs or medication.
10. Weight capacity and other product capabilities apply to properly and completely installed product only.

Use Precautions

1. Do not exceed vehicle manufacturer's load limits. Ensure rack is securely installed on truck prior to driving. Load must be evenly distributed and secured to rack prior to driving. Follow vehicle manufacturer guidance regarding potential instability while driving with added load. Use 800 lb. rated weight capacity only for slow speed on level ground with gradual starting and stopping only. Significantly reduce weight before turning, accelerating, braking, or moving at normal roadway speed.
2. Do not exceed rated weight capacity of truck. Refer to truck's Gross Vehicle Weight Rating.
3. Avoid low overhangs. Be aware of combined height of vehicle, rack, and load.
4. Secure and transport large flat loads correctly to prevent them from being forced upward or backward. Larger loads need to be transported more slowly and secured more carefully.
5. Use as intended only.
6. Inspect before every use; do not use if parts loose or damaged.
7. This product is not a toy. Do not allow children to play with or near this item.
8. Maintain product labels and nameplates. These carry important safety information. If unreadable or missing, contact Harbor Freight Tools for a replacement.
9. The warnings, precautions, and instructions discussed in this instruction manual cannot cover all possible conditions and situations that may occur. It must be understood by the operator that common sense and caution are factors which cannot be built into this product, but must be supplied by the operator.



SAVE THESE INSTRUCTIONS.

Specifications

| | |
|---------------|--|
| Load Capacity | 800 lb |
| Weight | 160 lb |
| Dimensions | 138" L x 60" W x 34" H (height of Legs with Risers) |

| | |
|--|--|
| Mounting Hardware (for permanent installation) | 12 x M12x70 Bolts 24 x Ø12 Washers 12 x Ø12 Spring Washers 12 x Ø12 Nuts (sold separately) |
|--|--|



Read the **ENTIRE IMPORTANT SAFETY INFORMATION** section at the beginning of this manual including all text under subheadings therein before set up or use of this product.

General Assembly

Note: Finger tighten all connections until assembly is done.

All connections are made to both left and right sides. Assemble on a flat, level, hard surface.

| Bolt Set | Part | Description | Qty |
|----------|------|---------------------------|--------|
| A | 15 | Bolt M16x30 | 4 sets |
| | 16 | Nut | |
| | 17 | Washer (2 per set) | |
| B | 18 | Bolt M12x50 | 8 sets |
| | 19 | Nut | |
| | 20 | Washer | |
| C | 21 | Bolt M10x35 | 2 sets |
| | 23 | Washer | |
| D | 21 | Bolt M10x35 | 2 sets |
| | 22 | Nut | |
| | 23 | Washer | |
| E | 24 | Bolt M12x75 | 2 sets |
| | 25 | Nut | |
| | 26 | Washer | |
| F1 | 27 | Bolt M18x85 | 4 sets |
| | 28 | Nut | |
| | 29 | Spring Washer | |
| | 30 | Washer (2 per set) | |
| F2 | 27 | Bolt M18x85 | 4 sets |
| | 28 | Nut | |
| | 29 | Spring Washer | |
| | 47 | Washer (2 per set) | |
| G | 31 | Bolt M12x70 | 8 sets |
| | 32 | Nut | |
| | 33 | Spring Washer | |
| | 34 | Washer Ø12 | |
| | 46 | Washer Ø16 | |
| H | 35 | Bolt M10x80 | 2 sets |
| | 36 | Nut | |
| | 37 | Spring Washer | |
| | 38 | Washer | |
| | 48 | Foam Sleeve | |
| | 49 | Rubber Washer (2 per set) | |
| I | 39 | J-Hook M12x70 | 8 sets |
| | 40 | Nut | |
| | 41 | Spring Washer | |
| | 42 | Washer | |
| J | 43 | Bolt M18x70 | 4 sets |
| | 44 | Nut | |
| | 45 | Washer (2 per set) | |

Figure A: Bolt Set Contents

1. Position Rear Legs (6, 7) on Rear Side Bars (3). Attach using Bolt Set B.
2. Attach curved ends of Rear Side Bars to Rear Legs using Bolt Set D.

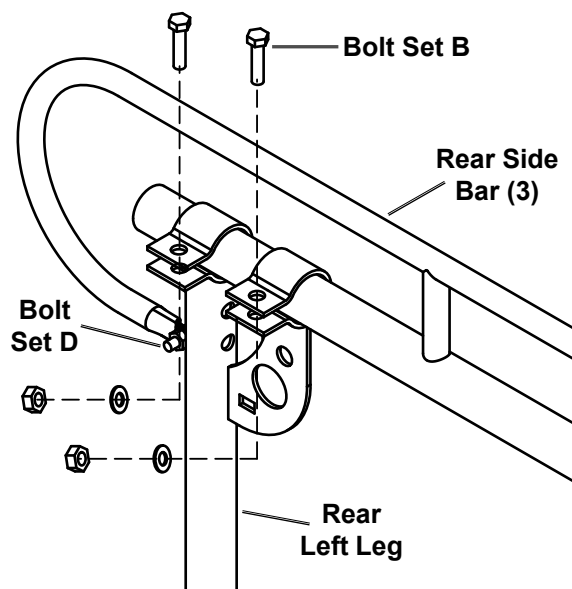

Figure B

3. Attach Rear Bar (12) to Rear Side Bars using Bolt Set G.
4. Attach end caps with Bolt Set C.

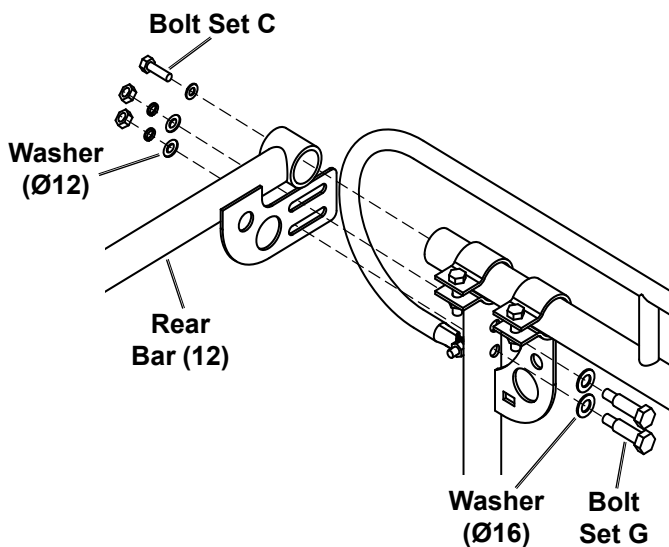

Figure C

If the truck has a short bed, go to instruction 5.
If it has a long bed, go to instruction 6.

5. Short Bed:

- Position the Front Bar (10) **behind** the Cross Bars on the Front Side Bars (2), then position the Front Legs (4, 5) next to the Front Bar.

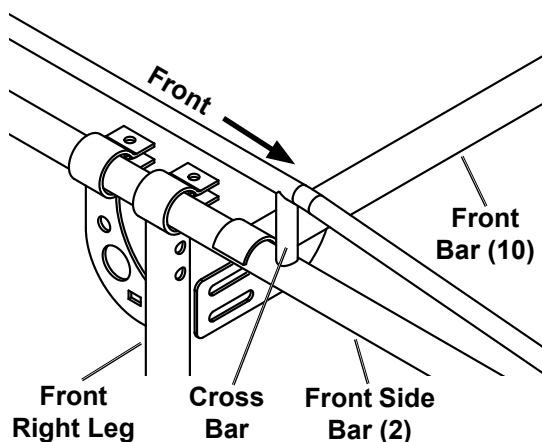

Figure D

- Secure connections with Bolt Sets B and G, then go to instruction 7.

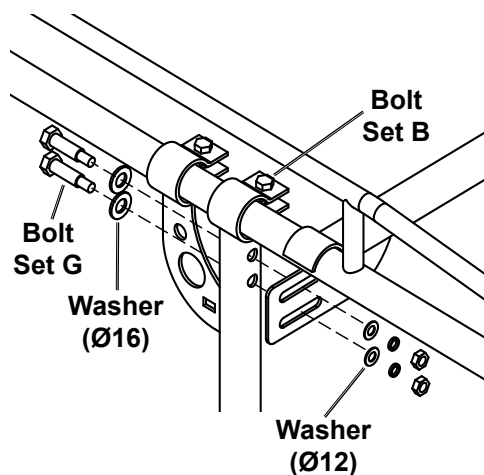

Figure E

6. Long Bed:

- Position the Front Bar (10) **in front of** the Cross Bars on the Front Side Bars (2), then position the Front Legs (4, 5) next to the Front Bar.

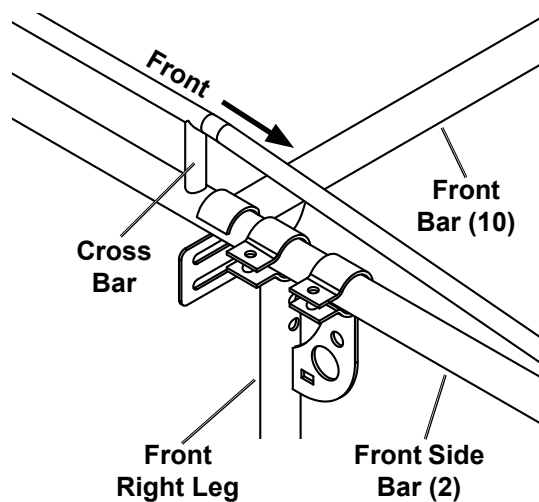

Figure F

- Secure connections with Bolt Sets B and G.

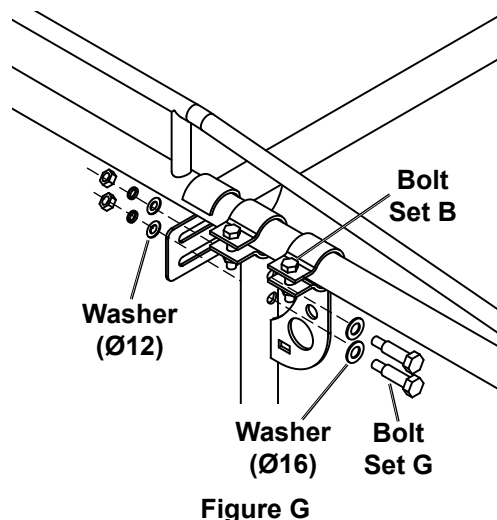

Figure G

HaulMaster®

- Slide Rear Side Bars (3) into Front Side Bars (2). Secure connections with Clamps (13) and Bolt Set A.

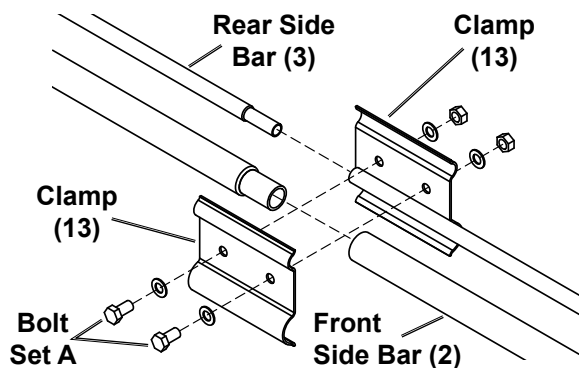

Figure H

- Slide the Foam Sleeves (48—part of Bolt Set H) over the ends of the Cab Bar (1). Slide ends of Cab Bar over Front Side Bars. Place Rubber Washers (49—part of Bolt Set H) on both sides of the Foam Sleeves. Attach with Bolt Set H.

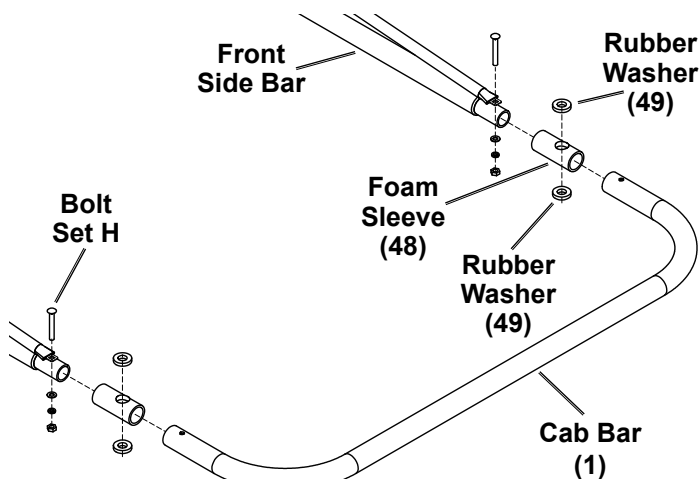

Figure I

Attaching the Feet

- Measure the height of the Truck Rack and determine if additional height is needed to clear the truck's cab.
- If additional height is needed, attach Risers (14) to bottoms of Legs with Bolt Set J.
- Attach Feet (8L, 8R, 9L, 9R) to corresponding Legs so that the lips will face inside the truck bed.
- Attach with Bolt Sets F1 and F2.

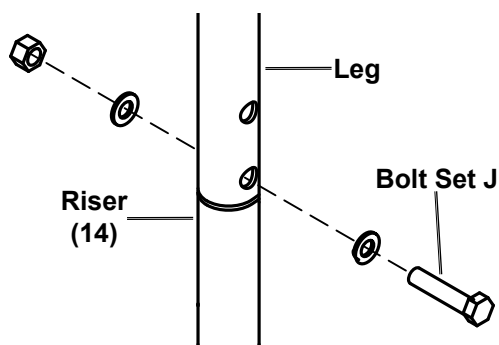

Figure K

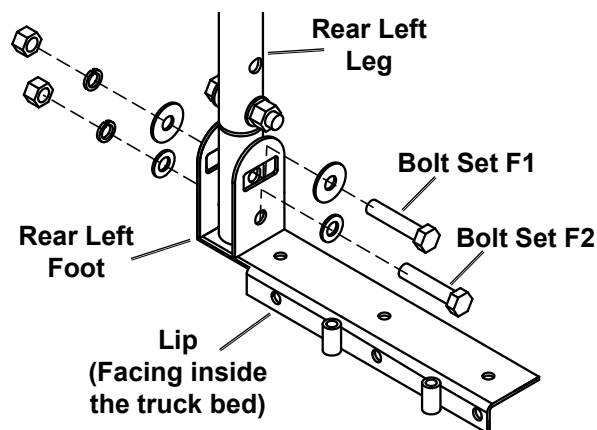

Figure L

Installation



Read the **ENTIRE IMPORTANT SAFETY INFORMATION** section at the beginning of this manual including all text under subheadings therein before set up or use of this product.

WARNING

TO PREVENT SERIOUS INJURY DURING INSTALLATION:

Park truck on a flat, level, hard surface well away from traffic. Place transmission in park/neutral and set parking brake.

Before Installation

1. Measure the length of the truck bed with the tailgate closed, then measure the distance between the Front and Rear Legs.
2. Adjust the Front and Rear Legs to match the length of the truck bed.
3. **With assistance**, lift the Truck Rack onto the truck bed.
4. Position the Legs as close to the corners of the truck bed's rails as possible. Adjust the legs to avoid obstructions on the underside of rails at installation points.

Permanent Installation

WARNING! Verify that installation surface has no hidden wires before drilling or driving screws.

1. Position the Feet so that the lips are flush with the insides of the rails.
2. Using the Feet as templates, mark locations of mounting holes.
3. Drill holes at the marked locations appropriate for the proper hardware (sold separately) described under Specifications on page 2.
4. Position the Feet so that mounting holes align with pilot holes, then secure the Feet with the hardware.

5. Square and level all components, then tighten all hardware securely.

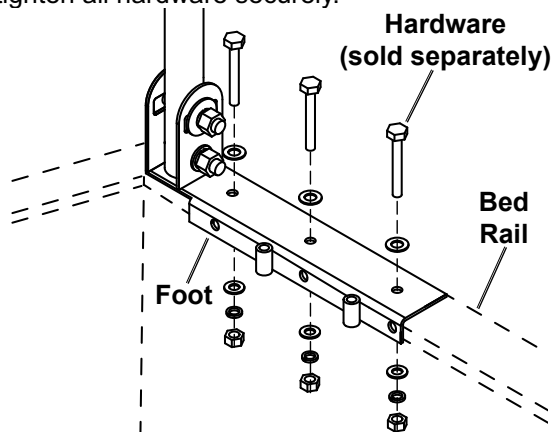

Figure M

Temporary Installation

1. Position the Feet so that the lips are flush with the insides of the rails.
2. Using Bolt Set I, insert the J-Hooks up through the mounting tubes on each Foot.
3. Secure from the top, tightening hardware until the J-Hooks are holding the Feet tightly against the bed rail.
4. Square and level all components, then tighten all hardware securely.

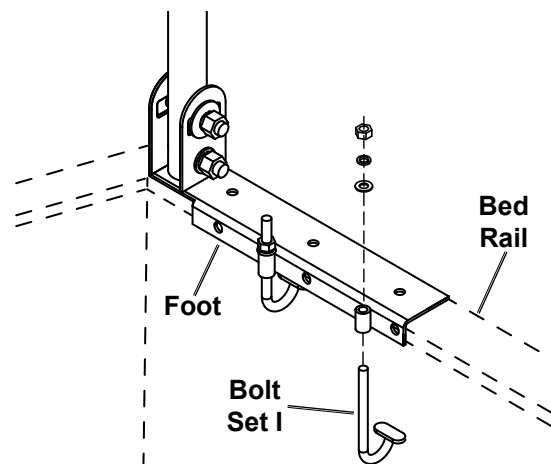

Figure N

Maintenance and Servicing



Procedures not specifically explained in this manual must be performed only by a qualified technician.

!WARNING

TO PREVENT SERIOUS INJURY FROM TRUCK RACK FAILURE:

Do not use damaged equipment. If Truck Rack is damaged or if abnormal noise or vibration occurs, have the problem corrected before further use.

1. **BEFORE EACH USE**, inspect the general condition of the Truck Rack. Check for:
 - loose hardware
 - misalignment or binding of moving parts
 - cracked or broken parts
 - any other condition that may affect its safe operation.
2. **AFTER USE**, wipe external surfaces of the Truck Rack with clean cloth.

PLEASE READ THE FOLLOWING CAREFULLY

SAFETY

THE MANUFACTURER AND/OR DISTRIBUTOR HAS PROVIDED THE PARTS LIST AND ASSEMBLY DIAGRAM IN THIS DOCUMENT AS A REFERENCE TOOL ONLY. NEITHER THE MANUFACTURER OR DISTRIBUTOR MAKES ANY REPRESENTATION OR WARRANTY OF ANY KIND TO THE BUYER THAT HE OR SHE IS QUALIFIED TO MAKE ANY REPAIRS TO THE PRODUCT, OR THAT HE OR SHE IS QUALIFIED TO REPLACE ANY PARTS OF THE PRODUCT. IN FACT, THE MANUFACTURER AND/OR DISTRIBUTOR EXPRESSLY STATES THAT ALL REPAIRS AND PARTS REPLACEMENTS SHOULD BE UNDERTAKEN BY CERTIFIED AND LICENSED TECHNICIANS, AND NOT BY THE BUYER. THE BUYER ASSUMES ALL RISK AND LIABILITY ARISING OUT OF HIS OR HER REPAIRS TO THE ORIGINAL PRODUCT OR REPLACEMENT PARTS THERETO, OR ARISING OUT OF HIS OR HER INSTALLATION OF REPLACEMENT PARTS THERETO.

SETUP

INSTALLATION

MAINTENANCE

Record Serial Number Here: _____

Note: If product has no serial number, record month and year of purchase instead.

Note: Some parts are listed and shown for illustration purposes only, and are not available individually as replacement parts. Specify UPC 193175228628 when ordering parts.

SAFETY

SETUP

INSTALLATION

MAINTENANCE

Components Parts List

| Part | Description | Qty |
|------|-----------------|-----|
| 1 | Cab Bar | 1 |
| 2 | Front Side Bar | 2 |
| 3 | Rear Side Bar | 2 |
| 4 | Front Right Leg | 1 |
| 5 | Front Left Leg | 1 |
| 6 | Rear Right Leg | 1 |
| 7 | Rear Left Leg | 1 |
| 8L | Front Left Foot | 1 |

| Part | Description | Qty |
|------|------------------|-----|
| 8R | Front Right Foot | 1 |
| 9L | Rear Left Foot | 1 |
| 9R | Rear Right Foot | 1 |
| 10 | Front Bar | 1 |
| 11 | Center Bar | 1 |
| 12 | Rear Bar | 1 |
| 13 | Clamp | 4 |
| 14 | Riser | 4 |

Hardware Parts List

| Bolt Set | Part | Description | Qty |
|----------|------|--------------------|--------|
| A | 15 | Bolt M16x30 | 4 sets |
| | 16 | Nut | |
| | 17 | Washer (2 per set) | |
| B | 18 | Bolt M12x50 | 8 sets |
| | 19 | Nut | |
| | 20 | Washer | |
| C | 21 | Bolt M10x35 | 2 sets |
| | 23 | Washer | |
| D | 21 | Bolt M10x35 | 2 sets |
| | 22 | Nut | |
| | 23 | Washer | |
| E | 24 | Bolt M12x75 | 2 sets |
| | 25 | Nut | |
| | 26 | Washer | |
| F1 | 27 | Bolt M18x85 | 4 sets |
| | 28 | Nut | |
| | 29 | Spring Washer | |
| | 30 | Washer (2 per set) | |
| F2 | 27 | Bolt M18x85 | 4 sets |
| | 28 | Nut | |
| | 29 | Spring Washer | |
| | 47 | Washer (2 per set) | |

| Bolt Set | Part | Description | Qty |
|----------|------|---------------------------|--------|
| G | 31 | Bolt M12x70 | 8 sets |
| | 32 | Nut | |
| | 33 | Spring Washer | |
| | 34 | Washer Ø12 | |
| | 46 | Washer Ø16 | |
| H | 35 | Bolt M10x80 | 2 sets |
| | 36 | Nut | |
| | 37 | Spring Washer | |
| | 38 | Washer | |
| | 48 | Foam Sleeve | |
| I | 49 | Rubber Washer (2 per set) | 8 sets |
| | 39 | J-Hook M12x70 | |
| | 40 | Nut | |
| | 41 | Spring Washer | |
| J | 42 | Washer | 4 sets |
| | 43 | Bolt M18x70 | |
| | 44 | Nut | |
| | 45 | Washer (2 per set) | |



Assembly Diagram

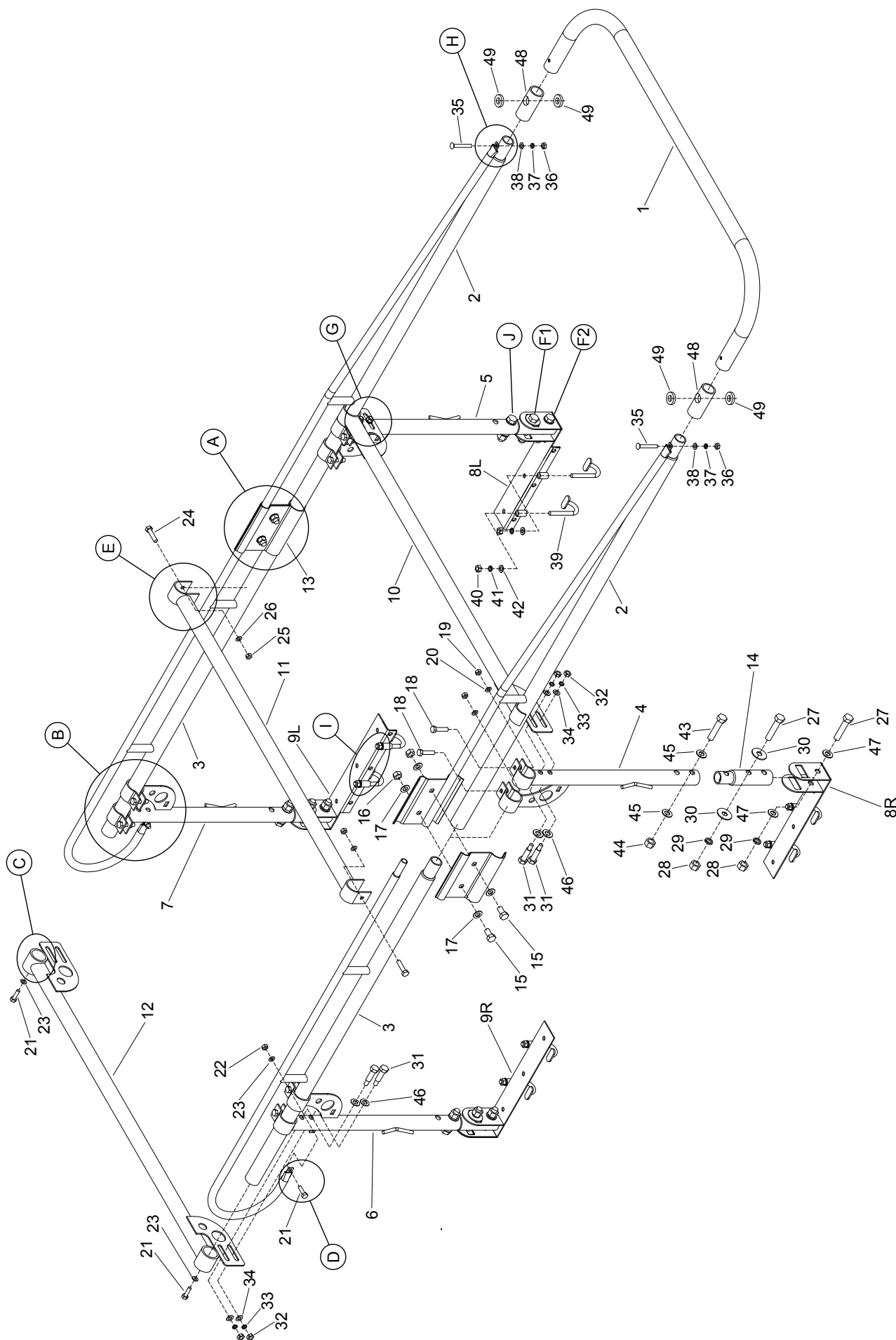

SAFETY

SETUP

INSTALLATION

MAINTENANCE

Limited 90 Day Warranty

Harbor Freight Tools Co. makes every effort to assure that its products meet high quality and durability standards, and warrants to the original purchaser that this product is free from defects in materials and workmanship for the period of 90 days from the date of purchase. This warranty does not apply to damage due directly or indirectly, to misuse, abuse, negligence or accidents, repairs or alterations outside our facilities, criminal activity, improper installation, normal wear and tear, or to lack of maintenance. We shall in no event be liable for death, injuries to persons or property, or for incidental, contingent, special or consequential damages arising from the use of our product. Some states do not allow the exclusion or limitation of incidental or consequential damages, so the above limitation of exclusion may not apply to you. THIS WARRANTY IS EXPRESSLY IN LIEU OF ALL OTHER WARRANTIES, EXPRESS OR IMPLIED, INCLUDING THE WARRANTIES OF MERCHANTABILITY AND FITNESS.

To take advantage of this warranty, the product or part must be returned to us with transportation charges prepaid. Proof of purchase date and an explanation of the complaint must accompany the merchandise. If our inspection verifies the defect, we will either repair or replace the product at our election or we may elect to refund the purchase price if we cannot readily and quickly provide you with a replacement. We will return repaired products at our expense, but if we determine there is no defect, or that the defect resulted from causes not within the scope of our warranty, then you must bear the cost of returning the product.

This warranty gives you specific legal rights and you may also have other rights which vary from state to state.

