

Owner's Manual & Safety Instructions

Save This Manual Keep this manual for the safety warnings and precautions, assembly, operating, inspection, maintenance and cleaning procedures. Write the product's serial number in the back of the manual near the assembly diagram (or month and year of purchase if product has no number). Keep this manual and the receipt in a safe and dry place for future reference.

18j

QUINN™ 64915 64916

DIGITAL TORQUE WRENCH



Visit our website at: <http://www.harborfreight.com>
Email our technical support at: productsupport@harborfreight.com

When unpacking, make sure that the product is intact and undamaged. If any parts are missing or broken, please call 1-888-866-5797 as soon as possible.

Copyright© 2018 by Harbor Freight Tools®. All rights reserved.

No portion of this manual or any artwork contained herein may be reproduced in any shape or form without the express written consent of Harbor Freight Tools. Diagrams within this manual may not be drawn proportionally. Due to continuing improvements, actual product may differ slightly from the product described herein. Tools required for assembly and service may not be included.

⚠WARNING

Read this material before using this product. Failure to do so can result in serious injury. **SAVE THIS MANUAL.**

Specifications

Model	64915	64916
Drive Size	3/8"	1/2"
Torque Range	5-100 ft. lb.	12.5-250 ft. lb.
Batteries	2 x 'AA'	
Torque Accuracy	±3% CW, ±4% CCW	
Angle Accuracy	±3° (rotating 90° at speed of 30°/sec)	

IMPORTANT SAFETY INFORMATION



WARNING Read all safety warnings and instructions.

Failure to follow the warnings and instructions may result in injury.

Save all warnings and instructions for future reference.

1. Wear ANSI-approved safety goggles during use.
 2. Do not mix old and new batteries.
Do not mix alkaline, standard (carbon-zinc), or rechargeable (nickel-cadmium) batteries.
Position batteries in proper polarity.
Do not use swollen or leaking batteries.
 3. Use as intended only:
 - a. Do not use for loosening fasteners.
 - b. Use only within rated torque range.
 - c. Do not use as hammer or pry bar.
 - d. Do not use handle extension to increase force.
Do not use as a breaker bar.
 - e. Do not use a Torque Wrench that has been dropped. Have it tested before putting back into use.
 - f. Do not expose to heat, humidity, or direct sunlight for a long period.
 - g. Keep dry. If the wrench gets wet, dry it off thoroughly as soon as possible. Especially avoid exposure to seawater.
 - h. Do not use organic solvents, such as alcohol or paint thinner to clean the wrench.
 - i. Keep away from magnets.
 - j. Do not expose to dust or sand.
 - k. Do not apply force to the LCD panel.
4. Have the Torque Wrench calibrated and serviced only by a qualified technician.
 5. Inspect before every use; do not use if damaged or if parts are loose.
 6. Keep away from children.
 7. Use only sockets with the correct drive and rated to at least the torque that will be applied to it.
 8. The warnings, cautions, and instructions in this instruction manual cannot cover all possible conditions and situations that may occur. It must be understood by the operator that common sense and caution are factors which cannot be built into this product, but must be supplied by the operator.

Operation



Read the **ENTIRE IMPORTANT SAFETY INFORMATION** section at the beginning of this document including all text under subheadings therein before set up or use of this product.

Battery Installation

1. Use a coin to twist the Battery Cap at the base of the Wrench until the slot in the Cap lines up with the empty circles ◦ on the housing and remove the Cap.

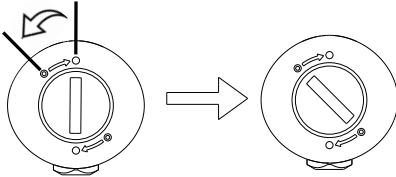

Figure A: Opening Battery Compartment

2. Insert two AA batteries with their positive + ends first.

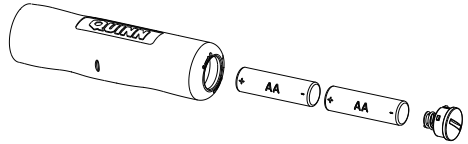
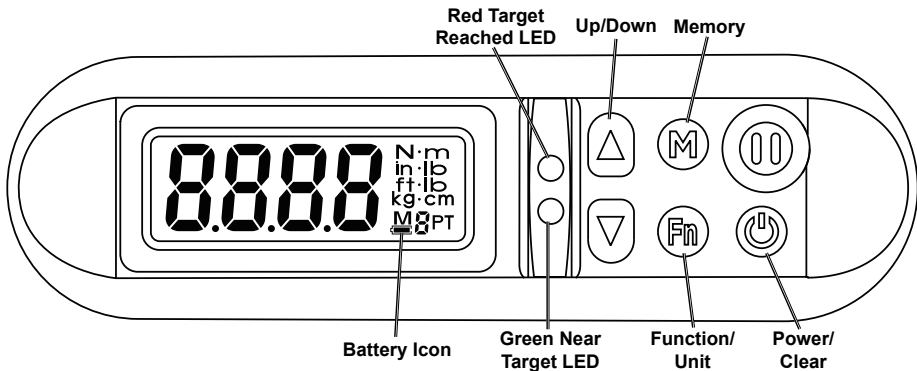

Figure B

3. Align the slot in the cap with the filled circles ◐ on the housing and press it back in place. Use a coin to twist it until the slot lines up with the filled circles ●.

Controls



M - Memory Button: Cycle through the saved presets, indicated by **M** ; - **M** on the lower right corner of the display.

Fn - Function/Unit Button: Cycle through measurement units for the selected preset: N-m, in-lb, ft-lb, kg-cm, and angle (flashing 0000).

Up/Down - Up/Down Buttons: Adjust torque/angle target value.

 - Battery Icon: This indicates that the battery power is low. Replace the batteries before further use to prevent inaccurate readings.

Turning on the Wrench

1. The Wrench automatically resets its angle and torque range when it is turned on.
2. Leave the Wrench in its case, or laying horizontally on a stable surface while turning on. If the Wrench is moved or its anvil turned when first turned on, readings may be inaccurate.

Note: The Wrench will automatically turn off after about 2 minutes of inactivity.

Advanced Settings

1. Press and hold Fn Button until $\tilde{n}odE$ appears, then release it.
2. $\tilde{n}odE$ means Peak/Track setting.
3. Press Fn Button.
 $R-U$ means Angle Torque Unit setting.
4. Press Fn Button. If there are saved torque measurements $n00!$ (cycling between record number and recorded value) will be displayed, otherwise $n0nE$ will be displayed. This is the Saved Measurement Review mode.
5. Press Fn Button again to display LrR , Measurement Clear mode. Press the \cup Button twice to clear the previously displayed Saved Measurement.
6. Press Fn Button again to display $L0nU$, Communication Mode. This Mode is not used on this Wrench.
7. Press Fn Button one last time to return to normal measurement mode.

Setting Peak/Track

1. Follow instructions above to enter $\tilde{n}odE$ setting.
2. Use Up/Down Buttons to toggle between Track (T) and Peak (P) modes. The selected mode is shown in the lower right of the display.
3. Press and hold Fn Button until $\tilde{n}odE$ disappears.

Setting Angle Torque Unit

1. Follow instructions above to enter $R-U$ setting.
2. Use Up/Down Buttons to change torque unit. The selected unit is shown on the right side of the display.
3. Press and hold Fn Button until $R-U$ disappears.

Saved Measurement Review

1. Follow instructions above to enter Saved Measurement Review mode.
2. If there are saved torque measurements $n00!$ (cycling between record number and recorded value) will be displayed, otherwise $n0nE$ will be displayed.
3. Use Up/Down Buttons to select a Saved Measurement.
4. Press Fn Button again to display LrR , Measurement Clear mode.
To clear a saved measurement:
 - a. Press the \cup Button.
 - b. $n0!$ will be displayed to confirm deletion.
 - c. Press the \cup Button again to confirm deletion or press the Fn Button to cancel. When a measurement is deleted $dE!$ will be displayed briefly.
5. Press Fn Button again to display $L0nU$, and exit Saved Measurement mode.



Measuring Torque

1. Use the M Button to select one of the target torque ratings.
2. Use Up/Down Buttons to adjust target as desired.
3. Apply torque slowly and grasp the center of the handle. Do not apply load to the end of the handle or the display.

4. The current torque will be displayed. Press the M Button to save the measurement. $r \overline{E} \overline{L}$ will be displayed while the Wrench saves the measurement.

Note: If the display shows $F \overline{U} \overline{L}$ instead, the Wrench has no memory available to save new measurements. Previously saved measurements need to be deleted before new measurements can be saved.

5. When 90% of the target torque rating is reached, the green indicator will light and the Wrench will beep periodically.
6. When the target torque rating is reached, the red indicator will light and the Wrench will beep continuously.

Measuring Angles

1. Use the M Button to select one of the target angles.
2. Use Up/Down Buttons to adjust target as desired.
3. Press the \odot Button. $\overline{O} \overline{O} \overline{O} \overline{O}$ will flash on the display while the Wrench prepares to measure an angle. Once the target angle appears again, the wrench is ready to measure an angle.

Note: If the target angle does not appear after several seconds or $\overline{E} \overline{r} \overline{U}$ is displayed, angle preparation was not able to complete. The Wrench may have been moved or the anvil turned. Rest the Wrench on a stable surface and press the \odot Button to try again.

4. Apply torque slowly and grasp the center of the handle. Do not apply load to the end of the handle or the display.

Note: Angle will be measured when at least 5% of maximum operation torque is reached.

5. The current angle will be displayed. Press the M Button to save the measurement. $r \overline{E} \overline{L}$ will be displayed while the Wrench saves the measurement.

Note: If the display shows $F \overline{U} \overline{L}$ instead, the Wrench has no memory available to save new measurements. Previously saved measurements need to be deleted before new measurements can be saved.

6. When 90% of the target angle is reached, the green indicator will light and the Wrench will beep periodically.
7. When the target angle is reached, the red indicator will light and the Wrench will beep continuously.

Note: The display will alternate between current torque and current angle when target angle has been reached.



Maintenance and Servicing



Procedures not specifically explained in this manual must be performed only by a qualified technician.

CAUTION

TO PREVENT INJURY FROM TOOL FAILURE:

Do not use damaged equipment. If abnormal noise or vibration occurs, have the problem corrected before further use.

1. **BEFORE EACH USE**, inspect the general condition of the tool. Check for:
 - loose hardware,
 - misalignment or binding of moving parts,
 - cracked or broken parts, and
 - any other condition that may affect its safe operation.
2. **AFTER USE:**
Wipe Wrench with a clean cloth. Do not use liquid on the cloth or immerse wrench in liquid.
3. **EVERY 6 MONTHS**, have the Torque Wrench calibrated and serviced by a qualified technician.
4. Remove batteries before storage.

Note: Replacement parts are not available.

Troubleshooting

Problem	Possible Causes	Likely Solutions
Er4 or Er5 displayed.	The Wrench has a temporary error.	Remove batteries, reinsert them, and turn Wrench back on.
Display will not turn on or display is dim.	Battery power is low.	Install new or recharged batteries in proper polarity. Do not mix alkaline, standard (carbon-zinc), or rechargeable (nickel-cadmium) batteries.
Display continues to flash 0000 .	Wrench moved or anvil turned while preparing for angle measurement.	Rest the Wrench on a stable surface and press the 0 Button to try angle measurement preparation again.
Display shows FULL instead of saving torque or angle measurements.	The Wrench has no memory available to save new measurements.	Delete previously saved measurements to allow new measurements to be saved.

Limited 90 Day Warranty

Harbor Freight Tools Co. makes every effort to assure that its products meet high quality and durability standards, and warrants to the original purchaser that this product is free from defects in materials and workmanship for the period of 90 days from the date of purchase. This warranty does not apply to damage due directly or indirectly, to misuse, abuse, negligence or accidents, repairs or alterations outside our facilities, criminal activity, improper installation, normal wear and tear, or to lack of maintenance. We shall in no event be liable for death, injuries to persons or property, or for incidental, contingent, special or consequential damages arising from the use of our product. Some states do not allow the exclusion or limitation of incidental or consequential damages, so the above limitation of exclusion may not apply to you. THIS WARRANTY IS EXPRESSLY IN LIEU OF ALL OTHER WARRANTIES, EXPRESS OR IMPLIED, INCLUDING THE WARRANTIES OF MERCHANTABILITY AND FITNESS.

To take advantage of this warranty, the product or part must be returned to us with transportation charges prepaid. Proof of purchase date and an explanation of the complaint must accompany the merchandise. If our inspection verifies the defect, we will either repair or replace the product at our election or we may elect to refund the purchase price if we cannot readily and quickly provide you with a replacement. We will return repaired products at our expense, but if we determine there is no defect, or that the defect resulted from causes not within the scope of our warranty, then you must bear the cost of returning the product.

This warranty gives you specific legal rights and you may also have other rights which vary from state to state.

