

# Owner's Manual & Safety Instructions

Save This Manual Keep this manual for the safety warnings and precautions, assembly, operating, inspection, maintenance and cleaning procedures. Write the product's serial number in the back of the manual near the assembly diagram (or month and year of purchase if product has no number). Keep this manual and the receipt in a safe and dry place for future reference.

22i

# **PITTSBURGH<sup>®</sup> AUTOMOTIVE**

**67441**

## ***1500 lb. Capacity Heavy Duty Load Leveler***



Visit our website at: <http://www.harborfreight.com>  
Email our technical support at: [productsupport@harborfreight.com](mailto:productsupport@harborfreight.com)

When unpacking, make sure that the product is intact and undamaged. If any parts are missing or broken, please call 1-888-866-5797 as soon as possible.

Copyright© 2022 by Harbor Freight Tools®. All rights reserved.

No portion of this manual or any artwork contained herein may be reproduced in any shape or form without the express written consent of Harbor Freight Tools. Diagrams within this manual may not be drawn proportionally. Due to continuing improvements, actual product may differ slightly from the product described herein. Tools required for assembly and service may not be included.

### **⚠ WARNING**

**Read this material before using this product.  
Failure to do so can result in serious injury.  
SAVE THIS MANUAL.**

## Specifications

Rated Capacity	1500 lb
Length	16"

## IMPORTANT SAFETY INFORMATION

1. Study, understand, and follow all instructions before operating this device.
2. Do not exceed rated capacity.
3. Ensure load is secured to the device.
4. To be used only with the following PASE: shop cranes or hoists suitable for load.
5. Failure to heed this information may result in personal injury and/or property damage.
6. Release load-locking devices (if employed) slowly and carefully.
7. No alterations shall be made to this product.
8. Do not allow load to swing or drop violently while lowering or moving.
9. Use as intended only. Do not use for lifting human weight or overhead lifting. Keep clear of raised load.
10. Inspect before every use; do not use if parts are loose or damaged.
11. Wear ANSI-approved safety goggles and heavy-duty work gloves during setup and use.
12. Do not use for aircraft purposes.
13. Do not work underneath, on, or near a lifted load.
14. Maintain product labels and nameplates. These carry important safety information. If unreadable or missing, contact Harbor Freight Tools for a replacement.
15. This product is not a toy. Keep it out of reach of children.
16. Keep bystanders out of the area during use.
17. Do not setup or use when tired or when under the influence of alcohol, drugs or medication.
18. The warnings, precautions, and instructions discussed in this instruction manual cannot cover all possible conditions and situations that may occur. It must be understood by the operator that common sense and caution are factors which cannot be built into this product, but must be supplied by the operator.



**SAVE THESE INSTRUCTIONS.**

## Assembly Instructions

For shipping purposes, the Handle comes installed on the inside of the Crank. It must be reinstalled on the outside of the Crank.

1. Remove the Handle by removing the Bolt (19).
2. Place the Handle on the outside of the Crank and replace the Bolt.

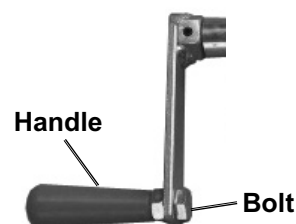

## Operating Instructions

1. Attach the Hanger to a Crane or Hoist (sold separately).
2. Secure the load to the Brackets.
3. Turn the Handle to move the load to its balance point, so that it is hanging evenly from the Leveler.
4. Lower load and detach Leveler after use. Do not use to support load for extended periods.
5. Grease the Threaded Bar (7), as needed, so that the Sliding Block (6) moves smoothly.

## Parts List and Diagram

Part	Description	Qty
1	Lifting Chain	1
2	Bolt (M12x40)	1
3	Lock Nut (M12)	2
4	Bushing	1
5	Connecting Plate	2
6	Sliding Block	1
7	Threaded Bar	1
8	Connecting Plate	2
9	Crank	1
10	Spring Pin	2
11	Bushing	1

Part	Description	Qty
12	Bolt (M10x25)	4
13	Lock Nut (M10)	4
14	Cross Beam	1
15	Bolt (M12x45)	1
16	Bushing	1
17	Shackle	2
18	Chain/Bracket Set	4
19	Bolt (M10x35)	1
20	Nut M10	1
21	Handle	1
22	Nut M16	1

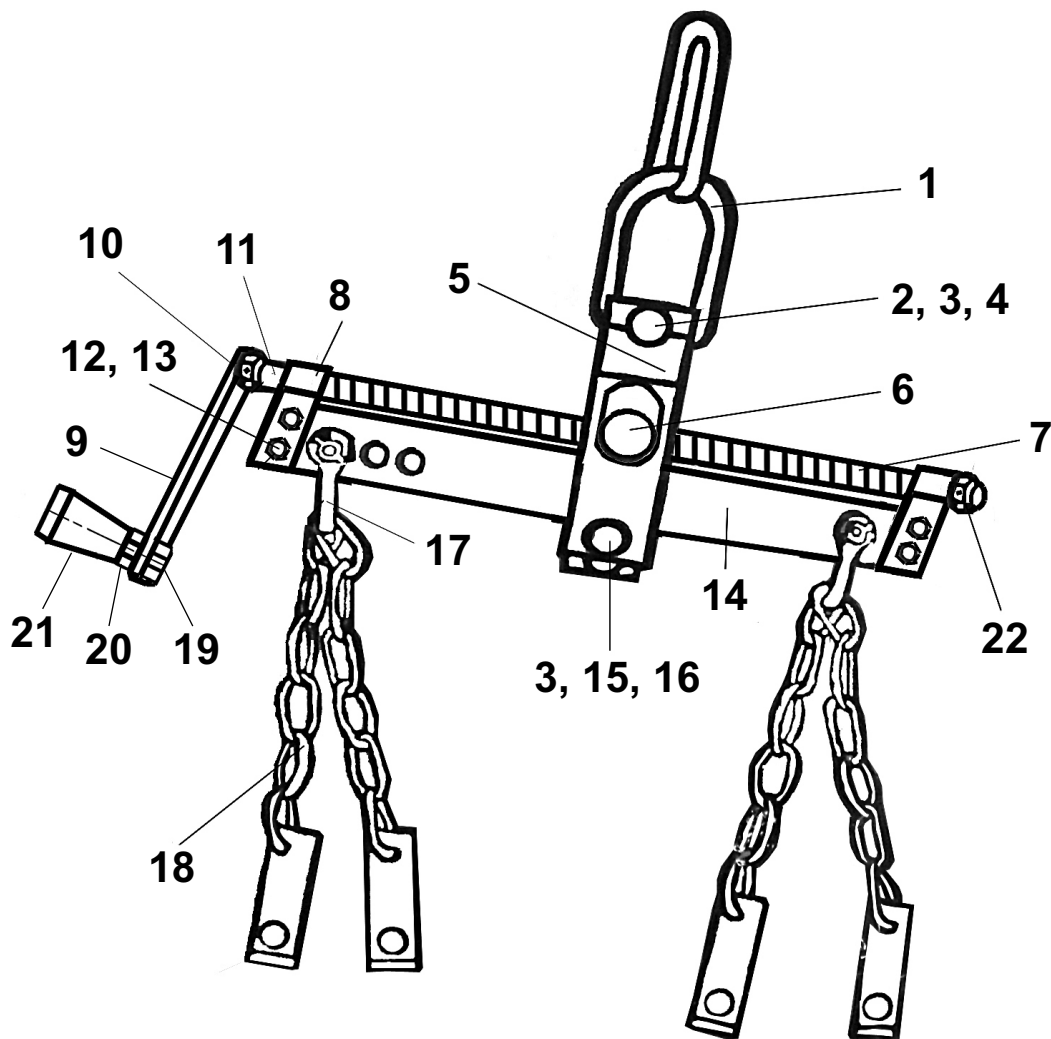

Record Serial Number Here:

---

**Note:** If product has no serial number, record month and year of purchase instead.

**Note:** Some parts are listed and shown for illustration purposes only, and are not available individually as replacement parts. Specify UPC 792363674416 when ordering parts.

## PLEASE READ THE FOLLOWING CAREFULLY

---

THE MANUFACTURER AND/OR DISTRIBUTOR HAS PROVIDED THE PARTS LIST AND ASSEMBLY DIAGRAM IN THIS MANUAL AS A REFERENCE TOOL ONLY. NEITHER THE MANUFACTURER OR DISTRIBUTOR MAKES ANY REPRESENTATION OR WARRANTY OF ANY KIND TO THE BUYER THAT HE OR SHE IS QUALIFIED TO MAKE ANY REPAIRS TO THE PRODUCT, OR THAT HE OR SHE IS QUALIFIED TO REPLACE ANY PARTS OF THE PRODUCT. IN FACT, THE MANUFACTURER AND/OR DISTRIBUTOR EXPRESSLY STATES THAT ALL REPAIRS AND PARTS REPLACEMENTS SHOULD BE UNDERTAKEN BY CERTIFIED AND LICENSED TECHNICIANS, AND NOT BY THE BUYER. THE BUYER ASSUMES ALL RISK AND LIABILITY ARISING OUT OF HIS OR HER REPAIRS TO THE ORIGINAL PRODUCT OR REPLACEMENT PARTS THERETO, OR ARISING OUT OF HIS OR HER INSTALLATION OF REPLACEMENT PARTS THERETO.

### Limited 90 Day Warranty

Harbor Freight Tools Co. makes every effort to assure that its products meet high quality and durability standards, and warrants to the original purchaser that this product is free from defects in materials and workmanship for the period of 90 days from the date of purchase. This warranty does not apply to damage due directly or indirectly, to misuse, abuse, negligence or accidents, repairs or alterations outside our facilities, criminal activity, improper installation, normal wear and tear, or to lack of maintenance. We shall in no event be liable for death, injuries to persons or property, or for incidental, contingent, special or consequential damages arising from the use of our product. Some states do not allow the exclusion or limitation of incidental or consequential damages, so the above limitation of exclusion may not apply to you. THIS WARRANTY IS EXPRESSLY IN LIEU OF ALL OTHER WARRANTIES, EXPRESS OR IMPLIED, INCLUDING THE WARRANTIES OF MERCHANTABILITY AND FITNESS.

To take advantage of this warranty, the product or part must be returned to us with transportation charges prepaid. Proof of purchase date and an explanation of the complaint must accompany the merchandise. If our inspection verifies the defect, we will either repair or replace the product at our election or we may elect to refund the purchase price if we cannot readily and quickly provide you with a replacement. We will return repaired products at our expense, but if we determine there is no defect, or that the defect resulted from causes not within the scope of our warranty, then you must bear the cost of returning the product.

This warranty gives you specific legal rights and you may also have other rights which vary from state to state.

**PITTSBURGH<sup>®</sup> AUTOMOTIVE**

26677 Agoura Road • Calabasas, CA 91302 • 1-888-866-5797