

# Owner's Manual & Safety Instructions

**Save This Manual** Keep this manual for the safety warnings and precautions, assembly, operating, inspection, maintenance and cleaning procedures. Write the product's serial number in the back of the manual near the assembly diagram (or month and year of purchase if product has no number). Keep this manual and the receipt in a safe and dry place for future reference.

20g

**PITTSBURGH** MOTORCYCLE

**ITEM 69026**

## WHEEL CHOCK

- *Self locking wheel chock works on virtually all standard motorcycles*
- *Motorcycle will stay in vertical position allowing bike to be strapped down*
- *Mounting frame allows quick & easy removal of the bike in seconds*

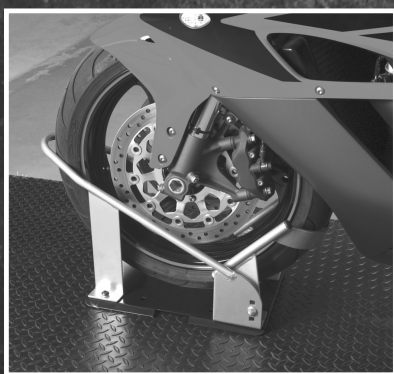
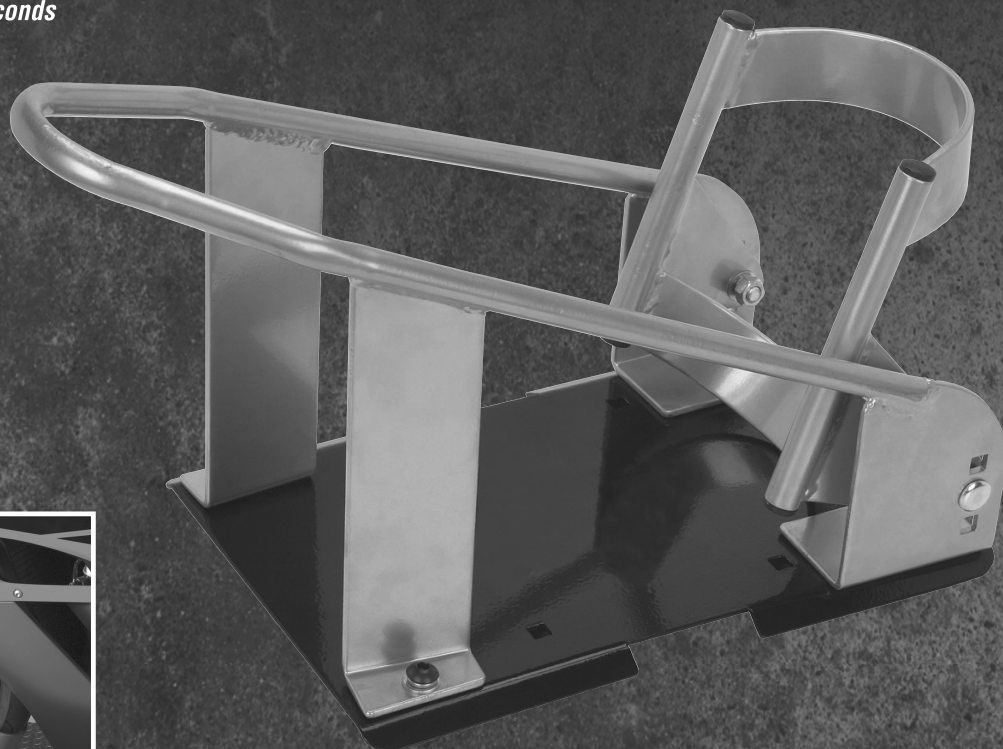

Usage shown above.  
Wheel not included.

Visit our website at: <http://www.harborfreight.com>  
Email our technical support at: [productsupport@harborfreight.com](mailto:productsupport@harborfreight.com)

When unpacking, make sure that the product is intact and undamaged. If any parts are missing or broken, please call 1-888-866-5797 as soon as possible.

Copyright© 2012 by Harbor Freight Tools®. All rights reserved.  
No portion of this manual or any artwork contained herein may be reproduced in any shape or form without the express written consent of Harbor Freight Tools. Diagrams within this manual may not be drawn proportionally. Due to continuing improvements, actual product may differ slightly from the product described herein. Tools required for assembly and service may not be included.

### ⚠ WARNING

Read this material before using this product.  
Failure to do so can result in serious injury.  
**SAVE THIS MANUAL.**

# IMPORTANT SAFETY INFORMATION

## WARNING

**Read all safety warnings and instructions.**

*Failure to follow the warnings and instructions may result in serious injury.*

**Save all warnings and instructions for future reference.**

1. **Keep your work area clean and well lit.** Cluttered benches and dark areas invite accidents.
2. **Keep children and visitors away while installing.** Distractions can cause you to lose control.
3. Store idle products out of reach of children and other untrained persons. Never allow children to play with or around the Wheel Chock.
4. **Stay alert. Watch what you are doing, and use common sense when using the Wheel Chock. Do not use this product while tired or under the influence of drugs, alcohol, or medication.** A moment of inattention while operating may result in serious personal injury.
5. **Dress properly. Do not wear loose clothing or jewelry. Contain long hair. Keep your hair, clothing, and gloves away from moving parts.** Loose clothes, jewelry, or long hair can be caught in moving parts.
6. **Do not overreach. Keep proper footing and balance at all times.** Proper footing and balance enables better control of the motorcycle in unexpected situations.
7. **Use safety equipment. Always wear eye protection.** Dust mask, nonskid safety shoes, hard hat, heavy-duty work gloves, or hearing protection must be used for appropriate conditions. Always wear ANSI-approved safety goggles and a dust mask/respirator when installing or performing maintenance on this tool.
8. **Maintain labels and nameplates on the tool.** These carry important information. If unreadable or missing, contact Harbor Freight Tools for a replacement.
9. **Use the correct product for your motorcycle.** Make sure the motorcycle's wheel fits into the Wheel Chock prior to first use.
10. The warnings, precautions, and instructions discussed in this instruction manual cannot cover all possible conditions and situations that may occur. It must be understood by the operator that common sense and caution are factors which cannot be built into this product, but must be supplied by the operator.



## SAVE THESE INSTRUCTIONS.

## Specifications

Construction	Formed Steel w/ Carbon Steel Hardware & Thermoplastic End Caps
Overall Dimensions	24-1/2" L X 9-3/4" W X 12-7/8" H
Weight	16 Pounds
Moveable Chock Length	10"

## Setup and Use



Read the **ENTIRE IMPORTANT SAFETY INFORMATION** section at the beginning of this manual including all text under subheadings therein before set up or use of this product.

**Note:** For additional information regarding the parts listed in the following pages, refer to the Assembly Diagram at the end of the manual.

The Wheel Chock comes fully assembled, however it must be mounted onto a solid surface to secure it. It is designed to be mounted on the bed of a truck, or a motorcycle lift, or onto a concrete floor.

### Concrete Floor Mounting

1. Choose a location to install the Wheel Chock that is flat, level, and capable of bearing the combined weight of the Wheel Chock and the motorcycle being secured. Be certain that the location will not obstruct walkways and will still provide enough room to retrieve the motorcycle after it is mounted. The surface of the location should be one suitable for the mounting of heavy equipment.
2. Use the mounting holes in the Base (7) of the Wheel Chock as a template.
3. Arrange the Base (7) in the chosen location and, using a pencil, mark where the holes are to be drilled. You will need concrete anchors (not included) to secure the Base (7) to the concrete floor.
4. Using the correct size concrete drill bit (not included), drill the mounting holes to secure the Base (7).
5. Attach the concrete anchors to the floor.
6. Secure the Base (7) to the floor utilizing the concrete anchors.

### Truck Bed or Motorcycle Lift Mounting

1. Place the Base (7) in the desired location of the truck bed or motorcycle lift where you want to mount it. Use the Base (7) as a pattern to mark where you will drill the holes that accept the hardware to mount the Wheel Chock. Use a power drill (not included) and a steel cutting drill bit (not included) to drill holes in the truck bed or motorcycle lift.
2. Attach the Base (7) to the truck bed utilizing the Mounting Bolts (6), Nylon Sleeves (8), Large Washers (9), Spring Washers (3), and secure with nuts (10). **See Assembly Diagram.**

**Warning:** Before drilling, verify that the installation surface has no hidden wires, brake lines, etc.

### Operating Instructions

1. Select the correct mounting hole for the motorcycle being loaded into the Wheel Chock, and use the Pivot Bolts (5) to secure the Pivoting Bracket in place.
2. To load a motorcycle, lower the Pivoting Bracket (13) to the horizontal position and simply push the motorcycle into the Wheel Chock.

**Note:** Do not sit on the motorcycle when it is loaded in the Wheel Chock.

## Maintenance and Servicing



Procedures not specifically explained in this manual must be performed only by a qualified technician.

### ⚠ WARNING

**TO PREVENT SERIOUS INJURY FROM TOOL FAILURE: Do not use damaged equipment. If abnormal noise or vibration occurs, have the problem corrected before further use.**

1. **BEFORE EACH USE**, inspect the general condition of the tool. Check for loose screws, misalignment or binding of moving parts, cracked or broken parts, and any other condition that may affect its safe operation. Do not use damaged equipment.
2. Occasionally, wipe the Wheel Chock down with a soft cloth and mild detergent.
3. **AFTER USE**, wipe external surfaces of the tool with clean cloth.
4. The Pivoting Bracket will close on the motorcycle tire, securing the bike in an upright position.
5. For long-term storage, or if the Wheel Chock is mounted to a mobile platform, secure the motorcycle with belts or straps (not included).

## Parts List and Diagram

### PLEASE READ THE FOLLOWING CAREFULLY

THE MANUFACTURER AND/OR DISTRIBUTOR HAS PROVIDED THE PARTS LIST AND ASSEMBLY DIAGRAM IN THIS MANUAL AS A REFERENCE TOOL ONLY. NEITHER THE MANUFACTURER OR DISTRIBUTOR MAKES ANY REPRESENTATION OR WARRANTY OF ANY KIND TO THE BUYER THAT HE OR SHE IS QUALIFIED TO MAKE ANY REPAIRS TO THE PRODUCT, OR THAT HE OR SHE IS QUALIFIED TO REPLACE ANY PARTS OF THE PRODUCT. IN FACT, THE MANUFACTURER AND/OR DISTRIBUTOR EXPRESSLY STATES THAT ALL REPAIRS AND PARTS REPLACEMENTS SHOULD BE UNDERTAKEN BY CERTIFIED AND LICENSED TECHNICIANS, AND NOT BY THE BUYER. THE BUYER ASSUMES ALL RISK AND LIABILITY ARISING OUT OF HIS OR HER REPAIRS TO THE ORIGINAL PRODUCT OR REPLACEMENT PARTS THERETO, OR ARISING OUT OF HIS OR HER INSTALLATION OF REPLACEMENT PARTS THERETO.

Part	Description	Qty
1	Main Frame	1
2	Hex Bolt M10x20	4
3	Spring Washer	8
4	Flat Washer	4
5	Pivot Bolt M10x30	2
6	Bolt M10x70	4
7	Base	1
8	Nylon Sleeve	4
9	Large Washer	4
10	nut M10	6
11	Nylon Washer	2
12	Rubber Cap	4
13	Pivoting Bracket	1

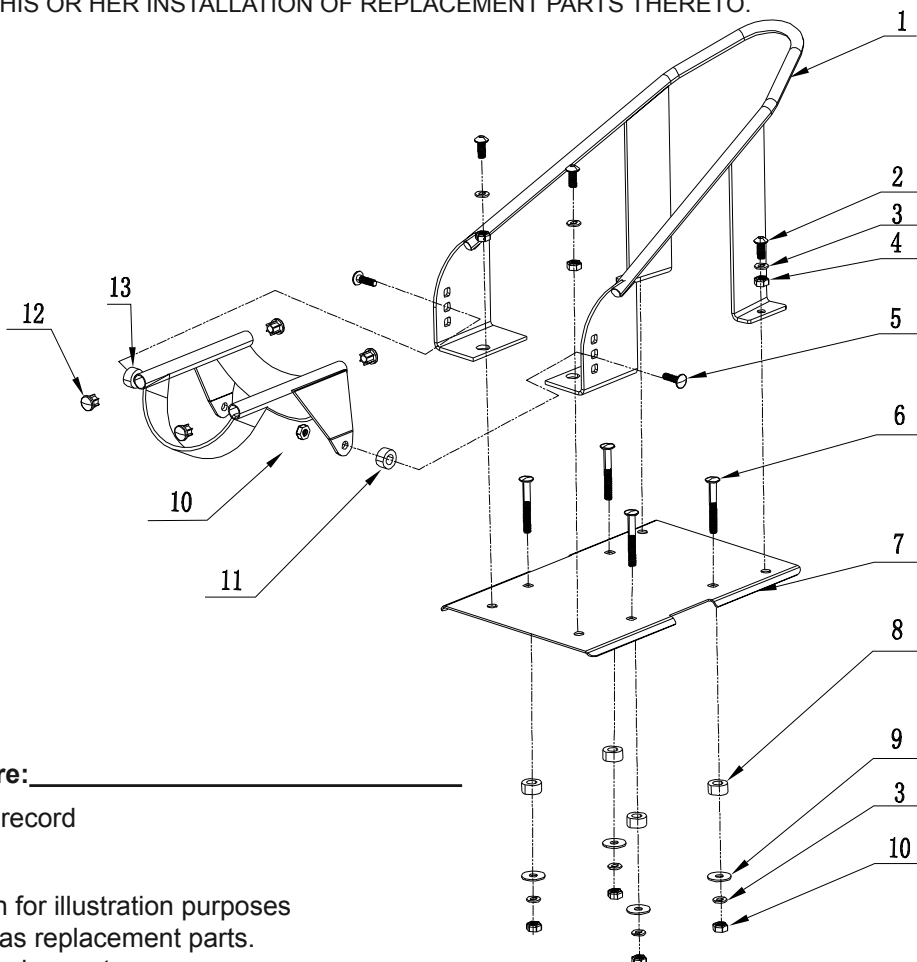

**Record Product's Serial Number Here:** \_\_\_\_\_

**Note:** If product has no serial number, record month and year of purchase instead.

**Note:** Some parts are listed and shown for illustration purposes only, and are not available individually as replacement parts. Specify UPC 193175316349 when ordering parts.

### Limited 90 Day Warranty

Harbor Freight Tools Co. makes every effort to assure that its products meet high quality and durability standards, and warrants to the original purchaser that this product is free from defects in materials and workmanship for the period of 90 days from the date of purchase. This warranty does not apply to damage due directly or indirectly, to misuse, abuse, negligence or accidents, repairs or alterations outside our facilities, criminal activity, improper installation, normal wear and tear, or to lack of maintenance. We shall in no event be liable for death, injuries to persons or property, or for incidental, contingent, special or consequential damages arising from the use of our product. Some states do not allow the exclusion or limitation of incidental or consequential damages, so the above limitation of exclusion may not apply to you. THIS WARRANTY IS EXPRESSLY IN LIEU OF ALL OTHER WARRANTIES, EXPRESS OR IMPLIED, INCLUDING THE WARRANTIES OF MERCHANTABILITY AND FITNESS.

To take advantage of this warranty, the product or part must be returned to us with transportation charges prepaid. Proof of purchase date and an explanation of the complaint must accompany the merchandise. If our inspection verifies the defect, we will either repair or replace the product at our election or we may elect to refund the purchase price if we cannot readily and quickly provide you with a replacement. We will return repaired products at our expense, but if we determine there is no defect, or that the defect resulted from causes not within the scope of our warranty, then you must bear the cost of returning the product.

This warranty gives you specific legal rights and you may also have other rights which vary from state to state.