

Owner's Manual & Safety Instructions

Save This Manual Keep this manual for the safety warnings and precautions, assembly, operating, inspection, maintenance and cleaning procedures. Write the product's serial number in the back of the manual near the assembly diagram (or month and year of purchase if product has no number). Keep this manual and the receipt in a safe and dry place for future reference.

23h

luminar INDOOR™

70030

LED TAPE LIGHT

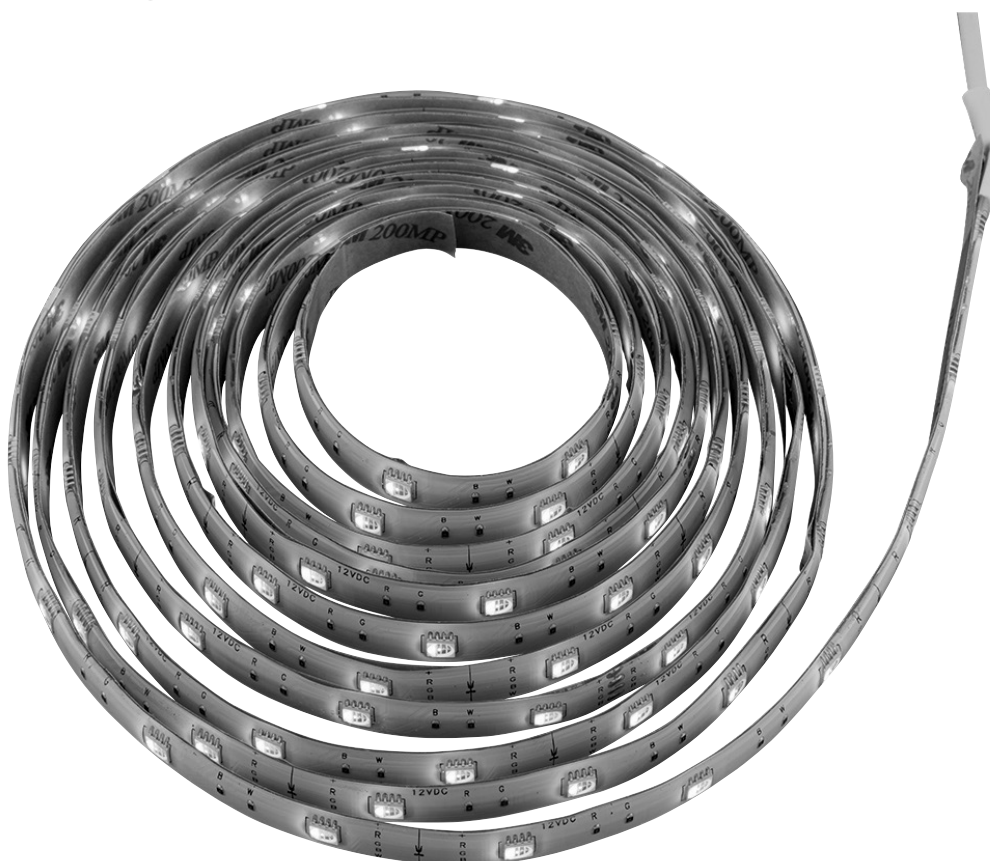

Visit our website at: <http://www.harborfreight.com>
Email our technical support at: productsupport@harborfreight.com





When unpacking, make sure that the product is intact and undamaged. If any parts are missing or broken, please call 1-888-866-5797 as soon as possible.

Copyright© 2018 by Harbor Freight Tools®. All rights reserved.
No portion of this manual or any artwork contained herein may be reproduced in any shape or form without the express written consent of Harbor Freight Tools. Diagrams within this manual may not be drawn proportionally. Due to continuing improvements, actual product may differ slightly from the product described herein. Tools required for assembly and service may not be included.

⚠ WARNING

Read this material before using this product.
Failure to do so can result in serious injury.
SAVE THIS MANUAL.

WARNING SYMBOLS AND DEFINITIONS

	This is the safety alert symbol. It is used to alert you to potential personal injury hazards. Obey all safety messages that follow this symbol to avoid possible injury or death.
	Indicates a hazardous situation which, if not avoided, will result in death or serious injury.
	Indicates a hazardous situation which, if not avoided, could result in death or serious injury.
	Indicates a hazardous situation which, if not avoided, could result in minor or moderate injury.
	Addresses practices not related to personal injury.

IMPORTANT SAFETY INFORMATION

WARNING

Read all safety warnings and instructions.

Failure to follow the warnings and instructions may result in electric shock, fire and/or serious injury.

Save all warnings and instructions for future reference.

1. For indoor use only. For electrical requirements, see Power Adapter Specifications.
2. Do not touch, operate, or install fixture while in contact with water. Not intended for illumination of aquariums. Do not mount over sinks or stoves.
3. Not intended for recessed installation in ceiling or soffits.
4. Lights may be installed inside of an enclosure only when the power adapter is located outside of the enclosure.
5. Use only insulated staples or plastic ties (not included) to secure cords. Do not run any cords behind walls, ceilings, soffits, cabinets or similar permanent structure where it may be inaccessible for examination. Do not use with an extension cord. Use a power strip with integral over-current protection to supply power to fixture.
6. Do not plug the power adapter into the power source until installation is complete.
7. Do not use this fixture with a dimming circuit. If dimmer controls are present, remove them and an electrician must replace them with regular electrical switches. If a three-way dimmer is present, an electrician must replace it with a regular three-way switch.
8. Keep installation area clean. Cluttered areas invite accidents.
9. Do not overreach. Keep proper footing and balance at all times. If a ladder is to be used during installation, it should be supported by an assistant.
10. People with pacemakers should consult their physician(s) before use. Electromagnetic fields in close proximity to heart pacemaker could cause pacemaker interference or pacemaker failure.
11. Use as intended only.
12. Maintain labels and nameplates on the Remote. These carry important safety information. If unreadable or missing, contact Harbor Freight Tools for a replacement.
13. The warnings, precautions, and instructions discussed in this instruction manual cannot cover all possible conditions and situations that may occur. It must be understood by the operator that common sense and caution are factors which cannot be built into this product, but must be supplied by the operator.
14. Do not install old and new batteries together. Do not install alkaline, carbon-zinc or rechargeable batteries together. Position batteries in proper polarity. Do not use swollen or leaking batteries.
15. This product has a polarized plug (one blade is wider than the other) as a feature to reduce the risk of electric shock. This plug will fit in a polarized outlet only one way. If the plug does not fit fully in the outlet, reverse the plug. If it still does not fit, contact a qualified electrician. Do not use with an extension cord unless plug can be fully inserted. Do not alter or replace the plug.



SAVE THESE INSTRUCTIONS.

Specifications

Electrical Rating	12VDC, Max. 2A, 24W
Tape Light Length	12ft.
Battery (Remote Control)	(2) AAA (included)

Changes or modifications not expressly approved by Harbor Freight Tools could void the user's authority to operate the equipment.

Note: This equipment has been tested and found to comply with the limits for a Class B digital device, pursuant to part 15 of the FCC Rules. These limits are designed to provide reasonable protection against harmful interference in a residential installation. This equipment generates, uses and can radiate radio frequency energy and, if not installed and used in accordance with the instructions, may cause harmful interference to radio communications. However, there is no guarantee that interference will not occur in a particular installation. If this equipment does cause harmful interference to radio or television reception, which can be determined by turning the equipment off and on, the user is encouraged to try to correct the interference by one or more of the following measures:

- Re-orient or relocate the receiving antenna.
- Increase the separation between the equipment and receiver.
- Connect the equipment into an outlet on a circuit different from that to which the receiver is connected
- Consult the dealer or an experienced radio/TV technician for help.



Setup



Read the **ENTIRE IMPORTANT SAFETY INFORMATION** section at the beginning of this manual including all text under subheadings therein before set up or use of this product.

WARNING

TO PREVENT SERIOUS INJURY FROM ACCIDENTAL OPERATION:
Do not plug Power Adapter into AC outlet until installation is complete.

Installation

1. Select and mark the location for the Tape Light. Make sure the Power Adapter reaches the AC outlet and Tape Light.
2. Using rubbing alcohol (not provided), thoroughly clean the mounting surface and allow it to dry.
3. To get around corners, the Tape Light can be cut and rejoined. Cut **ONLY** at the "cut symbol" which is located at 3.9" incremental lengths. Cutting elsewhere will damage the Tape Light.

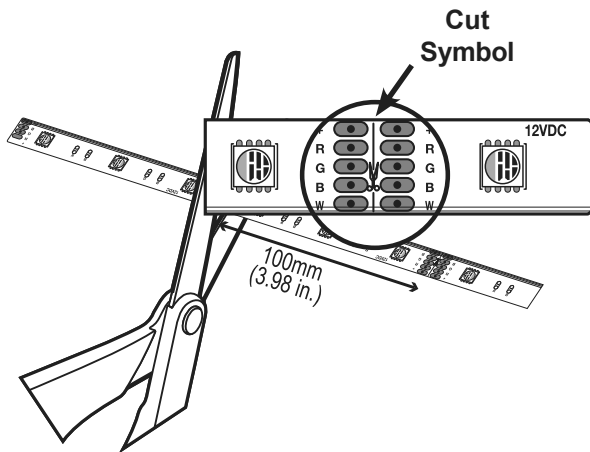

Note: Scissors not provided.

4. Once cut, the Tape Light can **ONLY** be rejoined with either the Block or Corner Connectors.

Note: Carefully measure the length of Tape Light before cutting to ensure the Block/Corner Connectors do not need to be repositioned as it may affect the performance of the Tape Light.

5. **To join two cut sections of Tape Light:**
 - a. Next to the cut, remove a small amount of adhesive tape from the back of the Tape Light, to expose the contact plates. Repeat for both sections.

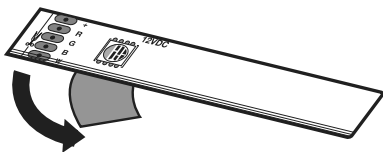

- b. Using a small flat-bladed screwdriver, pry the Block/Corner Connector latches open and lay the contact plates of each Tape Light section over the connector contact pins. Line up the polarity symbols at the end of each cut section.

- The polarity symbol "+" is located on the Tape Light every 3.98 inches. Line up the "+" on the Tape Light sections being joined.

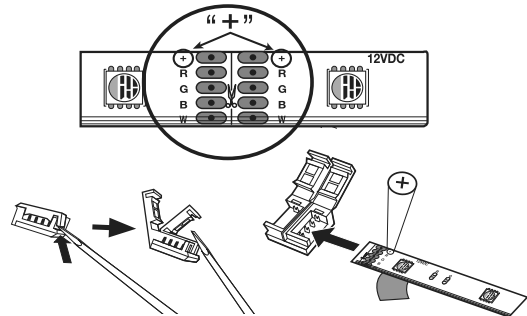

- c. Push the latch down until it locks. Repeat for the other section. The latch contact pins must pierce the Tape Light contact plates to make a good connection. Careful use of pliers (not provided) may be required to fully close and lock the latches.

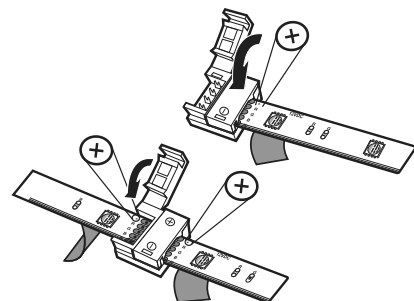

Block Connector

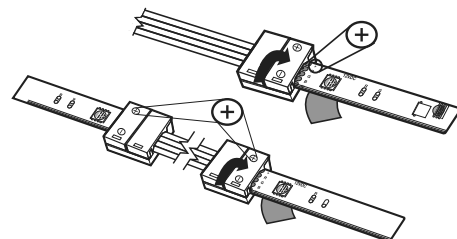

Corner Connector

6. **Mount the Tape Light** by carefully removing the thin paper liner from the adhesive strip on the back of Tape Light. Do not to remove the sticky backing.
7. Carefully place the sticky side of the strip onto the cleaned surface and apply pressure to the entire length to ensue adhesion.

Note: Choose placement carefully. Once the Tape Light has adhered to the surface, it should not be repositioned.

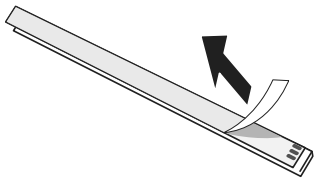

Removing paper liner from Tape Light

8. **Connect the IR Controller** to the Tape Light by lining up the arrows molded into the top of each cable connector and pushing them together.

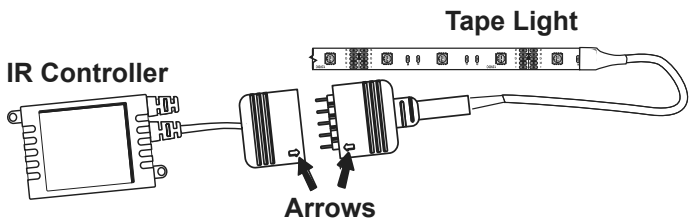

- Note:** If desired, the IR Controller may be mounted using the double-stick foam tape attached to its back. Carefully pull off the thin paper liner to expose the sticky surface and press it to the mounting surface.
9. Once the Tape Light is in place and the IR Controller is connected, **connect the Power Adapter** and plug it into an AC outlet. Be sure the Sensor is exposed.

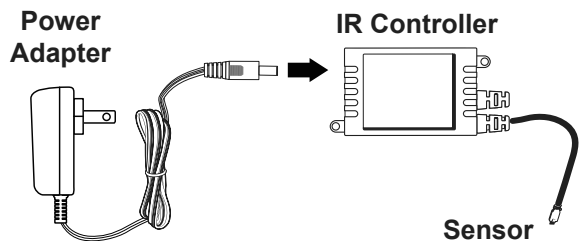

Operation

1. Place batteries into Remote Control:
 - a. Open battery compartment on back side of Remote Control. See *Remote Control Battery Replacement on page 6*.
 - b. Insert new batteries in correct polarity and close compartment. See battery type in *Specifications on page 3*.
2. Point the top of the Remote Control at the IR Controller and turn on the Tape Light by pressing the ON button.

Note: The Remote Control must have a direct line of sight and be within 20 feet of the IR Controller’s Sensor.

3. On the Remote Control, the top section of 24 buttons control the intensity of **Color** output. To adjust color, press the ON button in the “Color” section and press the desired color button. Hold down the Dim/ Brighten button until reaching the desired intensity.
4. The middle section of 8 buttons control the brightness of the **White light** output. To adjust, press the ON button in the “White” section and press one of the % buttons or hold the Brighten/ Dim button until reaching the desired brightness.

Note: When the “White” section is turned ON, the “Effects” section is deactivated.

5. The bottom section of 8 buttons control the **Effects** of cycling through color changes with varying degrees of fading or jumping from one color to the next. To use, press the action button desired.
 - a. Jump 3: Lights flash on/off while cycling through the three main colors (red, green blue).
 - b. Fade 3: Lights fade in/out while cycling through the three main colors (red, green blue).

- c. Jump 7: Lights flash on/off while cycling through seven colors.
 - d. Fade 7: Lights fade in/out while cycling through seven colors.
 - e. Flash: Lights flash on/off while cycling through the three main colors, then seven colors, and then the cycle restarts.
 - f. Auto: Lights flash on/off, then fade in/out though the three main colors, then seven colors, and then the cycle restarts.
 - g. Quick, Slow: Press and hold to adjust the speed of the flash and fade.
6. Turn off the Tape Light by pressing the OFF button.

Remote Control

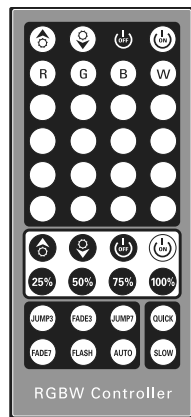

Color		Brighten		Red
		Dim		Green
		Off		Blue
		On		White
White		25% 25% Brightness		
		50% 50% Brightness		
		75% 75% Brightness		
		100% 100% Brightness		
Effects		Jump 3		Flash
		Fade 3		Auto
		Jump 7		Quick
		Fade 7		Slow

Maintenance and Servicing Instructions



Procedures not specifically explained in this manual must be performed only by a qualified technician.

!WARNING

TO PREVENT SERIOUS INJURY FROM TOOL FAILURE:

Do not use damaged equipment. If abnormal noise or vibration occurs, have the problem corrected before further use.

Cleaning, Maintenance, and Lubrication

1. **BEFORE EACH USE**, inspect the general condition of the tool. Check for:
 - loose hardware,
 - misalignment or binding of moving parts,
 - damaged cord/electrical wiring,
 - cracked or broken parts, and
 - any other condition that may affect its safe operation.
2. **PERIODICALLY**, clean Tape Light and Remote Control using a mild, nonabrasive cleaner and clean soft cloth. Disconnect Power Adapter when cleaning and do not spray cleaner directly on LEDs or buttons.

Remote Control Battery Replacement

1. Press Tab in and open battery compartment.
2. Remove batteries and dispose of properly.
3. Insert new batteries in correct polarity and close compartment.

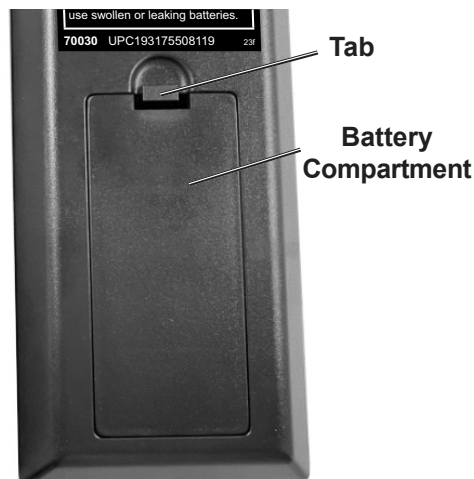

Troubleshooting

Problem	Possible Causes	Likely Solutions
Lights won't turn on.	<ol style="list-style-type: none">1. Power is not on.2. Cable connections are loose.	<ol style="list-style-type: none">1. Check that power switch is set to ON and batteries in the correct polarity are in the Remote Control. The Remote Control must have a direct line of sight and be within 20 feet of the IR Controller's Sensor.2. Firmly plug in Power Adapter and Tape Light cables into the IR Controller.
 Follow all safety precautions whenever diagnosing or servicing the tool. Disconnect power supply before service.		

PLEASE READ THE FOLLOWING CAREFULLY

THE MANUFACTURER AND/OR DISTRIBUTOR HAS PROVIDED THE PARTS LIST AND ASSEMBLY DIAGRAM IN THIS MANUAL AS A REFERENCE TOOL ONLY. NEITHER THE MANUFACTURER OR DISTRIBUTOR MAKES ANY REPRESENTATION OR WARRANTY OF ANY KIND TO THE BUYER THAT HE OR SHE IS QUALIFIED TO MAKE ANY REPAIRS TO THE PRODUCT, OR THAT HE OR SHE IS QUALIFIED TO REPLACE ANY PARTS OF THE PRODUCT. IN FACT, THE MANUFACTURER AND/OR DISTRIBUTOR EXPRESSLY STATES THAT ALL REPAIRS AND PARTS REPLACEMENTS SHOULD BE UNDERTAKEN BY CERTIFIED AND LICENSED TECHNICIANS, AND NOT BY THE BUYER. THE BUYER ASSUMES ALL RISK AND LIABILITY ARISING OUT OF HIS OR HER REPAIRS TO THE ORIGINAL PRODUCT OR REPLACEMENT PARTS THERETO, OR ARISING OUT OF HIS OR HER INSTALLATION OF REPLACEMENT PARTS THERETO.

Parts List and Diagram

Part	Description	Qty
1	Tape Light	1
2	Power Adapter	1
3	IR Controller	1

Part	Description	Qty
4	Remote Control	1
5	Block Connector	3
6	Corner Connector	3

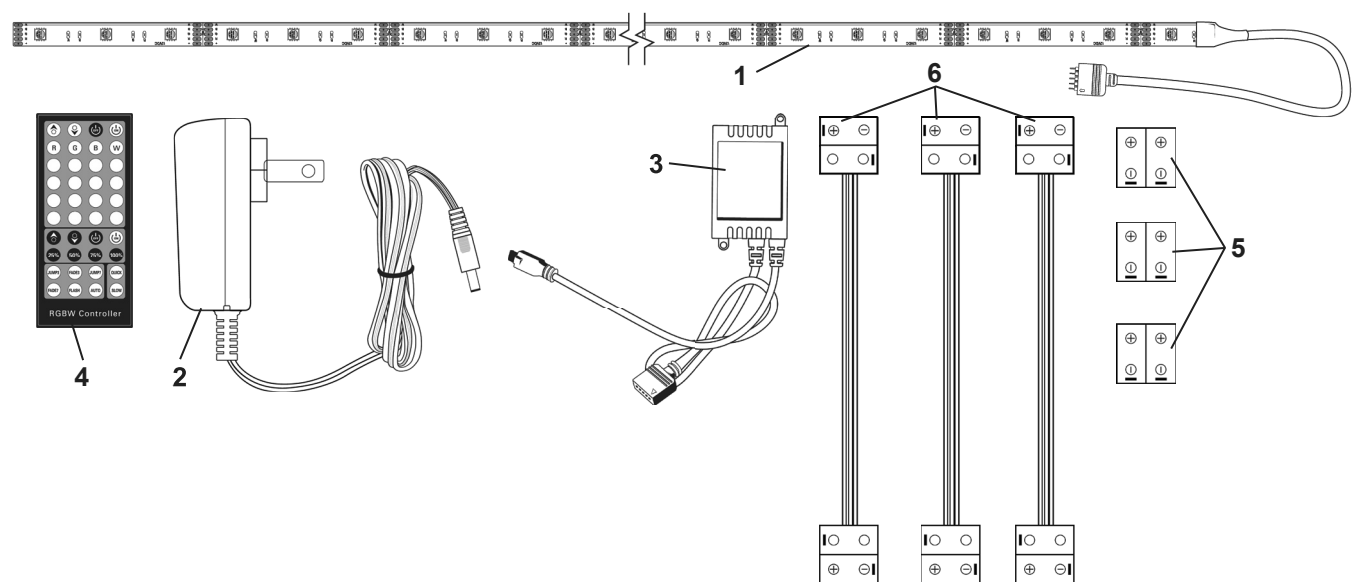

Record Product's Serial Number Here: _____

Note: If product has no serial number, record month and year of purchase instead.

Note: Some parts are listed and shown for illustration purposes only, and are not available individually as replacement parts. Reference UPC 193175508119.

Limited 90 Day Warranty

Harbor Freight Tools Co. makes every effort to assure that its products meet high quality and durability standards, and warrants to the original purchaser that this product is free from defects in materials and workmanship for the period of 90 days from the date of purchase. This warranty does not apply to damage due directly or indirectly, to misuse, abuse, negligence or accidents, repairs or alterations outside our facilities, criminal activity, improper installation, normal wear and tear, or to lack of maintenance. We shall in no event be liable for death, injuries to persons or property, or for incidental, contingent, special or consequential damages arising from the use of our product. Some states do not allow the exclusion or limitation of incidental or consequential damages, so the above limitation of exclusion may not apply to you. THIS WARRANTY IS EXPRESSLY IN LIEU OF ALL OTHER WARRANTIES, EXPRESS OR IMPLIED, INCLUDING THE WARRANTIES OF MERCHANTABILITY AND FITNESS.

To take advantage of this warranty, the product or part must be returned to us with transportation charges prepaid. Proof of purchase date and an explanation of the complaint must accompany the merchandise. If our inspection verifies the defect, we will either repair or replace the product at our election or we may elect to refund the purchase price if we cannot readily and quickly provide you with a replacement. We will return repaired products at our expense, but if we determine there is no defect, or that the defect resulted from causes not within the scope of our warranty, then you must bear the cost of returning the product.

This warranty gives you specific legal rights and you may also have other rights which vary from state to state.



26677 Agoura Road • Calabasas, CA 91302 • 1-888-866-5797