

# Owner's Manual & Safety Instructions

**Save This Manual** Keep this manual for the safety warnings and precautions, assembly, operating, inspection, maintenance and cleaning procedures. Write the product's serial number in the back of the manual near the assembly diagram (or month and year of purchase if product has no number). Keep this manual and the receipt in a safe and dry place for future reference.

24h

# **Bauer**

**2421E-B**

## **6" BENCHTOP JOINTER**



Visit our website at: <https://www.harborfreight.com>  
Email our technical support at: [productsupport@harborfreight.com](mailto:productsupport@harborfreight.com)

**70303**

When unpacking, make sure that the product is intact and undamaged. If any parts are missing or broken, please call 1-888-866-5797 as soon as possible.

Copyright© 2023 by Harbor Freight Tools®. All rights reserved.  
No portion of this manual or any artwork contained herein may be reproduced in any shape or form without the express written consent of Harbor Freight Tools. Diagrams within this manual may not be drawn proportionally. Due to continuing improvements, actual product may differ slightly from the product described herein. Tools required for assembly and service may not be included.

### **⚠ WARNING**

**Read this material before using this product.  
Failure to do so can result in serious injury.  
SAVE THIS MANUAL.**

# Table of Contents

Safety .....	2	Maintenance .....	12
Specifications .....	6	Parts List and Diagram .....	17
Setup .....	6	Warranty .....	20
Operation .....	9		



## WARNING SYMBOLS AND DEFINITIONS

	This is the safety alert symbol. It is used to alert you to potential personal injury hazards. Obey all safety messages that follow this symbol to avoid possible injury or death.
	Indicates a hazardous situation which, if not avoided, will result in death or serious injury.
	Indicates a hazardous situation which, if not avoided, could result in death or serious injury.
	Indicates a hazardous situation which, if not avoided, could result in minor or moderate injury.
	Addresses practices not related to personal injury.

## IMPORTANT SAFETY INFORMATION

### General Tool Safety Warnings

#### WARNING

**Read all safety warnings and instructions.**

*Failure to follow the warnings and instructions may result in electric shock, fire and/or serious injury.*

**Save all warnings and instructions for future reference.**

1. KEEP GUARDS IN PLACE and in working order.
2. REMOVE ADJUSTING KEYS AND WRENCHES. Form habit of checking to see that keys and adjusting wrenches are removed from tool before turning it on.
3. KEEP WORK AREA CLEAN. Cluttered areas and benches invite accidents.
4. DON'T USE IN DANGEROUS ENVIRONMENT. Don't use power tools in damp or wet locations, or expose them to rain. Keep work area well lighted.
5. KEEP CHILDREN AWAY. All visitors should be kept safe distance from work area.
6. MAKE WORKSHOP KID PROOF with padlocks, master switches, or by removing starter keys.
7. DON'T FORCE TOOL. It will do the job better and safer at the rate for which it was designed.
8. USE RIGHT TOOL. Don't force tool or attachment to do a job for which it was not designed.

**Table A: RECOMMENDED MINIMUM WIRE GAUGE  
FOR EXTENSION CORDS  
(120 VOLT)**

NAMEPLATE AMPERES (at full load)	EXTENSION CORD LENGTH			
	25'	50'	100'	150'
0 – 6	18	16	16	14
6.1 – 10	18	16	14	12
10.1 – 12	16	16	14	12
12.1 – 16	14	12	<b>Do not use.</b>	

9. **USE PROPER EXTENSION CORD.** Make sure your extension cord is in good condition. When using an extension cord, be sure to use one heavy enough to carry the current your product will draw. An undersized cord will cause a drop in line voltage resulting in loss of power and overheating. Table A shows the correct size to use depending on cord length and nameplate ampere rating. If in doubt, use the next heavier gauge. The smaller the gauge number, the heavier the cord.
10. **WEAR PROPER APPAREL.** Do not wear loose clothing, gloves, neckties, rings, bracelets, or other jewelry which may get caught in moving parts. Nonslip footwear is recommended. Wear protective hair covering to contain long hair.
11. **ALWAYS USE SAFETY GLASSES.** Also use face or dust mask if cutting operation is dusty. Everyday eyeglasses only have impact resistant lenses, they are NOT safety glasses.
12. **SECURE WORK.** Use clamps or a vise to hold work when practical. It's safer than using your hand and it frees both hands to operate tool.
13. **DON'T OVERREACH.**  
Keep proper footing and balance at all times.
14. **MAINTAIN TOOLS WITH CARE.** Keep tools sharp and clean for best and safest performance. Follow instructions for lubricating and changing accessories.
15. **DISCONNECT TOOLS** before servicing; when changing accessories, such as blades, bits, cutters, and the like.
16. **REDUCE THE RISK OF UNINTENTIONAL STARTING.** Make sure switch is in off position before plugging in.
17. **USE RECOMMENDED ACCESSORIES.**  
Consult the owner's manual for recommended accessories. The use of improper accessories may cause risk of injury to persons.
18. **NEVER STAND ON TOOL.**  
Serious injury could occur if the tool is tipped or if the cutting tool is unintentionally contacted.
19. **CHECK DAMAGED PARTS.** Before further use of the tool, a guard or other part that is damaged should be carefully checked to determine that it will operate properly and perform its intended function – check for alignment of moving parts, binding of moving parts, breakage of parts, mounting, and any other conditions that may affect its operation. A guard or other part that is damaged should be properly repaired or replaced.
20. **DIRECTION OF FEED.**  
Feed work into a blade or cutter against the direction of rotation of the blade or cutter only.
21. **NEVER LEAVE TOOL RUNNING UNATTENDED.**  
**TURN POWER OFF.** Don't leave tool until it comes to a complete stop.

## Grounding Instructions



### ⚠️ WARNING

TO PREVENT ELECTRIC SHOCK AND DEATH FROM INCORRECT GROUNDING WIRE CONNECTION READ AND FOLLOW THESE INSTRUCTIONS:

## 110-120 VAC Grounded Tools: Tools with Three Prong Plugs

1. In the event of a malfunction or breakdown, grounding provides a path of least resistance for electric current to reduce the risk of electric shock. This tool is equipped with an electric cord having an equipment-grounding conductor and a grounding plug. The plug must be plugged into a matching outlet that is properly installed and grounded in accordance with all local codes and ordinances.
2. Do not modify the plug provided – if it will not fit the outlet, have the proper outlet installed by a qualified electrician.
3. Improper connection of the equipment-grounding conductor can result in a risk of electric shock. The conductor with insulation having an outer surface that is green with or without yellow stripes is the equipment-grounding conductor. If repair or replacement of the electric cord or plug is necessary, do not connect the equipment-grounding conductor to a live terminal.
4. Check with a qualified electrician or service personnel if the grounding instructions are not completely understood, or if in doubt as to whether the tool is properly grounded.
5. Use only 3-wire extension cords that have 3-prong grounding plugs and 3-pole receptacles that accept the tool's plug.

6. Repair or replace damaged or worn cord immediately.

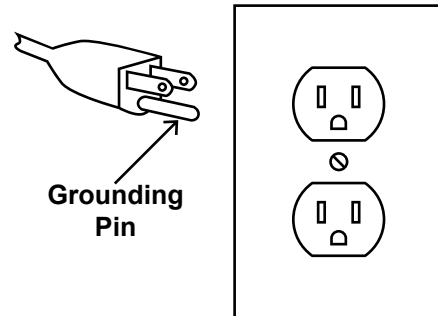

**125 VAC 3-Prong Plug and Outlet  
(for up to 125 VAC and up to 15 A)**

7. This tool is intended for use on a circuit that has an outlet that looks like the one illustrated above in **125 VAC 3-Prong Plug and Outlet**. The tool has a grounding plug that looks like the plug illustrated above in **125 VAC 3-Prong Plug and Outlet**.
8. The outlet must be properly installed and grounded in accordance with all codes and ordinances.
9. Do not use an adapter to connect this tool to a different outlet.

## Jointer Safety Warnings

### For Your Own Safety Read Instruction Manual Before Operating Jointer

1. Wear eye protection.
2. Always keep cutter head and drive guards in place and in proper operating condition.
3. Never make jointing or planing cut deeper than 1/8 in.
4. Always use hold-down/push blocks for jointing material narrower than 3 inches, or planing material thinner than 3 inches.
5. Never perform jointing or planing cuts on pieces shorter than 8 inches (203 mm) in length.
6. Do not perform jointing operations on material shorter than 8 in, narrower than 3/4 in, or less than 1/4 in thick.

**Note:** A jointing cut is a cut made to assist in joining two pieces of wood.

7. Do not perform planing operations on material shorter than 8 in, narrower than 3/4 in, or wider than 6 in or thinner than 1/2 in.

**Note:** A planing cut is a cut made to smooth out defects in the wood's surface.

8. Maintain the proper relationships of infeed and outfeed table surfaces and cutter head knife path.
9. Support the workpiece adequately at all times during operation; maintain control of the work at all times.
10. Do not back the work toward the infeed table.

11. Do not attempt to perform an abnormal or little-used operation without study and the use of adequate hold-down/push blocks, jigs, fixtures, stops, and the like.
12. **DO NOT OPERATE WITH ANY GUARD DISABLED, DAMAGED, OR REMOVED. Moving guards must move freely and close instantly.**
13. The use of accessories or attachments not recommended by the manufacturer may result in a risk of injury to persons.
14. When servicing use only identical replacement parts.
15. Remove the Safety Key after each use. Store the Safety Key separate from the tool and out of children's reach.
16. Only use safety equipment that has been approved by an appropriate standards agency. Unapproved safety equipment may not provide adequate protection. Eye protection must be ANSI-approved and breathing protection must be NIOSH-approved for the specific hazards in the work area.
17. Stay alert, watch what you are doing and use common sense when operating a power tool. Do not use a power tool while you are tired or under the influence of drugs, alcohol or medication. A moment of inattention while operating power tools may result in serious personal injury.
18. Industrial applications must follow OSHA guidelines.
19. Maintain labels and nameplates on the tool. These carry important safety information. If unreadable or missing, contact Harbor Freight Tools for a replacement.
20. Avoid unintentional starting. Prepare to begin work before turning on the tool.
21. People with pacemakers should consult their physician(s) before use. Electromagnetic fields in close proximity to heart pacemaker could cause pacemaker interference or pacemaker failure.
22. The warnings, precautions, and instructions discussed in this instruction manual cannot cover all possible conditions and situations that may occur. It must be understood by the operator that common sense and caution are factors which cannot be built into this product, but must be supplied by the operator.

## Vibration Safety

This tool vibrates during use. Repeated or long-term exposure to vibration may cause temporary or permanent physical injury, particularly to the hands, arms and shoulders. To reduce the risk of vibration-related injury:

1. Anyone using vibrating tools regularly or for an extended period should first be examined by a doctor and then have regular medical check-ups to ensure medical problems are not being caused or worsened from use. Pregnant women or people who have impaired blood circulation to the hand, past hand injuries, nervous system disorders, diabetes, or Raynaud's Disease should not use this tool. If you feel any medical or physical symptoms related to vibration (such as tingling, numbness, and white or blue fingers), seek medical advice as soon as possible.
2. Do not smoke during use. Nicotine reduces the blood supply to the hands and fingers, increasing the risk of vibration-related injury.
3. Use tools with the lowest vibration when there is a choice between different processes.
4. Include vibration-free periods each day of work.
5. Grip workpiece as lightly as possible (while still keeping safe control of it). Let the tool do the work.
6. To reduce vibration, maintain the tool as explained in this manual. If any abnormal vibration occurs, stop use immediately.



**SAVE THESE INSTRUCTIONS.**

## Specifications

Electrical Rating	120V~ / 60Hz / 12A / Class I
Cutter Head No Load Speed	$n_0$ : 9000/min
Cutter Head Dimensions and Types	6" Wide / 3 Rows of 4 Replaceable Square Inserts
Fence Stops	45°, 90°, 135°
Max. Cutting Depth	1/8"
Max. Cutting Width	6"
Min. Stock Length	10"
Min. Stock Width	3/4"
Min. Stock Thickness	1/2"
Min. Dust Collection Requirements	100 CFM, Ø2-1/2" OD Dust Port

## Setup - Before Use:



Read the **ENTIRE IMPORTANT SAFETY INFORMATION** section at the beginning of this manual including all text under subheadings therein before set up or use of this product.

### ⚠ WARNING

**TO PREVENT SERIOUS INJURY FROM ACCIDENTAL OPERATION:**

Turn the **Power Switch** of the tool off, remove the **Safety Key**, and unplug the tool from its electrical outlet before performing any procedure in this section.

**Note:** For additional information regarding the parts listed in the following pages, refer to the Assembly Diagram near the end of this manual.

## Assembly/Mounting

1. Assemble Handles to Infeed/Outfeed Tables with M8x30 Cap Screw Assemblies using 6mm Hex Wrench.

Infeed/Outfeed  
Table



2. Place Jointer on sturdy bench. Jointer can be mounted to bench using four Mounting Holes in base and appropriate hardware (sold separately).

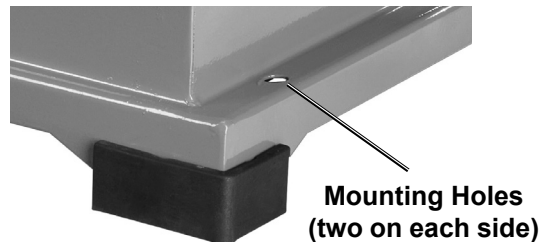

3. Assemble Carriage Support to back of Jointer with M8x20 Cap Screw Assemblies using 6mm Hex Wrench.

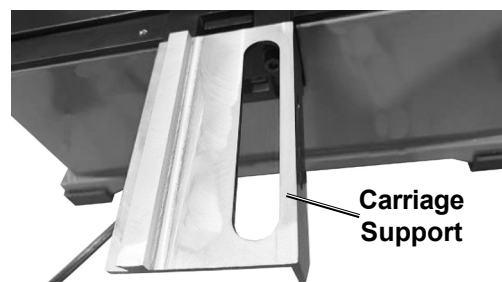

4. Assemble Fence Tilt Lock with Beveled Washer to Carriage.

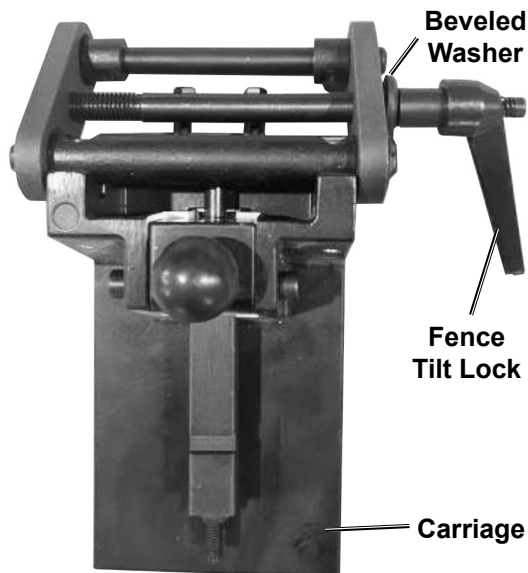

5. Remove M6x20 Cap Screws and Spring Washers from back of Fence with 5mm Hex Wrench.

**Note:** Slight radius in center of Fence will face DOWN towards Infeed/Outfeed Tables when assembled.

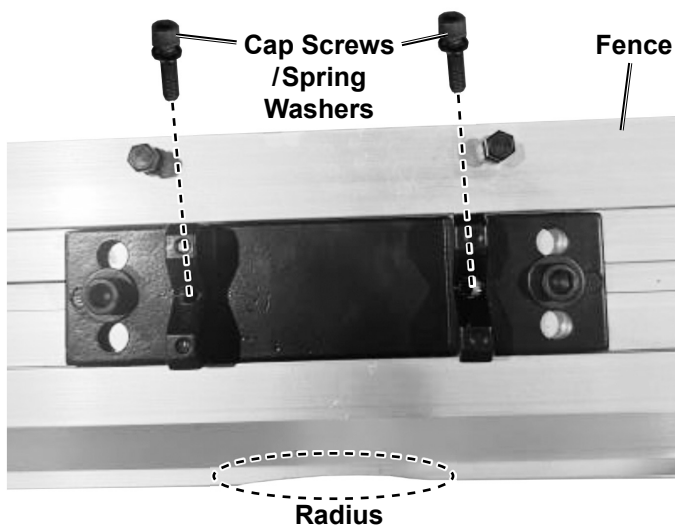

6. Assemble Carriage and Fence assemblies with M6x20 Cap Screws and Spring Washers removed in Step 5.

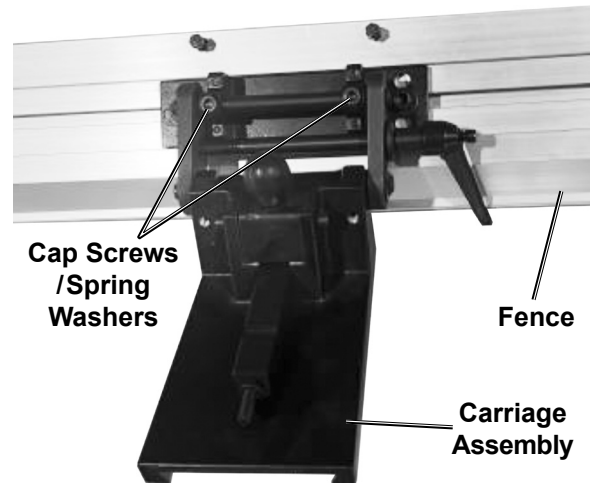

7. Assemble Carriage Assembly and Support:
  - a. Assemble Lock Plate to Carriage Support with Fence Carriage Lock and Beveled Washer, making sure Lock Plate pins are underneath Carriage support edge. Do not tighten Fence Carriage Lock at this time.
  - b. Slide Carriage assembly onto dovetail of Carriage Support and Lock Plate. Tighten Fence Carriage Lock to lock Carriage position.

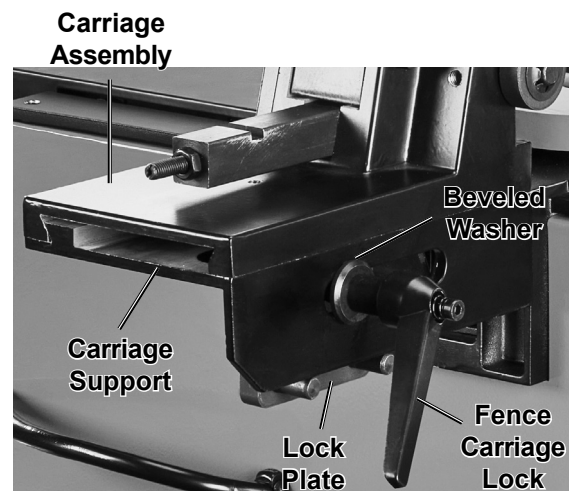

## Dust Collection

Install dust bag or dust collection system (sold separately) to the Dust Port.

Functions

SAFETY

SETUP

OPERATION

MAINTENANCE

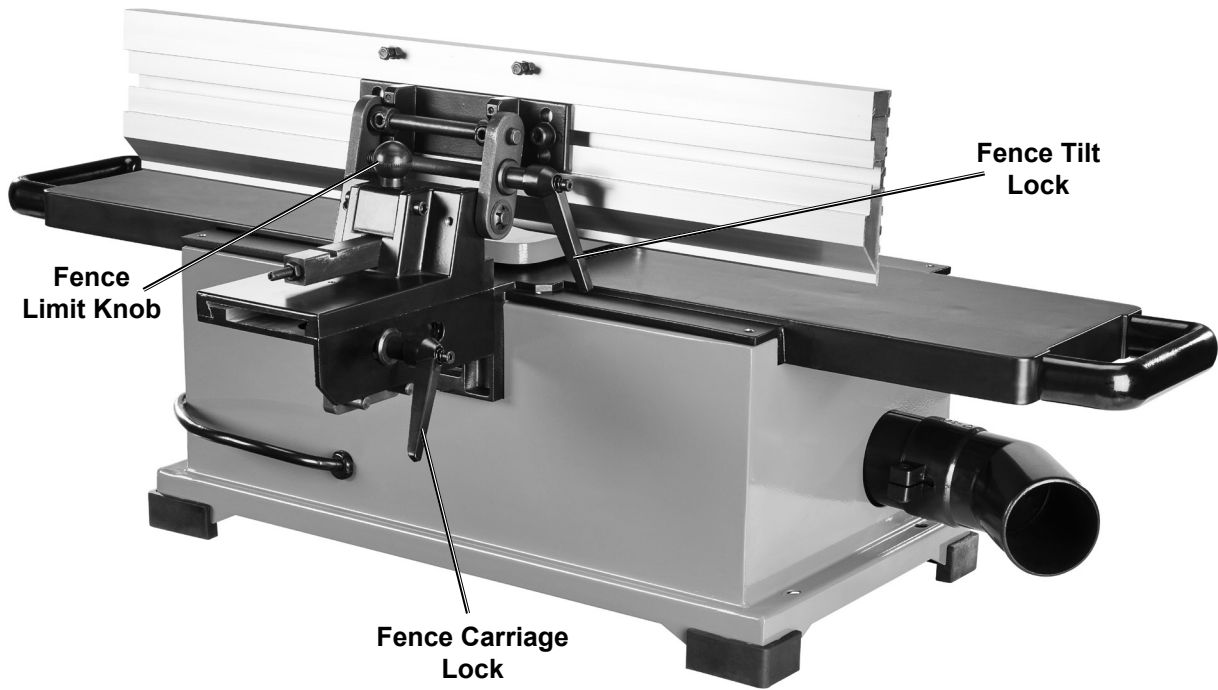
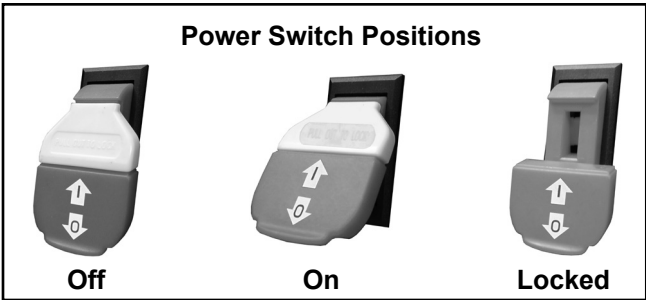
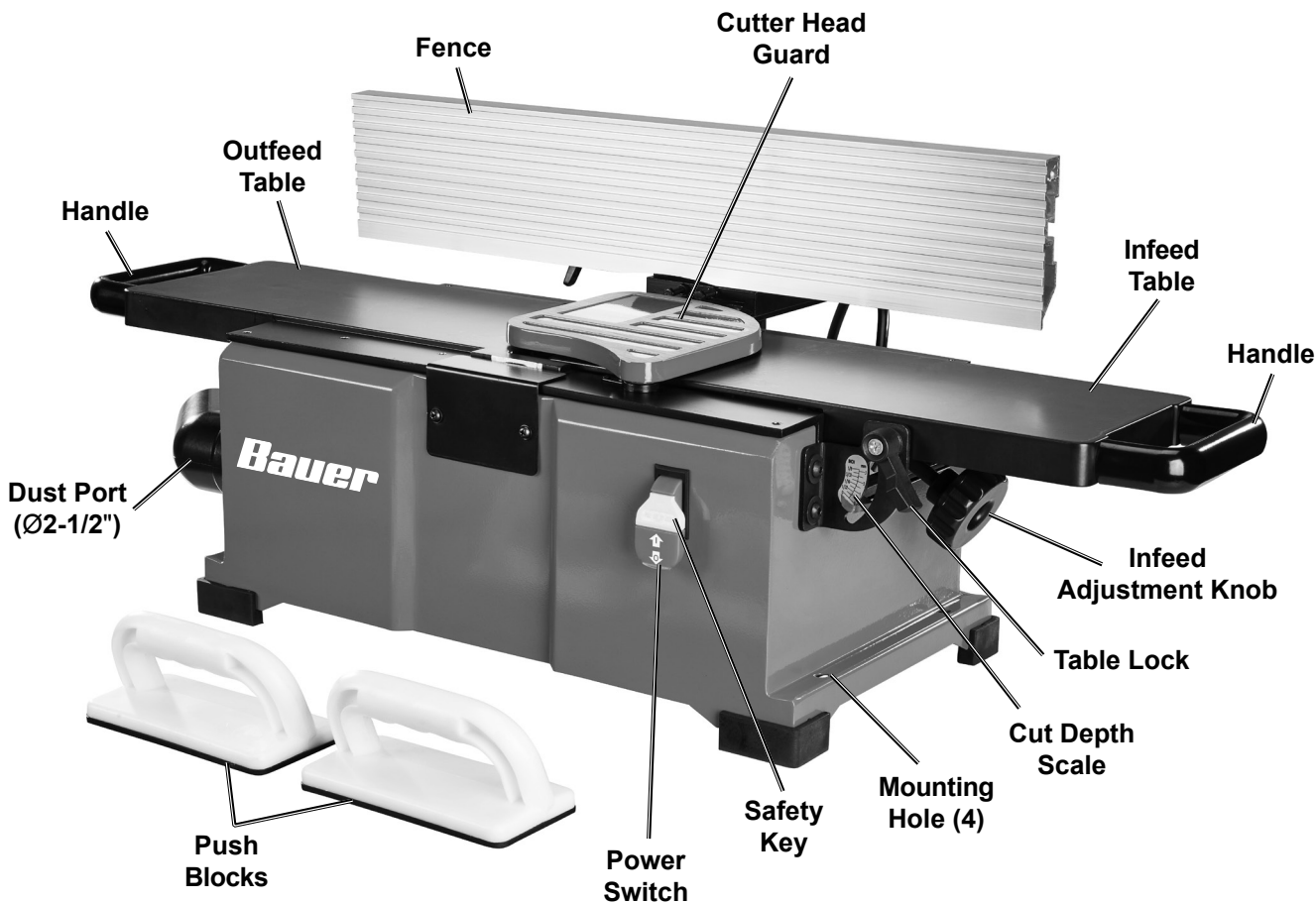



## Operating Instructions



Read the **ENTIRE IMPORTANT SAFETY INFORMATION** section at the beginning of this manual including all text under subheadings therein before set up or use of this product.

## Tool Set Up

### **⚠ WARNING**

**TO PREVENT SERIOUS INJURY FROM ACCIDENTAL OPERATION:**

Turn the Power Switch of the tool off, remove the Safety Key, and unplug the tool from its electrical outlet before performing any procedure in this section.

**TO PREVENT SERIOUS INJURY:**

**DO NOT OPERATE WITH ANY GUARD DISABLED, DAMAGED, OR REMOVED.**

Moving guards must move freely and close instantly.

## Workpiece and Work Area Set Up

1. Designate a work area that is clean and well-lit. The work area must not allow access by children or pets to prevent distraction and injury.
2. Route the power cord along a safe route to reach the work area without creating a tripping hazard or exposing the power cord to possible damage. The power cord must reach the work area with enough extra length to allow free movement while working.
3. There must not be objects, such as utility lines, nearby that will present a hazard while working.

## Setting Cut Depth

1. Loosen Table Lock.
2. Turn Infeed Adjustment Knob to raise or lower Infeed Table to desired cut depth.
3. Tighten Table Lock.

**Note:** Use Depth Adjustment Scale as a reference to indicate cut depth.

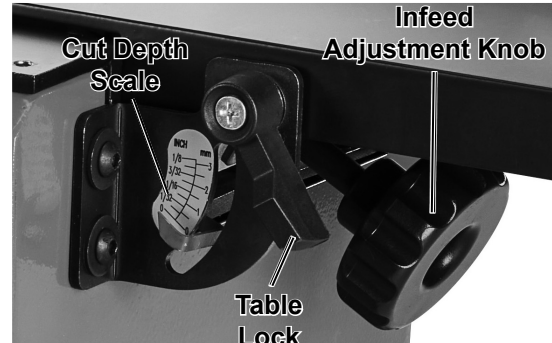

## Setting Zero Stop

Use the Zero Stop to consistently raise Infeed Table to same height as Outfeed Table.

1. Loosen Nut on Zero Stop Set Screw (located above Infeed Adjustment Knob) with 10mm wrench (sold separately).
2. Adjust Zero Stop Set Screw with 3mm hex wrench (sold separately) so it does not contact Infeed Table.
3. Loosen Table Lock, Place straightedge (sold separately) on top of Outfeed/Infeed tables. Adjust Infeed Table height until both have even contact.
4. Adjust Zero Stop Set Screw until it contacts Infeed Table, then tighten Nut.

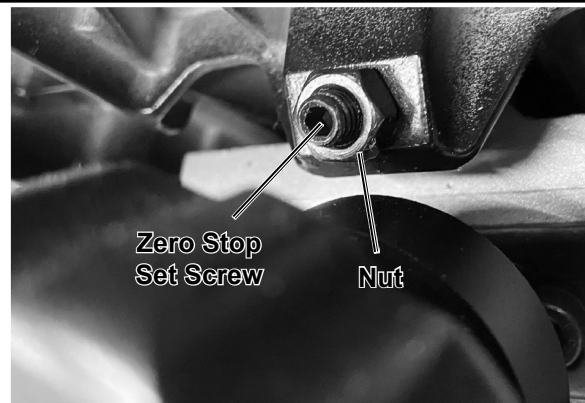

# Setting Fence Stops

Use a combination square (sold separately) to set Fence stops.

## Setting 90° Fence stop:

1. Loosen Fence Tilt Lock.
  2. Lift Fence Limit Knob, slide Limit Block in, release Knob to lock in last slot (illustration shows first slot locked).
- Note:** Limit Block is only used for positioning Fence for 90° cuts.
3. Tighten Fence Tilt Lock. Use square to confirm Fence is 90° to Infeed/Outfeed Tables.
  4. **If Fence is NOT 90° to Infeed/Outfeed Tables:**
    - a. Loosen Fence Tilt Lock and Nut. Keep Limit Block first slot locked.
    - b. Use square to adjust Fence 90° to Infeed/Outfeed Tables. Tighten Fence Tilt Lock.

- c. Turn Limit Block Shaft until it contacts Fence; tighten Nut.

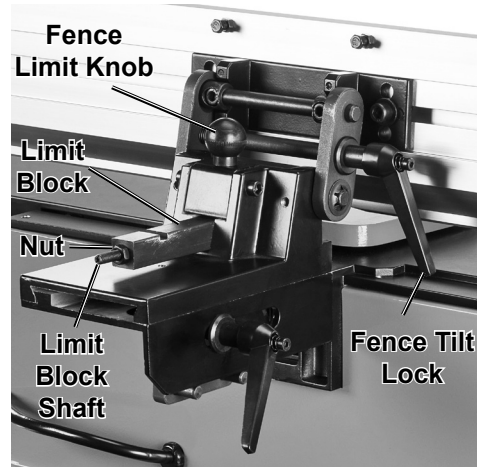

## Setting 45° Fence stop:

1. Lift Fence Limit Knob, slide Limit Block out and release Knob to lock in first slot.
- Note:** Limit Block is not used for positioning Fence for angled cuts.
2. Loosen Fence Tilt Lock; tilt top of Fence down towards Infeed/Outfeed Tables.
  3. Use square to confirm Fence is 45° to Infeed/Outfeed Tables.
  4. **If Fence is NOT 45° to Infeed/Outfeed Tables:**
    - a. Use square to adjust Fence 45° to Infeed/Outfeed Tables. Tighten Fence Tilt Lock.
    - b. Loosen Nuts on Inner Stop Bolts. Adjust Stop Bolts to touch Fence. Tighten Nuts.

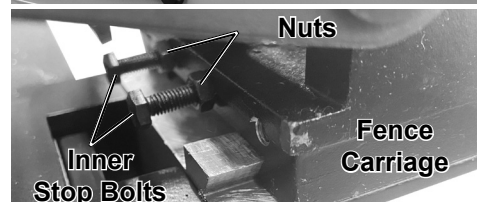
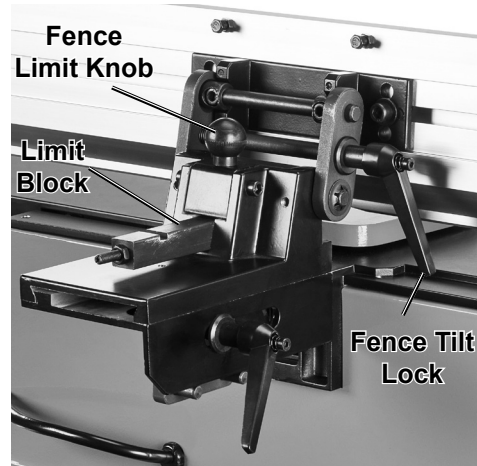

## Setting 135° Fence stop:

1. Lift Fence Limit Knob, slide Limit Block out and release Knob to lock in first slot.
- Note:** Limit Block is not used for positioning Fence for angled cuts.
2. Loosen Fence Tilt Lock; tilt top of Fence down away from Infeed/Outfeed Tables.
  3. Use square to confirm Fence is 135° to Infeed/Outfeed Tables.
  4. **If Fence is NOT 135° to Infeed/Outfeed Tables:**
    - a. Use square to adjust Fence 135° to Infeed/Outfeed Tables. Tighten Fence Tilt Lock.
    - b. Loosen Nuts on Outer Stop Bolts. Adjust Stop Bolts to touch Fence Pivot assembly. Tighten Nuts.

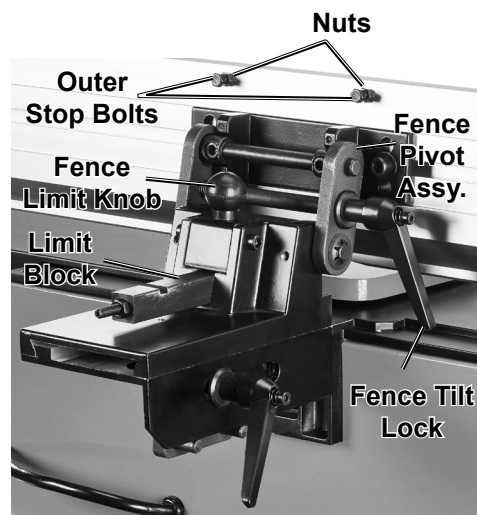

# General Operating Instructions

**Note:** Practice on scrap material until familiar with Jointer's capabilities.

**CAUTION!** Concave workpiece sides must face Table and Fence for stability when cutting.

**WARNING! TO PREVENT INJURY:** Do not use blunt or damaged Cutter Head Inserts.

Keep hands at least 4" away from Cutter Head.

**WARNING! TO PREVENT SERIOUS INJURY FROM KICKBACK:** Do not turn Jointer on with workpiece contacting Cutter Head.

Do not exceed a cut depth of 1/8".

Stand on side nearest the switch and to the side.

1. Adjust Infeed Table to desired cut depth.
2. Adjust Fence:
  - a. **Edge Jointing:** Slide Limit Block in, release Knob to lock in last slot to adjust Fence to 90° position.
  - b. **Bevel Cutting:** Slide Limit Block out and release Knob to lock in first slot and adjust Fence to desired cut angle.
3. Tighten Fence Carriage and Tilt Locks.
4. Make sure that the Power Switch is in the off-position, then plug in the tool.
5. Place workpiece against Fence and Infeed Table.
6. Insert the Safety Key into the Switch. Turn on tool.

7. Use Push Blocks to feed workpiece across Cutter Head, keeping it in firm contact with Fence and Table.



8. Repeat previous step as needed:
  - a. **Edge Jointing:** Repeat previous step as needed until edge is flat.
  - b. **Bevel Cutting:** Repeat previous step as needed to produce satisfactory edge.

**NOTICE:** To prevent damage from clogging, empty dust collection system and clean Cutter Head frequently.

9. To prevent accidents, turn off the tool, remove the Safety Key, and unplug the tool from its electrical outlet after use. Clean, then store the tool indoors out of children's reach. Store the Safety Key separately also out of children's reach.

SAFETY

SETUP

OPERATION

MAINTENANCE

## Maintenance and Servicing



Procedures not specifically explained in this manual must be performed only by a qualified technician.

### **⚠ WARNING**

**TO PREVENT SERIOUS INJURY FROM ACCIDENTAL OPERATION:**

Turn the Power Switch of the tool off, remove the Safety Key, and unplug the tool from its electrical outlet before performing any procedure in this section.

**TO PREVENT SERIOUS INJURY FROM TOOL FAILURE:**

Do not use damaged equipment. If abnormal noise or vibration occurs, have the problem corrected before further use.

## Cleaning, Maintenance, and Lubrication

1. **BEFORE EACH USE**, inspect the general condition of the tool. Check for:
  - loose hardware,
  - misalignment or binding of moving parts,
  - cracked or broken parts,
  - damaged electrical wiring, and
  - any other condition that may affect its safe operation.
2. **AFTER USE**, Wear ANSI-approved safety goggles and NIOSH-approved breathing protection, blow debris from Joints using dry compressed air.
  - a. Remove resin residue with pitch and gum remover.
  - b. Empty dust collection system (if applicable).
  - c. Wipe external surfaces with clean cloth.
  - d. Wax tables with a non-silicone paste wax to prevent staining the wood.

3. **PERIODICALLY**, Lubricate with light machine oil one or two drops as indicated. Wipe off excess.

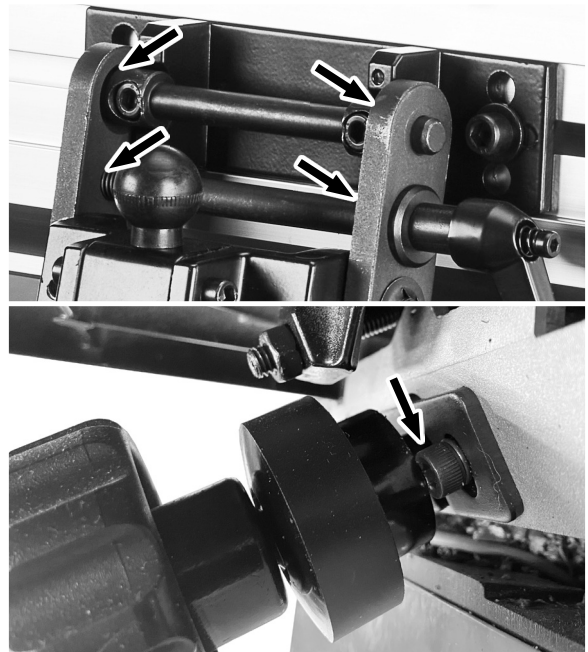

4. **PERIODICALLY**, wear ANSI-approved safety goggles and NIOSH-approved breathing protection and blow dust out of the motor vents using dry compressed air.
5. **⚠ WARNING! TO PREVENT SERIOUS INJURY:** If the supply cord of this power tool is damaged, it must be replaced only by a qualified service technician.

# Cutter Head Insert Rotation/Replacement

**CAUTION!** Wear heavy duty gloves when handling Cutting Inserts.

1. Lower Infeed Table as far as possible.
2. Remove bottom Base Cover.
3. Rotate Cutter Head Guard outward and use a small flat head screwdriver (sold separately) or wood block to hold it in place.
4. Rotate Cutter Head Pulley to rotate Cutter Head and expose Cutting Inserts.
5. Use T25 Torx Wrench to remove Cutting inserts.
6. Clean Cutter Head Inserts, Torx Screws, Cutting Insert pockets, and surrounding areas of saw dust or debris.

**Note:** Debris in the Cutting Insert pockets will raise the Cutting Inserts when installed and produce unsatisfactory results. Wear ANSI-approved safety goggles and NIOSH-approved breathing protection and blow debris out using dry low-pressure compressed air.

7. Lubricate Torx Screws with small amount of light machine oil. Wipe off excess.
8. Re-install Cutting Inserts with a sharp cutting edge facing outward. If all four cutting edges are dull, replace with a new Insert.

**Note:** Cutting Inserts are numbered or have a reference mark on them to allow operator to keep track of how many times the Insert has been rotated.

9. Torque Torx Screws to 48 inch pounds.
10. Replace bottom Base Cover.

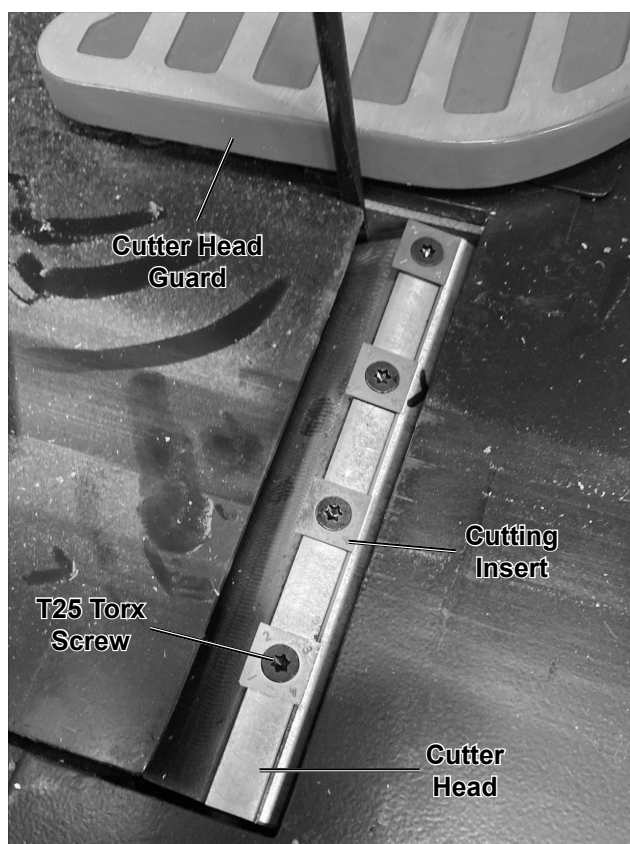

# Troubleshooting

SAFETY

SETUP

OPERATION

MAINTENANCE

Problem	Possible Causes	Likely Solutions
Tool will not start.	<ol style="list-style-type: none"> <li>1. Cord not connected.</li> <li>2. No power at outlet.</li> <li>3. Tool's thermal reset breaker tripped (if equipped).</li> <li>4. Internal damage or wear. (Carbon brushes or switch, for example.)</li> </ol>	<ol style="list-style-type: none"> <li>1. Check that cord is plugged in.</li> <li>2. Check power at outlet. If outlet is unpowered, turn off tool and check circuit breaker. If breaker is tripped, make sure circuit is right capacity for tool and circuit has no other loads.</li> <li>3. Turn off tool and allow to cool. Press reset button on tool.</li> <li>4. Have technician service tool.</li> </ol>
Torn, ragged, rough or raised grain.	<ol style="list-style-type: none"> <li>1. Blades dull or damaged.</li> <li>2. Cut is too heavy.</li> <li>3. Blades cutting against grain.</li> <li>4. Wood has a high moisture content.</li> </ol>	<ol style="list-style-type: none"> <li>1. Replace blades.</li> <li>2. Reduce depth of cut.</li> <li>3. Cut with grain.</li> <li>4. Use dry wood.</li> </ol>
Tool operates slowly.	Extension cord too long or wire size too small.	Eliminate use of extension cord. If an extension cord is needed, use one with the proper diameter for its length and load. See <b>Table A</b> on page 3.
Performance decreases over time.	<ol style="list-style-type: none"> <li>1. Accessory dull or damaged.</li> <li>2. Carbon brushes worn or damaged.</li> </ol>	<ol style="list-style-type: none"> <li>1. Keep cutting accessories sharp. Replace as needed.</li> <li>2. Have qualified technician replace brushes.</li> </ol>
Excessive noise or rattling.	Internal damage or wear. (Carbon brushes or bearings, for example.)	Have technician service tool.
Overheating.	<ol style="list-style-type: none"> <li>1. Forcing machine to work too fast.</li> <li>2. Accessory dull or damaged.</li> <li>3. Blocked motor housing vents.</li> <li>4. Motor being strained by long or small diameter extension cord.</li> </ol>	<ol style="list-style-type: none"> <li>1. Allow machine to work at its own rate.</li> <li>2. Keep cutting accessories sharp. Replace as needed.</li> <li>3. Wear ANSI-approved safety goggles and NIOSH-approved dust mask/respirator while blowing dust out of motor using compressed air.</li> <li>4. Eliminate use of extension cord. If an extension cord is needed, use one with the proper diameter for its length and load. See <b>Table A</b> on page 3.</li> </ol>
Belt Slipping	Loose belt	Replace belt.
Excessive dust in air	Leaking bag or loose connection.	Check connections or replace collection bag.
 <b>Follow all safety precautions whenever diagnosing or servicing the tool. Disconnect power supply and remove the Safety Key before service.</b>		

**Record Product's Serial Number Here:** \_\_\_\_\_

**Note:** If product has no serial number, record month and year of purchase instead.

**Note:** Some parts are listed and shown for illustration purposes only, and are not available individually as replacement parts. Reference UPC 193175495303.

SAFETY

SETUP

OPERATION

MAINTENANCE

## PLEASE READ THE FOLLOWING CAREFULLY

---

### SAFETY

THE MANUFACTURER AND/OR DISTRIBUTOR HAS PROVIDED THE PARTS LIST AND ASSEMBLY DIAGRAM IN THIS MANUAL AS A REFERENCE TOOL ONLY. NEITHER THE MANUFACTURER OR DISTRIBUTOR MAKES ANY REPRESENTATION OR WARRANTY OF ANY KIND TO THE BUYER THAT HE OR SHE IS QUALIFIED TO MAKE ANY REPAIRS TO THE PRODUCT, OR THAT HE OR SHE IS QUALIFIED TO REPLACE ANY PARTS OF THE PRODUCT. IN FACT, THE MANUFACTURER AND/OR DISTRIBUTOR EXPRESSLY STATES THAT ALL REPAIRS AND PARTS REPLACEMENTS SHOULD BE UNDERTAKEN BY CERTIFIED AND LICENSED TECHNICIANS, AND NOT BY THE BUYER. THE BUYER ASSUMES ALL RISK AND LIABILITY ARISING OUT OF HIS OR HER REPAIRS TO THE ORIGINAL PRODUCT OR REPLACEMENT PARTS THERETO, OR ARISING OUT OF HIS OR HER INSTALLATION OF REPLACEMENT PARTS THERETO.

### SETUP

### OPERATION

### MAINTENANCE



## Parts List and Diagram

### Parts List

Part	Description	Qty
1	Outfeed Table	1
2	Fence	1
3	Fence Mounting Bracket	1
4	Right Pivot Bar	1
5	Left Pivot Bar	1
6	Pivot Shaft	1
7	Carriage Shaft	1
8	Fence Limit Knob	1
9	Position Block	1
10	Compression Spring	1
11	Handle	2
12	Limit Block	1
13	Limit Block Shaft	1
14	Carriage	1
15	Fence Tilt Lock	1
16	Carriage Support	1
17	Lock Plate	1
18	Alignment Pin	2
19	Table Pin	4
20	Frame Pin	4
21	Pin Bracket	4
22	Infeed Table	1
23	Table Sub Frame	1
24	Dial Support Plate	1
25	Infeed Adjustment Knob	1
26	Lifting Screw Rod	1
27	Motor	1
28	Motor Pulley	1
29	Motor Mounting Plate	1
30	Cord Clamp	1
31	Cutter Head Guard	1
32	Rubber Stop	1
33	Torsion Spring	1
34	Roll Pin	1
35	M8x20 Cap Screw Assembly	2
36	Cutter Head Assembly	1
36.1	Cutting Insert	15
36.2	Flat Head Torx Screw	15
36.3	Cutter Head	1
36.4	T-Handle T25 Torx Wrench	1
37	Compression Spring	1
38	Inward Stop Bolt	2
39	Cap Screw Assembly	4
40	Cutter Head Pulley	1
41	Nut	2
42	Cable Clamp	1
43	Blower Port	1
44	Blower Impeller	1
45	Exterior Retaining Ring	1
46	Blower Mounting Plate	1
47	Impeller Shaft	1
48	Blower Pulley	1
49	Spacer	1
50	Ball Bearing	2
51	Chip Chute	1
52	Base Cover	1
53	Push Block	1
54	Power Switch/Safety Key	1

Part	Description	Qty
55	Position Shaft	1
56	Cap Screw Assembly	10
57	Spring Washer	9
58	Flat Washer	3
59	Screw	11
60	Flat Washer	2
61	Flat Washer	1
62	Cap Screw	8
63	Screw	1
64	Flat Washer	2
65	Cap Screw	2
66	Cap Screw	4
67	Hex Bolt	2
68	Nut	4
69	Screw	2
70	Nut	3
71	Cap Screw	1
72	V-Belt	1
73	Nut	1
74	Hex Bolt	1
75	Push Nut	2
76	E-Clip	4
77	Front Fixture Seat	1
78	Rear Fixture Seat	1
79	Zero Stop Set Screw	2
80	Set Screw	4
81	Set Screw	2
82	Screw	6
83	Screw	1
84	Exterior Tooth Washer	2
85	Spring Washer	4
86	Retainer Washer	1
87	Ball Bearing	2
88	Strain Relief	1
89	Power Cord	1
90	Belt Pulley Cover	1
91	V-Belt	1
92	Dust Port Assembly	1
92.1	Cross Head Screw	1
92.2	Dust Port Ø2-1/2"	1
93	Flat Washer	9
94	Cut Depth Scale	1
95	Pointer 1	1
96	Pointer 2	1
97	5mm Hex Wrench	1
98	Cap Screw	6
99	Set Screw	2
100	Base	1
101	Switch Mounting Plate	1
102	Rubber Pad-Left	2
103	Rubber Pad-Right	2
104	Guard Plate	1
105	Cap Screw Assembly	3
106	Taping Screw	6
107	6mm Hex Wrench	1
108	M8x30 Cap Screw Assembly	4
109	Beveled Washer	2
110	Sponge Gasket	1

SAFETY

SETUP

OPERATION

MAINTENANCE

Part	Description	Qty
111	Table Locking Screw	1
112	Fence Carriage Lock	1
113	Table Lock	1
114	Brush	1
115	Screw	1

Part	Description	Qty
116	Anti Slip Washer	2
117	Cross Head Screw	2
118	Step Screw	1
119	Compression Spring	1
120	Copper Bushing	1

# Assembly Diagram

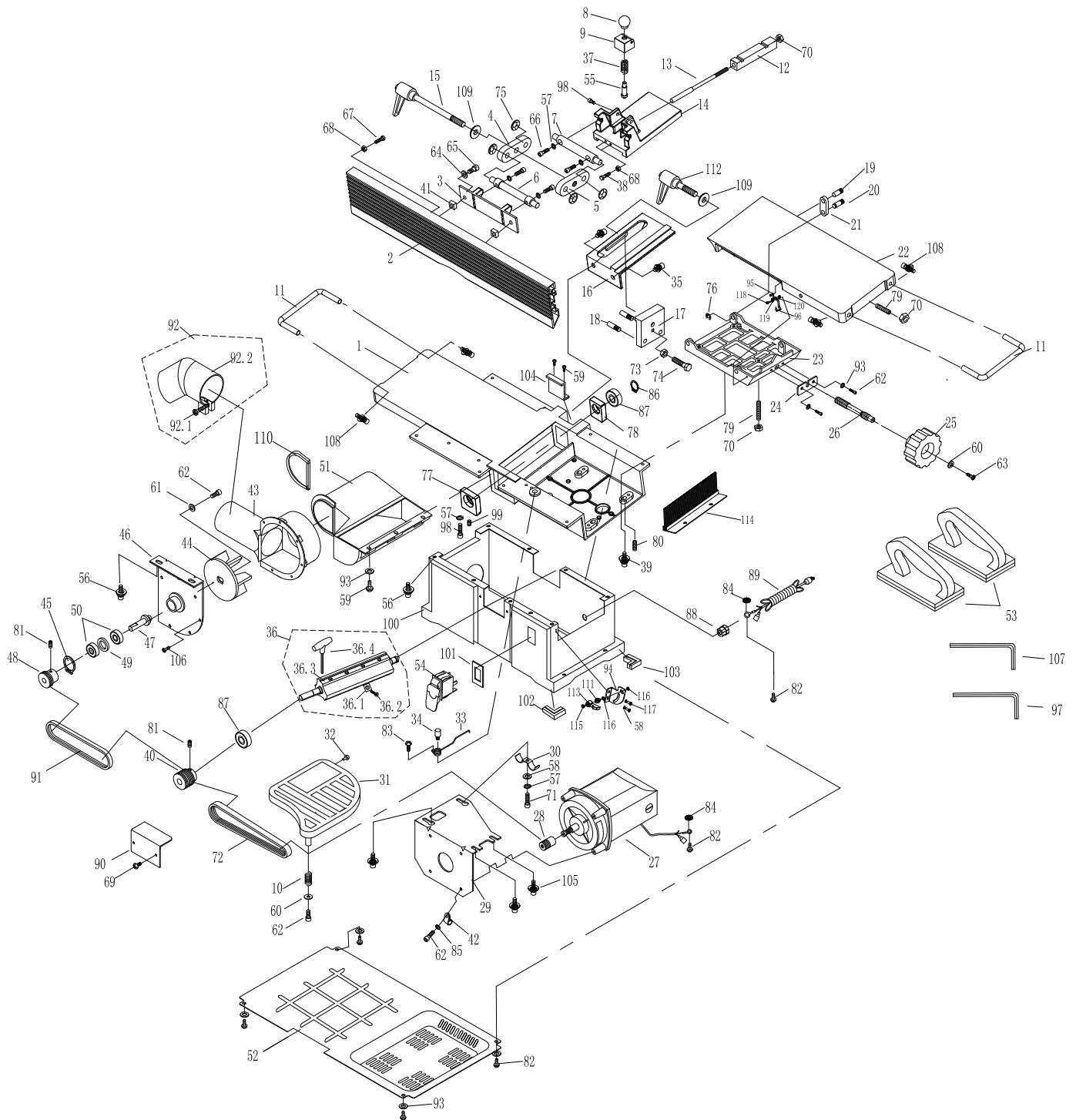

SAFETY

SETUP

OPERATION

MAINTENANCE

## Limited 90 Day Warranty

Harbor Freight Tools Co. makes every effort to assure that its products meet high quality and durability standards, and warrants to the original purchaser that this product is free from defects in materials and workmanship for the period of 90 days from the date of purchase. This warranty does not apply to damage due directly or indirectly, to misuse, abuse, negligence or accidents, repairs or alterations outside our facilities, criminal activity, improper installation, normal wear and tear, or to lack of maintenance. We shall in no event be liable for death, injuries to persons or property, or for incidental, contingent, special or consequential damages arising from the use of our product. Some states do not allow the exclusion or limitation of incidental or consequential damages, so the above limitation of exclusion may not apply to you. THIS WARRANTY IS EXPRESSLY IN LIEU OF ALL OTHER WARRANTIES, EXPRESS OR IMPLIED, INCLUDING THE WARRANTIES OF MERCHANTABILITY AND FITNESS.

To take advantage of this warranty, the product or part must be returned to us with transportation charges prepaid. Proof of purchase date and an explanation of the complaint must accompany the merchandise. If our inspection verifies the defect, we will either repair or replace the product at our election or we may elect to refund the purchase price if we cannot readily and quickly provide you with a replacement. We will return repaired products at our expense, but if we determine there is no defect, or that the defect resulted from causes not within the scope of our warranty, then you must bear the cost of returning the product.

This warranty gives you specific legal rights and you may also have other rights which vary from state to state.

The logo for Bauer, featuring the word "Bauer" in a bold, italicized, sans-serif font. A small trademark symbol (TM) is located at the bottom right of the word.

26677 Agoura Road • Calabasas, CA 91302 • 1-888-866-5797