

# Owner's Manual & Safety Instructions

Save This Manual Keep this manual for the safety warnings and precautions, assembly, operating, inspection, maintenance and cleaning procedures. Write the product's serial number in the back of the manual near the assembly diagram (or month and year of purchase if product has no number). Keep this manual and the receipt in a safe and dry place for future reference.

23e

# **Bauer**<sup>TM</sup>

## **2322A-B**

## **UNIVERSAL LATHE STAND**



Visit our website at: <http://www.harborfreight.com>  
Email our technical support at: [productsupport@harborfreight.com](mailto:productsupport@harborfreight.com)

**70595**

When unpacking, make sure that the product is intact and undamaged. If any parts are missing or broken, please call 1-888-866-5797 as soon as possible.

Copyright© 2023 by Harbor Freight Tools®. All rights reserved.  
No portion of this manual or any artwork contained herein may be reproduced in any shape or form without the express written consent of Harbor Freight Tools. Diagrams within this manual may not be drawn proportionally. Due to continuing improvements, actual product may differ slightly from the product described herein. Tools required for assembly and service may not be included.

### **⚠WARNING**





Read this material before using this product.  
Failure to do so can result in serious injury.  
**SAVE THIS MANUAL.**

## Table of Contents

Safety .....	3	Parts Lists and Diagrams .....	10
Specifications .....	3	Warranty .....	12
Assembly .....	5		

# ***Bauer***<sup>TM</sup>

### WARNING SYMBOLS AND DEFINITIONS

	This is the safety alert symbol. It is used to alert you to potential personal injury hazards. Obey all safety messages that follow this symbol to avoid possible injury or death.
 <b>DANGER</b>	Indicates a hazardous situation which, if not avoided, will result in death or serious injury.
 <b>WARNING</b>	Indicates a hazardous situation which, if not avoided, could result in death or serious injury.
 <b>CAUTION</b>	Indicates a hazardous situation which, if not avoided, could result in minor or moderate injury.
<b>NOTICE</b> <b>CAUTION</b>	Addresses practices not related to personal injury.

## Specifications

Adjustable Height	24 1/2" - 34 1/2"
Adjustable Length	23 1/2" - 35 1/2"
Weight Capacity	225 lb

## Important Safety Information

### Assembly Precautions

---

1. Assemble only according to these instructions. Improper assembly can create hazards.
2. Wear ANSI-approved safety goggles and heavy-duty work gloves during assembly.
3. Keep assembly area clean and well lit.
4. Keep bystanders out of the area during assembly.
5. Do not assemble when tired or when under the influence of alcohol, drugs or medication.
6. Weight capacity and other product capabilities apply to properly and completely assembled product only.

***Bauer***<sup>™</sup>

## Use Precautions

---

1. Wear ANSI-approved safety goggles and heavy-duty work gloves during use.
2. Do not exceed the Lathe Stand's maximum weight capacity of 225 lb.  
**Be aware of dynamic loading!**  
Sudden load movement may briefly create excess load causing product failure.
3. Use the Lathe Stand on a flat, level surface capable of supporting the weight of the Stand, the lathe, and the workpiece.
4. Turn lathe off and disconnect power before attaching lathe to Stand.
5. Follow lathe instructions for mounting and operation.
6. Do not wear loose clothing or jewelry as they can be caught in moving parts. Protective, electrically non-conductive clothes and non-skid footwear are recommended when working. Wear restrictive hair covering to contain long hair.
7. This product is not a toy. Do not allow children to play with or near this item.
8. Use as intended only. Do not use the Lathe Stand to support people or animals.
9. Inspect before every use; do not use if parts are loose or damaged.
10. Maintain product labels and nameplates. These carry important safety information. If unreadable or missing, contact Harbor Freight Tools for a replacement.
11. The warnings, cautions, and instructions discussed in this instruction manual cannot cover all possible conditions and situations that may occur. It must be understood by the operator that common sense and caution are factors which cannot be built into this product, but must be supplied by the operator.

The logo for Bauer, featuring the word "Bauer" in a bold, italicized, sans-serif font. A small trademark symbol (TM) is located at the bottom right of the word.

# Assembly Instructions



Read the **ENTIRE IMPORTANT SAFETY INFORMATION** section at the beginning of this manual including all text under subheadings therein before set up or use of this product.

**Note:** For additional information regarding the parts listed in this manual, refer to the Parts Lists and Diagram near the end of this manual.

## Attaching Feet to Base

1. Install M12 Washer (11), M12 Nut (10), and M12 x 100 Hex Bolt (9) through the top of the Base (12) on each end.
2. Install M12 Large Washer (13), Rubber Foot (14), M12 Washer (11), and Clip (15) onto threaded end of Bolt at each end of Base.
3. Repeat steps 1 and 2 on second Base.

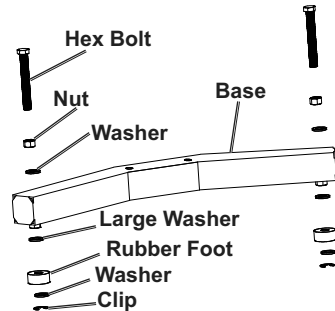

## Attaching Base to Column

1. Attach the Base to the Column (5) using two M10 Washers (2) and two M10 x 80 Hex Bolts (3).
2. Install two M10 Washers and two M10 Nuts to the Bolts to secure the Column in place.
3. Repeat steps 1 and 2 for the second column.

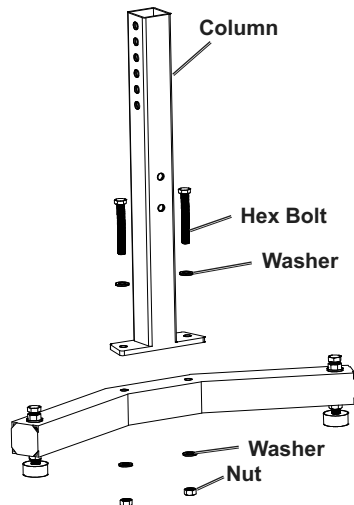

## Attaching Outer Beam to Column

1. Install two M10 Washers and two M10 x 80 Hex Bolts through the flange on the Outer Beam (8) and Column.
2. Install two M10 Washers and two M12 Nuts to the bolts to secure the Outer Beam (8).
3. Repeat steps 1 and 2 to attach the Inner Beam to the other Column assembly.

**Note:** The legs on the Column Base should face outward.

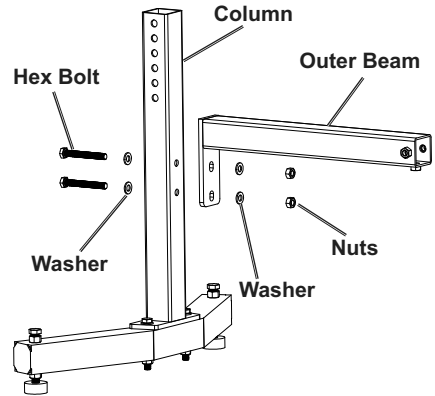

## Attaching Inner and Outer Beams

1. Insert the Inner Beam (6) into the Outer Beam (8).
2. Screw three M10 x 20 Hex Bolts (7) onto the Nuts on the Outer Beam.
4. Install a Mounting Platform (1) to the top of each Column using four M10 Washers, two M10 x 80 Hex Bolts and two Nuts.

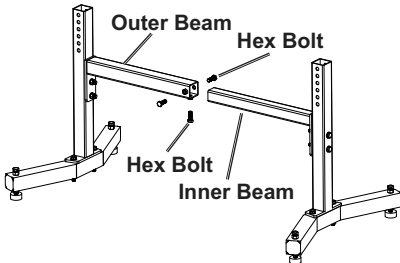

3. Hand tighten the bolts then secure once the length of the Lathe Stand has been determined.

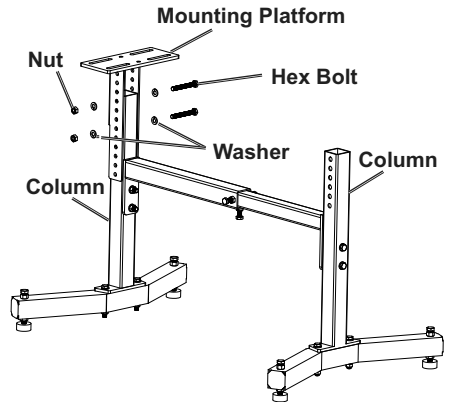

5. Install two M8 Elastic Washers, two M8 Washers (18) and two M10 Nuts (19) to the Bolts through the Mounting Platforms.

6. Hand tighten the nuts until the Lathe height has been determined.

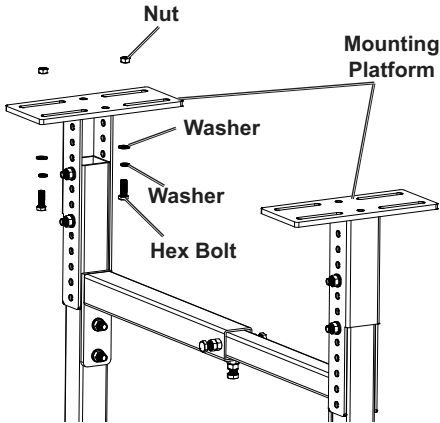

## Determining Proper Lathe Height

---

1. Determine the height of your Lathe by measuring the distance from the base of the Lathe to the point on the live center.
2. With your arm bent at 90°, measure the distance from your elbow to the floor.
3. Subtract the Lathe height measurement from the elbow height measurement. This number represents the approximate height that the mounting platform should be set at on your Lathe Stand.

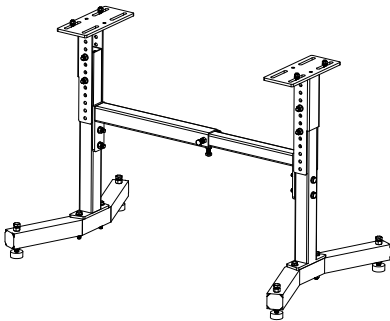

Example: 45" (elbow to floor) - 14.5" (Base to live center = 30.5" Stand height).

# Adjusting

## Adjusting for Lathe Length

---

1. Measure the length of your Lathe from the center of one mounting hole to the center of the other mounting hole.
2. Loosen the two M10 x 20 Hex Bolts on the Outer Beam. Slide the Beam inward or outward to the desired length, measuring from the slots in the right mounting platform to the slots in the left mounting platform.
3. Once the desired length has been set, tighten the two M10 x 20 Hex Bolts to secure the beams.

## Leveling the Lathe Stand

---

1. Loosen the M12 Nut on the Base.
2. Adjust the leveling M12 x 100 Hex Bolt and Foot to the desired height.
3. Tighten the M12 Nut against the Base to lock in place.

## Fastening Lathe to Stand

---

1. Securely mount your Lathe to the Stand using fasteners (not included).
2. Fully tighten all fasteners.



# Maintenance and Servicing

## **⚠ WARNING**

**TO PREVENT SERIOUS INJURY:**

**Disconnect the lathe from the power source before performing any inspection, maintenance, or cleaning on the Lathe Stand.**

**Do not use damaged equipment. If abnormal noise or vibration occurs, turn off the lathe immediately and have the problem corrected before further use.**

## **Inspection, Maintenance, and Cleaning**

---

1. **BEFORE EACH USE**, inspect the general condition of the Lathe Stand. Check for:
  - loose hardware
  - misalignment or binding of parts
  - loose or improper mounting of a tool
  - cracked or broken parts
  - any other condition that may affect its safe operation.
2. To clean, wipe off stand with slightly moist cloth.

# Parts List and Assembly Diagram

Part	Description	Qty
1	Mounting Platform	2
2	Washer M10	24
3	Hex Bolt M10 x 80	12
4	Nut M10	12
5	Column	2
6	Inner Beam	1
7	Hex Bolt M10 x 20	3
8	Outer Beam	1
9	Hex Bolt M12 x 100	4
10	Nut M12	4
11	Washer M12	8

Part	Description	Qty
12	Base	2
13	Large Washer M12	4
14	Rubber Foot	4
15	Clip	4
16	Hex Cap Screws M8 x 25	4
17	Elastic Washer M8	4
18	Washer M8	4
19	Nut M8	4

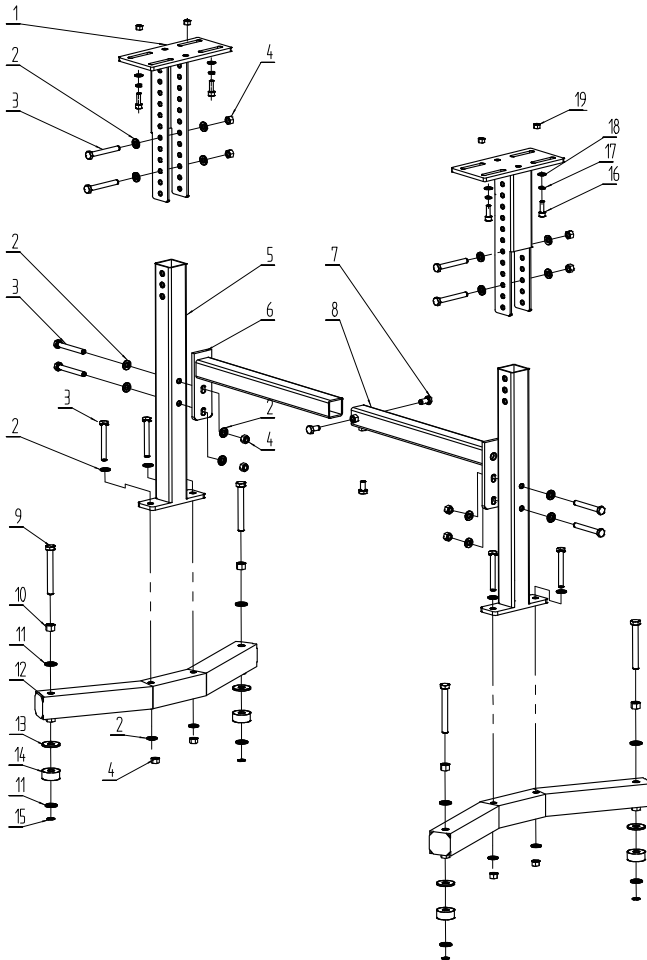

## PLEASE READ THE FOLLOWING CAREFULLY

---

THE MANUFACTURER AND/OR DISTRIBUTOR HAS PROVIDED THE PARTS LIST AND ASSEMBLY DIAGRAM IN THIS DOCUMENT AS A REFERENCE TOOL ONLY. NEITHER THE MANUFACTURER OR DISTRIBUTOR MAKES ANY REPRESENTATION OR WARRANTY OF ANY KIND TO THE BUYER THAT HE OR SHE IS QUALIFIED TO MAKE ANY REPAIRS TO THE PRODUCT, OR THAT HE OR SHE IS QUALIFIED TO REPLACE ANY PARTS OF THE PRODUCT. IN FACT, THE MANUFACTURER AND/OR DISTRIBUTOR EXPRESSLY STATES THAT ALL REPAIRS AND PARTS REPLACEMENTS SHOULD BE UNDERTAKEN BY CERTIFIED AND LICENSED TECHNICIANS, AND NOT BY THE BUYER. THE BUYER ASSUMES ALL RISK AND LIABILITY ARISING OUT OF HIS OR HER REPAIRS TO THE ORIGINAL PRODUCT OR REPLACEMENT PARTS THERETO, OR ARISING OUT OF HIS OR HER INSTALLATION OF REPLACEMENT PARTS THERETO.

**Record Serial Number Here:**

---

**Note:** If product has no serial number, record month and year of purchase instead.

**Note:** Some parts are listed and shown for illustration purposes only, and are not available individually as replacement parts. Specify UPC 193175501240 when ordering parts.

## Limited 90 Day Warranty

Harbor Freight Tools Co. makes every effort to assure that its products meet high quality and durability standards, and warrants to the original purchaser that this product is free from defects in materials and workmanship for the period of 90 days from the date of purchase. This warranty does not apply to damage due directly or indirectly, to misuse, abuse, negligence or accidents, repairs or alterations outside our facilities, criminal activity, improper installation, normal wear and tear, or to lack of maintenance. We shall in no event be liable for death, injuries to persons or property, or for incidental, contingent, special or consequential damages arising from the use of our product. Some states do not allow the exclusion or limitation of incidental or consequential damages, so the above limitation of exclusion may not apply to you. THIS WARRANTY IS EXPRESSLY IN LIEU OF ALL OTHER WARRANTIES, EXPRESS OR IMPLIED, INCLUDING THE WARRANTIES OF MERCHANTABILITY AND FITNESS.

To take advantage of this warranty, the product or part must be returned to us with transportation charges prepaid. Proof of purchase date and an explanation of the complaint must accompany the merchandise. If our inspection verifies the defect, we will either repair or replace the product at our election or we may elect to refund the purchase price if we cannot readily and quickly provide you with a replacement. We will return repaired products at our expense, but if we determine there is no defect, or that the defect resulted from causes not within the scope of our warranty, then you must bear the cost of returning the product.

This warranty gives you specific legal rights and you may also have other rights which vary from state to state.

The logo for Bauer, featuring the word "Bauer" in a bold, italicized, black sans-serif font with a small trademark symbol (TM) at the end.