

Owner's Manual & Safety Instructions

Save This Manual Keep this manual for the safety warnings and precautions, assembly, operating, inspection, maintenance and cleaning procedures. Write the product's serial number in the back of the manual near the assembly diagram (or month and year of purchase if product has no number). Keep this manual and the receipt in a safe and dry place for future reference.

21d



ROLLING WORK SEAT

with Tool Tray



Visit our website at: <http://www.harborfreight.com>
Email our technical support at: productsupport@harborfreight.com

91495

When unpacking, make sure that the product is intact and undamaged. If any parts are missing or broken, please call 1-888-866-5797 as soon as possible.

Copyright© 2021 by Harbor Freight Tools®. All rights reserved.
No portion of this manual or any artwork contained herein may be reproduced in any shape or form without the express written consent of Harbor Freight Tools. Diagrams within this manual may not be drawn proportionally. Due to continuing improvements, actual product may differ slightly from the product described herein. Tools required for assembly and service may not be included.

⚠WARNING

Read this material before using this product.
Failure to do so can result in serious injury.
SAVE THIS MANUAL.

Specifications

Construction	Heavy-Duty Tube/Formed Steel w/Polypropylene Tray
Finish	Green Powder Coated
Wheels	Four 10" Dia. Pneumatic Tires w/ Ball Bearing Wheels - 30 PSI
Seat Type	Bucket /Tractor Type 13-1/4" L x 17" W x 7-1/2" H
Overall Dimension	33" L x 17-1/2" W x 23" H
Tray Dimension	17" L x 15-1/2" W x 3" D
Overall Weight	30 Lbs.
Max. Weight Capacity	300 lb. (seat) 5 lb. (tray)

IMPORTANT SAFETY INFORMATION

Assembly Precautions

1. Assemble only according to these instructions. Improper assembly can create hazards.
2. Wear ANSI-approved safety goggles and heavy-duty work gloves during assembly.
3. Keep assembly area clean and well lit.
4. Keep bystanders out of the area during assembly.
5. Do not assemble when tired or when under the influence of alcohol, drugs or medication.
6. Dress properly. Do not wear loose clothing or jewelry as they can be caught in moving parts. Protective, electrically nonconductive clothes and nonskid footwear are recommended when working with this product. Wear restrictive hair covering to contain long hair.
7. Weight capacity and other product capabilities apply to properly and completely assembled product only.

Use Precautions

1. This product is not a toy. Do not allow children to play with or near this item.
2. Use as intended only.
3. Inspect before every use; do not use if parts are loose or damaged.
4. Do not exceed listed weight capacity. **Be aware of dynamic loading!** Sudden load movement may briefly create excess load causing product failure.
5. Maintain product labels and nameplates. These carry important safety information. If unreadable or missing, contact Harbor Freight Tools for a replacement.

Assembly Instructions



Read the **ENTIRE IMPORTANT SAFETY INFORMATION** section at the beginning of this document including all text under subheadings therein before set up or use of this product.

1. Assemble all parts on a smooth surface to avoid scratching. Sort and identify all parts. Additional tools will be necessary to assemble the Rolling Work Seat. (Tools not included).
2. Matching up all the predrilled holes, attach the Tray Bracket (2) to the Frame (1), the Tray (4) and the Reinforcing Plate (3) using the Screws (14), Small Washers (11), Lock Washers (12), and Small Nuts (15). Tighten hardware.

- Slide both Axles (7) into the Frame (1). Slide the Wheel (9) (be sure the valve stem is facing out) and then a Large Washer (10) onto the Axle. Thread a Nylon Axle Nut (8) onto the end of the axle and tighten, leaving enough space to permit the wheel to turn freely. Repeat for all Wheels. See Figures A & B.

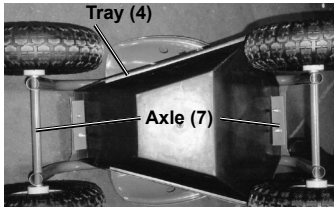

Figure A

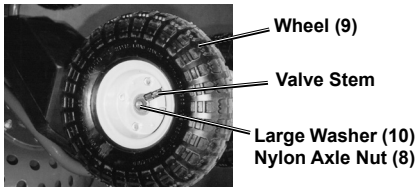

Figure B

- Be sure the Adjustment Lever (18) is screwed onto Seat Post (6). The Seat (5) is attached to the Seat Post (6) with four Tapered Bolts (16) and Flange Nuts (17). Twist Seat (5) and Seat Post (6) assembly into the Frame (1) clockwise. The threaded Post needs to be seen from below the Frame. Insert the Cotter Pin (11) through hole in the Post. Spread open the Cotter Pin (11). See Figures C & D.

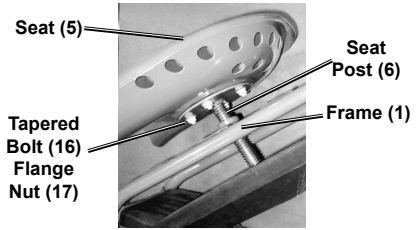

Figure C

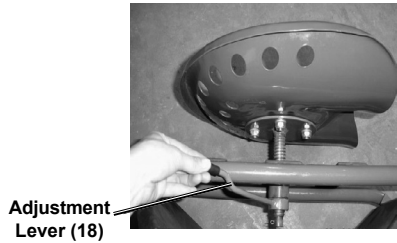

Figure D

- Loosen Adjustment Lever (18) to set the desired height. Adjust Seat height by rotating the Seat in the Frame. Rotate Adjustment Lever (18) to lock seat post in position. The Adjustment Lever (18) will prevent the Seat from lowering beyond the desired height. Before each use, check the Seat (5) to make sure that the Seat is securely in place with all hardware tightened down.

WARNING! TO PREVENT SERIOUS INJURY:
Do not use the Rolling Work Seat on inclines.

Parts List and Diagram

Part	Description	Qty
1	Frame	1
2	Tray Bracket	2
3	Reinforcing Plate	2
4	Tray	1
5	Seat	1
6	Seat Post	1
7	Axle	2
8	Nylon Axle Nut	4
9	Wheel	4
10	Large Washer (8 mm ID flat)	4
11	Cotter Pin	1
12	Small Washer	4
13	Lock Washer	4
14	Screw	4
15	Small Nut	4
16	Tapered Bolt	4
17	Flange Nut	4
18	Seat Adjustment Lever (not shown)	1

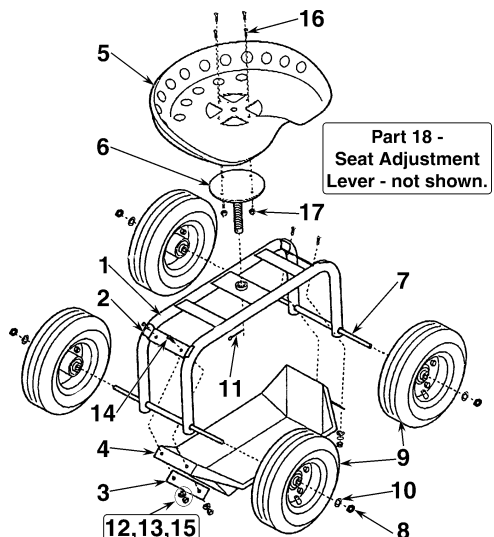

PLEASE READ THE FOLLOWING CAREFULLY

THE MANUFACTURER AND/OR DISTRIBUTOR HAS PROVIDED THE PARTS LIST AND ASSEMBLY DIAGRAM IN THIS DOCUMENT AS A REFERENCE TOOL ONLY. NEITHER THE MANUFACTURER OR DISTRIBUTOR MAKES ANY REPRESENTATION OR WARRANTY OF ANY KIND TO THE BUYER THAT HE OR SHE IS QUALIFIED TO MAKE ANY REPAIRS TO THE PRODUCT, OR THAT HE OR SHE IS QUALIFIED TO REPLACE ANY PARTS OF THE PRODUCT. IN FACT, THE MANUFACTURER AND/OR DISTRIBUTOR EXPRESSLY STATES THAT ALL REPAIRS AND PARTS REPLACEMENTS SHOULD BE UNDERTAKEN BY CERTIFIED AND LICENSED TECHNICIANS, AND NOT BY THE BUYER. THE BUYER ASSUMES ALL RISK AND LIABILITY ARISING OUT OF HIS OR HER REPAIRS TO THE ORIGINAL PRODUCT OR REPLACEMENT PARTS THERETO, OR ARISING OUT OF HIS OR HER INSTALLATION OF REPLACEMENT PARTS THERETO.

Record Serial Number Here:

Note: If product has no serial number, record month and year of purchase instead.

Note: Some parts are listed and shown for illustration purposes only, and are not available individually as replacement parts. Specify UPC 792363914956 when ordering parts.

Limited 90 Day Warranty

Harbor Freight Tools Co. makes every effort to assure that its products meet high quality and durability standards, and warrants to the original purchaser that this product is free from defects in materials and workmanship for the period of 90 days from the date of purchase. This warranty does not apply to damage due directly or indirectly, to misuse, abuse, negligence or accidents, repairs or alterations outside our facilities, criminal activity, improper installation, normal wear and tear, or to lack of maintenance. We shall in no event be liable for death, injuries to persons or property, or for incidental, contingent, special or consequential damages arising from the use of our product. Some states do not allow the exclusion or limitation of incidental or consequential damages, so the above limitation of exclusion may not apply to you. THIS WARRANTY IS EXPRESSLY IN LIEU OF ALL OTHER WARRANTIES, EXPRESS OR IMPLIED, INCLUDING THE WARRANTIES OF MERCHANTABILITY AND FITNESS.

To take advantage of this warranty, the product or part must be returned to us with transportation charges prepaid. Proof of purchase date and an explanation of the complaint must accompany the merchandise. If our inspection verifies the defect, we will either repair or replace the product at our election or we may elect to refund the purchase price if we cannot readily and quickly provide you with a replacement. We will return repaired products at our expense, but if we determine there is no defect, or that the defect resulted from causes not within the scope of our warranty, then you must bear the cost of returning the product.

This warranty gives you specific legal rights and you may also have other rights which vary from state to state.

