

Specifications

Oil Suction Gun

Capacity	16.9 oz.
Hose Dimensions	12 IN. L x 1/2 IN. O.D.

Item 95464

Important Safety Information

INSTRUCTIONS AND PRECAUTIONS



1. Wear ANSI-approved safety goggles and heavy-duty work gloves during use.
2. Keep work area clean and well lit.
3. Keep bystanders out of the work area.
4. Do not use when tired or when under the influence of drugs or medication.
5. This product is not a toy. Keep out of reach of children.
6. Use as intended only. Use only with non-corrosive lubricants. Do not use with gasoline.
7. Inspect before every use; do not use if parts are loose or damaged.
8. Recycle or dispose of oil properly in accordance with all local laws and regulations.
9. Do not use near open flame or other ignition sources.
10. When transferring oil, make certain that fluid is sufficiently cool prior to transfer. If transferring from a vehicle, make sure vehicle's engine is off, and oil and engine components are cool.

⚠ WARNING

Read this material before using this product. Failure to do so can result in serious injury. SAVE THIS MANUAL.

When unpacking, make sure that the product is intact and undamaged. If any parts are missing or broken, please call 1-800-444-3353 as soon as possible.

Copyright© 2006 by Harbor Freight Tools®. All rights reserved. No portion of this document or any artwork contained herein may be reproduced in any shape or form without the express written consent of Harbor Freight Tools. Diagrams within this document may not be drawn proportionally. Due to continuing improvements, actual product may differ slightly from the product described herein.

Manual Revised 11g

Visit our website at:
<http://www.harborfreight.com>

Email our technical support at:
tech@harborfreight.com

For technical questions,
please call 1-800-444-3353.

Operating Instructions



Inspect tool before use, looking for damaged, loose, and missing parts. If any problems are found, do not use tool until repaired.

To Drain Fluid

1. Submerge the Hose into the lubricant that you desire to transfer.
2. Holding onto the Tube with one hand, grasp the Handle with your other hand.
3. Pull up on the Handle to create suction and fill up the Tube. Use a rag on hose end to prevent dripping.
4. Place the Oil Suction Gun over a collection receptacle (not included) that can be closed and covered for transfer. Push down on the Handle or unscrew the Front Cover and pour lubricant out from the Tube into the collection receptacle.

To Fill With Fluid

1. Fill the Tube using the above steps.
2. Push down on the Handle to inject lubricant from the Hose into the transmission, clutch or differential.

Parts List and Diagram

Part	Description	Qty.
1	Handle	1
2	Rear Cover	1
3	Rubber Gasket	2
4	Tube	1
5	Front Cover	1
6	Nozzle	1
7	Hose	1
8	Spring	1
9	Follower Rod	1
10	Spacer	2
11	Plunger	1
12	Hex Nut	1

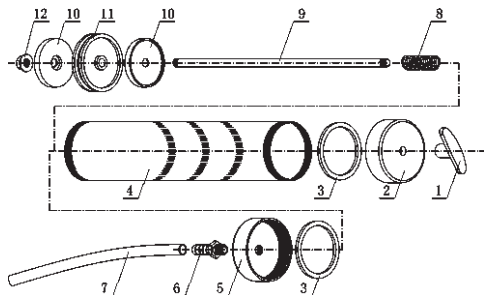

Note: Some parts are listed and shown for illustration purposes only, and are not available individually as replacement parts.

PLEASE READ THE FOLLOWING CAREFULLY

THE MANUFACTURER AND/OR DISTRIBUTOR HAS PROVIDED THE PARTS LIST AND ASSEMBLY DIAGRAM IN THIS DOCUMENT AS A REFERENCE TOOL ONLY. NEITHER THE MANUFACTURER OR DISTRIBUTOR MAKES ANY REPRESENTATION OR WARRANTY OF ANY KIND TO THE BUYER THAT HE OR SHE IS QUALIFIED TO MAKE ANY REPAIRS TO THE PRODUCT, OR THAT HE OR SHE IS QUALIFIED TO REPLACE ANY PARTS OF THE PRODUCT. IN FACT, THE MANUFACTURER AND/OR DISTRIBUTOR EXPRESSLY STATES THAT ALL REPAIRS AND PARTS REPLACEMENTS SHOULD BE UNDERTAKEN BY CERTIFIED AND LICENSED TECHNICIANS, AND NOT BY THE BUYER. THE BUYER ASSUMES ALL RISK AND LIABILITY ARISING OUT OF HIS OR HER REPAIRS TO THE ORIGINAL PRODUCT OR REPLACEMENT PARTS THERETO, OR ARISING OUT OF HIS OR HER INSTALLATION OF REPLACEMENT PARTS THERETO.